

# 2024 Annual Report of Integrated Water Management Activities in the Platte Basin Within Tri-Basin NRD



1723 Burlington Street  
Holdrege, Nebraska 68949  
(308) 995-6688  
[www.tribasinnr.org](http://www.tribasinnr.org)  
email: [tribasin@tribasinnr.org](mailto:tribasin@tribasinnr.org)

**June 2025**

# ANNUAL REPORT OF WATER USE ACTIVITIES IN THE PLATTE BASIN WITHIN TRI-BASIN NRD

## TO MEET THE REQUIREMENTS OF THE JOINT INTEGRATED MANAGEMENT PLAN FOR THE 2024 BASIN-WIDE MEETING

### I. SUMMARY

The purpose of this report is to convey information that Tri-Basin Natural Resources District (TBNRD) agreed to supply to the State of Nebraska as part of a joint Integrated Management Plan for the fully and over-appropriated portions of the Platte River Basin.

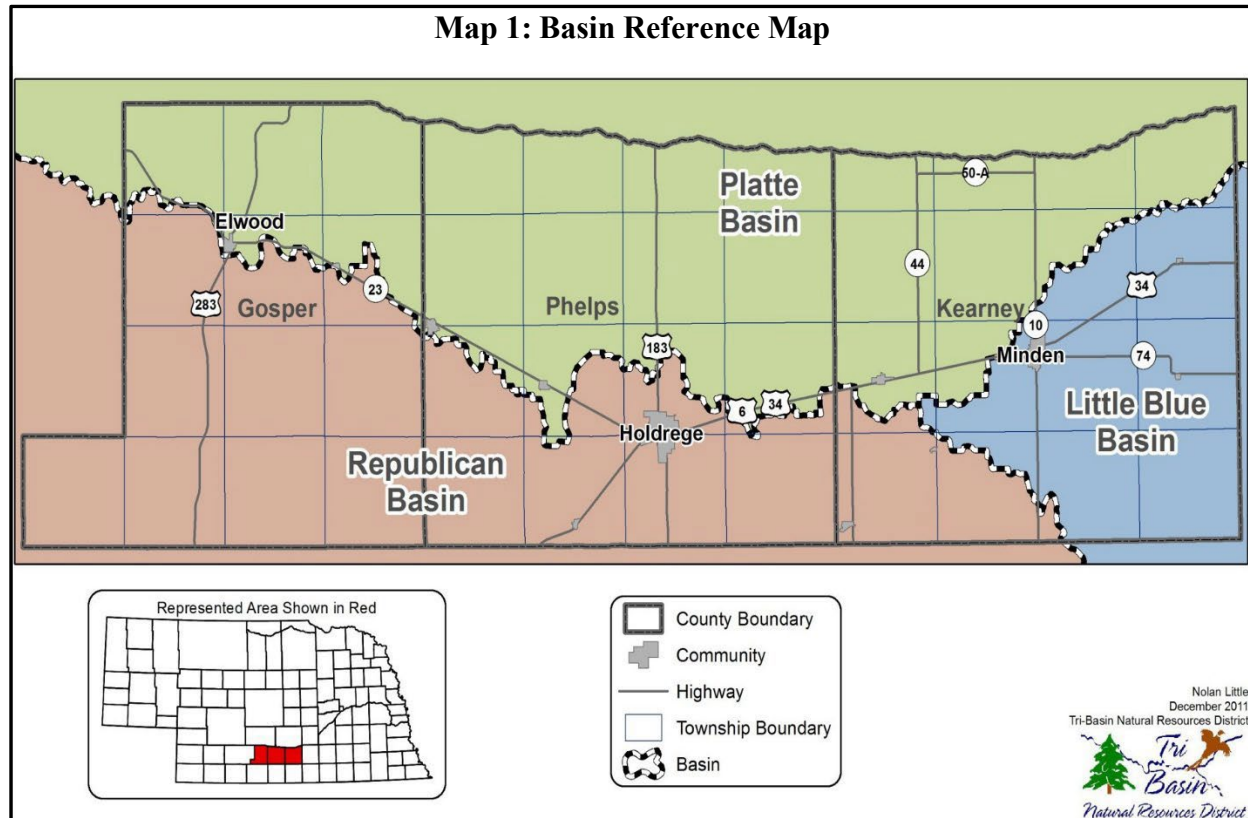

### II. INTRODUCTION

TBNRD encompasses portions of the Republican, Platte, and Little Blue River Basins (see **Map 1**, above). The district also contains an area commonly referred to as the “Groundwater Mound” spanning portions of all three basins, that is characterized by groundwater levels that are higher than historic, “predevelopment,” groundwater elevations.

More than 100,000 acres of cropland within the Platte Basin portion of TBNRD are irrigated with water diverted from the Platte River and distributed through the canals of the Central Nebraska Public Power and Irrigation District (CNPPID). Surface irrigation water and the canals that distribute it enhance recharge of groundwater supplies within the district. In addition to helping sustain groundwater supplies, this incidental recharge has increased streamflows in Platte and Republican tributaries. High groundwater levels have also saturated soil and sub-soil in parts of northern Phelps and Kearney counties, requiring TBNRD to construct drainage ditches (Improvement Project Areas or IPAs) in an attempt to stabilize groundwater levels below the crop root zone. For this reason, the TBNRD has designated portions of the Platte Basin as a “High Groundwater Management Area” pursuant to TBNRD rule 8.6 for purposes of groundwater quantity management.

### III. CERTIFIED IRRIGATED ACRES

The district began certifying irrigated acres in the Platte Basin in 2004. The initial certification process in the Platte Basin ended on June 15, 2006. Since that time, corrections and revisions to the certified acre database have occurred with a net result as of December 31, 2024, of 299,057.64 certified acres in the Platte Basin within TBNRD. Data regarding certified irrigated acres can be found in **TABLE 1** below. Commingled acres are acres that may be watered with either groundwater or surface water. Detailed information about locations and distribution of certified irrigated acres is available in the Tri-Basin NRD office.

Table 1: Platte Basin Certified Irrigated Acres						
County	Year	Groundwater	Co-Mingled	Surface	Environmental	Total Certified Acres
<b>Gosper</b>	2015	25,101.26	10,554.56			35,655.82
	2016	25,189.50	10,469.07			35,658.57
	2017	25,177.71	10,473.49			35,651.20
	2018	24,556.14	11,075.78			35,631.92
	2019	24,419.96	11,216.16			35,636.12
	2020	24,331.29	11,627.28			35,958.57
	2021	19,033.81	11,775.99	5,148.78		35,958.58
	2022	19,191.80	11,797.26	5,256.11		36,245.17
	2023	19,171.80	11,868.39	5,127.19		36,167.38
	2024	19,173.23	11,863.56	5,126.42		36,163.21
<b>Phelps</b>	2015	89,210.06	78,127.66			167,337.72
	2016	89,104.05	78,277.00			167,381.05
	2017	89,247.25	78,136.85			167,384.10
	2018	88,292.43	79,026.45			167,318.88
	2019	88,606.56	78,712.01			167,318.57
	2020	88,378.00	78,859.37			167,237.37
	2021	77,478.46	78,848.66	10,762.33		167,089.45
	2022	76,874.07	78,850.63	10,762.33	592.60	167,079.63
	2023	76,874.11	78,855.95	10,692.39	592.60	167,015.05
	2024	76,444.38	79,681.73	10,388.38	592.60	167,107.09
<b>Kearney</b>	2015	72,375.37	23,325.27			95,700.64
	2016	72,219.45	23,455.16			95,674.61
	2017	72,247.65	23,312.60			95,560.25
	2018	71,646.36	23,913.89			95,560.25
	2019	71,733.58	23,841.55			95,575.13
	2020	71,766.58	23,841.55			95,608.13
	2021	65,820.98	24,528.69	5,332.66		95,682.33
	2022	65,715.28	24,962.07	5,127.58		95,804.93
	2023	65,610.66	24,962.07	5,199.79		95,772.52
	2024	65,643.09	24,942.93	5,200.42		95,786.44
<b>District Wide</b>	2015	186,686.69	112,007.49			298,694.18
	2016	186,513.00	112,201.23			298,714.23
	2017	186,672.61	111,922.94			298,595.55
	2018	184,494.93	114,016.12			298,511.05
	2019	184,760.10	113,769.72			298,529.82
	2020	184,475.87	114,328.20			298,804.07
	2021	162,333.25	115,153.34	21,243.77	592.60	299,322.96
	2022	161,781.15	115,609.96	21,146.02	592.60	299,129.73
	2023	161,656.57	115,686.41	21,019.37	592.60	298,954.95
	2024	161,260.70	116,488.22	20,715.22	592.60	299,056.74

#### IV. APPROVED CERTIFIED ACRE AND GROUNDWATER TRANSFERS

- A. TBNRD allows certified irrigated acres to be transferred from one parcel to another within the Platte Basin portion of the district, with some limitations. These limitations include a prohibition on transfers from the fully appropriated portion of the district to the over- appropriated area. Certified irrigated acres also cannot be transferred from parcels with surface water or commingled water resources to parcels that have groundwater wells as their only water source.

Furthermore, district rules require that the number of certified acres that can be transferred be limited or “discounted” to ensure that there is not an increase in depletions to streamflows when acres are transferred from low to higher depletion zones. Between January 1 and December 31, 2024, the district approved 7 certified irrigated acre transfers in the Platte Basin. A total of 201.03 certified irrigated acres were involved in these transfers. Data regarding the location and number of acres associated with each transfer can be found below in **TABLE 2**.

TABLE 2: Platte Basin Transfer Acres																
NRD Permit Number								New Irrigated								Acres Dried Up
	Legal Description								Legal Description							
TBAT-0431	Section	29	-	7	-	15	W	6.5	Section	5	-	6	-	15	W	6.5
TBAT-0432	Section	29	-	7	-	15	W	6.5	Section	35	-	7	-	16	W	20.17
TBAT-0434	Section	26	-	7	-	20	W	3.4	Section	6	-	6	-	20	W	3.4
TBAT-0435	Section	26	-	7	-	20	W	3.1	Section	6	-	6	-	20	W	3.1
TBAT-0436	Section	13	-	7	-	17	W	14	Section	13	-	7	-	17	W	14
TBAT-0439	Section	31	-	7	-	16	W	5.4	Section	1	-	6	-	17	W	5.4
TBAT-0440	Section	31	-	7	-	16	W	7.69	Section	12	-	6	-	17	W	7.69

- B. TBNRD regulates groundwater pumping off of overlying land by requiring landowners to secure groundwater transfer permits before they can pump groundwater to properties that are either not contiguous or under the same ownership. Groundwater transfer permits can only be used to supply groundwater for irrigation of certified irrigated acres. Landowners are required to install flowmeters on wells that are permitted for transfers and to report pumping from these wells annually to the TBNRD. No permanent groundwater transfer permits were issued in the Platte Basin between January 1, 2024, and December 31, 2024. TBNRD allows CNPPID customers to pump groundwater into canals to supplement surface water diversions when necessary. Such permits are temporary and must be renewed annually. No Temporary Groundwater Transfer Permits were issued by TBNRD in 2024. Data regarding groundwater transfers can be found in **Table 3** below.

<b>TABLE 3: Groundwater Transfers</b>					
NRD Permit Number	Legal Description	Acres	Well Reg Number	Well ID #	Transfer Type

#### V. WELL CONSTRUCTION PERMITS

- A. Since 1989, TBNRD has required landowners to secure a well construction permit before they drill a well capable of pumping more than 50 gallons per minute. The district issues three categories of well permits: new well permits, conditional replacement well permits, and replacement well permits. \*Of the 8 permits issued in 2024, one replacement well permit was corrected and reapplied for as a supplemental to groundwater well and one replacement well was



not drilled as they were able to fix the current well.

TBNRD requires landowners to agree to several conditions on the operation of new wells and conditional replacement wells before permits are issued. These conditions are listed in an agreement that is signed by landowners when they apply for these types of well permits. A copy of that agreement is attached to this report as **Appendix A** (page 13).

B. **TABLE 4:** TBNRD Well Permits (above) is a breakdown of well permits that TBNRD issued in the

<b>TABLE 4: TBNRD Well Permits</b>	
<b>Well Permit Type</b>	<b>Permits</b>
New (variance) irrigation	
Replacement irrigation	6
Conditional replacement irrigation - supplemental to groundwater	
Conditional replacement irrigation - supplemental to surface water	2
Dewatering (streamflow augmentation)	
New commercial/industrial	
Domestic/Other (over 50 gpm)	

Platte Basin between January 1, 2024, and December 31, 2024. A detailed listing of well permits issued by TBNRD in 2024 is found in **TABLE 5** (below).

<b>TABLE 5: Well Permit Summary</b>				
<b>NRD Permit Number</b>	<b>Legal Description</b>		<b>Well Reg Number</b>	<b>Well Permit Type</b>
TBRP-G075187	Section	22 - 8 - 20	G-075187	Replacement Well
TBRP-G009985	Section	13 - 8 - 14	G-009985	Replacement Well
TBRP-G011192	Section	19 - 8 - 14	G-011192	Replacement Well
TBRP-G109041	Section	24 - 8 - 20	G-109041	Replacement Well
TBSS-1559	Section	19 - 7 - 19		SG Supplemental to Ground
TBRP-G045134	Section	36 - 8 - 23	G-045134	Replacement Well -Original Well modified to Stockwell
TBRP-G045112	Section	9 - 8 - 20	NDY	Replacement Well
TBSS-1565	Section	15 - 6 - 18	NDY	SG Supplemental to Ground

## VI. VARIANCES

TBNRD issues new well permits to landowners of parcels that do not have a prior irrigation history only after they have transferred sufficient certified irrigated acres to the previously dryland parcel for the intended new use. The TBNRD Board must approve a variance to the rule prohibiting new well construction before new well permits can be issued. No new irrigation well construction permit variances were issued in the Platte Basin between January 1, 2024, and December 31, 2024.

TBNRD allows for corrections to the district's certified irrigated acre database by providing proof

showing a history of irrigation between 1997 and 2005. These acres were not previously included in the district's database, because they were not classified as irrigated cropland by county assessors. Beginning in October 2013, producers also had to show proof that the corrected acres had been watered three out of the past five years. TBNRD also adjusts the district's irrigated acre database as a result of revisions made by county assessors to taxable irrigated acres. Additions or reductions of taxable irrigated acres of four acres or less are automatically accepted by the district. Larger additions or reductions must be reviewed by the NRD board before they are approved. In 2024 there were no acre correction variances and two groundwater well variances: one allowing surface water only where groundwater acres were previously transferred off and one for a replaced irrigation well modified to stock well.

#### VII. MUNICIPAL AND INDUSTRIAL ACCOUNTING

TBNRD collects water use data annually from all municipalities and industries within the district. Municipal and industrial water use data for communities and industries located in the Platte Basin reported to TBNRD in 2024. A summary of Municipal Water Use may be found in **TABLE 6** (page 9) and Industrial and Commercial Water Use in **TABLE 7** (page 11).

#### VIII. FLOWMETER DATA

TBNRD requires flowmeters to be installed, and annual water use to be reported to TBNRD whenever landowners drill new wells, receive irrigation-related cost-share funds, or when groundwater is transferred from one property to another.

In 2024, landowners reported data from 532 flowmeters in the Platte Basin. Thirty-seven of those 532 wells were reported as not used in 2024. An additional 36 supplemental wells that were used reported little use, less than 1.5 inches. A large number of acres in this area were hit hard by hail early in the season. Of the wells that were used, farmers reported that they pumped 34,334 acre-feet of groundwater on 58,720 certified irrigated acres. That results in an average application of 7.02 acre-inches of groundwater per acre.

Due to the installation of additional reporting flowmeters and depending on use of supplemental irrigation wells by CNPPID customers, flowmeter data and reported irrigated acres change from year to year. All District flowmeter data is reported annually to the Department of Natural Resources (DNR) for purposes of Republican River Basin Compact Administration accounting. Platte Basin flowmeter data is included in **Appendix B** (page 15).

#### IX. WATER BANKING ACTIVITIES

TBNRD initiated the Water Conservation Incentive Program (WCIP) in 2018 (see program summary in **Appendix E**, page 31). Participants in this program sign contracts agreeing to limit irrigation to the UNL Average Corn Crop Irrigation requirement. In exchange, Tri-Basin NRD agrees to pay them if they use less water than their allocated amount. Participants will be provided with credit accounts that track available water use credits for participating fields. Sign-up for the 2024 irrigation season concluded on April 1<sup>st</sup>. Tri-Basin received no applications for groundwater WCIP contracts in the Platte Basin in 2024.

A "commingled option" was added to the WCIP in 2019 (see commingled option in **Appendix E**, page 31). This option is particularly targeted at owners of fields that have access to both CNPPID canal water and groundwater well. Owners of these commingled fields who sign up for this option are incentivized to use surface water and limit their groundwater use to one inch or less per acre per year. The purpose of this option is to increase groundwater recharge. For this reason, the option has a ranking system that prioritizes incentives to parcels located in areas with groundwater declines. Four new commingled WCIP contracts were written in 2024 affecting 550.0 acres in the Platte Basin. At the end of 2024 a total of 3621.2 acres were in comingled WCIP contracts. 2530.2 of these total 3621.2 contract acres expired on December 31, 2024, and were not renewed.

#### X. STREAMFLOW ACCRETION ACTIVITIES

Tri-Basin NRD started utilizing the facilities of Central Nebraska Public Power District (CNPPID) to provide groundwater recharge and to augment streamflows when the district and the NE Game and Parks Commission paid CNPPID to divert 9,551 acre-feet of water from the Platte River into Elwood Reservoir in Gosper County in 2006. Additional diversions have been made regularly over the past twelve years, including 2021, when NDNR and TBNRD paid CNPPID \$188,110 to divert 6646 acre-feet into Elwood Reservoir, Victor Lakes WPA and E-65 Canal. Diversions in 2024 were

10,407.7 acre-feet, which created a total of 142,720.3 acre-feet of water diverted from 2006-2024. In all these instances, diversions were made when Platte streamflows exceeded target flows, or when irrigation deliveries were suspended due to heavy rainfall in the CNPPID irrigated area. CNPPID is no longer providing TBNRD with data. They are only sharing data directly with NDNR.

Tri-Basin NRD and NeDNR provided \$1,301,775 of local, state and Water Resources Cash Funds to the Rainwater Basin Joint Venture and CNPPID to construct pipelines from CNPPID canals to five federally owned wetlands (Victor Lakes, Cottonwood, Linder, Johnson, and Funk WPAs). (see **Appendix C**, page 34) This enables CNPPID to deliver excess flows to these wetlands.

Supplementing natural runoff with Platte excess flows enhances wildlife habitat and increases groundwater recharge, which helps offset groundwater pumping depletions, sustains groundwater supplies and augments baseflows in nearby Platte tributaries. The pipeline to Funk WPA was completed in 2018 and over 1950 acre-feet were diverted into that wetland in November and December 2018. The remaining pipelines were constructed in 2019. Excess flows were diverted into Johnson WPA in April 2019 (252 a-f) and into Victor Lakes WPA in December 2019 to January 2020 (1090 a-f).

The Platte River Recovery Implementation Program (PRRIP) paid CNPPID to divert 19,173 acre-feet of water into the Phelps County Canal in 2012. Since then, PRRIP has made additional diversions on several occasions when the Platte is flowing above target levels. While recharge resulting from these diversions cannot be used as a credit to offset depletions to Platte baseflows from post-1997 uses, Tri-Basin NRD anticipates that they will be credited toward reducing depletions to fully appropriated levels.

Tri-Basin NRD completed construction of a streamflow augmentation well along North Dry Creek in Kearney County in 2011. A second well was installed in 2015. Each well can pump as much as 1250 gallons per minute. A study of the augmentation wells' impacts, conducted by HDR Engineering in 2014 and commissioned by TBNRD and DNR, indicates that the average depletion caused by pumping augmentation well #1 over a 25-year period is equivalent to 44% of total pumping (see **Graph 2**, below).

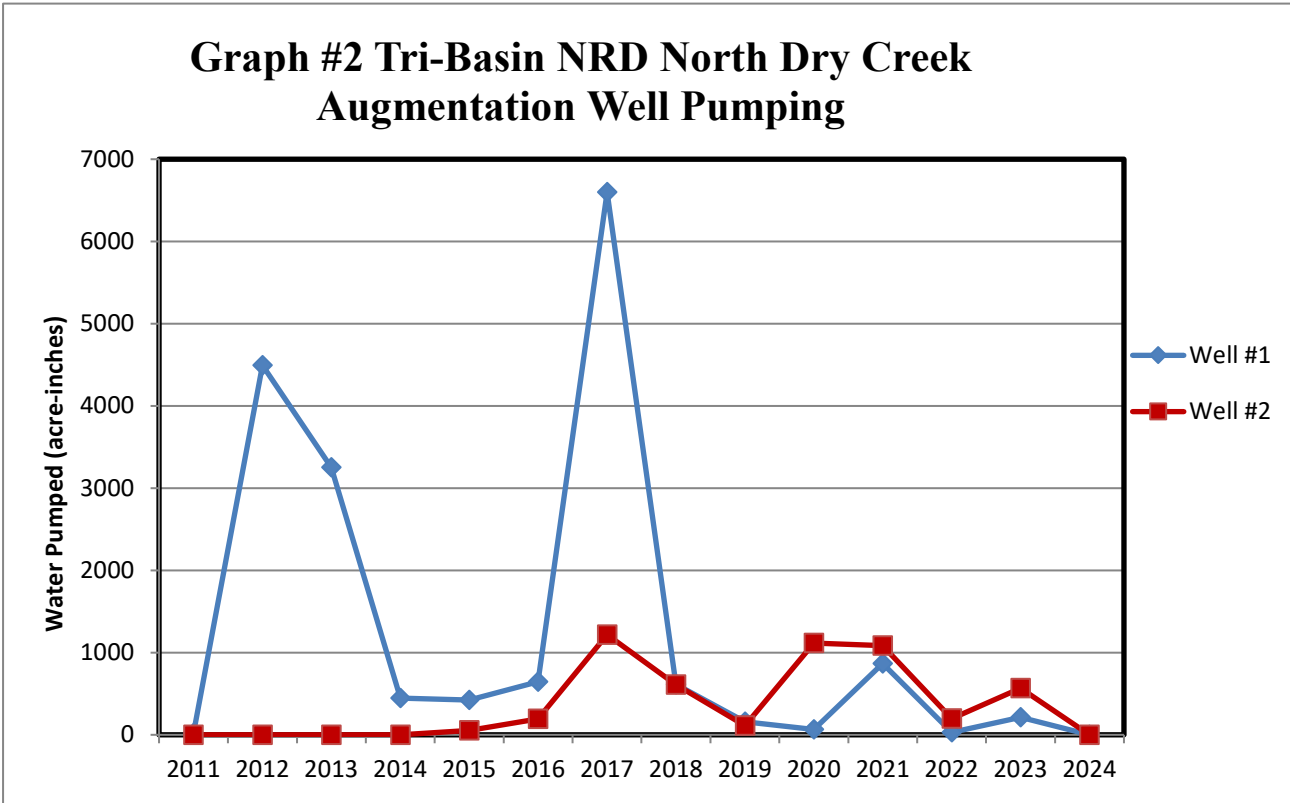

Tri-Basin NRD, PRRIP and NDNR initiated a streamflow augmentation and recharge re-timing project at Cottonwood Ranch in northwest Phelps County in 2021. Seven wells were drilled to the North and west of PRRIP's recharge cells at that site. The wells have capacities ranging from 400 to 800 gallons per minute. PRRIP's existing demonstration well on the Cook property has subsequently been integrated into the project as well. Although the wells were tested in 2022, due to some delays in construction of pipelines from the wells, the project didn't become fully operational until March 2023. Tri-Basin operates the augmentation wells on behalf of PRRIP and NDNR. Possible additional well construction is being evaluated. Pumping by augmentation wells also has an ancillary benefit of providing forage fish habitat during extreme drought conditions. Each of the eight augmentation wells operated an average of 112 days in 2024.

Tri-Basin NRD also accrued credit for 301.840 acre-feet of water pumped into the Platte River near Kearney in 2021 through a wastewater pipeline from the KAAPA ethanol plant near Axtell. This pipeline was constructed in 2008. The total discharge was 98,355,000 gallons.

Irrigated land was temporarily retired in TBNRD during 2024 through 19 contracts totaling 152.9 irrigated acres that were enrolled in 2024 for USDA-EQIP Dryland Corners.

Landowners reported to TBNRD on district Groundwater Quality Management Area crop reports that conservation tillage practices have been adopted or continue to be utilized on 64,160.4 certified irrigated acres in the Platte Basin portion of the district during 2024. It is estimated that no-till or minimum tillage practices have been adopted on at least 82,353.5 irrigated acres in the Platte Basin portion of the district. Recent university research (Klocke, et al, 2009) indicates that evapotranspiration (ET) is reduced by as much as 3 inches per acre on irrigated cropland, as compared to conventional tillage systems. Therefore, as much as 19,978 acre-feet of water was conserved in the Platte Basin in TBNRD in 2024 through this conservation practice.

Tri-Basin NRD signed agreements with DNR, Central Platte NRD (CPNRD) and Twin Platte NRD to participate in funding the proposed "J-2 Re-regulation Reservoir" project southwest of Overton, Nebraska. It was anticipated that this reservoir would store up to 8000 acre-feet of water, and that it would fill as often as three times per year. Funding for the project was suspended by the PRRIP in 2016. Tri-Basin NRD and other project partners are evaluating possible feasible alternatives to this project. Tri-Basin NRD has accrued 2040 acre-feet per year of depletion offset credit from its participation in this project. This credit remained in place through 2021.

Tri-Basin NRD and Central Platte NRD reached an agreement in 2013 that will enable TBNRD to compensate CPNRD in return for accruing credit from Platte baseflow enhancements that result from rehabilitation of three irrigation canal systems in Dawson County. In 2014, CPNRD provided 512 acre-feet of water to offset depletions caused by groundwater irrigation in TBNRD. No offset water credit has been provided under this agreement since that time, but the agreement remains in effect until 2033.

## XI. GROUNDWATER LEVELS

TBNRD has an extensive network of 137 dedicated groundwater observation wells (74 in the Platte Basin) and 91 irrigation wells (ten in the Platte Basin) that are used to measure groundwater levels (see **Map 2**, page 12). TBNRD also works cooperatively with CNPPID to gather groundwater level data. Data from 158 wells measured by CNPPID are included in TBNRD's groundwater observation well database. District water level data is reported biannually to U.S. Geological Survey and UNL-Conservation and Survey Division. Groundwater level data for the district is available from the Tri-Basin NRD office.



**Table 6: Platte Basin Municipal Water Use Data**

	Year	January	February	March	April	May	June	July	August	September	October	November	December	Yearly Total
<b>Axtell</b>	2015	2,282,900	2,027,700	4,393,300	4,318,200	4,664,300	5,876,500	12,441,200	10,301,700	10,976,400	7,525,900	4,008,900	2,699,700	71,516,700
	2016	2,379,000	2,755,600	3,040,700	4,168,700	3,985,900	13,891,900	14,882,100	11,692,100	9,021,300	7,816,500	3,537,100	2,310,600	79,481,500
	2017	2,288,000	1,988,100	2,493,500	3,609,100	4,904,500	14,414,100	14,784,100	7,672,900	10,143,900	3,942,000	2,797,400	2,430,100	71,467,700
	2018	2,487,000	2,289,700	2,421,700	2,379,200	6,946,500	12,633,200	9,746,700	8,058,000	6,823,000	3,239,900	2,139,300	2,421,400	61,585,600
	2019	2,457,000	2,265,400	2,411,600	2,931,200	4,443,300	6,385,100	9,487,000	7,732,400	7,671,600	3,046,500	2,241,100	2,209,400	53,281,600
	2020	2,259,900	2,092,600	2,132,000	4,100,500	7,021,600	11,247,200	16,882,800	16,333,800	11,553,300	7,813,600	2,668,700	2,185,500	86,291,500
	2021	2,299,800	2,258,300	2,262,600	3,861,500	5,424,400	13,903,400	11,587,900	10,636,800	8,164,300	5,333,900	2,118,100	2,194,200	70,045,200
	2022	2,208,000	2,139,300	3,083,300	7,209,500	7,657,600	12,870,500	13,080,500	13,780,200	10,480,700	6,049,800	2,946,700	2,315,800	83,821,900
	2023	2,302,800	2,169,200	2,259,800	4,042,400	7,527,500	11,012,500	11,462,500	12,927,700	10,021,100	5,292,800	2,470,100	2,453,700	73,942,100
	2024	2,699,900	2,344,100	2,525,800	3,926,500	4,992,000	11,184,000	11,568,500	12,086,200	12,274,200	9,743,500	2,373,400	2,496,800	78,214,900
<b>Bertrand</b>	2015	4,294,000	3,807,000	6,038,000	8,605,000	8,294,500	9,873,100	21,287,600	15,234,800	15,246,600	9,881,500	4,519,000	3,981,000	111,062,100
	2016	4,467,000	4,003,000	4,548,000	8,925,400	6,381,000	14,827,300	14,993,000	15,371,700	11,076,700	11,481,000	7,061,000	5,398,000	108,533,100
	2017	5,477,000	4,266,000	4,763,000	8,036,000	6,728,100	19,708,400	17,701,100	10,483,000	13,751,700	6,601,200	4,552,000	5,166,000	107,233,500
	2018	5,215,000	4,682,000	4,490,000	4,829,700	9,412,811	14,385,000	12,214,100	11,105,700	10,056,700	5,838,400	4,190,000	4,154,000	90,573,411
	2019	4,243,000	3,856,000	3,948,000	4,824,400	7,114,600	8,675,000	12,384,000	11,275,600	10,606,100	6,878,400	4,301,000	4,663,000	82,769,100
	2020	4,637,000	4,169,000	4,148,000	6,121,100	9,069,400	15,119,000	19,730,300	20,081,700	16,261,800	11,846,800	5,379,000	5,259,000	121,822,100
	2021	5,592,000	5,206,000	5,170,000	6,432,000	8,712,700	17,522,700	14,316,300	16,740,400	10,647,600	9,763,000	5,140,000	5,656,000	110,898,700
	2022	5,737,000	5,018,000	5,746,000	11,971,800	12,737,100	16,538,900	18,566,500	20,561,200	14,515,200	11,472,000	6,315,000	6,096,000	135,274,700
	2023	5,982,000	4,746,000	4,725,000	9,757,100	10,635,000	13,554,800	12,665,400	16,117,400	13,863,600	8,537,500	4,546,000	5,055,000	110,184,800
	2024	5,671,000	4,914,000	5,491,000	7,308,700	7,999,100	15,368,400	14,512,500	13,112,500	14,616,400	12,764,500	6,012,000	6,307,000	114,077,100
<b>Elwood</b>	2015	3,067,700	3,531,000	6,951,100	5,160,200	6,668,600	10,586,900	19,270,800	11,772,800	10,001,500	6,784,900	3,373,000	3,468,000	90,636,500
	2016	3,467,900	3,235,000	3,817,300	5,768,000	5,770,000	14,979,700	13,372,200	15,078,400	9,390,000	11,215,400	3,825,000	4,302,000	94,220,900
	2017	4,283,600	4,994,000	4,074,900	6,153,800	12,262,600	12,577,800	17,753,700	10,229,900	12,605,600	4,944,800	3,536,900	3,677,000	97,094,600
	2018	4,439,000	3,754,000	3,928,200	4,162,000	9,938,200	15,358,800	12,971,100	9,499,900	8,555,000	6,843,000	4,364,000	6,179,000	89,992,200
	2019	6,389,000	6,027,000	6,875,000	5,885,000	8,496,700	8,583,700	11,223,200	8,537,900	12,192,000	3,265,000	4,452,000	4,740,000	86,666,500
	2020	5,705,000	3,048,000	5,440,000	6,627,900	9,726,000	14,016,100	16,005,900	12,192,100	15,980,600	8,310,700	4,039,000	5,431,900	106,523,200
	2021	4,970,000	3,165,000	4,758,000	5,572,300	7,655,000	17,342,800	16,254,200	15,234,800	11,136,000	8,213,500	5,750,400	5,631,700	105,683,700
	2022	5,943,500	4,998,100	5,207,800	10,018,300	13,061,500	18,744,700	13,931,500	18,799,700	14,389,100	8,388,600	4,549,900	11,277,800	129,310,500
	2023	4,311,000	4,698,000	4,809,700	6,885,000	6,899,000	13,005,400	14,442,200	11,716,000	12,677,400	6,164,000	3,832,500	5,478,000	94,918,200
	2024	6,526,000	3,240,400	4,795,600	6,553,100	8,436,200	12,930,200	12,157,900	12,808,400	10,697,000	10,645,800	4,833,800	4,486,300	98,110,700

**Table 6: Platte Basin Municipal Water Use Data**

<b>Funk</b>	2015	737,000	726,000	1,004,000	1,279,000	1,347,000	1,580,000	3,150,000	1,443,000	3,291,000	1,535,000	717,000	1,047,000	17,856,000
	2016	1,239,000	1,121,000	1,368,000	1,195,000	908,000	3,739,000	3,584,000	3,240,000	1,375,000	1,176,000	615,000	539,000	20,099,000
	2017	581,000	503,000	592,000	608,000	795,000	1,998,000	3,786,700	1,670,300	2,294,000	1,080,000	912,100	1,296,000	16,116,100
	2018	1,820,000	1,624,000	1,960,000	1,803,000	1,703,000	5,737,000	7,370,700	4,910,300	3,669,000	2,256,000	1,527,100	1,835,000	36,215,100
	2019	1,662,200	1,766,800	1,403,600	1,215,300	1,290,200	1,585,400	2,746,600	2,708,800	2,410,800	1,251,500	1,260,400	1,288,200	20,589,800
	2020	1,332,100	1,376,000	1,492,100	1,724,200	2,501,800	4,063,500	4,870,200	4,164,800	3,953,000	3,314,600	1,727,600	1,177,000	31,696,900
	2021	1,125,600	1,148,800	1,261,700	2,074,800	1,396,900	4,014,600	2,936,900	2,921,400	2,589,000	1,797,100	1,085,000	1,169,100	23,520,900
	2022	983,500	1,077,200	1,265,400	1,493,100	3,250,700	3,727,100	6,032,200	1,626,400	3,098,200	1,801,800	994,800	1,082,200	26,432,600
	2023	343,800	1,193,700	1,894,900	1,153,700	4,824,000	2,483,700	2,644,500	4,096,000	3,038,800	1,928,300	1,048,900	998,100	25,648,400
	2024	1,395,700	1,062,700	1,234,400	1,092,100	1,488,200	1,800,100	4,494,800	2,910,600	3,167,200	3,543,700	1,404,100	1,494,300	25,087,900
<b>Loomis</b>	2015	1,163,000	1,177,000	2,116,000	4,199,000	2,763,000	5,302,000	8,388,000	6,377,000	6,215,000	3,215,000	1,382,000	1,113,000	43,410,000
	2016	1,066,000	1,119,000	1,362,000	2,828,000	1,952,000	7,843,000	6,982,000	7,775,000	5,093,000	4,769,000	1,995,000	1,254,000	44,038,000
	2017	1,522,000	823,000	1,835,000	3,033,000	3,124,000	9,538,000	9,616,000	2,699,000	6,351,000	2,228,000	1,401,000	653,000	42,823,000
	2018	1,440,000	1,282,000	1,235,000	1,432,000	4,451,000	6,398,000	6,346,000	4,138,000	3,901,000	1,944,000	1,084,000	1,342,000	34,993,000
	2019	1,086,000	972,000	986,000	1,273,000	1,579,000	2,621,000	5,587,000	5,196,000	5,656,000	2,152,000	1,181,000	1,165,000	29,454,000
	2020	1,143,000	1,058,000	1,170,000	2,031,000	3,304,000	7,559,000	6,338,000	11,240,000	7,536,000	4,471,000	1,690,000	1,585,000	49,125,000
	2021	1,411,000	1,532,000	1,764,000	2,228,000	3,813,000	8,872,000	7,088,000	9,758,000	5,456,000	3,571,000	1,829,000	1,598,000	48,920,000
	2022	1,574,725	1,268,725	881,725	4,769,725	5,210,725	7,737,725	7,011,725	9,318,725	6,165,725	4,199,725	1,348,725	1,097,725	50,585,700
	2023	1,371,467	1,153,467	1,112,467	2,884,467	5,144,467	4,984,467	5,265,467	7,153,467	5,078,467	3,573,467	962,467	689,467	39,373,604
	2024	1,255,790	1,073,340	1,158,780	1,425,780	4,043,280	6,224,710	6,697,360	4,869,590	6,091,090	5,214,670	1,128,290	1,224,220	40,406,900
<b>Smithfield</b>	2015													
	2016	178,100	79,200	93,100	182,300	210,600	189,900	1,028,800	1,173,700	386,200	290,500	164,400	180,700	4,157,500
	2017	121,600	151,200	127,700	128,900	236,000	489,300	725,400	267,900	375,100	168,400	162,000	99,600	3,053,100
	2018	160,800	82,400	113,300	199,800	254,200	393,900	436,600	271,700	248,000	207,100	131,600	202,300	2,701,700
	2019	99,900	201,800	156,500	152,000	254,900	259,300	230,900	412,700	183,700	164,400	143,300	109,700	2,369,100
	2020	145,300	164,000	173,400	179,600	261,800	570,500	483,300	488,700	775,100	682,200	258,200	288,800	4,470,900
	2021	160,700	244,600	214,500	240,400	346,800	534,400	309,600	632,200	367,600	404,200	267,800	314,300	4,037,100
	2022	402,700	123,300	164,400	384,400	292,600	301,000	519,500	561,600	308,200	320,000	157,500	130,000	3,665,200
	2023	142,100	134,600	127,600	224,800	393,500	385,600	289,400	486,900	385,900	239,800	105,300	117,100	3,032,600
	2024	137,200	130,600	112,500	204,200	143,000	542,100	529,000	672,300	514,000	248,100	91,500	122,500	3,447,000

- 2015 Smithfield monthly data unavailable. Water Manager passed away; village staff was unaware that they were to be keeping monthly readings. They will begin January 2016.
- 2015 IMP Report data for Bertrand contained an error; data from one well was not included in the report.

<b>Table 7: Platte Basin Industrial and Commercial Water Use Data</b>				
<b>Well Reg</b>	<b>Well ID</b>	<b>Owner</b>	<b>Legal Description</b>	<b>Gallons Used</b>
G-095842	112013	Aurora Co-Op	Section 19-7-20	9,500,000
G-116982	141058	KGLD, LLC -- Awarii Dunes	Section 11-7-16	40,080,000
G-122576	151178	Bullhead Point Assoc- Water Supervisor	Section 5-8-22	18,584,500
G-092923	102854	Central Nebraska Public Power & Irrigation District	Section 4-8-22	0
G-156977	199850	Central Nebraska Public Power & Irrigation District	Section 7-8-21	338,651,405
G-197419	273014	CNPPID	Section 4-8-22	173,339,372
G-139944	171644	Fort Kearny Consolidated	Section 6-7-14	0
G-165728	219082	Fort Kearny Consolidated	Section 5-7- 14	47,191,400
G-165729	219083	Fort Kearny Consolidated	Section 5-7- 14	12,621,900
G-123753-R1	194279	KAAPA Ethanol, LLC	Section 13-6-16	103,166,800
G-123754-R2	210900	KAAPA Ethanol, LLC	Section 13-6-16	369,500
G-124061	152898	KAAPA Ethanol, LLC	Section 13-6-16	4,021,000
G-134413-R1	194280	KAAPA Ethanol, LLC	Section 13-6-16	40,803,400
G-181488	243777	KAAPA Ethanol, LLC	Section 13-6-16	11,717,800
G-076515	85080	Lakeside Golf Club	Section 8-8-22	16,200,000
G-076780-R1	124121	Lakeside Golf Club	Section 8-8-22	21,600,000
G-177447	238330	Loomis Pork LLC	Section 19-7-19	828,000
G-071961	80123	Mosaic of Axtell	Section 15-6-16	0
G-071962	80124	Mosaic of Axtell	Section 15-6-16	0
G-073205	81395	Nebraska Public Power District	Section 4-8-21	97,902,000
G-080853	89509	Nebraska Public Power District	Section 4-8-21	403,850
G-177982	239716	Olsen Cattle Co LLC	Section 5-6- 15	4,174,000
G-147025	188561	Paul Johnson & Sons	Section 10-7-20	8,351,010
G-087812	99723	Rusty's Fertilizer Inc	Section 21-8-18	1,396,800
G-173880	234693	Tri-Basin NRD - Nolan Little	Section 5-7- 16	0
G-159762	210850	Tri-Basin NRD - Nolan Little	Section 27-8- 16	0
G-194761	266792	Tri-Basin NRD - Nolan Little	Section 9-8- 19	106,560,573
G-194762	266793	Tri-Basin NRD - Nolan Little	Section 10-8- 19	107,630,853
G-194763	266795	Tri-Basin NRD - Nolan Little	Section 10-8- 19	115,217,409
G-194766	266803	Tri-Basin NRD - Nolan Little	Section 11-8- 19	82,641,570
G-194767	266804	Tri-Basin NRD - Nolan Little	Section 11-8- 19	117,580,078
G-194765	266798	Tri-Basin NRD - Nolan Little	Section 14-8- 19	77,258,832
G-194764	266814	Tri-Basin NRD - Nolan Little	Section 17-8- 19	135,248,915
G-178735	240687	Tri-Basin NRD - Nolan Little	Section 10-8- 20	74,880,000
G-073875	82215	Village of Bertrand	Section 6-6-20	24,468,800
G-093253	106683	Wolfden Dairy	Section 28-8-16	4,750,000
G-093254	106684	Wolfden Dairy	Section 28-8-16	4,750,000
				1,801,889,767

Map 2: Dedicated Groundwater Observation Wells

# Tri-Basin Natural Resources District

## Static Water Measurement Wells

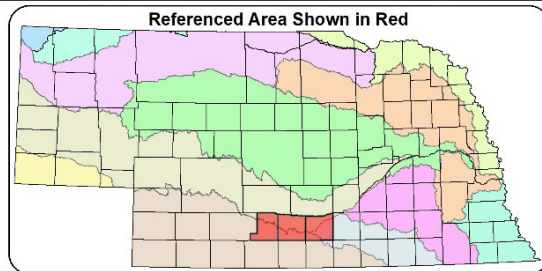
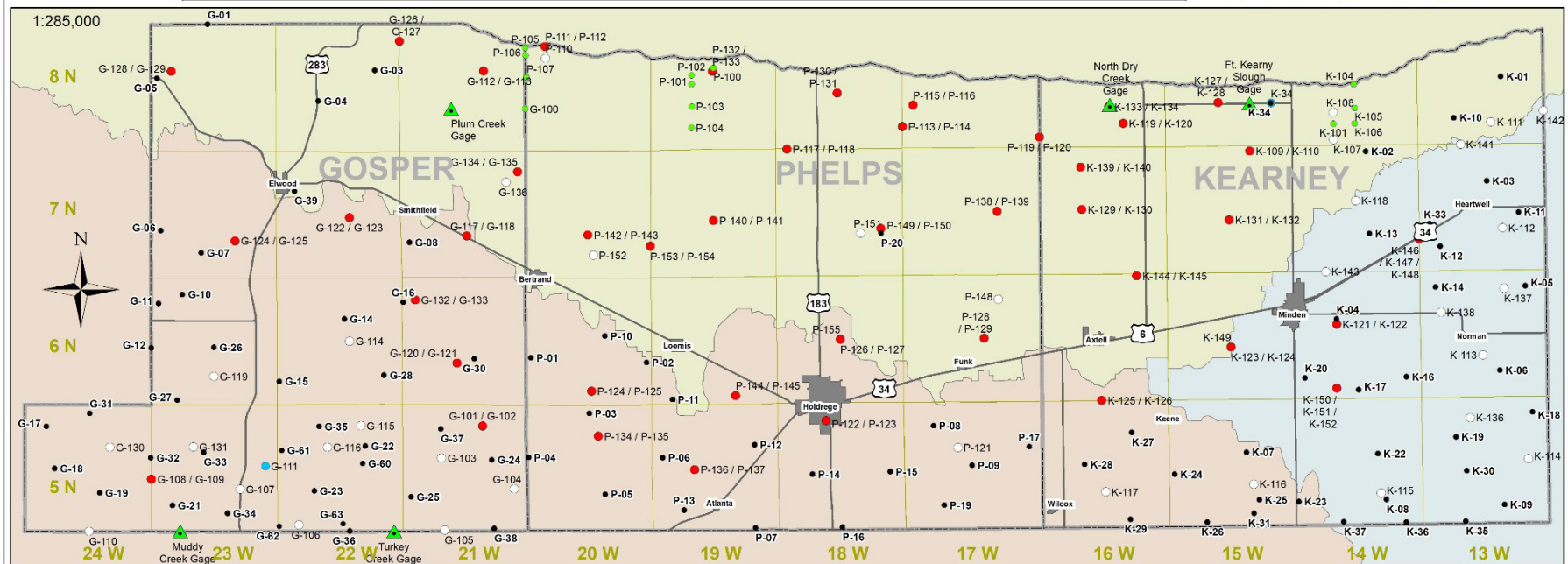

- Irrigation Well
- Transect Well
- Nested Well
- Single Well
- Other Well
- Community
- Highway
- County Boundary
- Township
- Little Blue Basin
- Republican Basin
- Platte Basin
- ▲ Stream Gage

### Observation Well Stats:

- 93 Sites
- 43 Nested Wells
- 137 Data Loggers
- 12 Hour Interval

### Irrigation Well Stats:

- 10 Platte Basin
- 21 Little Blue Basin
- 59 Republican Basin
- 90 Measured Wells
- Spring & Fall

## Appendix A: Tri-Basin NRD – Platte Basin

### Tri-Basin Natural Resources District New Well and Conditional Replacement Well Permit Applicant Certification and Agreement (Form for NON- CNPPID customers)

This Applicant Certification and Agreement imposes mandatory Conditions and Limitations on the operation of a Well permitted as a New Well or as a Conditional Replacement Well pursuant to Rule 1.13, Tri-Basin Natural Resources District Rules and Regulations for Management of Land and Water Resources.

NRD Permit # \_\_\_\_\_ Applicant \_\_\_\_\_

Applicant is the owner of the following- described real estate:

\_\_\_\_\_  $\frac{1}{4}$  Section \_\_\_\_\_ T \_\_\_\_\_ N - R \_\_\_\_\_ W \_\_\_\_\_

\*\*\*\*\*

Applicant accepts and agrees to the following conditions and limitations on the operation of a well that is constructed under the authority of a permit issued by the Tri-Basin Natural Resources District (“NRD”). The conditions and limitations are as follows (Note: Carefully read each condition checked by the NRD and then place your initials on the line next to the checked box):

1. ☐ \_\_\_\_\_ Applicant agrees to offset any “new depletions” to streamflows of the Platte River, Little Blue River, Republican River, or their tributaries that the NRD determines to be associated with use of this well. Applicant agrees to use methods to offset those depletions that are deemed acceptable by the NRD and the State of Nebraska. Applicant understands and agrees that Applicant’s failure to offset said new depletions will result in closure of this well or restrictions being imposed by the NRD on the number of acres of land that can be irrigated by this well.
2. ☐ \_\_\_\_\_ Applicant agrees to abide by well spacing and pumping capacity limitations that apply to the well that is the subject of this permit, whether such limitations arise pursuant to or state law or by rule or regulation of the NRD. Applicant understands and agrees that Applicant’s failure to comply with all rules and regulations of the NRD that pertain to this well will result in closure of this well and civil or criminal prosecution and other penalties.
3. ☐ \_\_\_\_\_ Applicant agrees to comply with all current and future rules and regulations of the NRD that pertain to this well. Applicant understands and agrees that Applicant’s failure to comply with all rules of regulations of the NRD will result in closure of this well and civil or criminal prosecution and other penalties.
4. ☐ \_\_\_\_\_ Applicant agrees to irrigate only land that has been certified for irrigation by the NRD (no new irrigated acres will be allowed). Applicant understands and agrees that Applicant’s failure to prevent irrigation of land not certified for irrigation by the NRD will result in closure of this well and prosecution by the State of Nebraska.



## **Appendix A: Tri-Basin NRD – Platte Basin**

I certify that I am familiar with the information contained in this certification and agreement and that to the best of my knowledge and belief such information is true, complete and accurate. I further acknowledge that Tri-Basin Natural Resources District or the State of Nebraska may impose additional conditions, limitations and restrictions on operation of the well that is the subject of this permit, and that all conditions, limitations and restrictions shall be binding upon any successors in interest to the well and real property.

---

Date

---

Signature of Applicant

---

Date

---

Signature of Applicant

---

Date

---

Signature of Witness

### **Approval by Tri-Basin Natural Resources District**

---

Date

---

Signature of Tri-Basin NRD Representative

### Appendix B: Tri-Basin NRD Platte Basin Flowmeter Data for Irrigation Wells - 2024

Well Reg	Well ID	Irrigated acres	Gallons Used	Meter Comments
A-005254	805	152.00	6,833,600	Hail
A-005527	1006	136.70	24,791,200	
A-005544-R1	113944	152.00	36,972,000	
A-005573-R1	203922	81.00	16,862,300	
A-005616	1053	154.00	31,379,433	
A-005637	1064	140.00	35,775,938	
A-005727-R1	247613	90.00	17,503,739	
A-005806	156476	125.00	42,027,332	
A-005851-R2	234961	156.40	26,238,000	
A-005964B-R1	182843	116.00	36,255,749	
A-005987	1325	73.90	21,157,200	
A-006272	124857	140.00	31,188,541	
A-006470	1647	130.00	36,974,516	
A-006862	1917	148.00	17,261,600	
A-007012-R1	2028		0	Well NOT Used in 2024
A-007219-R1	263005	168.00	24,621,346	
A-007398-R1	219835	139.50	33,053,000	
A-008164-R1	174548	100.00	5,924,188	Series Well: 2 Wells, 2 Meters
G-000273-R1	98237	127.00	19,666,285	
G-000317-R2	219289	132.00	25,227,200	
G-000533	3831	126.00	8,140,226	
G-000559-R1	262531	97.00	6,584,845	Est. Usage- meter not working and field was hailed out.
G-000597-R1	207683	135.00	42,766,463	
G-000671-R1	3992	300.00	40,265,300	
G-001136-R1	238751		0	Well NOT Used in 2024 - Surface Water Only WCIP Program
G-001152	4544		0	Well NOT Used in 2024
G-001169	4563	149.00	33,797,800	EQIP Contract; Water Use Report not required
G-001228-R1	92085	73.00	35,680,356	Estimated Usage
G-001374-R1	222615	135.00	21,859,300	
G-001498	4954	245.15	15,326,700	
G-001705	5190	150.00	27,945,268	
G-002216-R1	166014	143.00	33,603,200	
G-002383-R1	128836	132.00	27,400,015	
G-002482	6081	134.00	2,048,226	Supplemental Well -NOT Used in 2024
G-003468	7201	77.00	22,913,200	
G-004871	8801	80.00	4,296,849	Hail
G-004955-R1	8893	148.00	4,112,500	
G-005097-R1	114236	151.30	26,949,530	
G-005392	9390	0.00	0	Supplemental Well -NOT Used in 2024
G-006383	10549	0.00	0	Supplemental Well -NOT Used in 2024
G-006536	10727	22.00	3,032,287	Meter measures mini-Pivot Only
G-007340-R1	162706	130.00	36,087,000	
G-007342-R1	162707	119.00	37,660,400	

### Appendix B: Tri-Basin NRD Platte Basin Flowmeter Data for Irrigation Wells - 2024

Well Reg	Well ID	Irrigated acres	Gallons Used	Meter Comments
G-007488-R1	11845	0.00	0	Supplemental Well -NOT Used in 2024
G-007764	12171	0.00	0	Supplemental Well; NOT Used in 2024. WCIP Program
G-008178	12651	130.00	21,163,012	
G-009462	14164	70.00	8,629,000	Supplemental Well
G-009596	14319	147.00	21,341,500	
G-010388-R1	213868	65.00	7,253,104	
G-011357-R1	16352	115.00	23,695,395	
G-012318	17473	137.00	38,268,000	
G-012651-R1	191520	67.00	13,408,374	
G-013097-R1	121819	132.00	13,136,500	Hail
G-013423-R1	209336	260.00	34,721,276	
G-013652	18997	153.30	13,577	
G-013974	19370	135.60	20,201,761	
G-014026	19432	146.00	1,985,242	Estimated Usage
G-014735-R1	20244	78.00	10,905,317	
G-016206	21928	146.00	27,175,723	
G-016446-R1	22203	130.00	23,581,891	
G-016616-R1	169839		0	Supplemental Well -NOT Used in 2024
G-016633	22408	75.00	21,294,600	
G-016869	22679		99,655	Well Used to water Cattle
G-017090-R1	172826	131.60	34,691,950	
G-020681	26927	133.60	17,427,980	
G-020831	27090	120.00	25,034,630	
G-021172	27458	93.00	15,272,400	
G-021193	27482	139.00	22,670,059	alfalfa
G-021609-R1	258322	151.00	40,964,795	
G-021735-R1	28060	152.00	39,220,151	
G-021830-R1	163082	123.00	2,967,932	Supplemental Well
G-022286	28646	30.00	6,509,356	
G-022438	28804	135.00	24,951,267	Seed Corn
G-022950	29350	130.00	31,590,600	
G-022962-R1	227608	120.00	48,880,700	
G-023149	29563	26.00	11,706,360	
G-023266	29683	149.00	18,506,700	
G-023268-R1	241542	62.00	3,542,511	
G-023479	29912	135.00	30,793,200	
G-023572	30014		0	Supplemental Well -NOT Used in 2024
G-023615	30058	155.00	32,041,000	
G-024078-R1	98512	150.35	59,238,800	Hail, replanted beans
G-024220	30697	130.00	87,100	Supplemental Well
G-024327	30807	152.00	20,727,000	
G-024329	30809	76.00	2,328,999	Supplemental Well
G-024483-R1	30966	132.43	29,123,480	

### Appendix B: Tri-Basin NRD Platte Basin Flowmeter Data for Irrigation Wells - 2024

Well Reg	Well ID	Irrigated acres	Gallons Used	Meter Comments
G-024606-R1	228630	105.00	28,569,800	
G-024787-R1	97572	150.00	3,213,132	Hail
G-024986	31500	130.00	8,919,817	Supplemental Well
G-025069	31589	151.00	36,902,286	Estimate: Required - Platte basin well, waters into Republican basin.
G-025152	31677	125.00	11,999,624	
G-025207	31736	127.00	13,794,232	Estimated Usage
G-025703-R1	242435	151.50	43,084,000	
G-025803	32369	140.00	30,108,100	
G-026446	33051	130.00	30,964,520	
G-027184	33850	140.00	27,025,000	
G-027484-R1	225652	0.00	0	
G-028077	34788	146.00	23,690,000	
G-028109-R1	34822	109.00	20,247,923	
G-028636	35400	132.00	34,558,700	
G-028660-R2	160179	145.00	14,200	Supplemental Well
G-028765-R1	35540	142.00	32,351,275	Meter Replaced
G-028884	35667	140.00	32,005,200	
G-029347	36156	105.00	19,398,000	
G-029951-R1	217569	38.00	18,037,316	
G-030265	37128	50.00	8,449,782	
G-030496	37375	130.00	16,580,503	
G-030668-R1	164677	0.00	0	
G-030676	37576	130.00	10,412,473	
G-030705	37605	148.00	13,517,700	
G-030936-R1	176011	120.00	19,202,500	
G-031102	38030	150.00	17,287,000	Hail -Seed Corn
G-031153	38092	155.00	6,387,000	
G-031354	38311	140.00	30,304,000	
G-031657	38620	62.00	17,485,300	
G-031862-R1	170685	147.50	30,942,700	
G-031885-R1	168468	149.90	20,351,923	Estimated Usage- hail meter did not move
G-032220	39203	145.00	31,510,044	
G-032221	39204	21.00	5,736,282	
G-032462-R1	166009	124.00	22,870,100	
G-032999-R2	189200	65.00	10,828,472	
G-033196-R1	158873	130.00	30,337,534	
G-033788	40819	147.20	9,453,800	Supplemental Well
G-033845	40877	132.00	9,886,700	
G-034024	41062	85.00	42,280,000	
G-034034-R1	93086	65.00	8,346,700	
G-034439	41489	130.00	43,376,614	
G-034522	41576		0	Supplemental Well -NOT Used in 2024
G-034601	41656	70.00	15,583,200	

### Appendix B: Tri-Basin NRD Platte Basin Flowmeter Data for Irrigation Wells - 2024

Well Reg	Well ID	Irrigated acres	Gallons Used	Meter Comments
G-034607-R1	95424	191.00	42,170,705	
G-034763	41826	142.00	2,178,022	Supplemental Well
G-034808	41871	0.00	0	Meter Exemption:
G-035001-R1	246956	151.00	31,619,746	
G-035027	42096	116.70	3,189,800	Supplemental Well
G-035028	42097	154.80	37,581,400	corner system
G-035046-R1	149129	94.80	30,971,900	Hail, replanted beans
G-035210-R1	42287	132.00	4,896,409	Hail
G-035230-R1	209844	100.50	34,757,663	
G-035840-R1	221855	265.00	1,184,600	Supplemental Well
G-036171-R1	217862	148.00	29,912,575	
G-036219-R1	213455	75.00	22,282,843	
G-036220-R1	204099	53.70	29,204,399	
G-036447-R1	203726	135.00	46,416,000	
G-036476	43608	144.00	23,469,745	
G-036500	43633	149.00	37,732,655	
G-036585	43719	44.90	12	
G-036677	43812	130.00	38,363,986	
G-037041	44181	50.00	2,000	Supplemental Well
G-037482	44633	152.00	38,403,630	
G-037931-R1	227572	140.00	21,661,000	
G-038167-R2	209014	134.00	28,599,500	
G-038172	45343	130.00	40,141,487	
G-039054	46251	119.00	20,747,828	
G-039106	46304	128.00	38,789,900	
G-039190	265700	156.00	38,361,270	
G-039297	46502		0	Supplemental Well; NOT Used in 2024. WCIP Program
G-039421	46631	145.00	38,806,324	
G-039572	46786	77.90	49,629,908	
G-039663-R1	199851	100.00	27,248,800	
G-040337	47575	145.00	30,394,400	
G-040839	48087	118.00	14,154,837	alfalfa
G-041057	48311	14.00	6,251,122	
G-041183	48439	154.00	57,970,300	
G-041329-R1	219361	0.00	0	
G-041350	48611	127.00	16,828,419	
G-041369-R1	188563	66.00	17,135,900	
G-041374	48636	141.00	26,341,009	
G-041637	48904	59.70	24,547,216	First year SDI - Meter NOT Required, but producer willing to report. This was part of an EQIP project.
G-041826	49107	157.80	33,398,100	
G-041978-R1	222393	230.00	9,336,631	Supplemental Well
G-041996-R1	228128	17.00	3,553,916	
G-042019	49302	145.00	138,214	



**Appendix B: Tri-Basin NRD Platte Basin Flowmeter Data for Irrigation Wells - 2024**

Well Reg	Well ID	Irrigated acres	Gallons Used	Meter Comments
G-042824	50125	159.94	30,144,100	
G-042992-R1	198737	135.00	28,686,600	
G-043275-R1	50593	137.00	18,550,798	
G-043276-R1	169041	148.00	26,316,571	
G-043366-R1	127238	83.00	4,145,300	
G-043639	50973	120.00	54,835,059	
G-043853	51191	126.00	39,168,287	
G-043947	51286	136.00	19,746,700	
G-044047	51391	135.00	25,430,264	
G-044222	51568	165.00	48,305,600	Hail replanted in July
G-044570	51919	130.00	28,240,160	Estimate Required -Waters into Rep basin
G-044608	51959	132.00	17,526,900	Hail
G-044680	52031	141.00	26,610,376	
G-044799	52151	123.00	22,283,387	
G-044918	52271	156.40	36,701,617	Estimated Usage-
G-045284	52644	135.00	28,552,700	
G-045549-R1	118572	136.00	33,673,200	
G-046380	53760	135.00	25,837,031	
G-046434	53847	157.00	19,813,100	
G-048424	55885	111.00	27,773,800	
G-049528	57016	133.00	32,147,500	
G-049567-R1	221186	146.00	38,511,432	
G-050030	272604	144.00	33,772,244	
G-050941	58466	17.00	5,348,844	
G-053420	60983	160.00	42,407,759	
G-053870	61445	150.00	28,244,100	
G-054523	62111	150.00	27,407,800	
G-055251	263060	166.30	65,718,900	Hail, replanted beans
G-055382-R1	172201	156.70	49,349,100	
G-055521	63130	137.00	80,458,659	
G-056004	63618	102.50	31,546,100	
G-056497	64132	135.00	31,501,355	
G-056606-R1	64243	133.00	9,287,100	Hailed Out -Crop Destroyed
G-057082	64744	134.00	26,020,000	
G-057112	64775	135.00	35,207,604	
G-057282	64950	150.00	5,422,800	
G-057427-R1	222051	187.00	52,736,000	
G-058508	66218	136.00	17,626,747	
G-059592	67347	149.26	19,694,500	
G-059676	67433	57.30	11,649,609	
G-060270-R1	254482	62.00	29,671,990	
G-060768	68553	136.16	23,198,205	
G-060797-R1	212228	130.00	2,181,950	Hail

## Appendix B: Tri-Basin NRD Platte Basin Flowmeter Data for Irrigation Wells - 2024

Well Reg	Well ID	Irrigated acres	Gallons Used	Meter Comments
G-061063-R1	213557	240.00	56,632,111	
G-061501-R1	221352	152.00	23,038,900	Hail
G-061654	69490	138.50	28,479,500	
G-061946	69783	128.00	35,935,500	
G-063158	71057	153.77	30,841,600	
G-063177	71076	138.68	41,525,797	
G-063232	71133	150.00	28,010,300	
G-063877	71796	91.00	27,608,100	
G-063968	71890	130.00	36,442,026	
G-064069	71993	65.20	3,605,800	
G-064756	72722	77.21	8,444,200	
G-064840	72808	145.00	54,313,600	
G-065598	73589	130.00	27,258,814	
G-066150	74154	130.00	10,230,500	
G-066270	74279	134.00	765,000	Supplemental Well
G-066404	74421	130.00	28,954,863	
G-066511	74530	149.20	38,834,000	
G-067478	75541	95.00	16,215,011	
G-067820	75893	135.00	13,613,500	
G-067926	76002	129.61	2,771,000	WCIP Surface
G-067939-R1	176352	149.00	37,082,589	
G-067960	76038	132.00	7,706,000	
G-068188	76269	131.00	24,129,400	
G-068235	76316	127.00	19,421,626	
G-068317	76399	173.30	41,694,967	
G-068903	77028	134.80	25,830,700	
G-068938	77063	135.00	15,260,548	
G-069457	77609	240.00	39,145,749	
G-069536	77689	130.00	49,454,000	
G-069613	77769	0.00	0	
G-070512	264615	153.00	38,558,680	
G-070731	78892	158.20	33,053,000	
G-070802	78963	145.00	20,521,000	
G-070946	79107		0	Well NOT Used in 2024
G-071177-R1	225427	133.00	19,031,423	
G-071178-R1	162859	146.80	20,529,000	Surface water used on corners
G-071179	79340	120.00	36,946,000	Meter Refurbished
G-071541	79703	130.00	27,071,180	
G-072455-R1	206053	132.00	37,022,849	
G-072667	80855	151.42	19,155,517	
G-072681	80869	7.00	2,517,300	
G-073172	81360	72.00	20,631,609	
G-073798	82134	140.00	22,023,794	

**Appendix B: Tri-Basin NRD Platte Basin Flowmeter Data for Irrigation Wells - 2024**

Well Reg	Well ID	Irrigated acres	Gallons Used	Meter Comments
G-073863	82203	150.00	10,299,200	Series Well: 2 Wells, 2 Meters
G-074144	82484	134.00	23,830,350	
G-074176	82517	130.00	26,431,975	Hail
G-074256	82601	73.00	15,686,900	
G-074282	82627	140.00	25,675,000	
G-074365	82710	127.00	31,037,022	
G-074392	82739	66.00	13,114,500	
G-074662	83011	105.00	43,097,200	
G-077557	86175	150.00	33,657,926	WCIP Contract 2022 PH G003
G-079825	88482	135.00	27,437,900	Meter Not Required, Willing to Report
G-087842	99647	133.00	29,969,100	corner system
G-091120	102868	160.31	22,006,600	
G-091407	102859	133.00	43,018,600	
G-096150	109726	130.00	17,480,930	Hail Total -beans replanted in July
G-096555	109842	130.00	24,144,900	
G-096676	112194	130.00	23,729,066	
G-096815	110571	77.00	16,518,864	
G-097100	110814	70.00	5,990,172	Supplemental Well -- Meter moved, Producer said NOT USED
G-097707-R1	236661	143.30	22,873	
G-098970	115138	64.00	21,148,892	
G-100388	114419	145.00	33,301,900	
G-109999	128947	225.00	26,606,847	
G-110172	129232	151.78	42,839,200	
G-116457	140343	80.00	21,458,992	
G-116906	141679	75.00	27,765,000	Estimated Usage
G-118169	142719	160.00	57,318,835	
G-119660	146805	88.00	17,607,468	
G-120205	146011	102.00	32,473,468	
G-121077	147633	152.80	47,489,800	
G-121219	146009	120.00	27,837,400	
G-121766	146008	150.00	29,683,395	
G-121894	148344	181.97	80,783,383	
G-122529	147634	78.00	14,013,000	
G-123303	149183	64.00	20,007,067	
G-124617	152724	148.00	30,405,368	corner system
G-125286	152448	77.70	26,894,800	
G-125287	152447	0.00	0	
G-127496	153919	116.00	30,163,800	
G-127559	155815	135.00	29,580,200	
G-128172	154500	37.50	3,837,400	
G-129150	154896	131.00	30,546,400	
G-129241	158555	90.00	21,765,300	
G-129257	160440	137.00	15,985,600	

**Appendix B: Tri-Basin NRD Platte Basin Flowmeter Data for Irrigation Wells - 2024**

Well Reg	Well ID	Irrigated acres	Gallons Used	Meter Comments
G-129577	158376	120.00	23,941,500	
G-129685	156989	144.61	29,808,304	Swing Arm
G-129692	160438	140.00	18,616,600	
G-130058	154894	100.00	33,898,782	
G-130108	159812	134.00	4,760,368	Supplemental Well
G-130225	160878	134.00	30,919,400	
G-130382	153921	0.00	0	Supplemental Well -NOT Used in 2024
G-130445	153920	0.00	0	Supplemental Well -NOT Used in 2024
G-130451	154496	0.00	0	Supplemental Well; NOT Used in 2024. WCIP Program
G-130559	156326	152.50	46,838,300	
G-130635	159808	130.00	29,777,600	
G-130699	161380	135.10	1,846,000	Supplemental Well
G-130801	154254	130.00	28,171,900	
G-130918	161076	152.20	54,449,700	
G-130954	162385	10.00	1,230,800	
G-130969	161430	148.00	3,023,597	Supplemental Well
G-131043	161371	143.00	26,090,500	
G-131271	156876	130.00	701,500	Supplemental Well: Hailed
G-131440	156871	124.00	4,716,200	Supplemental Well
G-131490	154924	80.00	26,084,947	
G-131622	155819	100.00	10,273,000	
G-131623	155812	135.00	36,351,400	
G-131624	160071	114.00	42,374,903	
G-131726	162133	150.80	26,676,000	
G-131774	163016	144.00	22,689,700	
G-131925	162127	133.40	1,150,200	Supplemental Well
G-131927	161757	130.00	21,445,900	
G-131930	162388	122.60	22,879,000	
G-131993	159890	145.00	29,432,400	
G-132158	163442	139.00	19,876,300	
G-132168	160566	135.00	33,017,700	
G-132241	165009	128.00	5,666,700	Supplemental Well
G-132339	156879		0	Supplemental Well; NOT Used in 2024. WCIP Program
G-132340	156877	0.00	0	Well NOT Used in 2024
G-132341	156875	0.00	0	Supplemental Well -NOT Used in 2024
G-132344	156789	12.00	2,502,000	
G-132359	160881	0.00	0	Supplemental Well -NOT Used in 2024
G-132512	161373	135.00	35,857,900	
G-132514	165545	0.00	0	Supplemental Well -NOT Used in 2024
G-132515	161839	144.23	2,030,700	Supplemental Well -WCIP Program
G-132529	161379	141.50	22,437,700	Supplemental Well
G-132531	161571	140.00	25,533,177	
G-132532	161572	151.12	29,550,200	

**Appendix B: Tri-Basin NRD Platte Basin Flowmeter Data for Irrigation Wells - 2024**

Well Reg	Well ID	Irrigated acres	Gallons Used	Meter Comments
G-132544	159256	131.00	15,882,103	
G-132547	159597	145.00	38,362,200	Supplemental Well
G-132644	160439	158.00	23,024,700	Supplemental Well
G-132663	164229	154.30	37,719,621	
G-132700	165015	132.00	85,258,400	
G-132701	165016	132.00	90,822,500	
G-132733	159884	160.00	25,057,100	
G-132734	164687	115.00	46,930,801	
G-132768	165657	140.00	24,777,600	
G-132769	160567	144.00	41,234,700	
G-132798	159254	130.00	26,529,186	
G-132840	160488	151.00	24,218,924	
G-133038	165739	136.25	28,805,300	
G-133088	157915	130.00	35,670,580	
G-133180	161381		0	Supplemental Well -NOT Used in 2024
G-133181	161382	0.00	0	Supplemental Well -NOT Used in 2024
G-133233	162390	119.68	19,659,900	
G-133234	161749	125.00	29,236,200	
G-133235	158379	117.00	14,514,400	Supplemental Well
G-133352	162136	148.00	31,880,968	
G-133405	165547	120.00	29,699,700	
G-133416	165335	71.50	24,136,100	
G-133421	161383	101.00	18,657,513	
G-133426	165471	65.00	16,836,800	
G-133471	163782	130.00	357,000	
G-133725	162123	130.00	9,625,600	
G-133759	160323	87.00	9,617,947	
G-133929	164406	75.00	25,852,000	
G-133952	166448		4,587,200	Well Used to fill Pond @ MOSAIC
G-134113	166449	111.00	28,805,100	
G-134130	162140	130.00	45,349,080	
G-134132	162139	67.00	28,329,000	
G-134186	166699	10.00	1,571,402	
G-134199	162134	130.00	15,757,738	
G-134206	166528		0	Supplemental Well -NOT Used in 2024
G-134230	166010	63.00	43,106,900	
G-134566	160564	123.00	29,005,200	
G-134706	167566		0	Well NOT Used in 2024
G-134879	162601	65.00	1,552,000	Supplemental Well
G-134880	161156	145.00	5,868,794	
G-135119	169328	156.30	20,231,700	Supplemental Well
G-135169	166605	130.00	28,813,900	
G-135192	167715		0	Supplemental Well -NOT Used in 2024



### Appendix B: Tri-Basin NRD Platte Basin Flowmeter Data for Irrigation Wells - 2024

Well Reg	Well ID	Irrigated acres	Gallons Used	Meter Comments
G-135193	167716	65.00	9,871,100	
G-135213	166040	86.00	28,004,800	
G-135516	169018	116.00	28,042,000	
G-135532	160565	140.00	33,354,700	
G-135822	169468	99.60	27,293,300	
G-135950	161750	0.00	0	Well NOT Used in 2024
G-136259	169013	86.00	8,934,600	
G-136650	169774	135.00	48,469,500	Hail
G-136691	165017	135.00	14,353,300	Hail
G-137318	169448	110.00	14,385,600	Estimated Usage- ran 10 days. Pasture
G-137329	169841	134.30	7,627,559	Hail - July 6th. Didn't pump after that.
G-137381	170158	145.00	4,192,034	Supplemental Well
G-137402	170172	135.00	26,679,619	
G-137403	170742	72.00	23,692,000	
G-137447	165018	135.00	7,807,300	Hail
G-137702	169770	133.00	17,377,745	
G-137739	166606	138.00	11,727,270	
G-137937	172642	134.00	77,471,700	
G-137967	166808	292.00	26,496,300	Supplemental Well
G-138203	172442	155.00	36,949,262	
G-138280	162142	64.85	18,607,279	
G-138534	172370	151.00	21,364,224	
G-138594	172862	74.60	2,909,900	Supplemental Well
G-139059	172599	100.00	18,426,600	
G-139271	170679	90.00	24,248,200	Supplemental Well
G-139360	165336	38.00	37,056,800	
G-139572	169042	100.00	15,356,200	
G-140012	167002	24.50	6,033,500	Supplemental Well
G-140625	172547	132.00	19,598,200	
G-141518	173834	68.00	4,578,800	
G-141860	177863	93.00	9,684,618	Supplemental Well
G-142036	170682	122.27	21,521,900	Supplemental Well
G-142430	178761	130.00	7,582,000	Hail
G-142530	173630	139.00	38,536,400	
G-142566	178584		0	Supplemental Well -NOT Used in 2024
G-142967	178585	215.00	25,167,900	
G-143253	177864	0.00	0	Well NOT Used in 2024
G-144298	182757	72.00	3,589,800	Hail
G-144555	181381		0	Supplemental Well; Not Used in 2024
G-144716	182053	150.00	27,666,700	
G-144783	183104	137.00	2,111,500	Hail
G-144784	180131	0.00	0	Well NOT Used in 2024
G-144823	182952	205.00	4,330,600	Supplemental Well

### Appendix B: Tri-Basin NRD Platte Basin Flowmeter Data for Irrigation Wells - 2024

Well Reg	Well ID	Irrigated acres	Gallons Used	Meter Comments
G-144980	182209	135.00	34,429,400	
G-145042	183105	100.00	22,814,400	
G-145565-R1	190217	130.00	23,137,380	
G-145863	185009	260.10	10,279,400	Supplemental Well
G-145885	178762	40.00	754,600	Supplemental Well
G-145993	183670		0	Supplemental Well; Not Used in 2024
G-146977	180054	90.00	24,852,200	
G-147124	182953	150.00	4,429,500	Supplemental Well
G-147456	188634	150.00	11,798,956	
G-147457	188635	150.00	29,536,763	
G-148411	189364	150.00	13,529,900	
G-148565	187309	150.00	0	Supplemental Well -NOT Used in 2024
G-148621	191026	150.00	6,590,276	
G-148622	190543	150.00	8,012,000	
G-148685	188800	150.00	27,276,464	
G-148702	189813	150.00	29,427,875	
G-148722	191249	150.00	12,182,370	
G-148743	187694	150.00	1,509,490	Supplemental Well
G-149188	191318	150.00	60,182,800	
G-149618	192106	150.00	29,953,577	
G-149663	191521	150.00	17,445,902	
G-149890	191025	150.00	3,102,887	Hail
G-150891	187697	150.00	2,340,900	Supplemental Well; (6.37")
G-151663	191248	150.00	24,823,372	
G-152478	197495	150.00	33,535,190	Estimated Usage+AH358
G-152676	191017	150.00	6,960,656	
G-152707	197427	150.00	10,723,700	Hail
G-153081	197627	150.00	11,579,552	
G-153624	199985	150.00	29,530,789	
G-157641	202660	150.00	36,115	Supplemental Well:
G-158114	208108	150.00	12,261,660	
G-159284	208463	150.00	30,408,135	
G-161020	213049	150.00	54,244,700	
G-161031	214156	150.00	14,750,596	
G-161519	208462	150.00	7,247,100	
G-162926	216452	150.00	10,650,613	
G-164032	219279	150.00	35,463,124	
G-164644	218534	150.00	23,852,073	
G-164765	217905	150.00	32,422,690	corner system
G-165055	220042	150.00	3,074,647	Supplemental Well -NOT Used in 2024 surface water (6.51")
G-165537	215283	150.00	8,773,186	
G-165597	218166	150.00	13,964,216	
G-166011	221015	150.00	5,924,188	

**Appendix B: Tri-Basin NRD Platte Basin Flowmeter Data for Irrigation Wells - 2024**

Well Reg	Well ID	Irrigated acres	Gallons Used	Meter Comments
G-166108	222272	150.00	13,352,164	Hail
G-166557	217687	150.00	32,502,251	
G-166720	222354	150.00	29,003,458	
G-167012	221958	150.00	4,515,710	
G-167286	223104	150.00	13,033,920	
G-167416	222557	150.00	26,474,606	
G-167483	224220	150.00	1,881,772	Supplemental Well; 6.93 surface water
G-167695	221189	150.00	6,088,470	Supplemental Well
G-167696	221856	150.00	27,112,454	
G-167697	222232	150.00	8,472,048	Estimated Usage- AH5
G-167700	222753	150.00	2,139,900	Supplemental Well
G-167889	222616	150.00	10,481,444	
G-167954	223105	150.00	0	
G-168005	223141	150.00	10,822,498	
G-168610	217989	150.00	30,622,651	
G-169763	225845	150.00	0	Supplemental Well
G-169866	224583	150.00	0	Hail
G-170249	228482	150.00	34,640,357	
G-170384	228390	150.00	56,308,435	
G-170397	222559	150.00	13,887,370	Supplemental Well
G-170400	226797	150.00	20,092,059	
G-171454	229850	150.00	4,225,032	Supplemental Well
G-171471	229476	150.00	11,763,800	
G-171948	228629	150.00	34,078,270	
G-172064	227073	150.00	0	Supplemental Well
G-172337	230621	150.00	4,912,158	Supplemental Well: Hailed
G-172642	226828	150.00	15,422,657	Supplemental Well
G-172798	230409	150.00	8,095,693	Supplemental Well
G-173699	230989	150.00	34,515,449	
G-174251	230397	150.00	5,279,280	Supplemental Well
G-174557	230623	150.00	18,778,620	
G-174591	234579	150.00	5,832,679	Supplemental Well
G-174932	232741	150.00	8,525,812	
G-175697	235514	150.00	24,954,526	
G-175830	235770	150.00	2,044,424	Hail
G-175946	231156	150.00	7,473,595	
G-175949	236660	150.00	16,048,828	
G-176126	235952	150.00	5,806,883	Supplemental Well
G-176401	236745	150.00	10,202,572	
G-177578	239253	150.00	8,532,601	
G-178033	240120	150.00	6,384,448	Supplemental well
G-178903	240974	150.00	23,330,445	alfalfa
G-186194	254285	150.00	9,985,600	Well used to fill Pond

**Appendix B: Tri-Basin NRD Platte Basin Flowmeter Data for Irrigation Wells - 2024**

Well Reg	Well ID	Irrigated acres	Gallons Used	Meter Comments
G-186486	254490	150.00	28,598,864	Fills duck pond
G-187210	256486	150.00	16,561,224	
G-187945	257218	150.00	115,026	corn & pumpkins
G-188663	257035	150.00	2,666,523	Hail -Used mostly Surface Water
G-189345	259680	150.00	39,776,100	
G-189407	247403	150.00	17,199,067	
G-194313	268259	150.00	31,301,300	
G-194826	269694	150.00	13,181,637	Supplemental Well
G-197276	272202	150.00	34,107,868	
G-197292	272201	150.00	48,075,614	
G-197341	273395	150.00	12,207,352	
G-197342	269766	150.00	609,700	
G-197643	271393	150.00	41,950,486	
G-198584	273673	150.00	14,002,503	Estimated Usage -New well 2023, Supplemental to G-037262+AH209
G-198947	269521	150.00	0	Supplemental Well; Meter on in 2025
G-199899	275044	150.00	20,664,194	

63,918.65      11,229,665,930

**7.02      IPA**

**34,329.785      Acre Foot**

New data system uses certified acres vs actual acres \* Therefore there is no county breakdown or summary.

Appendix C: Phelps Canal Recharge Map

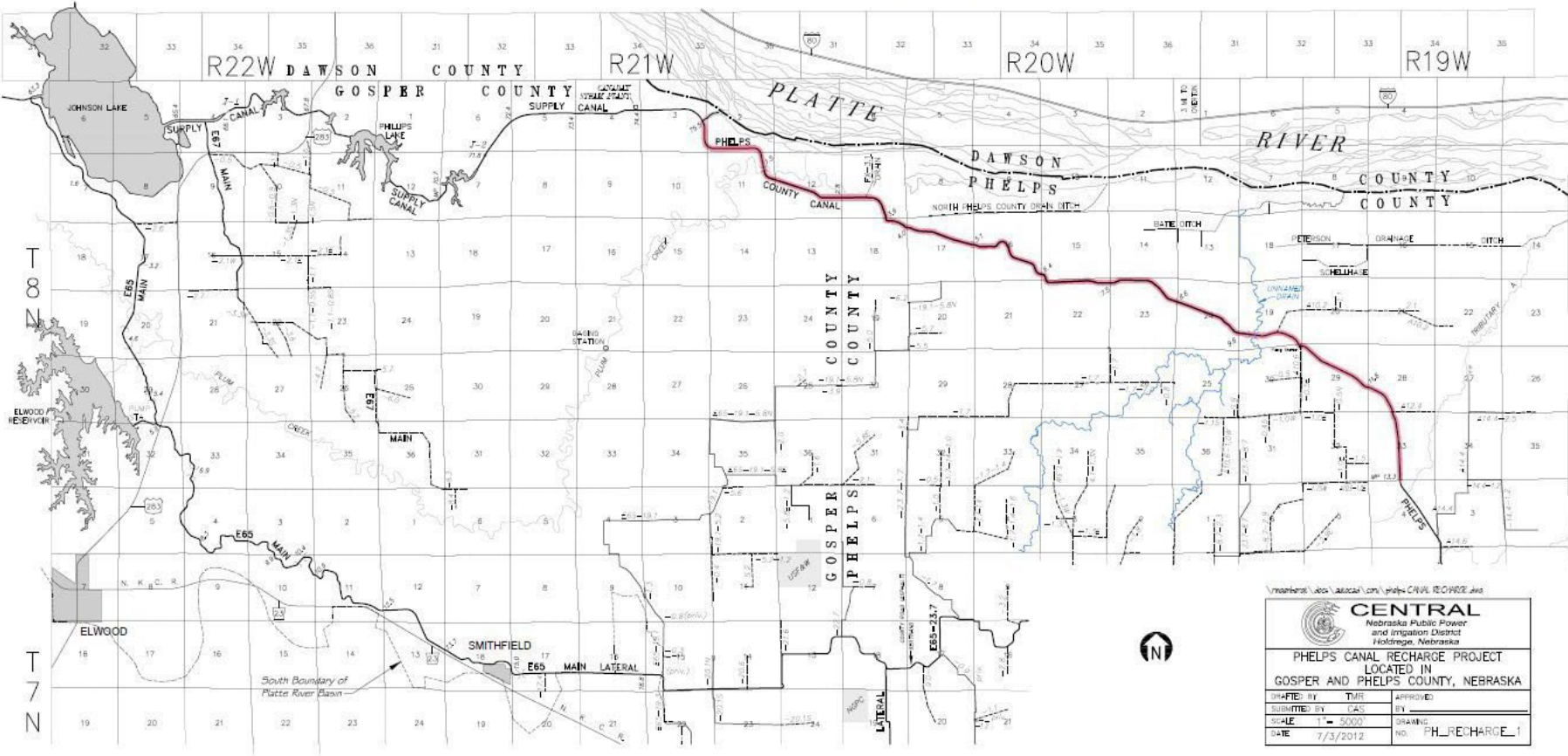



## Appendix C: Elwood Reservoir & E65 Canal Recharge Map

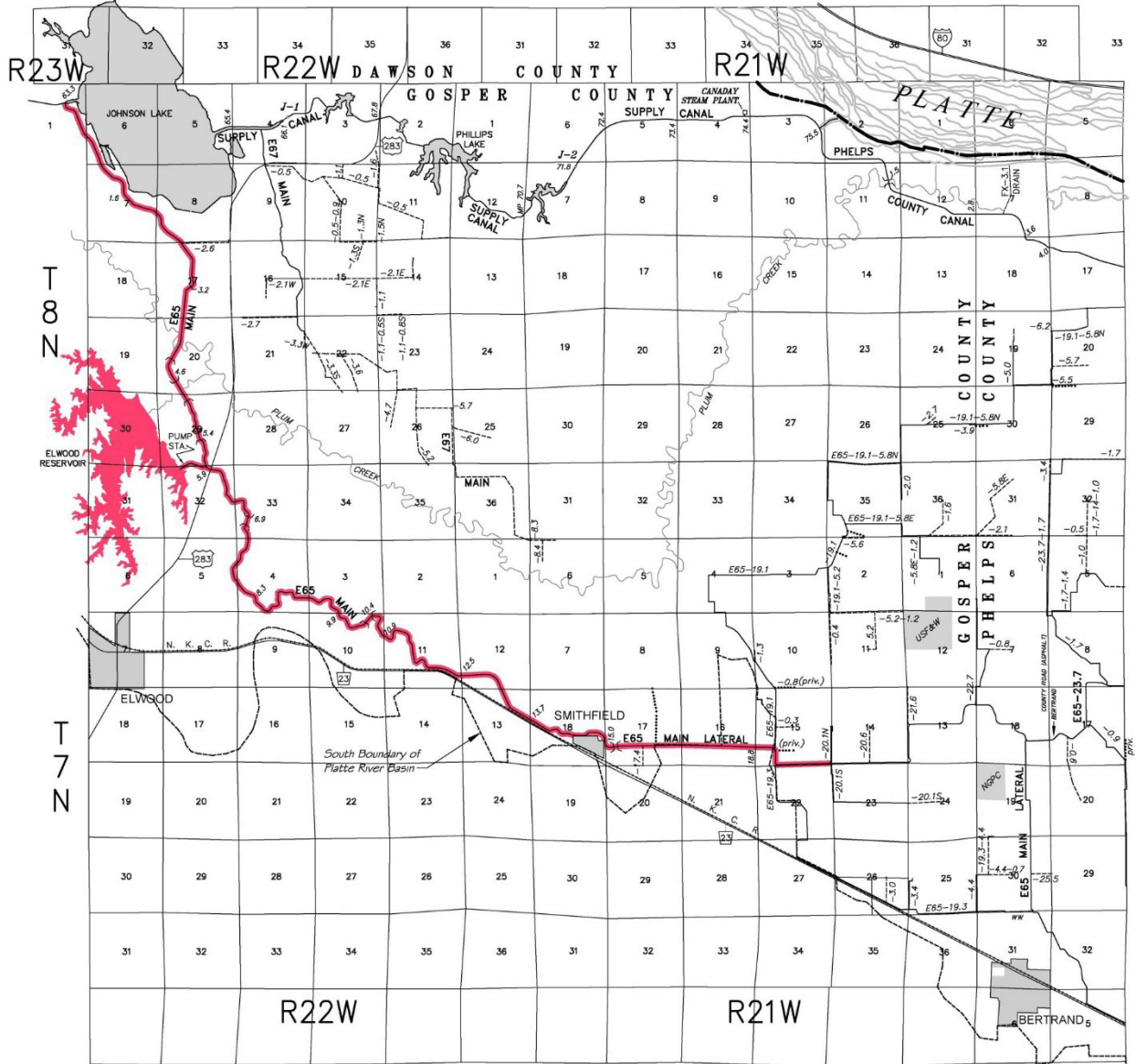

### LEGEND

— EXCESS FLOWS RECHARGE

\\ringenberg\docs\autocad\copy\elwoodRes-E65-201~.dwg



**CENTRAL**  
Nebraska Public Power  
and Irrigation District  
Holdrege, Nebraska

PLATTE RIVER EXCESS FLOWS FOR RECHARGE  
IN E65 CANAL & ELWOOD RESERVOIR,  
GOSPER COUNTY, NEBRASKA

DRAFTED BY	TMR	APPROVED	
SUBMITTED BY	DRF	BY	
SCALE	1" = 1.4 Mi.	DRAWING	
DATE	12/3/2014	NO.	RCHG_E65_DEC14

Appendix D: Wetland Recharge Project Map

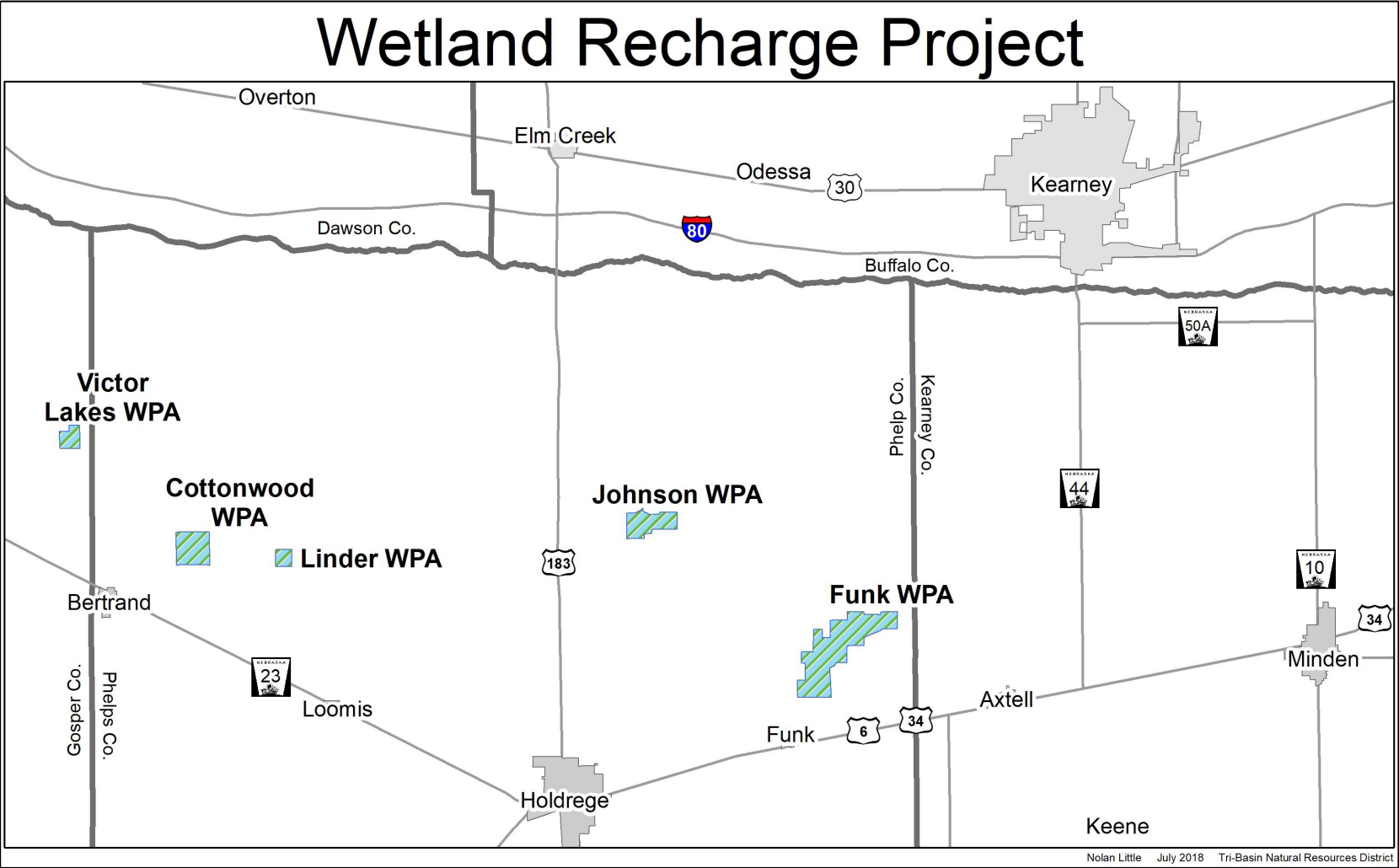

## **Appendix E: Tri-Basin NRD Water Conservation Incentive Program**

**Introduction:** Tri-Basin NRD launched the Water Conservation Incentive Program (WCIP) in March 2019. WCIP is intended to address two natural resources management issues: ensuring sustainability of groundwater supplies and protecting streamflows from diminishment due to groundwater pumping. When participating in the WCIP groundwater option, irrigators agree to accept an allocation on their certified irrigated acres in exchange for the NRD offering them flexibility on which acres they can irrigate. Financial incentives for water conservation are also available to participants.

The program was initially aimed at groundwater irrigators. One of the main benefits that is anticipated is that it will encourage participants to be more efficient irrigators and help sustain groundwater supplies. We initially excluded Central Nebraska Public Power and Irrigation District (CNPPID) customers from the WCIP because the incentives set up for groundwater irrigators don't encourage conservation on commingled fields.

Tri-Basin wants to encourage irrigators who have parcels that have both surface water turnouts and groundwater wells (commingled parcels) to use canal water rather than groundwater on those fields to the greatest extent possible. This has the dual benefit of reducing groundwater pumping and increasing groundwater recharge. For this reason, we developed a "commingled" option for CNPPID customers. The Nebraska Department of Natural Resources pays 60% of the cost of landowner payments through the Water Resources Cash Fund, because they recognize the benefits of incentivizing irrigators to become more efficient and of utilizing surface water, when available, to reduce groundwater withdrawals and increase groundwater recharge.

**The Program:** Tri-Basin will allow landowners to enroll up to 8000 NRD-certified irrigated acres in the program. The enrollment period will be open until the program acre enrollment limit is reached. Once the enrollment limit is reached, water savings to the district could reach 650 acre-feet per year. Incentives in this program will likely be most attractive to landowners in phase two and phase three groundwater quantity management areas, so the water-use reductions should be greatest where the need is greatest (there are approximately 30,000 certified irrigated acres in Tri-Basin's phase two and phase three townships).

In exchange for their participation, landowners will be paid for the equivalent of one acre-inch of water credit per acre per year, with the opportunity to sell additional credits to the NRD at a set price. In addition to NRD purchases, landowners will have the opportunity to sell water credits on the open market at any agreed-upon price (private transactions require NRD board approval). Landowners will also be granted flexibility to irrigate any acres within enrolled parcels and to share (pool) allocations between parcels. Pooling agreements will be required to enable sharing allocations between parcels under different ownership.

**The Contract:** The NRD and the landowner will sign a five-year agreement. The groundwater option agreement commits the landowner to limiting water use (allocation) on parcels that they select. The allocation will be equal to the UNL average corn crop consumptive irrigation requirement, which is nine inches per acre per year in Kearney County, ten inches per acre per year in Phelps County and eleven inches per acre per year in Gosper County (allocation will be limited to current allocation of nine inches per acre per year in Union Township in Gosper County). Landowners are required to have flowmeters installed on all wells serving participating parcels and to report water use annually to the NRD. Tri-Basin NRD offers cost share on flowmeters for participants. Tri-Basin NRD spot checks flowmeter readings on 20% of participating parcels annually. As a condition of their participation, landowners agree to subject enrolled parcels to (most of) the same rules that apply to all landowners in Phase three groundwater quantity management areas.

In exchange for their participation, the NRD agrees to buy one acre-inch per acre per year from every acre enrolled in the contract. Landowners have two payment options: an annual payment of \$5 per acre-inch credit for one acre-inch per year, or payment at the end of the contract period for up to five acre-inches of credits per acre (assuming the landowner has that much unused allocation) at a rate of \$4 per acre-inch. The NRD may also choose to purchase additional credits from participants. NRD purchases of additional

acre-inches will be prioritized in Groundwater Quantity Management Phase 2 and Phase 3 areas and 50%+ stream depletion zones. The NRD will have the right of first refusal to purchase unused allocations from landowners, so landowners would need NRD board approval before they make private sales.

Landowners will also have the option to irrigate any and all acres within participating parcels. They can also pool allocations between parcels under the same ownership (pooling water credits associated with parcels under different ownership, but the same management will require a separate NRD-approved pooling agreement). Pools are only allowed for multiple parcels in the same basin and with the same groundwater quantity management phase status. Water use will be deducted from landowner water credit "accounts."

If a producer overuses their allocation, they need to purchase credits from other landowners to eliminate their deficit. Otherwise, they will be prohibited from irrigating enrolled parcels until the deficit is eliminated. The only way a landowner can cancel a contract would be to pay the NRD for the full contracted amount (refund any payments that the NRD has already made and pay the NRD the amount we would have paid them at the end of the contract period).

**Commingled Option:** A different approach is needed to incentivize surface water use. We need to incentivize commingled water users to use canal water rather than groundwater. CNPPID customers and landowners with individual surface water rights are eligible to enroll commingled parcels in five year contracts. Participants will be reimbursed by Tri-Basin NRD for the equivalent of the cost per acre of CNPPID water delivery, with the understanding that payments will be reduced by \$6 per acre inch of groundwater used in excess of one inch per acre during the contract period. If, however, CNPPID is unable to deliver the full amount of contracted water to a parcel for any reason, a landowner will be allowed to pump groundwater without penalty to make up the difference between what CNPPID is able to deliver and the full contract amount.

CNPPID charges \$42.00 to deliver nine inches of water to their irrigation customers (2024). Their prices are subject to annual increases. Tri-Basin will pay incentives to landowners based on the current delivery rate at the time of enrollment in WCIP, but payment rates won't be increased during the contract period if CNPPID raises rates.

WCIP incentives will be paid on CNPPID contracted acres. Because NRD funds are limited, we will initially approve contracts for 8000 acres. Because applications exceed the number of acres allowed for enrollment, applications are selected for approval using a ranking system.

The WCIP commingled option requires annual reporting of groundwater use. As of 2018, only 15,597 commingled acres (TBNRD definition) have flowmeters in place and are reporting water use to Tri-Basin NRD. Applications from landowners with flowmeters currently in place are favored in the ranking system.

Parcels in which CNPPID water service contracts are in the process of cancellation are not eligible for enrollment. Landowners are allowed to enroll additional acres on existing CNPPID water service contracts. Individual landowners are limited to enrolling a total of no more than 320 acres in the WCIP. In the case of fields with fewer CNPPID contract acres than NRD-certified irrigated acres, landowners need to agree to have seals installed on valves or risers that would enable use of groundwater on CNPPID contract acres. If the seals are broken, recorded groundwater use will be divided among all NRD-certified irrigated acres.

If you are interested in enrolling in WCIP, please call the Tri-Basin NRD office at (308) 995-6688, or email us at [jthorburn@tribasinnrdr.org](mailto:jthorburn@tribasinnrdr.org).

### Appendix E: Tri-Basin NRD Water Conservation Incentive Program [WCIP]

Type of Contract	Contract Period	Contract Credits [total inches]	Basin
Co-Mingled	2020-2024	255.00	Platte
Co-Mingled	2020-2024	130.00	Platte
Co-Mingled	2020-2024	149.00	Platte
Co-Mingled	2020-2024	150.00	Platte
Co-Mingled	2020-2024	142.00	Platte
Co-Mingled	2020-2024	140.00	Platte
Co-Mingled	2020-2024	147.00	Platte
Co-Mingled	2020-2024	148.38	Platte
Co-Mingled	2020-2024	287.10	Platte
Co-Mingled	2020-2024	149.00	Platte
Co-Mingled	2020-2024	123.86	Platte
Co-Mingled	2020-2024	123.00	Platte
Co-Mingled	2020-2024	135.00	Platte
Co-Mingled	2020-2024	150.00	Platte
Co-Mingled	2020-2024	300.86	Platte
Groundwater	2021-2025	125.20	Platte
Groundwater	2021-2025	132.43	Platte
Co-Mingled	2021-2025	142.00	Platte
Co-Mingled	2021-2025	144.00	Platte
Co-Mingled	2021-2025	127.00	Platte
Co-Mingled	2021-2025	128.00	Platte
Groundwater	2022-2026	136.36	Platte
Co-Mingled	2022-2026	93.14	Platte
Groundwater	2023-2027	136.16	Platte
Co-Mingled	2024-2028	150.00	Platte
Co-Mingled	2024-2028	144.00	Platte
Co-Mingled	2024-2028	136.00	Platte
Co-Mingled	2024-2028	120.00	Platte

