

2021 Annual Report of Integrated Water Management Activities in the Platte Basin Within Tri-Basin NRD



1723 Burlington Street
Holdrege, Nebraska 68949
(308) 995-6688
www.tribasinnrd.org
email: tribasin@tribasinnrd.org

June 2022

**ANNUAL REPORT OF WATER USE ACTIVITIES
IN THE PLATTE BASIN WITHIN TRI-BASIN NRD
TO MEET THE REQUIREMENTS OF THE JOINT INTEGRATED MANAGEMENT PLAN
FOR THE 2021 BASIN-WIDE MEETING**

I. SUMMARY

The purpose of this report is to convey information that Tri-Basin Natural Resources District (TBNRD) agreed to supply to the State of Nebraska as part of a joint Integrated Management Plan for the fully and over-appropriated portions of the Platte River Basin.

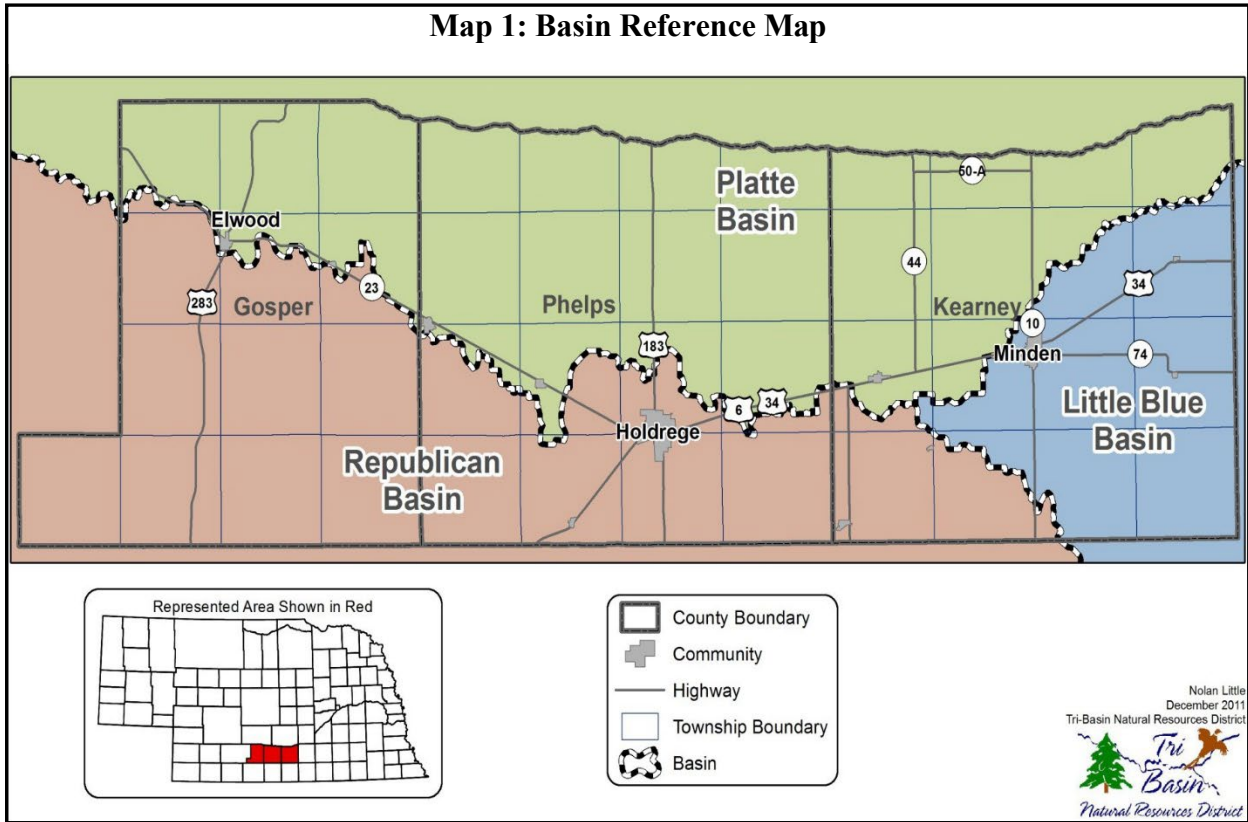

II. INTRODUCTION

TBNRD encompasses portions of the Republican, Platte, and Little Blue River Basins (see **Map 1**, above). The district also contains an area commonly referred to as the “Groundwater Mound” spanning portions of all three basins, that is characterized by groundwater levels that are higher than historic, “predevelopment,” groundwater elevations.

More than 100,000 acres of cropland within the Platte Basin portion of TBNRD are irrigated with water diverted from the Platte River and distributed through the canals of the Central Nebraska Public Power and Irrigation District (CNPPID). Surface irrigation water and the canals that distribute it enhance recharge of groundwater supplies within the district. In addition to helping sustain groundwater supplies, this incidental recharge has increased streamflows in Platte and Republican tributaries. High groundwater levels have also saturated soil and sub-soil in parts of northern Phelps and Kearney counties, requiring TBNRD to construct drainage ditches (Improvement Project Areas or IPAs) in an attempt to stabilize groundwater levels below the crop root zone. For this reason, the TBNRD has designated portions of the Platte Basin as a “High Groundwater Management Area” pursuant to TBNRD rule 8.6 for purposes of groundwater quantity management.

III. CERTIFIED IRRIGATED ACRES

The district began certifying irrigated acres in the Platte Basin in 2004. The initial certification process in the Platte Basin ended on June 15, 2006. Since that time, corrections and revisions to the certified acre database have occurred with a net result as of December 31, 2021, of 299,322.96

certified acres in the Platte Basin within TBNRD. Data regarding certified irrigated acres can be found in **TABLE 1** below. Commingled acres are acres that may be watered with either groundwater or surface water. Detailed information about locations and distribution of certified irrigated acres is available in the Tri-Basin NRD office.

Table 1: Platte Basin Certified Irrigated Acres			
County	Year	Commingled	Total Certified Acres
Gosper	2011	10,804.80	35,755.64
	2012	10,581.80	35,737.43
	2013	10,397.80	35,696.95
	2014	10,395.25	35,800.39
	2015	10,554.56	35,655.82
	2016	10,469.07	35,658.57
	2017	10,473.49	35,651.20
	2018	11,075.78	35,631.92
	2019	11,216.16	35,636.12
	2020	11,627.28	35,958.57
	2021	11,775.99	35,958.58
Phelps	2011	78,178.44	167,027.69
	2012	78,103.08	167,127.23
	2013	78,352.49	167,501.73
	2014	78,500.37	167,222.82
	2015	78,127.66	167,337.72
	2016	78,277.00	167,381.05
	2017	78,136.85	167,384.10
	2018	79,026.45	167,318.88
	2019	78,712.01	167,318.57
	2020	78,859.37	167,237.37
	2021	78,848.66	167,089.45
Kearney	2011	23,314.13	95,650.11
	2012	23,522.33	95,733.45
	2013	23,214.77	95,778.33
	2014	23,441.29	95,738.64
	2015	23,325.27	95,700.64
	2016	23,455.16	95,674.61
	2017	23,312.60	95,560.25
	2018	23,913.89	95,560.25
	2019	23,841.55	95,575.13
	2020	23,841.55	95,608.13
	2021	24,528.69	95,682.33
Basin Wide	2011	112,297.37	298,433.44
	2012	112,207.21	298,598.11
	2013	111,965.06	298,977.01
	2014	112,336.91	298,761.85
	2015	112,007.49	298,694.18
	2016	112,201.23	298,714.23
	2017	111,922.94	298,595.55
	2018	114,016.12	298,511.05
	2019	113,769.72	298,529.82
	2020	114,328.20	298,804.07
	2021	115,153.34	299,322.96

IV. APPROVED CERTIFIED ACRE AND GROUNDWATER TRANSFERS

- A. TBNRD allows certified irrigated acres to be transferred from one parcel to another within the Platte Basin portion of the district, with some limitations. These limitations include a prohibition on transfers from the fully appropriated portion of the district to the over-appropriated area. Certified irrigated acres also cannot be transferred from parcels with surface water or commingled water resources to parcels that have groundwater wells as their only water source.

TABLE 2A: Platte Basin Transfer - Acres at Original Locations		
NRD Permit Number	Legal Description	Acres Dried Up
TBAT-0359	Section 2-6- 17W	15.20
TBAT-0361	Section 15-8- 17W	30.00
TBAT-0367	Section 15-8- 17W	25.00
TBAT-0368	Section 15-8- 17W	20.00
TBAT-0369	Section 15-8- 17W	9.00
TBAT-0372	Section 15-8- 17W	7.67
TBAT-0373	Section 14-8- 17W	5.33
TBAT-0374	Section 14-8- 17W	4.00
TBAT-0375	Section 14-8- 17W	20.00
TBAT-0376	Section 14-8- 17W	21.00
TBAT-0377	Section 14-8- 17W	3.00
TBAT-0378	Section 14-8- 17W	14.00
TBAT-0382	Section 26-7- 19W	9.76
TBAT-0384	Section 14-8- 17W	8.79

Furthermore, district rules require that the number of certified acres that can be transferred be limited or “discounted” to ensure that there is not an increase in depletions to streamflows when acres are transferred from low to higher depletion zones. Between January 1 and December 31, 2021, the district approved 14 certified irrigated acre transfers in the Platte Basin. A total of 192.75 certified irrigated acres were involved in these transfers. Data regarding the location and number of acres associated with each transfers original location can be found above in **TABLE 2A** and the new locations are listed below in **TABLE 2B**.

TABLE 2B: Platte Basin Transfer - Acres at New Location		
NRD Permit Number	Legal Description	New Irrigated
TBAT-0359	Section 22-7- 16W	15.20
TBAT-0361	Section 27-8- 17W	30.00
TBAT-0367	Section 25-8- 15W	25.00
TBAT-0368	Section 23-8- 18W	20.00
TBAT-0369	Section 12-7- 17W	9.00
TBAT-0372	Section 6-7- 17W	7.67
TBAT-0373	Section 6-7- 17W	5.33
TBAT-0374	Section 5-7- 17W	4.00
TBAT-0375	Section 18-7- 16W	20.00
TBAT-0376	Section 3-7- 18W	21.00
TBAT-0377	Section 24-8- 17W	3.00
TBAT-0378	Section 16-7- 15W	14.00
TBAT-0382	Section 3-7- 20W	9.76
TBAT-0384	Section 6-7- 17W	8.79

- B. TBNRD regulates groundwater pumping off of overlying land by requiring landowners to secure groundwater transfer permits before they can pump groundwater to properties that are either not contiguous or under the same ownership. Groundwater transfer permits can only be used to

supply groundwater for irrigation of certified irrigated acres. Landowners are required to install flowmeters on wells that are permitted for transfers and to report pumping from these wells annually to the TBNRD. Two permanent groundwater transfer permits were issued in the Platte Basin between January 1, 2022, and December 31, 2021. TBNRD allows CNPPID customers to pump groundwater into canals to supplement surface water diversions when necessary. Such permits are temporary and must be renewed annually. Two Temporary Groundwater Transfer Permits were issued by TBNRD in 2021. Data regarding groundwater transfers can be found in **Table 3** below.

TABLE 3: Groundwater Transfers					
NRD Permit Number	Legal Description	Acres	Well Reg Number	Well ID #	Transfer Type
GWT-0349	Section 28-8- 19W	7.00	G-032221	39204	Permanent
GWT-0350	Section 28-8- 19W	14.00	G-032221	39204	Permanent

V. WELL CONSTRUCTION PERMITS

A. Since 1989, TBNRD has required landowners to secure well construction permits before they drill wells capable of pumping more than 50 gallons per minute. The district issues three categories of well permits: new well permits, conditional replacement well permits, and replacement well permits.

TBNRD requires landowners to agree to several conditions on the operation of new wells and conditional replacement wells before permits are issued. These conditions are listed in an agreement that is signed by landowners when they apply for these types of well permits. A copy of that agreement is attached to this report as **Appendix A** (page 13).

TABLE 4: TBNRD Well Permits	
Well Permit Type	Permits
New (variance) irrigation	
Replacement irrigation	4
Conditional replacement irrigation - supplemental to groundwater	
Conditional replacement irrigation - supplemental to surface water	
Dewatering (streamflow augmentation)	7
New commercial/industrial	
Domestic/Other (over 50 gpm)	

B. **TABLE 4:** TBNRD Well Permits (above) is a breakdown of well permits that TBNRD issued in the Platte Basin between January 1, 2021, and December 31, 2021. A detailed listing of well permits issued by TBNRD in 2021 is found in **TABLE 5** (below).

TABLE 5: Well Permit Summary				
NRD Permit Number	Well Permit Type	Legal Description	Well Reg Number	Well ID
TBRP-G070512-R1	Replacement	Section 22-7- 16W	G-070512	264615
TBRP-G039190-R1	Replacement	Section 31-8- 19W	G-039190	265700
TBDW-1533	Dewatering	Section 9-8- 19W	TBDW-1533	NA
TBDW-1534	Dewatering	Section 9-8- 19W	TBDW-1534	NA
TBDW-1535	Dewatering	Section 10-8- 19W		266795
TBDW-1536	Dewatering	Section 14-8- 19W		266798
TBDW-1537	Dewatering	Section 11-8- 19W		266803
TBDW-1538	Dewatering	Section 11-8- 19W		266804
TBDW-1539	Dewatering	Section 17-8- 19W		266814
TBRP-G-033717-R1	Replacement	Section 34-8- 18W	G-033717	267330
TBRP-G026414-R1	Replacement	Section 11-7- 18W	G-026414	267392

VI. VARIANCES

TBNRD issues new well permits to landowners of parcels that do not have a prior irrigation history only after they have transferred sufficient certified irrigated acres to the previously dryland parcel for the intended new use. The TBNRD Board must approve a variance to the rule prohibiting new well construction before new well permits can be issued. No new irrigation well construction permit variances were issued in the Platte Basin between January 1, 2021, and December 31, 2021.

TBNRD allows for corrections to the district's certified irrigated acre database by providing proof showing a history of irrigation between 1997 and 2005. These acres were not previously included in the district's database, because they were not classified as irrigated cropland by county assessors. Beginning in October 2013, producers also had to show proof that the corrected acres had been watered three out of the past five years. TBNRD also adjusts the district's irrigated acre database as a result of revisions made by county assessors to taxable irrigated acres. Additions or reductions of taxable irrigated acres of four acres or less are automatically accepted by the district. Larger additions or reductions must be reviewed by the NRD board before they are approved. Eight well variances were issued in the Platte Basin in 2021. One for a livestock conversion and seven for well spacing on augmentation wells.

VII. MUNICIPAL AND INDUSTRIAL ACCOUNTING

TBNRD collects water use data annually from all municipalities and industries within the district. Municipal and industrial water use data for communities and industries located in the Platte Basin reported to TBNRD in 2021 is shown in the next two tables. A summary of Municipal Water Use may be found in **TABLE 6** (page 9) and Industrial and Commercial Water Use in **TABLE 7** (page 11).

VIII. FLOWMETER DATA

TBNRD requires flowmeters to be installed and annual water use to be reported to TBNRD whenever landowners drill new wells, receive irrigation-related cost-share funds, or when groundwater is transferred from one property to another.

In 2021, landowners reported data from 508 flowmeters in the Platte Basin. Thirty-seven of those 508 wells were reported as not used in 2021. An additional 25 supplemental wells that were used reported were little use generally 1 or 2 rotations. Of the wells that were used, farmers reported that they pumped 34,335 acre-feet of groundwater on 56,234 certified irrigated acres. That results in average application of 7.33 acre-inches of groundwater per acre.

Due to the installation of additional reporting flowmeters and depending on use of supplemental irrigation wells by CNPPID customers, flowmeter data and reported irrigated acres change from year to year. All District flowmeter data is reported annually to the Department of Natural Resources (DNR) for purposes of Republican River Basin Compact Administration accounting. Platte Basin flowmeter data is included in **Appendix B** (page 15).

IX. WATER BANKING ACTIVITIES

TBNRD initiated the Water Conservation Incentive Program (WCIP) in 2018 (see program summary in **Appendix G**, page 58). Participants in this program sign contracts agreeing to limit irrigation to the UNL Average Corn Crop Irrigation requirement. In exchange, Tri-Basin NRD agrees to pay them if they use less water than their allocated amount. Participants will be provided with credit accounts that track available water use credits for participating fields. Sign-up for the 2021 irrigation season concluded on April 1st. Tri-Basin received two applications for groundwater WCIP contracts in the Platte Basin in 2021 for 257.63 acres.

A "commingled option" was added to the WCIP in 2019 (see program expansion summary in **Appendix H**, page 60). This option is particularly targeted at owners of fields that have access to both CNPPID canal water and a groundwater well. Owners of these commingled fields who sign up for this option are incentivized to use surface water and limit their groundwater use to one inch or less per acre per year. The purpose of this option is to increase groundwater recharge. For this reason, the option has a ranking system that prioritizes incentives to parcels located in areas with groundwater declines. Four new contracts for 541 acres were offered five-year contracts for this option. They began during the 2021 irrigation season. At the end of 2021 a total of 3074.2 acres were in commingled WCIP contracts.

X. STREAMFLOW ACCRETION ACTIVITIES

Tri-Basin NRD started utilizing the facilities of Central Nebraska Public Power District (CNPPID) to provide groundwater recharge and to augment streamflows when the district and the NE Game

and Parks Commission paid CNPPID to divert 9551 acre-feet of water from the Platte River into Elwood Reservoir in Gosper County in 2006. Additional diversions (see **Appendix D**, page 45, and **Graph 1**, below) have been made regularly over the past twelve years, including 2021, when NDNR and TBNRD paid CNPPID \$188,110 to divert 6646 acre-feet into Elwood Reservoir, Victor Lakes WPA and E-65 Canal. Diversions in 2018, when added to past diversions, result in a grand total of 121,526 acre-feet of water diverted from 2006-2021. In all these instances, diversions were made when Platte streamflows exceeded target flows, or when irrigation deliveries were suspended due to heavy rainfall in the CNPPID irrigated area.

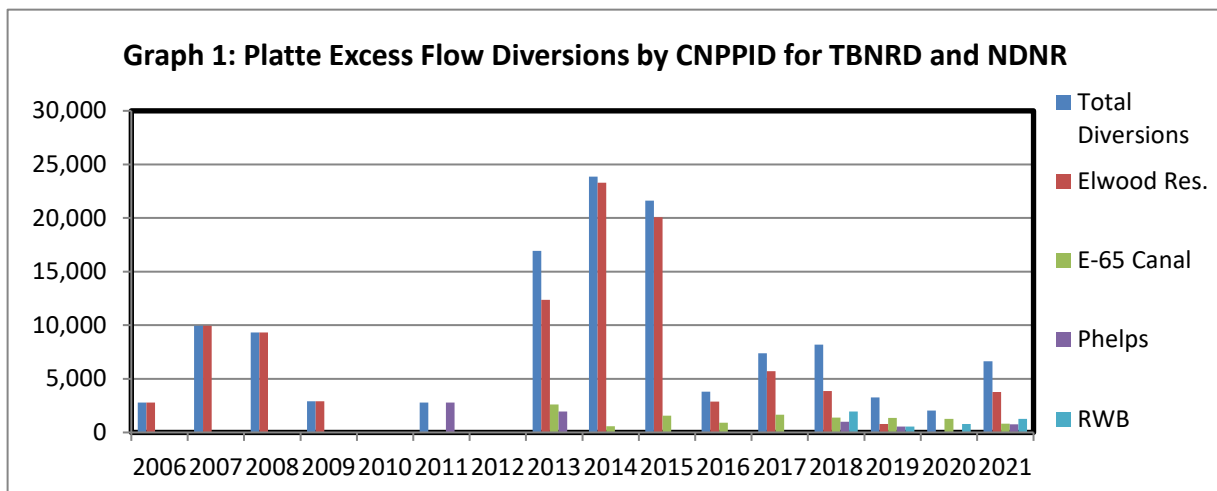

Tri-Basin NRD and NeDNR provided \$1,301,775 of local, state and Water Resources Cash Funds to the Rainwater Basin Joint Venture and CNPPID to construct pipelines from CNPPID canals to five federally-owned wetlands (Victor Lakes, Cottonwood, Linder, Johnson, and Funk WPAs). (See **Appendix E**, page 56) This enables CNPPID to deliver excess flows to these wetlands. Supplementing natural runoff with Platte excess flows enhances wildlife habitat and increases groundwater recharge, which helps offset groundwater pumping depletions, sustains groundwater supplies and augments baseflows in nearby Platte tributaries. The pipeline to Funk WPA was completed in 2018 and over 1950 acre-feet were diverted into that wetland in November and December 2018. The remaining pipelines were constructed in 2019. Excess flows were diverted into Johnson WPA in April 2019 (252 a-f) and into Victor Lakes WPA in December 2019 to January 2020 (1090 a-f). (See **Appendix E**).

The Platte River Recovery Implementation Program (PRRIP) paid CNPPID to divert 19,173 acre-feet of water into the Phelps County Canal in 2012. Since then, PRRIP has made additional diversions on several occasions when the Platte is flowing above target levels (see **Appendix D**, page 45). While recharge resulting from these diversions cannot be used as a credit to offset depletions to Platte baseflows from post-1997 uses, Tri-Basin NRD anticipates that they will be credited toward reducing depletions to fully appropriated levels.

Tri-Basin NRD completed construction of a streamflow augmentation well along North Dry Creek in Kearney County in 2011. A second well was installed in 2015. The wells can each pump as much as 1250 gallons per minute. A study of the augmentation wells' impacts, conducted by HDR Engineering in 2014 and commissioned by TBNRD and DNR, indicates that the average depletion caused by pumping augmentation well #1 over a 25-year period is equivalent to 44% of total pumping (see **Graph 2**, on the next page). Augmentation well pumping and resulting estimated offset credit is described in **Appendix F** on page 57. Pumping by augmentation wells also has an ancillary benefit of providing forage fish habitat during extreme drought conditions.

Tri-Basin NRD also accrued credit for 278.31 acre-feet of water pumped into the Platte River near Kearney in 2021 through a wastewater pipeline from the KAAPA ethanol plant near Axtell. This pipeline was constructed in 2008. The total discharge was 90,688.0 gallons.

Irrigated land was temporarily retired in TBNRD during 2021 through one contract totaling 1.20 irrigated acres that were signed up for USDA-EQIP Dryland Corners.

Landowners reported to TBNRD on district Groundwater Quality Management Area crop reports that conservation tillage practices have been adopted or continue to be utilized on 85,890.1 certified irrigated acres in the Platte Basin portion of the district during 2021 (see **Appendix C**, page 27). It is estimated that no-till or minimum tillage practices have been adopted on at least

102,014 irrigated acres in the Platte Basin portion of the district. Recent university research (Klocke, et al, 2009) indicates that evapotranspiration (ET) is reduced by as much as 3 inches per acre on irrigated cropland, as compared to conventional tillage systems. Therefore, as much as 25,504 acre-feet of water was conserved in the Platte Basin in TBNRD in 2021 through this conservation practice.

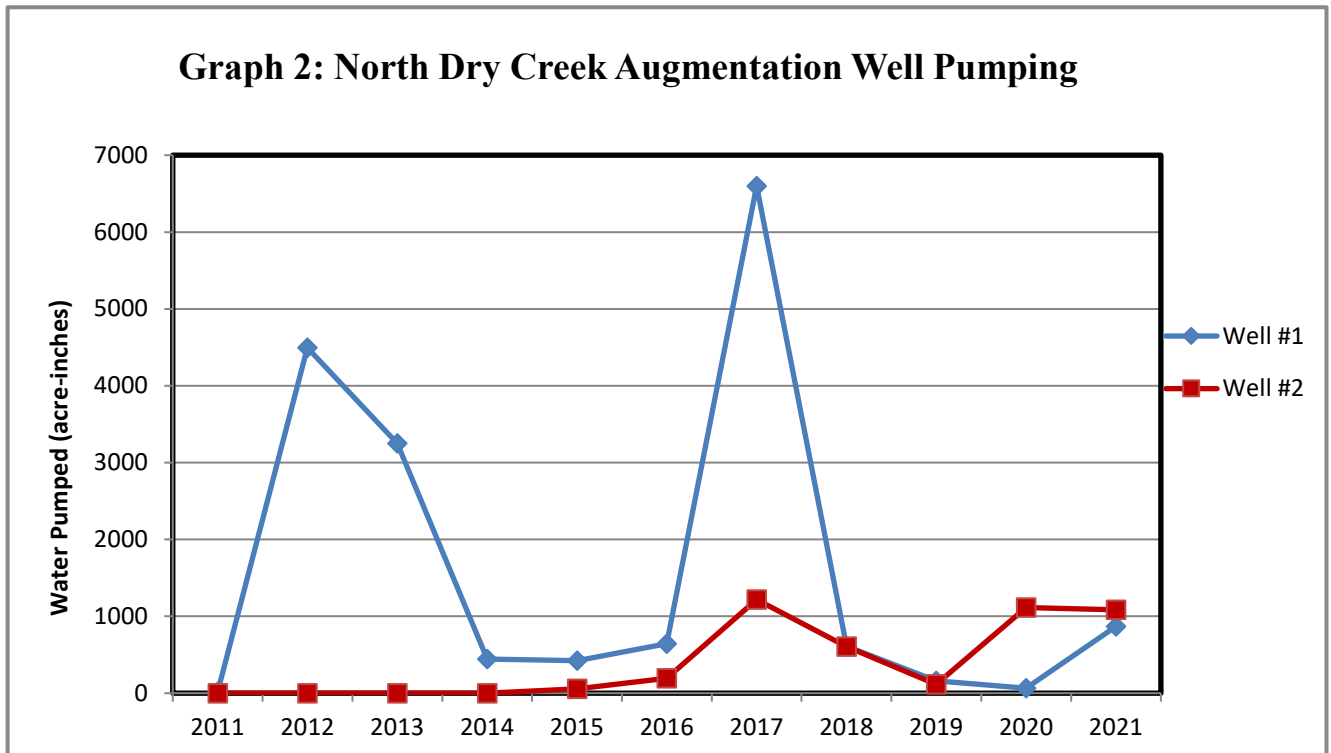

Tri-Basin NRD signed agreements with DNR, Central Platte NRD (CPNRD) and Twin Platte NRD to participate in funding the proposed “J-2 Re-regulation Reservoir” project southwest of Overton, Nebraska. It was anticipated that this reservoir would store up to 8000 acre-feet of water, and that it would fill as often as three times per year. Funding for the project was suspended by the PRRIP in 2016. Tri-Basin NRD and other project partners are evaluating possible feasible alternatives to this project. Tri-Basin NRD has accrued 2040 acre-feet per year of depletion offset credit from its participation in this project. This credit remained in place through 2021.

Tri-Basin NRD and Central Platte NRD reached an agreement in 2013 that will enable TBNRD to compensate CPNRD in return for accruing credit from Platte baseflow enhancements that result from rehabilitation of three irrigation canal systems in Dawson County. In 2014, CPNRD provided 512 acre-feet of water to offset depletions caused by groundwater irrigation in TBNRD. No offset water credit has been provided under this agreement since that time, but the agreement remains in effect until 2033.

Tri-Basin NRD signed an agreement with PRRIP to construct and operate a series of seven streamflow augmentation wells in the vicinity of PRRIP’s Cottonwood Ranch Groundwater Recharge and Retiming Project. Well and pipeline construction commenced in October 2021. The project is expected to be operational by May 2022.

XI. GROUNDWATER LEVELS

TBNRD has an extensive network of 137 dedicated groundwater observation wells (74 in the Platte Basin) and 91 irrigation wells (ten in the Platte Basin) that are used to measure groundwater levels (see **Map 2**, page 12). TBNRD also works cooperatively with CNPPID to gather groundwater level data. Data from 158 wells measured by CNPPID are included in TBNRD’s groundwater observation well database. District water level data is reported biannually to U.S. Geological Survey and UNL-Conservation and Survey Division. Groundwater level data for the district is available from the Tri-Basin NRD office.

TABLE 6: Platte Basin Municipal Water Use Data

	Year	January	February	March	April	May	June	July	August	September	October	November	December	Yearly Total
Axtell	2011	3,708,500	3,301,900	3,649,000	3,742,000	5,305,600	7,600,700	11,452,600	8,907,600	7,459,200	5,677,900	3,018,200	3,111,100	66,934,300
	2012	3,124,800	3,104,600	4,241,500	5,751,800	11,685,400	14,211,000	22,110,800	12,040,400	12,675,900	5,713,700	3,274,500	2,878,000	100,812,400
	2013	2,923,900	2,395,100	2,530,000	3,195,600	8,260,800	11,960,000	19,418,700	11,170,400	9,955,100	5,558,900	2,753,300	2,495,500	82,617,300
	2014	2,653,500	2,359,000	2,740,400	3,836,900	7,461,100	7,534,900	12,794,400	8,925,000	5,467,700	5,640,300	2,475,500	2,180,300	64,069,000
	2015	2,282,900	2,027,700	4,393,300	4,318,200	4,664,300	5,876,500	12,441,200	10,301,700	10,976,400	7,525,900	4,008,900	2,699,700	71,516,700
	2016	2,379,000	2,755,600	3,040,700	4,168,700	3,985,900	13,891,900	14,882,100	11,692,100	9,021,300	7,816,500	3,537,100	2,310,600	79,481,500
	2017	2,288,000	1,988,100	2,493,500	3,609,100	4,904,500	14,414,100	14,784,100	7,672,900	10,143,900	3,942,000	2,797,400	2,430,100	71,467,700
	2018	2,487,000	2,289,700	2,421,700	2,379,200	6,946,500	12,633,200	9,746,700	8,058,000	6,823,000	3,239,900	2,139,300	2,421,400	61,585,600
	2019	2,457,000	2,265,400	2,411,600	2,931,200	4,443,300	6,385,100	9,487,000	7,732,400	7,671,600	3,046,500	2,241,100	2,209,400	53,281,600
	2020	2,259,900	2,092,600	2,132,000	4,100,500	7,021,600	11,247,200	16,882,800	16,333,800	11,553,300	7,813,600	2,668,700	2,185,500	86,291,500
	2021	2,299,800	2,258,300	2,262,600	3,861,500	5,424,400	13,903,400	11,587,900	10,636,800	8,164,300	5,333,900	2,118,100	2,194,200	70,045,200
Bertrand	2011	4,234,000	3,655,000	3,876,000	4,307,000	7,316,900	9,301,200	15,651,200	12,540,800	9,397,600	7,050,000	3,945,000	4,152,000	85,426,700
	2012	3,575,000	3,348,000	3,846,000	6,122,000	13,410,700	17,711,000	27,282,900	14,707,500	15,511,100	8,976,000	5,261,000	3,970,000	123,721,200
	2013	4,002,000	3,571,000	3,533,000	3,858,000	10,671,200	15,688,200	23,473,500	17,540,600	14,850,200	6,406,000	3,852,000	4,288,000	111,733,700
	2014	4,422,000	3,817,000	4,069,000	4,949,000	11,419,500	8,539,000	16,089,200	11,456,000	7,427,000	8,972,000	4,710,000	4,114,000	89,983,700
	2015	4,294,000	3,807,000	6,038,000	8,605,000	8,294,500	9,873,100	21,287,600	15,234,800	15,246,600	9,881,500	4,519,000	3,981,000	111,062,100
	2016	4,467,000	4,003,000	4,548,000	8,925,400	6,381,000	14,827,300	14,993,000	15,371,700	11,076,700	11,481,000	7,061,000	5,398,000	108,533,100
	2017	5,477,000	4,266,000	4,763,000	8,036,000	6,728,100	19,708,400	17,701,100	10,483,000	13,751,700	6,601,200	4,552,000	5,166,000	107,233,500
	2018	5,215,000	4,682,000	4,490,000	4,829,700	9,412,811	14,385,000	12,214,100	11,105,700	10,056,700	5,838,400	4,190,000	4,154,000	90,573,411
	2019	4,243,000	3,856,000	3,948,000	4,824,400	7,114,600	8,675,000	12,384,000	11,275,600	10,606,100	6,878,400	4,301,000	4,663,000	82,769,100
	2020	4,637,000	4,169,000	4,148,000	6,121,100	9,069,400	15,119,000	19,730,300	20,081,700	16,261,800	11,846,800	5,379,000	5,259,000	121,822,100
	2021	5,592,000	5,206,000	5,170,000	6,432,000	8,712,700	17,522,700	14,316,300	16,740,400	10,647,600	9,763,000	5,140,000	5,656,000	110,898,700
Elwood	2011	4,490,000	3,277,000	4,745,000	4,930,200	7,990,000	10,787,000	9,682,800	17,946,300	7,851,600	8,301,000	5,195,900	3,483,000	88,679,800
	2012	4,278,000	3,324,500	5,774,700	4,184,000	16,881,600	22,944,600	30,825,300	20,347,800	15,277,100	9,352,300	4,511,400	4,061,900	141,763,200
	2013	5,223,600	4,535,500	5,299,500	6,824,000	4,795,500	14,776,000	28,116,000	17,587,000	13,151,900	5,936,800	4,311,200	3,800,900	114,357,900
	2014	3,729,600	4,188,000	4,915,000	4,968,000	12,601,700	10,104,800	20,316,600	15,146,100	9,033,400	6,043,600	3,827,000	4,682,500	99,556,300
	2015	3,067,700	3,531,000	6,951,100	5,160,200	6,668,600	10,586,900	19,270,800	11,772,800	10,001,500	6,784,900	3,373,000	3,468,000	90,636,500
	2016	3,467,900	3,235,000	3,817,300	5,768,000	5,770,000	14,979,700	13,372,200	15,078,400	9,390,000	11,215,400	3,825,000	4,302,000	94,220,900
	2017	4,283,600	4,994,000	4,074,900	6,153,800	12,262,600	12,577,800	17,753,700	10,229,900	12,605,600	4,944,800	3,536,900	3,677,000	97,094,600
	2018	4,439,000	3,754,000	3,928,200	4,162,000	9,938,200	15,358,800	12,971,100	9,499,900	8,555,000	6,843,000	4,364,000	6,179,000	89,992,200
	2019	6,389,000	6,027,000	6,875,000	5,885,000	8,496,700	8,583,700	11,223,200	8,537,900	12,192,000	3,265,000	4,452,000	4,740,000	86,666,500
	2020	5,705,000	3,048,000	5,440,000	6,627,900	9,726,000	14,016,100	16,005,900	12,192,100	15,980,600	8,310,700	4,039,000	5,431,900	106,523,200
	2021	4,970,000	3,165,000	4,758,000	5,572,300	7,655,000	17,342,800	16,254,200	15,234,800	11,136,000	8,213,500	5,750,400	5,631,700	105,683,700

TABLE 6: Platte Basin Municipal Water Use Data (Continued)

	Year	January	February	March	April	May	June	July	August	September	October	November	December	Yearly Total
Funk	2011	1,530,000	1,241,000	1,410,000	1,510,000	2,081,000	2,666,000	2,833,000	2,656,000	2,614,000	1,732,000	1,500,000	1,630,000	23,403,000
	2012	1,889,000	1,549,000	1,106,000	1,053,000	2,432,000	4,285,000	3,508,000	2,773,000	3,043,000	1,990,000	1,251,000	1,152,000	26,031,000
	2013	1,163,000	1,029,000	1,119,000	1,215,000	1,830,000	2,727,000	4,608,000	3,154,000	2,247,000	1,123,000	780,000	748,000	21,743,000
	2014	758,000	694,000	725,000	796,000	2,346,000	1,669,000	3,132,000	2,394,000	1,443,000	1,045,000	809,000	760,000	16,571,000
	2015	737,000	726,000	1,004,000	1,279,000	1,347,000	1,580,000	3,150,000	1,443,000	3,291,000	1,535,000	717,000	1,047,000	17,856,000
	2016	1,239,000	1,121,000	1,368,000	1,195,000	908,000	3,739,000	3,584,000	3,240,000	1,375,000	1,176,000	615,000	539,000	20,099,000
	2017	581,000	503,000	592,000	608,000	795,000	1,998,000	3,786,700	1,670,300	2,294,000	1,080,000	912,100	1,296,000	16,116,100
	2018	1,820,000	1,624,000	1,960,000	1,803,000	1,703,000	5,737,000	7,370,700	4,910,300	3,669,000	2,256,000	1,527,100	1,835,000	36,215,100
	2019	1,662,200	1,766,800	1,403,600	1,215,300	1,290,200	1,585,400	2,746,600	2,708,800	2,410,800	1,251,500	1,260,400	1,288,200	20,589,800
	2020	1,332,100	1,376,000	1,492,100	1,724,200	2,501,800	4,063,500	4,870,200	4,164,800	3,953,000	3,314,600	1,727,600	1,177,000	31,696,900
	2021	1,125,600	1,148,800	1,261,700	2,074,800	1,396,900	4,014,600	2,936,900	2,921,400	2,589,000	1,797,100	1,085,000	1,169,100	23,520,900
Loomis	2011	1,287,000	2,080,000	1,254,000	1,953,000	3,231,000	4,369,000	5,352,000	6,655,000	6,671,000	3,976,000	2,551,000	1,304,000	40,683,000
	2012	1,709,000	1,033,000	1,553,000	2,428,000	7,072,000	10,692,000	15,290,000	7,847,000	8,014,000	4,510,000	1,855,000	984,000	62,987,000
	2013	1,254,000	783,000	1,124,000	1,534,000	5,182,000	7,094,000	11,508,000	7,579,000	7,236,000	2,221,000	1,393,000	1,298,000	48,206,000
	2014	1,223,000	1,150,000	1,341,000	1,952,000	5,636,000	4,465,000	8,702,000	5,563,000	2,847,000	2,970,000	1,437,000	1,289,000	38,575,000
	2015	1,163,000	1,177,000	2,116,000	4,199,000	2,763,000	5,302,000	8,388,000	6,377,000	6,215,000	3,215,000	1,382,000	1,113,000	43,410,000
	2016	1,066,000	1,119,000	1,362,000	2,828,000	1,952,000	7,843,000	6,982,000	7,775,000	5,093,000	4,769,000	1,995,000	1,254,000	44,038,000
	2017	1,522,000	823,000	1,835,000	3,033,000	3,124,000	9,538,000	9,616,000	2,699,000	6,351,000	2,228,000	1,401,000	653,000	42,823,000
	2018	1,440,000	1,282,000	1,235,000	1,432,000	4,451,000	6,398,000	6,346,000	4,138,000	3,901,000	1,944,000	1,084,000	1,342,000	34,993,000
	2019	1,086,000	972,000	986,000	1,273,000	1,579,000	2,621,000	5,587,000	5,196,000	5,656,000	2,152,000	1,181,000	1,165,000	29,454,000
	2020	1,143,000	1,058,000	1,170,000	2,031,000	3,304,000	7,559,000	6,338,000	11,240,000	7,536,000	4,471,000	1,690,000	1,585,000	49,125,000
	2021	1,411,000	1,532,000	1,764,000	2,228,000	3,813,000	8,872,000	7,088,000	9,758,000	5,456,000	3,571,000	1,829,000	1,598,000	48,920,000
Smithfield	2011	232,300	332,000	553,600	555,200	420,600	270,100	440,600	801,200	602,000	321,000	234,300	202,800	4,965,700
	2012	311,700	169,600	212,300	145,100	611,300	959,500	959,700	650,100	620,700	332,900	290,900	112,800	5,376,600
	2013	167,700	158,400	106,400	269,100	373,800	690,600	555,300	601,500	350,200	211,600	181,400	195,000	3,861,000
	2014													
	2015													
	2016	178,100	79,200	93,100	182,300	210,600	189,900	1,028,800	1,173,700	386,200	290,500	164,400	180,700	4,157,500
	2017	121,600	151,200	127,700	128,900	236,000	489,300	725,400	267,900	375,100	168,400	162,000	99,600	3,053,100
	2018	160,800	82,400	113,300	199,800	254,200	393,900	436,600	271,700	248,000	207,100	131,600	202,300	2,701,700
	2019	99,900	201,800	156,500	152,000	254,900	259,300	230,900	412,700	183,700	164,400	143,300	109,700	2,369,100
	2020	145,300	164,000	173,400	179,600	261,800	570,500	483,300	488,700	775,100	682,200	258,200	288,800	4,470,900
	2021	160,700	244,600	214,500	240,400	346,800	534,400	309,600	632,200	367,600	404,200	267,800	314,300	4,037,100

- 2014 Smithfield monthly data unavailable. Papers fell into water; all they are able to provide is beginning and ending reading for the year.
- 2015 Smithfield monthly data unavailable. Water Manager passed away; village staff was unaware that they were to be keeping monthly readings. They will begin January 2016.
- 2015 IMP Report data for Bertrand contained an error; data from one well was not included in the report.

TABLE 7: Platte Basin Industrial and Commercial Water Use Data

Well Reg	Well ID	Owner	Legal Description	Gallons Used
G-177982	239716	Olsen Cattle Co LLC	Section 5-6- 15	4,745,000
G-123753-R1	194279	KAAPA Ethanol, LLC	Section 13-6-16	124,948,200
G-123754-R2	210900	KAPPA Ethanol, LLC	Section 13-6-16	417,900
G-124061	152898	KAAPA Ethanol, LLC	Section 13-6-16	2,884,000
G-134413-R1	194280	KAAPA Ethanol, LLC	Section 13-6-16	55,785,900
G-181488	243777	KAAPA Ethanol LLC	Section 13-6-16	112,188,000
G-071961	80123	Mosaic	Section 15-6-16	0
G-071962	80124	Mosaic	Section 15-6-16	0
G-073875	82215	Village of Bertrand	Section 6-6-20	21,696,500
G-165728	219082	Fort Kearny Consolidated	Section 5-7- 14	54,456,000
G-165729	219083	Fort Kearny Consolidated	Section 5-7- 14	325,300
G-139944	171644	Fort Kearny Consolidated	Section 6-7-14	0
G-116982	141058	KGLD, LLC	Section 11-7-16	47,844,000
G-177447	238330	Loomis Pork LLC	Section 19-7-19	8,718,700
G-147025	188561	Paul Johnson & Sons	Section 10-7-20	147,800
G-095842	112013	Aurora Co-Op	Section 19-7-20	950,000
G-093253	106683	Dan & Steve Wolfe	Section 28-8-16	4,380,000
G-093254	106684	Dan & Steve Wolfe	Section 28-8-16	4,380,000
G-087812	99723	Rusty's Fertilizer Inc	Section 21-8-18	626,400
G-073205	81395	Rockford G Plettner	Section 4-8-21	131,000,000
G-080853	89509	Nebraska Public Power District	Section 4-8-21	108,000
G-156977	199850	Central Nebraska Public Power & Irrigation District	Section 7-8-21	340,013,136
G-092923	102854	Central Nebraska Public Power & Irrigation District	Section 4-8-22	60,445,360
G-122576	151178	Bullhead Point Association	Section 5-8-22	13,362,200
G-076515	85080	Lakeside Country Club	Section 8-8-22	15,300,000
G-076780-R1	124121	Lakeside Country Club	Section 8-8-22	15,300,000
				1,020,022,396

Map 2: Dedicated Groundwater Observation Wells

Tri-Basin Natural Resources District

Static Water Measurement Wells

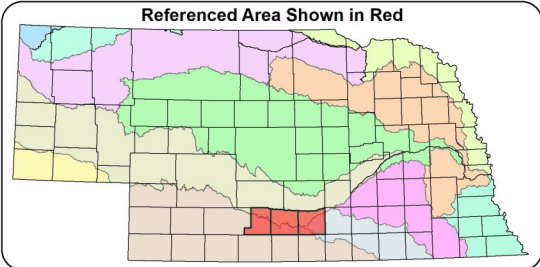
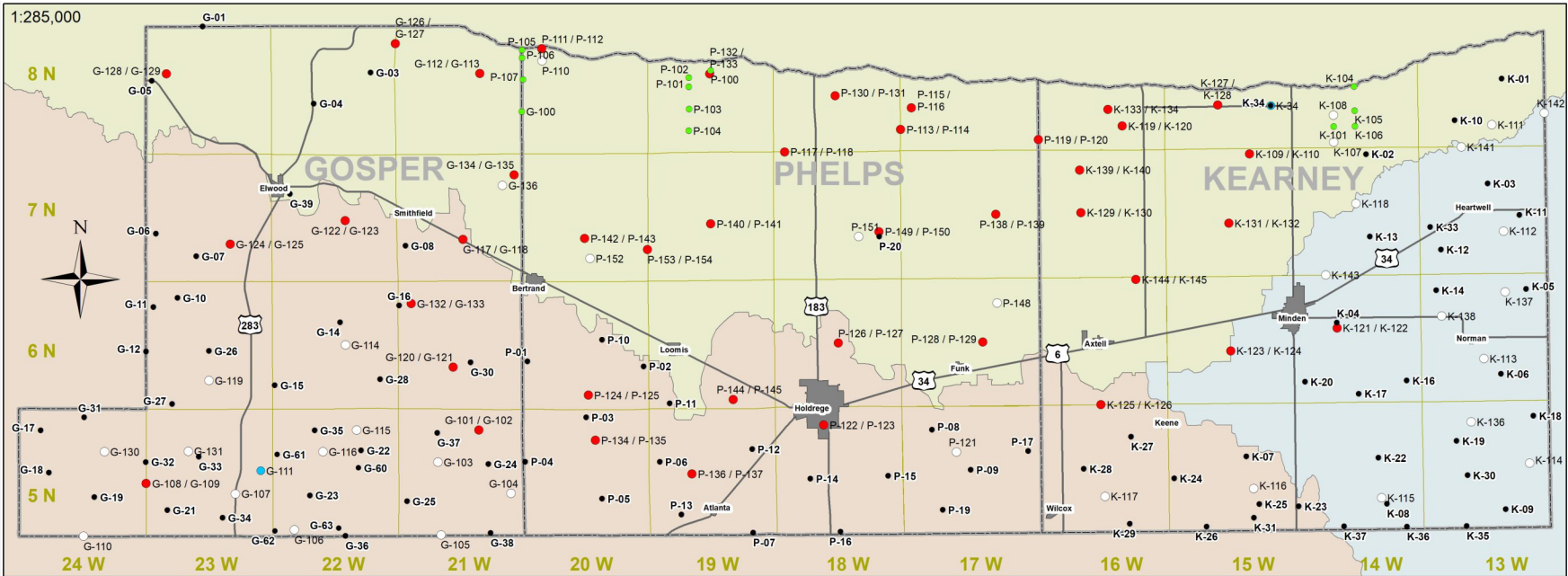

• Irrigation Well	■ Community
• Transect Well	□ County Boundary
○ Single Well	□ Township
• Nested Well	○ Little Blue Basin
• Other Well	○ Republican Basin
— Highway	○ Platte Basin

Observation Well Stats:

- 91 Sites
- 41 Nested Wells
- 133 Data Loggers
- 12 Hour Interval

Irrigation Well Stats:

- 9 Platte Basin
- 21 Little Blue Basin
- 60 Republican Basin
- 90 Measured Wells
- Spring & Fall

Nolan Little
March 2020
Tri-Basin Natural Resources District

Appendix A: Tri-Basin NRD – Platte Basin

Tri-Basin Natural Resources District New Well and Conditional Replacement Well Permit Applicant Certification and Agreement (Form for NON- CNPPID customers)

This Applicant Certification and Agreement imposes mandatory Conditions and Limitations on the operation of a Well permitted as a New Well or as a Conditional Replacement Well pursuant to Rule 1.13, Tri-Basin Natural Resources District Rules and Regulations for Management of Land and Water Resources.

NRD Permit # _____ Applicant _____

Applicant is the owner of the following- described real estate:

_____ ¼ Section T N - R W

Applicant accepts and agrees to the following conditions and limitations on the operation of a well that is constructed under the authority of a permit issued by the Tri-Basin Natural Resources District (“NRD”). The conditions and limitations are as follows (Note: Carefully read each condition checked by the NRD and then place your initials on the line next to the checked box):

1. _____ Applicant agrees to offset any “new depletions” to streamflows of the Platte River, Little Blue River, Republican River, or their tributaries that the NRD determines to be associated with use of this well. Applicant agrees to use methods to offset those depletions that are deemed acceptable by the NRD and the State of Nebraska. Applicant understands and agrees that Applicant’s failure to offset said new depletions will result in closure of this well or restrictions being imposed by the NRD on the number of acres of land that can be irrigated by this well.

2. _____ Applicant agrees to abide by well spacing and pumping capacity limitations that apply to the well that is the subject of this permit, whether such limitations arise pursuant to or state law or by rule or regulation of the NRD. Applicant understands and agrees that Applicant’s failure to comply with all rules and regulations of the NRD that pertain to this well will result in closure of this well and civil or criminal prosecution and other penalties.

3. _____ Applicant agrees to comply with all current and future rules and regulations of the NRD that pertain to this well. Applicant understands and agrees that Applicant’s failure to comply with all rules of regulations of the NRD will result in closure of this well and civil or criminal prosecution and other penalties.

4. _____ Applicant agrees to irrigate only land that has been certified for irrigation by the NRD (no new irrigated acres will be allowed). Applicant understands and agrees that Applicant’s failure to prevent irrigation of land not certified for irrigation by the NRD will result in closure of this well and prosecution by the State of Nebraska.

Appendix A: Tri-Basin NRD – Platte Basin

I certify that I am familiar with the information contained in this certification and agreement and that to the best of my knowledge and belief such information is true, complete and accurate. I further acknowledge that Tri-Basin Natural Resources District or the State of Nebraska may impose additional conditions, limitations and restrictions on operation of the well that is the subject of this permit, and that all conditions, limitations and restrictions shall be binding upon any successors in interest to the well and real property.

Date

Signature of Applicant

Date

Signature of Applicant

Date

Signature of Witness

Approval by Tri-Basin Natural Resources District

Date

Signature of Tri-Basin NRD Representative

Appendix B: Tri-Basin NRD Platte Basin Flowmeter Data for Irrigation Wells - 2021

Well Reg	Well ID	Reported Acres	Gallons Used	Comments
A-005254	805	152.00	24,541,100	
A-005527	1006	136.70	22,612,400	
A-005544-R1	113944	135.00	27,472,200	
A-005573-R1	203922	81.00	12,354,200	
A-005616	1053	129.70	26,500,403	
A-005727-R1	247613	90.00	11,117,390	
A-005851-R2	234961	156.43	26,513,300	
A-005964B-R1	182843	116.00	26,464,288	
A-005987	1325	73.90	12,819,900	
A-006470	1647	130.00	34,509,747	
A-006862	1917	148.00	39,637,200	
A-007012-R1	2028	0.00	0	Well Not Used in 2021 --- Supplemental Well
A-007219-R1	263005	168.00	53,870,549	Well waters in 3 parcels W 6-8-21
A-007398-R1	219835	139.50	30,090,434	
A-008164-R1	174548	100.00	29,834,371	Series Well w/ G-073863 - 2 Wells, each own meter
G-000273-R1	98237	127.00	29,614,967	
G-000317-R2	219289	132.00	25,116,000	
G-000533	3831	126.00	15,098,982	
G-000559-R1	262531	97.00	10,535,752	
G-000597-R1	207683	135.00	41,475,563	
G-000671-R1	3992	300.00	57,693,000	
G-001136-R1	238751	0.00	0	Well Not Used in 2021 -- Surface water only
G-001152	4544	0.00	0	Well Not Used in 2021 --- Supplemental Well
G-001169	4563	149.00	24,055,500	
G-001228-R1	92085	73.00	22,561,500	
G-001374-R1	222615	135.00	15,809,000	
G-001498	4954	245.15	16,129,666	Estimate
G-001705	5190	150.00	43,021,711	40 ac alfalfa/15 ac teff grass
G-002216-R1	166014	128.00	28,370,200	
G-002383-R1	128836	132.00	23,772,200	
G-002482	6081	130.00	793,711	
G-003468	7201	77.00	20,908,580	Estimate
G-004871	8801	80.00	15,386,814	
G-004955-R1	8893	148.00	28,610,300	
G-005097-R1	114236	151.30	24,034,141	
G-005392	9390	0.00	0	Well Not Used in 2021
G-006383	10549	138.00	888,207	
G-007340-R1	162706	130.00	42,032,500	
G-007342-R1	162707	119.00	46,272,600	
G-007488-R1	11845	150.00	2,332,767	Supplemental Well
G-007764	12171	0.00	0	Well Not Used in 2021
G-008178	12651	130.00	24,329,984	

Appendix B: Tri-Basin NRD Platte Basin Flowmeter Data for Irrigation Wells - 2021

Well Reg	Well ID	Reported Acres	Gallons Used	Comments
G-009462	14164	0.00	0	Well Not Used in 2021 --- Supplemental Well
G-009596	14319	147.00	26,055,300	
G-010388-R1	213868	65.00	7,982,190	
G-011357-R1	16352	115.00	35,103,877	
G-011745-R1	16802	132.00	33,972,600	
G-012318	17473	137.00	17,531,000	
G-012651-R1	191520	67.00	24,817,127	
G-013097-R1	121819	132.00	21,268,400	
G-013149-R1	223630	75.00	29,896,554	
G-013423-R1	209336	260.00	29,480,826	
G-013974	19370	135.60	34,127,690	
G-014026	19432	0.00	0	Well Not Used in 2021 --- Supplemental Well
G-016206	21928	142.00	27,756,000	alfalfa
G-016446-R1	22203	130.00	32,778,136	
G-016616-R1	169839	0.00	0	Well Not Used in 2021 --- Supplemental Well
G-016633	22408	75.00	28,902,100	
G-016869	22679	0.00	698,401	Cattle only
G-017090-R1	172826	131.60	44,553,197	
G-020681	26927	133.60	13,478,159	
G-020831	27090	120.00	31,655,047	
G-021172	27458	98.00	26,113,600	
G-021193	27482	124.00	35,148,681	alfalfa
G-021609-R1	258322	151.00	33,050,491	
G-021735-R1	28060	152.00	38,124,759	
G-021830-R1	163082	123.00	3,620,442	
G-022286	28646	30.00	4,483,397	
G-022950	29350	130.00	23,570,300	
G-022962-R1	227608	120.00	46,515,200	double crop with wheat
G-023149	29563	26.00	7,218,891	
G-023266	29683	149.00	37,882,700	
G-023268-R1	241542	62.00	15,942,928	
G-023479	29912	125.00	32,546,000	
G-023572	30014	240.00	0	Well Not Used in 2021 --- Supplemental Well
G-023615	30058	155.00	24,628,500	
G-024078-R1	98512	129.56	37,191,800	
G-024220	30697	130.00	2,549,600	
G-024327	30807	152.00	37,548,000	
G-024329	30809	75.00	3,045,592	New meter
G-024483-R1	30966	132.43	24,148,866	
G-024606-R1	228630	105.00	28,338,800	
G-024787-R1	97572	150.00	33,676,934	
G-024986	31500	120.00	28,054,698	

Appendix B: Tri-Basin NRD Platte Basin Flowmeter Data for Irrigation Wells - 2021

Well Reg	Well ID	Reported Acres	Gallons Used	Comments
G-025069	31589	142.00	30,846,944	Estimate
G-025152	31677	125.00	18,510,610	
G-025207	31736	147.00	9,125,000	
G-025703-R1	242435	151.50	19,299,000	
G-025803	32369	140.00	24,027,700	
G-026446	33051	170.00	23,340,221	
G-027184	33850	140.00	19,930,000	
G-027484-R1	225652	135.00	1,297,147	Supplemental Well
G-028077	34788	146.00	19,312,000	
G-028109-R1	34822	109.00	21,118,480	
G-028636	35400	132.00	25,218,000	
G-028660-R2	160179	145.00	1,318,300	
G-028765-R1	35540	142.00	24,099,175	Estimate
G-028884	35667	140.00	24,298,100	
G-029347	36156	105.00	18,552,000	
G-029951-R1	217569	38.00	11,196,409	
G-030265	37128	50.00	9,702,124	
G-030496	37375	130.00	21,667,806	
G-030668-R1	164677	0.00	0	Well Not Used in 2021
G-030676	37576	130.00	24,857,586	
G-030705	37605	148.00	23,893,100	
G-030936-R1	176011	120.00	24,932,800	
G-031102	38030	150.00	18,305,000	
G-031153	38092	0.00	0	Well Not Used in 2021 --- WCIP Contract
G-031354	38311	139.00	21,980,000	
G-031657	38620	62.00	4,486,200	
G-031862-R1	170685	147.50	31,012,700	
G-031885-R1	168468	150.00	31,908,700	
G-032220	39203	145.00	30,283,770	
G-032221	39204	21.00	2,709,154	
G-032462-R1	166009	124.00	21,432,200	
G-032999-R2	189200	65.00	14,907,003	
G-033196-R1	158873	132.00	21,311,002	
G-033788	40819	147.20	8,397,900	
G-033845	40877	132.00	29,453,400	
G-034024	41062	85.00	19,911,000	
G-034034-R1	93086	65.00	8,126,500	
G-034215	41257	135.00	44,749,792	
G-034439	41489	130.00	42,179,123	
G-034522	41576	0.00	0	Well Not Used in 2021 --- Supplemental Well
G-034601	41656	70.00	13,910,200	
G-034607-R1	95424	191.00	20,745,656	Estimate
G-034763	41826	7.00	1,765,010	Well watered gravity corners only

Appendix B: Tri-Basin NRD Platte Basin Flowmeter Data for Irrigation Wells - 2021

Well Reg	Well ID	Reported Acres	Gallons Used	Comments
G-034808	41871	134.00	14,554,544	Estimate
G-035001-R1	246956	151.00	29,983,990	
G-035027	42096	116.70	11,414,400	
G-035028	42097	154.80	32,239,300	
G-035046-R1	149129	94.08	14,114,600	
G-035210-R1	42287	132.00	23,447,207	
G-035230-R1	209844	100.50	31,913,553	
G-035840-R1	221855	0.00	0	Well Not Used in 2021
G-036171-R1	217862	148.00	19,922,075	
G-036219-R1	213455	75.00	23,816,773	
G-036220-R1	204099	53.70	13,519,161	
G-036447-R1	203726	135.00	26,527,200	
G-036500	43633	149.00	34,630,039	15 ac wheat
G-036585	43719	44.90	13,403,757	grass
G-036677	43812	130.00	51,113,875	
G-037041	44181	50.00	1,012,000	Supplemental Well
G-037482	44633	152.00	30,375,822	
G-037931-R1	227572	140.00	37,740,100	
G-038167-R2	209014	134.00	21,713,500	
G-038172	45343	130.00	49,834,922	
G-039054	46251	119.00	15,244,799	alfalfa
G-039106	46304	128.00	44,410,300	
G-039190-R1	265700	156.00	37,337,836	
G-039297	46502	0.00	0	Well Not Used in 2021
G-039572	46786	77.90	42,183,739	
G-039663-R1	199851	95.00	24,542,600	
G-040084	47314	135.00	45,890,260	
G-040337	47575	145.00	17,186,700	
G-040839	48087	118.00	25,006,933	Alfalfa
G-041057	48311	14.00	5,334,675	
G-041183	48439	154.00	50,810,400	
G-041329-R1	219361	125.00	37,297,920	
G-041350	48611	127.00	19,723,308	
G-041369-R1	188563	66.00	5,729,200	
G-041374	48636	141.00	22,228,617	
G-041826	49107	157.80	19,076,900	
G-041978-R1	222393	230.00	80,081,301	
G-041996-R1	228128	17.00	4,070,385	
G-042019	49302	145.00	29,088,451	
G-042824	50125	160.00	33,323,000	
G-042992-R1	198737	135.00	44,841,600	
G-043275-R1	50593	137.00	25,391,434	
G-043276-R1	169041	148.00	25,120,437	

Appendix B: Tri-Basin NRD Platte Basin Flowmeter Data for Irrigation Wells - 2021

Well Reg	Well ID	Reported Acres	Gallons Used	Comments
G-043366-R1	127238	83.00	16,568,700	
G-043639	50973	120.00	54,433,451	
G-043947	51286	136.00	25,409,200	
G-044047	51391	135.00	30,231,906	
G-044222	51568	165.00	74,367,900	
G-044419	51766	135.00	49,447,434	
G-044570	51919	30.00	4,154,562	
G-044608	51959	132.00	42,892,700	
G-044680	52031	141.00	20,605,813	
G-044918	52271	156.40	29,673,077	
G-045284	52644	135.00	27,068,000	Alfalfa (13-0864-8 Not Used in 2021)
G-045549-R1	118572	135.90	25,972,000	
G-046380	53760	135.00	35,125,871	
G-046434	53847	150.00	16,451,400	
G-048424	55885	111.00	21,069,100	
G-049528	57016	133.00	29,774,700	
G-049567-R1	221186	146.00	30,502,903	
G-050030	57531	144.00	29,220,000	
G-050941	58466	17.00	8,098,300	
G-052873	60431	135.00	43,760,571	
G-053420	60983	160.00	39,224,496	
G-053462	61025	135.00	48,279,812	
G-053870	61445	150.00	23,869,800	
G-054523	62111	150.00	32,584,800	Estimate
G-055251-R1	263060	166.30	39,449,200	
G-055382-R1	172201	157.00	37,185,500	
G-055521	63130	137.00	102,866,684	
G-056004	63618	102.50	33,981,500	
G-056606-R1	64243	133.00	33,675,000	
G-057082	64744	154.00	28,645,300	
G-057427-R1	222051	187.00	45,353,000	
G-058508	66218	136.00	27,207,222	
G-059592	67347	149.20	24,607,900	
G-059676	67433	57.30	21,113,864	
G-060270-R1	254482	62.00	20,301,417	
G-060797-R1	212228	130.00	32,454,189	
G-061063-R1	213557	240.00	45,394,971	
G-061501-R1	221352	152.00	39,636,300	
G-061654	69490	151.50	24,281,100	
G-061946	69783	128.00	24,905,200	
G-063158	71057	153.77	21,957,100	
G-063177	71076	138.68	17,310,132	
G-063232	71133	150.00	19,009,500	

Appendix B: Tri-Basin NRD Platte Basin Flowmeter Data for Irrigation Wells - 2021

Well Reg	Well ID	Reported Acres	Gallons Used	Comments
G-063877	71796	91.00	19,108,700	
G-063968	71890	130.00	55,941,856	
G-064069	71993	65.25	21,082,800	
G-064756	72722	77.21	25,289,300	
G-064840	72808	145.00	29,713,100	
G-065598	73589	130.00	50,480,915	
G-066150	74154	135.00	19,314,300	
G-066404	74421	130.00	34,574,374	
G-066511	74530	149.20	25,827,600	
G-067478	75541	65.00	18,961,910	
G-067820	75893	135.00	31,471,900	
G-067926	76002	103.00	31,900	
G-067939-R1	176352	149.00	35,904,105	
G-067960	76038	132.00	69,137,600	
G-068235	76316	127.00	30,156,146	
G-068317	76399	173.30	33,570,219	
G-068903	77028	134.80	10,435,300	
G-068938	77063	135.00	19,360,802	
G-069457	77609	240.00	48,877,200	Estimate
G-069536	77689	130.00	44,397,200	
G-069613	77769	275.00	4,419,585	Supplemental Well
G-070512-R1	264615	153.00	16,039,324	
G-070660-R1	216319	135.00	41,437,004	
G-070731	78892	158.20	13,286,000	
G-070802	78963	145.00	18,793,000	
G-070946	79107	0.00	0	Well Not Used in 2021
G-071177-R1	225427	133.00	20,257,156	
G-071178-R1	162859	146.80	29,882,600	
G-071179	79340	120.00	18,473,000	
G-071541	79703	130.00	23,050,216	
G-072455-R1	206053	132.00	30,833,095	
G-072667	80855	140.00	22,632,587	
G-072681	80869	7.00	2,513,000	
G-073172	81360	72.00	14,610,210	
G-073798	82134	140.00	21,760,673	
G-073863	82203	150.00	15,552,500	Series Well w/ A-008164-R1 - 2 Wells each have meter
G-074144	82484	134.00	22,941,600	
G-074176	82517	130.00	24,265,086	
G-074256	82601	73.00	19,523,900	
G-074282	82627	140.00	27,991,000	
G-074365	82710	127.00	24,139,906	Estimate
G-074392	82739	76.07	26,440,700	
G-074662	83011	105.00	29,939,800	

Appendix B: Tri-Basin NRD Platte Basin Flowmeter Data for Irrigation Wells - 2021

Well Reg	Well ID	Reported Acres	Gallons Used	Comments
G-087416	99269	140.00	43,157,753	
G-087842	99647	133.00	28,546,200	
G-091120	102868	142.00	26,139,900	
G-091407	102859	133.00	41,165,400	
G-094083	107849	130.00	33,283,200	
G-096150	109726	130.00	28,767,762	
G-096555	109842	130.00	29,716,700	
G-096676	112194	130.00	29,142,487	
G-096815	110571	67.00	8,375,379	
G-097100	110814	0.00		Well Not Used in 2021 --- Supplemental Well
G-097707-R1	236661	143.30	39,298,898	
G-098970	115138	75.00	18,318,359	
G-100388	114419	145.00	33,936,100	
G-109999	128947	225.00	21,236,872	
G-110172	129232	151.78	35,496,800	
G-116457	140343	130.00	32,126,984	
G-116906	141679	75.00	15,885,090	Estimate
G-118169	142719	160.80	31,677,585	
G-119660	146805	88.00	7,088,009	
G-121077	147633	152.80	38,012,200	
G-121219	146009	120.00	19,521,700	
G-121766	146008	150.00	25,557,888	
G-121894	148344	181.97	26,355,806	
G-122529	147634	78.00	8,133,900	
G-123303	149183	64.00	15,595,000	
G-124617	152724	128.00	18,461,317	
G-125286	152448	40.00	15,915,000	
G-125287	152447	130.00	28,858,600	
G-127496	153919	127.00	28,182,300	
G-127559	155815	135.00	19,593,900	
G-128172	154500	37.50	9,036,600	
G-129150	154896	131.00	13,302,100	
G-129241	158555	90.00	16,364,500	
G-129257	160440	137.00	20,380,600	Supplemental Well
G-129685	156989	136.20	2,758,846	Supplemental Well
G-129692	160438	140.00	19,659,900	
G-130058	154894	100.00	27,741,613	
G-130108	159812	19.00	5,337,662	Supplemental Well
G-130225	160878	156.00	30,309,400	
G-130382	153921	0.00	0	Well Not used in 2021
G-130445	153920	0.00	0	Well Not Used in 2021
G-130451	154496	133.00	8,146	
G-130559	156326	152.50	30,344,900	

Appendix B: Tri-Basin NRD Platte Basin Flowmeter Data for Irrigation Wells - 2021

Well Reg	Well ID	Reported Acres	Gallons Used	Comments
G-130635	159808	130.00	12,056,000	
G-130699	161380	0.00	0	Well Not Used in 2021
G-130801	154254	130.00	22,416,400	
G-130918	161076	152.20	31,026,400	
G-130954	162385	10.00	1,214,900	
G-130969	161430	145.00	6,635,623	Supplemental Well
G-131043	161371	143.00	43,550,200	
G-131271	156876	130.00	2,174,100	
G-131440	156871	124.00	3,489,200	Supplemental Well
G-131490	154924	79.80	24,101,890	
G-131622	155819	100.00	11,197,000	
G-131623	155812	135.00	45,316,700	
G-131726	162133	150.88	30,736,500	
G-131774	163016	144.00	20,507,000	
G-131925	162127	133.04	281,600	Supplemental Well
G-131927	161757	130.00	26,118,500	
G-131930	162388	122.60	37,312,300	
G-131993	159890	145.00	31,150,100	
G-132158	163442	139.00	26,440,500	
G-132168	160566	135.00	28,624,300	
G-132241	165009	128.00	15,427,500	
G-132339	156879	0.00	0	Well Not Used in 2021 --- WCIP
G-132340	156877	134.95	1,195,400	WCIP Contract
G-132341	156875	0.00	0	Well Not Used in 2021 --- WCIP Contract
G-132344	156789	12.00	1,987,100	
G-132359	160881	133.00	20,871,107	
G-132512	161373	135.00	25,638,700	
G-132514	165545	0.00	0	Well Not Used in 2021 - Supplemental Well
G-132515	161839	144.23	4,493,700	Supplemental Well
G-132529	161379	0.00	0	Well Not Used in 2021
G-132531	161571	140.00	23,234,863	
G-132532	161572	151.00	33,319,200	
G-132544	159256	135.00	21,343,004	Estimate
G-132547	159597	153.50	24,598,000	Supplemental Well
G-132644	160439	158.00	41,778,800	
G-132663	164229	154.30	33,212,329	
G-132700	165015	132.00	94,195,700	
G-132701	165016	132.00	73,670,200	
G-132733	159884	160.00	24,995,300	
G-132734	164687	115.00	45,028,121	
G-132768	165657	140.40	23,395,000	
G-132769	160567	135.00	17,103,600	
G-132798	159254	130.00	24,332,428	

Appendix B: Tri-Basin NRD Platte Basin Flowmeter Data for Irrigation Wells - 2021

Well Reg	Well ID	Reported Acres	Gallons Used	Comments
G-132840	160488	151.00	12,929,649	
G-133038	165739	136.25	15,451,900	
G-133088	157915	130.00	21,637,122	
G-133180	161381	0.00	0	Well Not Used in 2021
G-133181	161382	0.00	0	Well Not Used in 2021
G-133233	162390	119.68	17,856,900	
G-133234	161749	146.00	24,990,900	
G-133235	158379	117.00	60,500	Supplemental Well
G-133352	162136	135.00	7,858,639	
G-133405	165547	120.00	17,743,600	
G-133416	165335	66.50	18,809,300	
G-133421	161383	101.00	35,410,988	
G-133426	165471	65.00	6,536,800	
G-133471	163782	130.00	24,135,700	
G-133725	162123	130.00	16,410,800	
G-133759	160323	87.00	22,233,152	
G-133929	164406	75.00	15,526,800	
G-133952	166448	0.00	3,495,500	Well Used to fill Pond @ MOSAIC
G-134113	166449	111.00	46,524,900	
G-134130	162140	130.00	46,317,936	
G-134132	162139	67.00	17,846,200	
G-134186	166699	10.00	1,629,240	Estimate
G-134199	162134	130.00	20,020,916	
G-134206	166528	0.00	0	Well Not Used in 2021
G-134230	166010	63.00	44,838,100	
G-134566	160564	123.00	15,113,900	
G-134706	167566	0.00	0	Well Not Used in 2021
G-134879	162601	65.00	3,711,000	
G-134880	161156	0.00		New Meter
G-135119	169328	156.30	52,595,900	Supplemental Well
G-135169	166605	149.00	20,750,600	
G-135192	167715	0.00	0	Well Not Used in 2021 --- Supplemental Well
G-135193	167716	65.00	5,364,500	
G-135213	166040	86.00	17,898,600	
G-135516	169018	116.00	16,292,400	Estimate
G-135532	160565	140.00	38,570,500	
G-135822	169468	99.60	19,307,400	
G-135950	161750	0.00	0	Well Not Used in 2021
G-136259	169013	86.00	16,552,100	
G-136650	169774	135.00	41,000,400	
G-136691	165017	135.00	22,426,700	
G-137318	169448	110.00	23,327,000	
G-137329	169841	134.30	26,836,650	Estimate

Appendix B: Tri-Basin NRD Platte Basin Flowmeter Data for Irrigation Wells - 2021				
Well Reg	Well ID	Reported Acres	Gallons Used	Comments
G-137381	170158	145.00	1,836,153	Supplemental Well
G-137402	170172	135.00	40,555,857	
G-137403	170742	72.00	20,301,000	
G-137447	165018	135.00	28,817,800	
G-137937	172642	134.00	62,687,200	
G-137967	166808	292.00	6,526,100	Supplemental Well
G-138203	172442	155.00	34,513,006	
G-138280	162142	64.85	16,012,600	
G-138416	162122	145.00	23,648,700	
G-138534	172370	151.00	27,116,799	
G-138594	172862	74.60	2,342,000	
G-139059	172599	100.00	19,999,400	
G-139271	170679	90.00	9,946,800	
G-139360	165336	90.00	39,494,400	
G-139572	169042	100.00	27,485,600	
G-140012	167002	24.50	6,725,200	
G-140625	172547	132.00	2,421,400	
G-141518	173834	65.00	14,587,300	
G-141860	177863	93.00	11,704,894	
G-142036	170682	59.00	6,519,500	
G-142430	178761	130.00	15,075,900	Well Used on pivot
G-142530	173630	139.00	22,840,900	
G-142566	178584	0.00	0	Well Not Used in 2021 --- Supplemental Well
G-142967	178585	215.00	39,098,500	
G-143253	177864	0.00	0	Well Not Used in 2021
G-144298	182757	71.00	15,570,100	
G-144555	181381	0.00	0	Well Not Used in 2021
G-144716	182053	145.00	23,173,800	
G-144783	183104	137.00	29,916,300	
G-144784	180131	0.00	0	Well Not Used in 2021 --- Supplemental Well
G-144823	182952	205.00	83,700	
G-144980	182209	135.00	43,185,800	
G-145042	183105	100.00	22,785,400	
G-145565-R1	190217	130.00	28,616,514	
G-145863	185009	260.10	19,462,600	
G-145885	178762	40.00	25,153,700	
G-145993	183670	0.00	0	Well Not Used in 2021
G-146977	180054	50.00	12,225,400	
G-147124	182953	150.00	1,505,600	Supplemental Well
G-147456	188634	65.00	9,115,055	
G-147457	188635	136.00	31,166,818	
G-148411	189364	135.31	30,763,800	
G-148565	187309	0.00	0	Well Not Used in 2021 --- Supplemental Well

Appendix B: Tri-Basin NRD Platte Basin Flowmeter Data for Irrigation Wells - 2021				
Well Reg	Well ID	Reported Acres	Gallons Used	Comments
G-148621	191026	75.00	16,088,745	
G-148622	190543	130.00	1,721,600	
G-148685	188800	125.00	48,634,715	
G-148702	189813	94.00	26,817,290	
G-148722	191249	73.00	4,334,593	
G-148743	187694	100.00	1,357,700	Estimate
G-149188	191318	134.00	41,412,900	double crop with wheat
G-149618	192106	132.00	16,896,305	
G-149663	191521	74.00	24,180,094	
G-149890	191025	87.00	6,209,034	
G-150891	187697	0.00	0	Well Not Used in 2021 --- WCIP Contract
G-151663	191248	62.00	8,455,756	
G-152478	197495	130.00	13,523,235	
G-152676	191017	125.00	40,140,672	
G-152707	197427	160.00	1,221,300	Supplemental Well
G-153081	197627	68.00	16,360,557	
G-153624	199985	95.00	21,349,018	
G-157641	202660	115.00	11,948	
G-158114	208108	120.00	16,835,480	
G-159284	208463	162.80	37,566,744	
G-161020	213049	128.00	74,419,200	Double cropped, rye to corn
G-161031	214156	30.00	15,559,242	
G-161519	208462	67.00	15,634,100	
G-162926	216452	74.50	9,273,091	
G-164032	219279	155.00	33,915,346	
G-164644	218534	160.00	22,927,480	
G-164765	217905	97.00	21,900,244	
G-165055	220042	143.00	11,881,504	
G-165537	215283	48.00	20,555,578	
G-165597	218166	75.00	14,913,791	
G-166011	221015	130.00	28,903,532	
G-166108	222272	67.00	24,342,746	
G-166557	217687	124.00	35,425,923	
G-166720	222354	148.00	42,056,115	
G-167012	221958	31.80	9,375,733	
G-167286	223104	144.00	17,460,022	
G-167416	222557	77.00	23,023,334	
G-167483	224220	106.00	5,482,121	
G-167695	221189	127.00	4,822,550	Supplemental Well
G-167696	221856	130.00	12,076,470	
G-167697	222232	78.00	8,143,756	
G-167700	222753	150.00	1,461,900	Supplemental Well

Appendix B: Tri-Basin NRD Platte Basin Flowmeter Data for Irrigation Wells - 2021

Well Reg	Well ID	Reported Acres	Gallons Used	Comments
G-167889	222616	76.00	6,272,574	
G-167954	223105	0.00	39,373	Cattle Only
G-168005	223141	57.00	9,534,584	
G-168610	217989	143.00	27,710,385	
G-169763	225845	25.00	3,403,300	
G-169866	224583	88.00	15,305,081	
G-170249	228482	122.00	22,879,689	
G-170384	228390	155.00	55,083,790	
G-170397	222559	79.39	82,005	
G-170400	226797	67.00	22,923,678	
G-171454	229850	81.40	2,882,669	
G-171471	229476	65.00	8,729,800	
G-171948	228629	133.00	21,370,198	
G-172064	227073	153.28	3,802,103	
G-172337	230621	131.00	9,554,406	Supplemental Well
G-172642	226828	137.00	9,962,260	
G-172798	230409	145.00	10,811,094	Supplemental Well
G-173699	230989	171.00	57,444,287	
G-174251	230397	100.00	1,159,476	Supplemental Well
G-174557	230623	135.00	58,879,919	
G-174591	234579	82.00	6,910,965	Supplemental Well
G-174932	232741	108.00	18,862,526	
G-175697	235514	75.00	27,507,002	
G-175830	235770	35.00	5,623,865	
G-175946	231156	140.00	3,019,796	
G-175949	236660	108.00	593,315	Supplemental Well
G-176126	235952	0.00	0	Well Not Used in 2021
G-176401	236745	15.00	11,216,231	
G-177578	239253	21.40	15,893,779	
G-178033	240120	130.00	6,567,738	
G-178903	240974	132.00	18,381,900	
G-186194	254285	30.00	79,557,700	Well is used to fill duck pond in off season
G-186486	254490	20.00	59,232,921	Grass _ Purpose for well mainly to fill Duck Pond
G-187210	256486	77.00	13,436,342	
G-187945	257218	16.00	1,626,199	
G-188663	257035	115.00	4,204,064	
G-189345	259680	97.00	41,139,500	
G-189407	247403	18.00	11,597,037	

56,234.74 11,188,321,504

34,335.698 Acre Feet
7.33 Average IPA

Appendix C: Tri-Basin NRD Platte Basin No Till Acres - 2021						
Well Reg	Sub Section	Section	Township	Range	Irrigated Acres	Tillage
A-004566	SW 1/4 of SE 1/4	31	7	16	137.5	No Till
A-005229	NE 1/4	8	6	20	38.0	No Till
A-005309	NW 1/4	2	5	17	115.0	Minimum Till
A-005349	NE 1/4	32	5	16	152.0	Minimum Till
A-005509	NE 1/4	32	6	16	70.0	No Till
A-005523	NE 1/4	10	5	17	15.0	Minimum Till
A-005616	lot 2	30	7	17	77.1	No Till
A-005633	SE 1/4	10	6	19	156.0	No Till
A-005727	E1/2 NW 1/4	30	7	19	76.0	No Till
A-005838	NE 1/4	10	5	18	145.0	No Till
A-005964B	NE 1/4	16	8	13	117.0	No Till
A-005987	W1/2 SW	33	7	17	72.0	No Till
A-006934	NE 1/4 of NE 1/4	13	7	17	54.0	No Till
A-007010	SE 1/4	11	5	17	64.0	No Till
A-007126	lots 2 & 3	31	6	17	150.0	No Till
A-007273	SE 1/4	23	5	19	135.0	No Till
A-007514	SW 1/4	7	5	19	140.0	No Till
G-000125	SE 1/4	14	5	17	66.0	Minimum Till
G-000246	NE 1/4	34	7	20	158.0	No Till
G-000540	SE 1/4	11	5	19	87.0	No Till
G-000642	NW 1/4	21	8	13	135.0	No Till
G-000652	SW 1/4	22	6	20	156.0	No Till
G-001168A	NE 1/4	14	8	18	15.0	No Till
G-001168B	SE 1/4	14	8	18	20.0	No Till
G-001169	NE 1/4	5	6	19	149.0	Minimum Till
G-001173	NE 1/4	4	5	19	123.0	Minimum Till
G-001239	SW 1/4	27	6	20	173.5	No Till
G-001256	SE 1/4	9	5	19	132.0	No Till
G-001336	NE 1/4	10	5	17	110.0	Minimum Till
G-001341	SE 1/4	20	5	19	111.0	No Till
G-001407	NW 1/4	27	6	17	60.2	Minimum Till
G-002145	NE 1/4	34	5	18	130.0	No Till
G-002253	SW 1/4	11	6	21	143.0	No Till
G-002334	SW 1/4	22	5	16	153.0	Minimum Till
G-002482	SW 1/4	16	7	19	130.0	No Till
G-002623	NW 1/4	24	8	18	41.0	No Till
G-002671	NW 1/4	35	5	16	130.0	No Till
G-002716	NE 1/4	33	5	16	120.0	No Till
G-002950	SE 1/4	28	7	17	126.0	No Till
G-002985	NW 1/4	22	6	20	154.0	No Till
G-003127	NE 1/4	8	6	20	80.0	No Till
G-003516	NE 1/4	22	5	19	20.0	No Till

Appendix C: Tri-Basin NRD Platte Basin No Till Acres - 2021

Well Reg	Sub Section	Section	Township	Range	Irrigated Acres	Tillage
G-003681	SW 1/4	4	5	16	65.0	Minimum Till
G-003733	SW 1/4 of SW 1/4	7	7	16	6.5	No Till
G-003734	SW 1/4 of SE 1/4	7	7	16	4.0	No Till
G-003918	SE 1/4 of NW 1/4	33	7	16	154.0	No Till
G-004669	SE 1/4 of SW 1/4	8	7	16	100.0	No Till
G-004679	SW 1/4	22	6	18	30.0	No Till
G-004856	SW 1/4 of NW 1/4	20	7	16	53.0	No Till
G-004926	SE 1/4	15	8	18	45.0	Minimum Till
G-004994	NE 1/4	14	6	19	146.0	No Till
G-005935	NE 1/4	7	5	19	130.0	No Till
G-005936	SW 1/4	20	5	18	130.0	No Till
G-006176	NE 1/4	15	5	19	155.0	Minimum Till
G-006383	NW 1/4	14	7	20	138.0	No Till
G-006536	NW 1/4	14	8	13	90.0	Minimum Till
G-006537	NE SE 1/4	8	8	13	83.0	No Till
G-006759	SE 1/4	21	5	16	158.0	Minimum Till
G-007043	NW 1/4	16	7	19	150.6	No Till
G-007078	NE 1/4	23	8	14	18.0	No Till
G-007196	NW 1/4	24	5	16	145.0	No Till
G-007505	SE 1/4	9	6	20	121.0	No Till
G-007598	SE 1/4	16	8	18	14.0	Minimum Till
G-008006	SW 1/4	21	6	18	135.0	No Till
G-008008	SW 1/4	13	8	18	58.0	No Till
G-008029	SW 1/4	27	6	18	69.5	No Till
G-008191	SE 1/4	22	5	16	130.0	No Till
G-008436	SW 1/4	17	7	19	232.0	No Till
G-008503	SE 1/4 of SE 1/4	11	7	16	115.0	No Till
G-008625	SW 1/4	11	8	13	77.0	No Till
G-008626	NW 1/4	11	8	13	68.0	No Till
G-008919	SE 1/4	12	8	13	4.0	Minimum Till
G-008921	SE 1/4	11	8	13	60.5	Minimum Till
G-009227	SW 1/4	34	7	21	124.0	No Till
G-009240	SE 1/4	14	8	14	56.0	Minimum Till
G-009241	SE 1/4	14	8	14	56.0	Minimum Till
G-009416	NW 1/4	14	7	16	73.0	No Till
G-009417	NW1/4 NE1/4	14	7	16	60.0	No Till
G-009596	NE of SE 1/4	29	6	16	148.6	No Till
G-009669	NE 1/4	24	6	19	137.0	No Till
G-010285	NW 1/4	17	8	13	132.0	No Till
G-010452	NE 1/4	6	7	16	66.0	No Till
G-010959	SE 1/4	6	5	17	135.0	No Till
G-011029	NE1/4 NW1/4	12	7	16	129.0	Minimum Till

Appendix C: Tri-Basin NRD Platte Basin No Till Acres - 2021

Well Reg	Sub Section	Section	Township	Range	Irrigated Acres	Tillage
G-011361	NE 1/4	4	6	17	165.0	No Till
G-011646	SW 1/4	15	8	18	180.0	Minimum Till
G-011958	NW 1/4	26	5	16	158.6	No Till
G-012177	SE 1/4	21	8	14	143.0	No Till
G-012216	NE 1/4	25	7	18	62.0	No Till
G-012366	NE 1/4	11	5	19	144.0	No Till
G-012428	NW 1/4	22	8	13	127.0	Minimum Till
G-012650	SW 1/4	25	7	21	72.0	Minimum Till
G-012652	SE 1/4	31	7	19	156.0	No Till
G-013067	SE 1/4	31	7	17	5.0	No Till
G-013352	SW 1/4	24	5	16	133.0	No Till
G-013356	SE 1/4	35	7	21	136.0	No Till
G-013511	SW 1/4	31	5	16	31.3	No Till
G-013607	SW 1/4	25	8	15	65.0	No Till
G-013618	SW 1/4	34	6	19	156.0	No Till
G-014730	SW 1/4	16	8	13	69.0	Minimum Till
G-014731	SW 1/4	16	8	13	25.0	Minimum Till
G-014735	NW 1/4	17	7	19	80.0	Minimum Till
G-015124	SE 1/4	35	7	18	135.0	Minimum Till
G-015125	NE 1/4	12	6	18	145.0	No Till
G-015428	NW 1/4	21	8	18	130.0	No Till
G-015504	NW 1/4 of NW 1/4	24	7	17	160.0	No Till
G-015907	SE 1/4	17	8	17	47.0	Minimum Till
G-015956	NW 1/4	12	6	18	150.0	No Till
G-015957	SW 1/4	1	6	18	140.0	No Till
G-015972	SE 1/4	13	8	13	139.0	No Till
G-015987	SW 1/4	19	5	19	144.0	No Till
G-016205	NE 1/4	26	7	21	120.0	No Till
G-016211	SW 1/4	31	6	18	84.0	No Till
G-016226	NW 1/4	17	5	16	65.0	No Till
G-016296	SW 1/4	21	6	16	152.0	No Till
G-016386	SW 1/4	17	5	16	120.0	Minimum Till
G-016781	SW 1/4	25	8	15	65.0	No Till
G-016902	NW 1/4 of NW 1/4	16	7	16	132.0	No Till
G-017090	SE 1/4	22	8	14	135.0	No Till
G-017198	SW 1/4	13	8	13	65.0	No Till
G-017743	SW 1/4 of SW 1/4	3	7	16	132.0	Minimum Till
G-017750	NW 1/4	28	5	16	136.0	No Till
G-018340	SE 1/4	35	5	19	150.0	Minimum Till
G-018673	NW 1/4	24	8	14	40.0	No Till
G-019980	SE 1/4	15	6	19	8.0	No Till
G-020298	NW 1/4	30	5	16	77.0	No Till
G-020360	NW 1/4 of NW 1/4	18	7	16	60.0	No Till

Appendix C: Tri-Basin NRD Platte Basin No Till Acres - 2021

Well Reg	Sub Section	Section	Township	Range	Irrigated Acres	Tillage
G-020404	SW 1/4	14	5	19	135.0	No Till
G-020559	NE 1/4	24	5	17	133.0	No Till
G-020611	SE 1/4	16	5	19	80.0	No Till
G-020681	SW 1/4	21	7	19	155.0	No Till
G-021172	SE 1/4	6	6	20	108.0	Minimum Till
G-021397	SE 1/4 of NW 1/4	7	7	16	8.0	No Till
G-021595	NE 1/4	31	7	17	66.0	No Till
G-021609	NE 1/4	21	7	17	142.0	No Till
G-021705	NW 1/4	18	5	18	76.0	Minimum Till
G-021726	NE 1/4 of NE 1/4	27	7	17	30.0	No Till
G-0224341	SE 1/4	35	5	19	146.0	Minimum Till
G-022762	NE 1/4	11	5	18	55.0	No Till
G-022892	NW 1/4	3	5	19	130.0	Minimum Till
G-022942	SE 1/4	36	6	20	89.0	No Till
G-022971	SE 1/4	32	5	18	130.0	No Till
G-023062	SW 1/4	4	5	19	132.0	No Till
G-023069	NE 1/4	36	5	16	145.0	Minimum Till
G-023075	NE 1/4	31	5	18	65.0	No Till
G-023093	SW 1/4	13	7	20	136.0	Minimum Till
G-023124	SW 1/4	32	7	19	139.0	No Till
G-023268	NW 1/4 of SE 1/4	26	7	16	65.0	No Till
G-023301	NW 1/4	15	5	17	130.0	No Till
G-023320	NE 1/4	23	7	18	152.0	No Till
G-023406	SW 1/4	7	5	16	92.2	No Till
G-023474	NE 1/4	26	5	16	158.6	No Till
G-023531	SW 1/4 of SW 1/4	33	7	16	154.0	No Till
G-023624	SE 1/4	18	5	19	135.0	Minimum Till
G-023699	NW 1/4	9	6	18	130.0	No Till
G-023721	SW 1/4	31	5	16	122.4	No Till
G-023920	NE 1/4	22	5	16	115.0	No Till
G-023999	NW 1/4	36	6	18	30.0	No Till
G-024090	NE 1/4	7	5	18	152.0	Minimum Till
G-024222	SW 1/4	11	5	19	131.0	No Till
G-024234	NE 1/4	19	6	16	115.0	No Till
G-024308	NE 1/4 of SW 1/4	15	7	17	146.0	No Till
G-024309	SW 1/4	17	7	19	232.0	No Till
G-024325	SW 1/4	36	7	17	76.0	No Till
G-024341	NE 1/4	26	5	19	146.0	Minimum Till
G-024429	SW 1/4	17	8	17	47.0	Minimum Till
G-024524	SW 1/4	24	6	20	63.0	No Till
G-024590	NW NW 1/4	24	6	20	106.0	No Till
G-024713	NE 1/4	4	5	16	144.0	No Till
G-024728	SE 1/4	24	6	20	130.0	No Till

Appendix C: Tri-Basin NRD Platte Basin No Till Acres - 2021

Well Reg	Sub Section	Section	Township	Range	Irrigated Acres	Tillage
G-024757	SW 1/4	17	5	19	149.0	Minimum Till
G-024986	NE 1/4	1	6	18	130.0	No Till
G-025009	SW 1/4	29	5	16	49.0	No Till
G-025010	NW 1/4	29	5	16	139.0	No Till
G-025032	NE 1/4	13	5	17	72.0	No Till
G-025056	NE 1/4	35	5	19	151.0	No Till
G-025073	SE 1/4	24	5	17	130.0	No Till
G-025108	NE 1/4	8	5	19	148.0	No Till
G-025126	SW 1/4	9	5	19	148.0	No Till
G-025164	NW 1/4	35	5	19	151.0	Minimum Till
G-025168	SW 1/4	24	6	19	135.0	No Till
G-025202	NW 1/4	26	5	19	164.5	No Till
G-025244	SE 1/4	14	6	19	141.0	No Till
G-025307	SE 1/4	21	7	19	113.0	No Till
G-025482	SE 1/4	21	7	20	140.0	No Till
G-025488	SE 1/4	28	5	18	120.0	No Till
G-025537	NW 1/4	14	8	13	53.1	No Till
G-025557	NE 1/4 of SE 1/4	31	7	17	76.0	No Till
G-025632	NE 1/4	14	5	18	55.0	No Till
G-025739	SW 1/4	33	5	17	160.0	No Till
G-025819	NE 1/4	30	5	16	153.0	Minimum Till
G-025849	NW 1/4	3	6	19	140.0	Minimum Till
G-025915	SW 1/4	8	5	16	65.0	No Till
G-025986	NE 1/4	25	6	20	145.0	No Till
G-025998	SW 1/4	13	5	19	45.0	No Till
G-026069	lots 11,12,13,14	18	6	17	155.0	No Till
G-026085	SE 1/4	27	6	19	131.0	Minimum Till
G-026250	SW 1/4	35	6	19	145.0	No Till
G-026280	NW 1/4	27	6	18	136.0	No Till
G-026324	SW 1/4 of NE 1/4	33	7	16	130.0	No Till
G-026335	SE 1/4	28	6	17	127.0	No Till
G-026426	SE 1/4	32	6	17	150.0	No Till
G-026634	SE 1/4	2	6	18	85.0	No Till
G-027010	SW 1/4	24	7	20	130.0	Minimum Till
G-027064	SE 1/4	2	5	17	80.0	No Till
G-027126	NW 1/4	11	6	21	157.0	Minimum Till
G-027227	NW 1/4	34	7	21	104.0	No Till
G-027284	NW 1/4	6	5	18	140.0	No Till
G-027416	NE 1/4	17	6	19	144.0	No Till
G-027444	NW 1/4	8	5	16	75.0	No Till
G-027510	SW 1/4	15	5	18	155.0	No Till
G-027543	NE 1/4	25	7	20	85.0	No Till
G-027593	N2 SE 1/4	19	8	17	74.0	No Till

Appendix C: Tri-Basin NRD Platte Basin No Till Acres - 2021

Well Reg	Sub Section	Section	Township	Range	Irrigated Acres	Tillage
G-027644	NE 1/4	14	5	19	160.0	No Till
G-027808	SE 1/4	16	5	18	98.0	No Till
G-027841	lot 9	18	8	17	101.0	No Till
G-027921	SE 1/4	24	5	16	145.0	No Till
G-028007	NE 1/4	22	6	20	147.0	No Till
G-028013	NE 1/4	25	5	17	130.0	No Till
G-028083	SE 1/4 of NW 1/4	26	7	16	270.0	Minimum Till
G-028109	SW 1/4	17	7	20	118.0	No Till
G-028120	NW 1/4	34	5	17	66.0	No Till
G-028336	SW 1/4	31	5	16	30.0	No Till
G-028370	SW 1/4	32	6	18	100.4	No Till
G-028692	SW 1/4	17	5	18	130.0	No Till
G-028884	SW 1/4	29	7	17	71.0	No Till
G-028913	NW 1/4	24	7	20	61.0	Minimum Till
G-029057	NW 1/4	26	6	18	151.0	No Till
G-029273	NW 1/4	36	5	17	74.5	Minimum Till
G-029462	SE 1/4	26	5	16	156.0	Minimum Till
G-029478	SE 1/4	13	6	17	67.0	No Till
G-029643	SE 1/4	2	5	19	140.0	No Till
G-029791	SE 1/4	29	5	19	158.0	No Till
G-030104	SW 1/4	32	6	18	100.0	No Till
G-030174	SE 1/4	32	7	17	65.0	No Till
G-030176	SW 1/4	27	7	18	132.0	Minimum Till
G-030229	NE 1/4	24	5	16	145.5	No Till
G-030282	NE 1/4	35	5	17	120.0	No Till
G-030448	NW 1/4	34	6	19	132.0	No Till
G-030496	NW 1/4 of SW 1/4	24	7	16	146.1	Minimum Till
G-030567	NE 1/4	7	5	16	63.0	No Till
G-030693	NW 1/4	20	6	18	154.0	No Till
G-030725	SE 1/4	35	5	18	81.0	No Till
G-030784	SW 1/4	36	5	19	128.0	Minimum Till
G-031086	SE 1/4	27	5	18	141.0	No Till
G-031315	SE 1/4	16	6	18	131.0	No Till
G-031354	NE 1/4	1	6	21	117.0	No Till
G-031620	NW 1/4	23	5	18	133.0	No Till
G-031733	SW 1/4	13	5	17	131.3	No Till
G-031740	NW 1/4	24	6	19	140.0	No Till
G-031757	NE1/4	30	7	16	156.0	Minimum Till
G-031885	SW 1/4 of SW 1/4	24	7	17	71.0	No Till
G-032082	NE 1/4	9	5	17	67.0	No Till
G-032103	NW NE 1/4	18	5	19	75.0	Minimum Till
G-032220	NE 1/4 of SE 1/4	36	7	16	145.0	No Till
G-032287	SW 1/4	24	5	19	132.0	No Till

Appendix C: Tri-Basin NRD Platte Basin No Till Acres - 2021

Well Reg	Sub Section	Section	Township	Range	Irrigated Acres	Tillage
G-032447	NW 1/4	30	6	18	152.0	No Till
G-032452	NE 1/4	28	6	19	143.0	No Till
G-032795	SE 1/4	25	6	20	152.0	No Till
G-032987	SW 1/4	30	6	18	138.0	No Till
G-033527	lots 11, 12, 13 & 14	31	8	17	134.0	No Till
G-033786	SW 1/4	7	5	18	180.0	No Till
G-034026	NW 1/4	24	5	18	135.0	No Till
G-034048	lots 15 & 16	31	8	17	100.0	No Till
G-034049	SE 1/4	31	8	17	134.0	No Till
G-034091	SW 1/4	14	6	20	151.0	No Till
G-034095	NE 1/4	23	8	17	77.0	Minimum Till
G-034096	NE 1/4	23	8	17	77.0	Minimum Till
G-034163	NE 1/4	20	5	19	149.3	No Till
G-034186	SW 1/4	25	5	19	127.0	No Till
G-034320	SE 1/4	30	8	16	126.0	No Till
G-034321	SW 1/4	30	8	16	126.0	No Till
G-034439	SE 1/4 of NW 1/4	10	7	16	132.0	No Till
G-034497	NE 1/4	31	8	17	133.0	No Till
G-034558	SE 1/4	6	6	20	78.0	Minimum Till
G-034763	SE 1/4	16	7	19	67.5	No Till
G-034766	SW 1/4 of SE 1/4	20	7	16	151.0	No Till
G-034808	NW 1/4	32	6	19	142.0	No Till
G-034898	lots 9, 10, 15 & 16	19	8	17	149.0	Minimum Till
G-035028	SE 1/4	11	6	18	155.0	Minimum Till
G-035035	NW 1/4	22	7	16	135.0	No Till
G-035158	NW 1/4	34	5	16	51.0	No Till
G-035306	NE 1/4	19	8	16	136.0	Minimum Till
G-035658	SE 1/4	4	5	19	147.0	No Till
G-035734	SW 1/4	31	6	19	82.0	No Till
G-035763	lots 4, 5	7	6	17	110.0	No Till
G-035846	NE 1/4	23	7	21	25.0	No Till
G-036446	SE 1/4	28	8	14	132.0	No Till
G-036786	SE 1/4	31	5	18	116.0	No Till
G-036818	NW 1/4	4	6	20	95.0	Minimum Till
G-036947	SE 1/4	23	5	17	79.0	No Till
G-037113	NE 1/4	24	7	18	14.4	No Till
G-037119	NE 1/4	30	8	17	133.0	No Till
G-037172	NE 1/4	11	5	17	150.0	No Till
G-037212	Cent of SE 1/4	7	7	17	150.0	Minimum Till
G-037236	NW 1/4 of SE 1/4	7	7	16	120.0	No Till
G-037484	NW 1/4	29	5	19	145.0	No Till
G-037542	SW 1/4	34	7	20	164.0	No Till
G-037999	NW 1/4	12	6	21	144.0	No Till

Appendix C: Tri-Basin NRD Platte Basin No Till Acres - 2021

Well Reg	Sub Section	Section	Township	Range	Irrigated Acres	Tillage
G-038040	NE 1/4	29	6	19	140.0	No Till
G-038067	SW of NE 1/4	28	5	18	132.0	No Till
G-038199	lots 1, 2, 7 & 8	30	8	17	132.0	No Till
G-038793	NW 1/4	21	7	19	66.0	No Till
G-039345	NW 1/4	4	5	16	146.0	Minimum Till
G-039385	NW 1/4	7	5	19	76.0	No Till
G-039539	lots 9, 10, 15 & 16	7	6	17	145.0	No Till
G-039540	SW 1/4	25	6	19	140.0	No Till
G-039565	SE 1/4	36	7	20	148.0	No Till
G-039594	SE 1/4	27	7	21	81.0	No Till
G-039642	NW 1/4 of NW 1/4	24	7	17	140.0	No Till
G-039643	SE 1/4	18	5	19	85.0	Minimum Till
G-040036	SW 1/4	15	6	18	145.0	No Till
G-040116	NE 1/4	36	5	19	145.0	Minimum Till
G-040134	NW 1/4	31	5	18	135.0	No Till
G-040199	SE 1/4	30	8	17	132.0	No Till
G-040342	NW 1/4 of SE 1/4	5	7	17	130.0	No Till
G-040343	SW 1/4	8	6	19	140.0	No Till
G-040491	SE 1/4	13	5	19	152.0	No Till
G-041088	SE 1/4	25	8	15	120.0	No Till
G-041182	SW 1/4	30	6	19	129.0	No Till
G-041216	SE 1/4	24	8	17	130.0	Minimum Till
G-041383	SE 1/4	17	8	17	80.0	No Till
G-041384	NE 1/4	20	8	17	20.0	No Till
G-041432	SW 1/4	4	6	17	65.0	No Till
G-041441	NW 1/4	11	5	19	137.0	Minimum Till
G-041487	SE 1/4	10	6	20	152.0	No Till
G-041544	lots 3-6	19	5	17	76.0	No Till
G-041780	NW1/4 SW1/4	26	7	17	140.0	No Till
G-041781	SE 1/4 of NE 1/4	34	7	17	150.0	No Till
G-041783	SE 1/4	11	5	19	144.0	No Till
G-041802	NW 1/4	23	6	19	156.0	No Till
G-041970	SE 1/4	24	6	18	148.0	No Till
G-042013	NW 1/4	32	5	18	150.0	No Till
G-042184	NW SE 1/4	26	7	20	148.0	No Till
G-042269	NE 1/4	9	6	20	139.0	No Till
G-042374	SE 1/4 of SE 1/4	4	7	17	62.0	No Till
G-042381	NW 1/4	28	6	19	160.0	Minimum Till
G-042426	NE 1/4	21	8	13	147.4	No Till
G-042443	SW 1/4	11	6	19	137.0	No Till
G-042526	NW 1/4	22	5	16	155.0	No Till
G-042628	NW 1/4 of NW 1/4	14	7	17	130.0	No Till
G-042824	SW 1/4	11	6	17	159.9	Minimum Till

Appendix C: Tri-Basin NRD Platte Basin No Till Acres - 2021

Well Reg	Sub Section	Section	Township	Range	Irrigated Acres	Tillage
G-042864	SE 1/4	15	5	19	155.0	Minimum Till
G-043164	NE 1/4	32	8	17	135.0	No Till
G-043853	NE 1/4	24	8	13	127.0	No Till
G-044065	NW 1/4	22	6	17	160.0	No Till
G-044222	NE 1/4	28	8	18	161.0	No Till
G-044258	SW 1/4	20	6	18	156.0	No Till
G-044283	SE 1/4	20	6	18	158.0	No Till
G-044391	SE 1/4	16	8	17	108.0	Minimum Till
G-044521	NE 1/4	35	8	15	130.0	No Till
G-044570	NW 1/4	18	6	18	130.0	No Till
G-044612	NE 1/4	4	5	17	130.0	No Till
G-044680	NE 1/4	5	5	19	141.0	No Till
G-044779	NW 1/4	9	6	19	143.0	No Till
G-044831	NW 1/4	35	8	15	128.0	No Till
G-044832	SE 1/4	27	8	14	132.0	No Till
G-044895	NE 1/4	34	8	17	136.0	No Till
G-044968	NE 1/4	21	6	18	148.0	No Till
G-044991	SE 1/4	22	5	18	150.0	No Till
G-045284	SE 1/4	22	6	18	68.3	No Till
G-045600	NW 1/4	14	5	19	128.0	No Till
G-045710	NE 1/4	18	6	19	148.0	No Till
G-045821	NE 1/4	34	7	21	144.0	No Till
G-046723	lots 1 & 8	30	7	17	68.0	No Till
G-046945	SW 1/4	13	7	18	132.0	No Till
G-046947	Cent of SE 1/4	3	7	17	65.0	No Till
G-047106	NE 1/4	17	7	19	149.0	No Till
G-047120	SW 1/4	34	8	17	135.0	No Till
G-047172	SW 1/4	5	5	17	154.0	Minimum Till
G-047270	SE 1/4	1	5	18	55.0	No Till
G-047630	SW 1/4	6	5	18	72.0	No Till
G-047719	NW 1/4	21	5	18	138.8	No Till
G-047810	NW 1/4	29	7	17	150.0	Minimum Till
G-048083	NW 1/4	25	5	17	130.0	No Till
G-048258	SE 1/4	25	8	18	145.0	No Till
G-048259	NE 1/4	25	6	19	295.0	No Till
G-048684	NE 1/4	34	8	15	150.0	No Till
G-048991	NW 1/4	36	8	17	134.0	No Till
G-049083	NW 1/4	25	6	19	295.0	No Till
G-049239	NW 1/4	25	8	17	153.0	No Till
G-049240	SW 1/4	25	8	17	133.0	No Till
G-049326	NW 1/4	2	6	21	160.0	Minimum Till
G-049435	NW 1/4	15	5	18	70.0	No Till
G-049525	SW 1/4	28	8	18	148.0	No Till

Appendix C: Tri-Basin NRD Platte Basin No Till Acres - 2021

Well Reg	Sub Section	Section	Township	Range	Irrigated Acres	Tillage
G-049567	SE 1/4	26	5	19	146.0	Minimum Till
G-049914	NE 1/4	22	5	19	145.0	No Till
G-050066	NE 1/4	11	6	21	147.0	Minimum Till
G-050203	SE 1/4	17	6	18	135.0	No Till
G-050365	SW 1/4	35	5	16	66.0	No Till
G-051199	SW 1/4	33	5	17	160.0	No Till
G-051375	NE 1/4	28	8	17	134.0	No Till
G-051378	SE 1/4	35	5	17	126.0	No Till
G-051674	NW 1/4	8	5	16	75.0	No Till
G-052078	SE 1/4	28	6	19	122.0	No Till
G-052232	SE 1/4 of NE 1/4	13	7	17	25.0	No Till
G-052272	NE 1/4	4	6	19	290.0	Minimum Till
G-052273	SE 1/4	31	6	19	68.0	No Till
G-052566	NW 1/4	10	6	21	132.0	No Till
G-052581	SE 1/4	8	5	19	146.0	Minimum Till
G-052826	NW 1/4	13	5	17	145.0	No Till
G-053486	SE 1/4	33	5	17	75.0	No Till
G-053581	SE 1/4	34	8	17	134.0	No Till
G-053686	NW 1/4	34	8	15	150.0	No Till
G-053691	SW 1/4	15	5	17	151.3	No Till
G-053867	lots 1, 2, 7 & 8	7	6	17	145.0	No Till
G-053938	NE 1/4	32	5	19	174.0	No Till
G-054024	Cent of SW 1/4	10	7	17	132.0	No Till
G-054318	NE 1/4	36	5	17	55.0	No Till
G-055381	NE 1/4	17	7	17	148.0	No Till
G-055382	SE 1/4	17	7	17	156.2	Minimum Till
G-055469	SE 1/4	16	5	17	100.0	No Till
G-055674	SW 1/4	21	8	18	103.0	No Till
G-055675	SE 1/4	21	8	18	163.0	No Till
G-055771	NW 1/4	35	6	20	156.0	No Till
G-055863	SW 1/4	25	8	18	133.0	No Till
G-055864	NE1/4 NW1/4	12	7	17	133.0	Minimum Till
G-056539	SE 1/4	27	8	17	135.0	No Till
G-056619	SW 1/4	31	6	18	70.0	No Till
G-056707	NE 1/4	23	5	17	136.0	No Till
G-056775	NW 1/4	26	5	17	140.0	No Till
G-057046	SW 1/4	32	5	18	145.0	No Till
G-057066	SW 1/4	28	6	16	58.0	No Till
G-057225	NW 1/4	26	5	18	135.0	No Till
G-058321	SW 1/4	26	8	18	130.0	No Till
G-058722	SE 1/4 of SW 1/4	9	7	17	154.0	Minimum Till
G-059220	SW 1/4	20	5	19	128.0	No Till
G-059221	SE 1/4	19	5	18	119.0	No Till

Appendix C: Tri-Basin NRD Platte Basin No Till Acres - 2021

Well Reg	Sub Section	Section	Township	Range	Irrigated Acres	Tillage
G-059678	NW 1/4 of NE 1/4	3	7	17	134.0	No Till
G-059679	lots 7, 8, 9 & 10	30	8	17	76.0	No Till
G-060103	NW 1/4	17	7	17	135.0	No Till
G-060270	SE 1/4	17	8	13	62.0	No Till
G-060341	SE 1/4	17	5	17	130.0	No Till
G-060613	SE 1/4	24	5	18	65.0	No Till
G-060768	Cent of SE 1/4	24	7	17	151.0	Minimum Till
G-060781	SW 1/4	13	8	18	58.0	No Till
G-060846	Cent of NE 1/4	2	7	17	133.0	No Till
G-060847	Cent of NW 1/4	2	7	17	133.0	No Till
G-060870	SW 1/4	26	5	17	135.0	No Till
G-061041	SE 1/4	24	5	16	5.0	No Till
G-061141	NW 1/4	20	5	17	131.5	No Till
G-061170	NW 1/4	3	5	17	140.0	No Till
G-061236	SW 1/4	17	5	16	120.0	Minimum Till
G-061237	SE 1/4	30	5	16	79.0	Minimum Till
G-061318	NE 1/4	26	8	17	136.0	No Till
G-061360	NE 1/4	36	6	20	144.0	No Till
G-061449	SE 1/4	1	6	19	150.0	Minimum Till
G-061500	SW 1/4	10	6	21	145.0	No Till
G-061776	NE 1/4	32	7	20	153.0	No Till
G-061971	SE 1/4	31	7	17	68.0	No Till
G-062149	SE 1/4	26	5	18	117.5	No Till
G-062245	pts of S/2 of NE/4 & N/2 of SE/4	7	5	17	100.0	No Till
G-062292B	SE 1/4	13	5	18	157.0	No Till
G-062383	SW 1/4	36	6	19	135.0	No Till
G-062683	SW 1/4	29	6	20	64.0	No Till
G-062791	SE 1/4	35	8	17	133.0	No Till
G-062876	NE 1/4 of SW 1/4	7	7	16	60.0	No Till
G-062948	NE 1/4	28	5	16	83.0	No Till
G-063124A	SE 1/4	32	5	17	136.0	No Till
G-063124B	SE 1/4	32	5	17	68.0	No Till
G-063158	SE 1/4	30	7	18	153.7	No Till
G-063216	NW 1/4	16	7	17	128.0	No Till
G-063234	SW 1/4	12	6	18	145.0	No Till
G-063395	NE 1/4	36	8	17	133.5	No Till
G-063756	NW 1/4	29	7	20	145.0	No Till
G-063757	lots 3, 4, 5 & 6	31	8	17	136.0	No Till
G-063815	NE 1/4	35	8	17	133.0	No Till
G-063852	NE 1/4	7	5	17	115.0	No Till
G-064170	lots 11, 12, 13 & 14	30	8	17	138.0	No Till
G-064547	NW 1/4 of SW 1/4	36	7	16	134.0	Minimum Till

Appendix C: Tri-Basin NRD Platte Basin No Till Acres - 2021

Well Reg	Sub Section	Section	Township	Range	Irrigated Acres	Tillage
G-064756	NW 1/4 of NE 1/4	29	7	16	79.0	Minimum Till
G-064932	SW 1/4	36	7	21	60.0	No Till
G-065049	NW 1/4	36	7	19	135.0	No Till
G-065185	lots 3, 4, 5 & 6	30	8	17	130.0	No Till
G-065186	lots 1 & 2, & 15 & 16 in sec 30	30	8	17	175.0	No Till
G-065187	lots 7, 8, 9 & 10	31	8	17	132.0	No Till
G-065342	lot 10	18	8	17	53.0	No Till
G-065357	Cent of NE 1/4	2	7	16	132.0	No Till
G-065491	SE 1/4	29	5	18	133.0	No Till
G-066228	NE 1/4	28	5	18	14.0	No till
G-066266	NE 1/4	13	8	13	60.0	No Till
G-066268	SW 1/4	15	5	19	135.0	Minimum Till
G-066446	lots 3, 5, 4, & 6	31	5	17	164.0	No Till
G-066520	SE 1/4	28	8	18	56.0	No Till
G-066588	NE 1/4	19	5	18	135.0	No Till
G-067052	SW 1/4	29	5	16	82.0	No Till
G-067406	NE 1/4	30	5	17	121.0	No Till
G-067407	SE 1/4	31	5	17	128.0	No Till
G-067828	SE 1/4 of NW 1/4	2	7	16	132.0	No Till
G-067832	SW 1/4	35	8	16	132.0	No Till
G-067833	SE 1/4	35	8	16	132.0	No Till
G-067913	NE 1/4	27	8	17	135.0	No Till
G-067974	SW 1/4	24	5	17	130.0	No Till
G-067975	SW 1/4 of NE 1/4	1	7	17	135.0	No Till
G-067976	SW 1/4 of NW 1/4	1	7	17	135.0	No Till
G-067977	Lot 3	6	7	17	35.6	No Till
G-067978	Lot 4	6	7	17	35.6	No Till
G-068036	Cent of NE 1/4	25	8	18	130.0	No Till
G-068048	lots 3, 5, 4, & 6	30	5	17	160.5	No Till
G-068245	lots 11 & 14	7	6	17	78.0	No Till
G-068317	NW 1/4	23	6	17	227.0	No Till
G-068598	SE 1/4	22	6	19	148.0	No Till
G-068846	SW 1/4	32	5	17	134.4	No Till
G-068947	NE 1/4	23	5	16	135.0	No Till
G-069017	NW 1/4	35	8	17	133.0	No Till
G-069018	SW 1/4	35	8	17	133.0	No Till
G-069042	SW 1/4	31	5	18	138.7	No Till
G-069108	Cent of NW 1/4	8	7	17	131.0	No Till
G-069112	SW 1/4	4	5	16	7.5	Minimum Till
G-069166	NE 1/4	8	6	17	130.0	No Till
G-069234	NE 1/4	14	8	13	148.8	Minimum Till

Appendix C: Tri-Basin NRD Platte Basin No Till Acres - 2021

Well Reg	Sub Section	Section	Township	Range	Irrigated Acres	Tillage
G-069282	SW 1/4	3	6	18	125.0	No Till
G-069535	SE 1/4	25	5	17	24.0	No Till
G-069536	SE 1/4 of NE 1/4	4	7	17	132.0	No Till
G-069636	NW 1/4	28	8	18	134.0	No Till
G-069714	NE 1/4	8	5	16	135.0	No Till
G-069776	SE 1/4	21	6	18	162.3	No Till
G-070077	NE 1/4	23	8	18	145.0	No Till
G-070221	SE 1/4	14	5	19	69.0	No Till
G-070269	NW 1/4 of SE 1/4	11	7	16	6.0	No Till
G-070472	Cent of NW 1/4	10	7	17	132.0	No Till
G-070514	NW 1/4	28	5	18	129.0	No Till
G-070660	NE SW 1/4	21	8	13	134.0	No Till
G-070859	lots 3, 4, 5, & 6	30	6	17	76.0	No Till
G-070881	NE 1/4	23	5	18	135.0	No Till
G-070882	SE 1/4	23	5	18	135.0	No Till
G-070891	SW 1/4	18	6	18	130.0	No Till
G-070993	SW 1/4	22	6	17	102.8	Minimum Till
G-071117	SW 1/4	20	5	16	154.0	No Till
G-071119	NE 1/4	24	6	19	134.0	No Till
G-071157	SW 1/4	18	5	19	80.0	Minimum Till
G-071266	NW 1/4	24	7	19	135.0	No Till
G-071480	NW 1/4 of NE 1/4	19	7	16	102.0	Minimum Till
G-071511	NE 1/4	36	7	18	76.0	No Till
G-071535	lots 13 & pt S2 lot 12	18	5	17	61.0	No Till
G-071933	SW 1/4	17	6	18	145.0	Minimum Till
G-071957	NW 1/4	23	7	20	121.0	Minimum Till
G-072067	SW 1/4	19	8	16	61.0	Minimum Till
G-072176	SW 1/4	30	8	15	145.0	No Till
G-072383	NE 1/4	14	5	17	118.5	No Till
G-072456	NE 1/4	20	7	17	136.0	Minimum Till
G-072462	SE 1/4	17	5	18	134.0	No Till
G-072631	NW 1/4	23	8	17	77.0	Minimum Till
G-072667	SW 1/4	5	6	20	141.0	Minimum Till
G-072701	NW 1/4	20	5	18	130.0	No Till
G-072797	SE 1/4	25	7	21	102.0	No Till
G-072918	NW 1/4	13	6	19	25.0	No Till
G-073120	SW 1/4	26	6	19	91.0	No Till
G-073478	NE 1/4	31	5	16	137.0	Minimum Till
G-073554	NE 1/4	17	5	16	65.0	No Till
G-073629	SW 1/4 of NW 1/4	24	7	16	143.0	Minimum Till
G-073711	NE 1/4	31	6	19	145.0	No Till
G-073772	SE 1/4	14	6	20	140.0	No Till

Appendix C: Tri-Basin NRD Platte Basin No Till Acres - 2021						
Well Reg	Sub Section	Section	Township	Range	Irrigated Acres	Tillage
G-074132	SE 1/4	31	6	17	158.0	Minimum Till
G-074203	SE 1/4	19	6	17	80.0	No Till
G-074261	NW 1/4	27	7	19	139.0	Minimum Till
G-074324	lots 11, 12, 13, & 14	31	5	17	141.0	No Till
G-074329	lots 1, 7, 8, 9 & 10	31	6	17	67.0	No Till
G-074330	SW 1/4	19	6	19	65.0	No Till
G-074474	NE 1/4	10	5	18	145.0	No Till
G-074532	SE 1/4	17	5	17	56.0	No Till
G-074549	NE 1/4	20	7	19	134.0	No Till
G-074588	SE 1/4	36	5	16	155.0	No Till
G-074640	NE 1/4	22	5	18	132.0	No Till
G-074644	NE 1/4	35	6	17	68.0	No Till
G-074748	NW 1/4	29	7	18	130.0	No Till
G-074759	NW 1/4	21	6	18	154.0	No Till
G-074773	NW 1/4	20	5	16	130.0	No Till
G-074785	NW 1/4	27	6	20	151.0	No Till
G-074863	SW 1/4	27	6	19	157.0	No Till
G-075182	NE 1/4	31	7	18	141.0	Minimum Till
G-075303	NW 1/4	25	8	18	134.0	No Till
G-076517	lots pt 7, 9, 10, 11, 14, 15, & pt 16	7	5	17	255.0	No Till
G-076518	East	18	5	17	135.0	No Till
G-076519	lots 1, 2, 7, & 8	30	5	17	135.0	No Till
G-076520	SW 1/4	18	5	18	135.0	No Till
G-076521	NE 1/4	26	5	18	100.0	No Till
G-077018	SW 1/4	28	8	17	138.0	No Till
G-077557	NW 1/4	21	7	17	135.0	No Till
G-077625	NW 1/4 of SE 1/4	24	7	16	134.8	No Till
G-077982	NW 1/4 of SE 1/4	25	7	16	150.8	No Till
G-078200	SE 1/4	12	8	13	131.0	Minimum Till
G-078372	SW 1/4 of NE 1/4	25	7	16	71.0	No Till
G-081367	SW 1/4	32	6	16	170.0	No Till
G-081487	NW 1/4 of NW 1/4	3	7	17	133.0	No Till
G-082100	SE 1/4	11	7	16	109.0	No Till
G-082106	NE 1/4	32	5	16	126.0	Minimum Till
G-082130	SE 1/4 of NW 1/4	5	7	16	220.0	No Till
G-083647	SW 1/4	14	5	17	134.0	Minimum Till
G-085981	NW of NW 1/4	24	8	18	40.0	No Till

Appendix C: Tri-Basin NRD Platte Basin No Till Acres - 2021

Well Reg	Sub Section	Section	Township	Range	Irrigated Acres	Tillage
G-086015	SW 1/4	13	5	19	145.0	No Till
G-086432	NW 1/4	4	6	16	143.0	No Till
G-086436	SW 1/4	16	7	17	135.0	No Till
G-086583	NE 1/4	21	8	18	134.0	No Till
G-086748	NW 1/4	19	5	16	120.0	No Till
G-086858	NW 1/4	36	5	19	128.0	No Till
G-087522	NW 1/4	14	5	17	133.0	No Till
G-087523	SE 1/4	9	6	19	65.0	No Till
G-088487	SE 1/4	16	8	18	73.0	Minimum Till
G-088498	SW 1/4	5	6	19	135.0	No Till
G-088499	NE 1/4	33	8	17	130.0	No Till
G-089768	NE 1/4	10	6	20	146.0	No Till
G-090257	SE 1/4	10	5	18	84.0	No Till
G-090649	NE 1/4	19	5	19	130.0	No Till
G-090860	S2 of SE 1/4	19	8	17	58.0	No Till
G-090861	lots 11, 12, 13 & 14	19	8	17	133.0	No Till
G-091179	NW 1/4	25	6	20	135.0	No Till
G-091242	NE 1/4	21	5	17	100.7	No Till
G-091279	SE 1/4	22	6	20	38.0	No Till
G-091503	SE 1/4	12	5	19	77.0	No Till
G-091575	NE 1/4	18	5	18	135.0	No Till
G-093786	NE 1/4	15	8	18	40.0	Minimum Till
G-094233	NE 1/4	31	5	19	81.0	Minimum Till
G-094234	SE 1/4	31	5	19	163.0	No Till
G-094725	NW 1/4	26	6	19	218.0	No Till
G-095253	SW 1/4 of SE 1/4	5	7	16	72.0	No Till
G-095680	NE 1/4	18	5	18	130.0	No Till
G-096952	NW 1/4	31	5	19	119.0	No Till
G-096953	SW 1/4	31	5	19	130.0	No Till
G-100592	Cent of NE 1/4	7	7	17	130.0	Minimum Till
G-100986	lots pts 5, 6, 7, & 8	6	6	17	140.0	No Till
G-104054	pt of lots 2, 3, 4, 5, 6 & 7	18	8	17	110.0	No Till
G-104055	lot pts2, 7 & all 8	18	8	17	70.0	No Till
G-104231	NE 1/4	16	5	19	135.0	No Till
G-106091	SW 1/4 of SW 1/4	5	7	16	54.0	No Till
G-106128	SE 1/4	36	5	19	140.0	No Till
G-108959	NW 1/4 of NW 1/4	27	7	17	130.0	No Till

Appendix C: Tri-Basin NRD Platte Basin No Till Acres - 2021

Well Reg	Sub Section	Section	Township	Range	Irrigated Acres	Tillage
G-109792	NW 1/4	19	5	19	125.0	No Till
G-110137	SE 1/4	35	6	19	131.0	No Till
G-110559	NE 1/4	14	6	19	146.0	No Till
G-113765	NW 1/4	3	6	18	135.0	No Till
G-114016	NE 1/4	13	6	19	31.0	No Till
G-115304	SE	7	5	19	127.0	No Till
G-115336	SW 1/4	19	5	16	154.0	No Till
G-115347	SW 1/4	35	5	17	124.0	No Till
G-115591	SE 1/4	20	5	16	160.0	No Till
G-116145	NW 1/4 of NE 1/4	27	7	17	15.0	No Till
G-116684	West	18	5	17	135.0	No Till
G-119626	SE of SE 1/4	36	5	18	130.0	No Till
G-119660	NE 1/4	36	7	19	180.0	No Till
G-120087	Cent of SW 1/4	6	5	19	67.0	No Till
G-120467	SE 1/4 of NE 1/4	23	7	17	50.0	No Till
G-121369	Cent of SE 1/4	23	8	17	152.0	Minimum Till
G-121464	SW 1/4	34	6	18	115.0	No Till
G-123407	NE 1/4	5	6	16	140.0	No Till
G-124617	SW 1/4 of SW 1/4	34	7	17	151.0	Minimum Till
G-125404	SW 1/4	14	8	18	142.0	Minimum Till
G-125420	SE 1/4	19	8	16	75.0	Minimum Till
G-125421	SW 1/4 of NE 1/4	7	7	16	62.0	No Till
G-126121	SE1/4	18	7	19	130.0	No Till
G-126452	SE of NW 1/4	15	7	19	95.5	No Till
G-126657	NW of NW 1/4	25	6	17	141.5	No Till
G-126845	NW of SE 1/4	11	6	19	70.0	No Till
G-126846	SE 1/4 of SE 1/4	30	7	16	130.0	No Till
G-127045	SE of SE 1/4	19	5	16	130.0	Minimum Till
G-127327	SW 1/4 of NE 1/4	24	7	16	54.0	No Till
G-127903	NW of NE 1/4	18	7	18	120.0	Minimum Till
G-128172	SW of SW 1/4	34	7	19	37.5	No Till
G-128350	NE of NE 1/4	26	5	17	64.0	No Till
G-128351	SW of SE 1/4	26	5	17	107.0	No Till
G-129049	SW 1/4	23	6	20	78.0	No Till
G-129246	Cent of NE 1/4	5	6	17	135.0	No Till
G-129257	NW of NW 1/4	21	6	19	137.0	No Till
G-129448	NE of NW 1/4	17	7	18	100.0	No Till
G-129577	SW 1/4	28	6	19	120.0	Minimum Till
G-129611	NE of NE 1/4	2	5	19	75.0	No Till
G-129695	NW of SW 1/4	25	5	18	65.6	No Till

Appendix C: Tri-Basin NRD Platte Basin No Till Acres - 2021

Well Reg	Sub Section	Section	Township	Range	Irrigated Acres	Tillage
G-129696	NW 1/4	14	7	19	130.0	No Till
G-129768	NE of SW 1/4	36	5	18	100.0	No Till
G-129992	NE of NE 1/4	36	7	20	140.0	No Till
G-130184	SW 1/4 of SE 1/4	33	7	16	124.0	No Till
G-130452	NE of NW 1/4	17	6	18	130.0	No Till
G-130632	SW of NW 1/4	18	5	16	125.0	No Till
G-130635	SE of NE 1/4	17	6	18	130.0	Minimum Till
G-130665	SW of SW 1/4	20	7	18	125.0	No Till
G-130755	SE of NW 1/4	21	6	17	68.0	No Till
G-130799	NE of SE 1/4	23	7	19	120.0	No Till
G-131170	NW of SW 1/4	14	6	17	39.0	No Till
G-131271	SW of NW 1/4	34	7	20	75.0	No Till
G-131621	NE of SE 1/4	5	6	17	72.0	No Till
G-132076	NE 1/4	24	6	20	81.0	No Till
G-132241	NE 1/4 of SW 1/4	26	7	16	270.0	Minimum Till
G-132247	Cent of SW 1/4	29	7	20	155.0	No Till
G-132344	NW 1/4	24	6	20	6.0	No Till
G-132360	NE 1/4 of NE 1/4	24	7	17	160.0	No Till
G-132361	Lot 12	31	7	17	148.0	No Till
G-132515	SW of SE 1/4	13	6	18	144.0	No Till
G-132529	SW 1/4 of NW 1/4	30	7	16	147.0	No Till
G-132532	SE 1/4	1	6	17	155.0	Minimum Till
G-132544	SE of SE 1/4	7	6	17	65.0	No Till
G-132608	SW of SW 1/4	21	6	19	131.0	No Till
G-132613	SE 1/4	24	7	19	130.0	No Till
G-132645	SW 1/4	25	7	19	90.0	No Till
G-132798	NE of NE 1/4	17	6	17	66.0	No Till
G-132975	SW 1/4 of SE 1/4	7	7	16	54.0	No Till
G-132977	NW 1/4 of SW 1/4	5	7	16	32.0	No Till
G-132978	SW 1/4 of SW 1/4	7	7	16	120.0	No Till
G-132979	NW 1/4 of NW 1/4	5	7	16	32.0	No Till
G-133038	NE 1/4	9	6	18	130.0	No Till
G-133385	SW of SW 1/4	18	7	19	144.0	Minimum Till
G-133471	SE of NW 1/4	27	6	17	60.2	Minimum Till
G-133563	NW of NW 1/4	18	6	19	145.0	No Till
G-133633	NW of NE 1/4	19	7	19	144.0	Minimum Till
G-133634	NW of SE 1/4	14	7	20	141.6	Minimum Till
G-133725	NW 1/4 of NE 1/4	26	7	16	150.0	Minimum Till
G-134076	SW of NW 1/4	17	5	19	143.0	No Till
G-135942	SE of SE 1/4	8	6	18	144.0	No Till

Appendix C: Tri-Basin NRD Platte Basin No Till Acres - 2021						
Well Reg	Sub Section	Section	Township	Range	Irrigated Acres	Tillage
G-135943	NW of NE 1/4	23	7	20	102.0	Minimum Till
G-137381	SW1/4	31	7	17	145.0	No Till
G-137403	SW 1/4	21	7	17	135.0	No Till
G-137937	SW 1/4	36	8	17	134.0	No Till
G-138203	SW1/4	13	6	17	78.0	No Till
G-138416	NW 1/4	13	7	19	120.0	No Till
G-138594	E 1/2 of SE 1/4	27	7	17	70.0	No Till
G-139271	NW 1/4 NW 1/4	25	7	16	110.0	Minimum Till
G-139528	NW 1/4	28	7	17	65.0	Minimum Till
G-140497	SW 1/4	17	8	17	46.0	Minimum Till
G-142531	SE 1/4	31	5	16	56.0	Minimum Till
G-146199	NE1/4	16	5	17	125.0	Minimum Till
G-149890	NE1/4 of SE1/4	5	7	16	15.0	No Till
G-151663	SW 1/4	36	7	19	65.0	No Till
G-152707	SE 1/4	5	6	20	139.0	No Till
G-160745	NE NE 1/4	29	5	18	130.0	No Till
G-164549	NE 1/4 of SW 1/4	10	7	16	135.0	No Till
G-165018	NE 1/4	12	5	18	78.0	No Till
G-165675	NW 1/4	21	5	17	52.0	No Till
G-167483	NW 1/4	23	6	18	107.0	No Till
G-167695	SE 1/4	3	6	20	130.0	Minimum Till
G-169498	NE 1/4	13	6	19	267.0	No Till
G-169866	SE 1/4 of NW 1/4	8	7	16	60.0	No Till
G-169903	N 1/2 of NW 1/4	16	5	19	65.0	No Till
G-170025	NW 1/4	35	5	17	135.0	No Till
G-170397	SE of SW 1/4	20	7	17	79.0	Minimum Till
G-171454	NE 1/4	18	6	19	80.0	No Till
G-172798	NE 1/4	6	6	19	80.0	No Till
G-174557	NE	35	7	19	132.0	No Till
G-174932	NE 1/4	20	6	19	108.0	No Till
G-175830	SW 1/4 of SE 1/4	7	7	16	35.0	No Till
G-178984	SW of NW	4	5	19	40.4	Minimum Till
G-182853	SE 1/4	5	5	16	52.0	Minimum Till
G-184538	NW of NE 1/4	5	5	16	68.0	No Till

85,890.1

Appendix D: CNPPID Groundwater Recharge Diversions Summary - 2021 Platte Basin

Dates of Recharge Diversion	1/1/19 to 1/24/19	1/1/19 to 1/28/19	1/1/19 to 1/31/19	
Elwood Reservoir Diversions				
AF, in				
\$/af				
\$/other				
Notes				
Elwood Releases				
AF, in				
\$/af				
\$/other				
Notes				
E65 Canal				
AF, in			297	445.5
\$/af			44.9	44.9
\$/other				
Notes			Contract 1024 w/ 1-7-19 Amendment, for TBNRD, down to MP 19.3	Contract 1024 w/ 1-7-19 Amendment, for NDNR, down to MP 19.3
Phelps Canal				
AF, in	712.1			
\$/af	31.9			
\$/other				
Notes	10-27-19 WSA w/ PRRIP, Diversions			
Funk Lagoon				
AF, in				
\$/af				
Notes				
Funds				
Total \$	\$22,723.11	\$347,879.80	\$13,338.27	\$20,007.41
PRRIP	\$22,723.11	\$347,879.80		
NDNR				\$20,007.41
TBNRD			\$13,338.27	
NGPC				

Appendix D: CNPPID Groundwater Recharge Diversions Summary - 2021 Platte Basin

2019 (Cont. on pg. 60 & 61)				
Dates of Recharge Diversion	1-1-19 to 1-24-19	1-1-19 to 1-28-19	1-1-19 to 1-31-19	
Elwood Reservoir Diversions				
AF, in		7178.7		
\$/af		48.46		
\$/other				
Notes		11-26-18 SWA Amendment No. 2, took limit to 30,000 af. All for PRRIP. NDNR and TBNRD wanted the remainder of their contract in E65 Canal		
Elwood Releases				
AF, in				
\$/af				
\$/other				
Notes				
E65 Canal				
AF, in			297	445.5
\$/af			44.91	44.91
\$/other				
Notes			Contract 1024 w/ 1-7-19 Amendment, for TBNRD, down to MP 19.3	Contract 1024 w/ 1-7-19 Amendment, for NDNR, down to MP 19.3
Phelps Canal				
AF, in	712.10			
\$/af	31.91			
\$/other				
Notes	10-20-17 WSA w/ PRRIP, Diversions down to MP 13.3			
Funk Lagoon				
AF, in				
\$/af				
Notes				
Funds				
Total \$	\$ 22,723.11	\$ 347,879.80	\$ 13,338.27	\$20,007.40
PRRIP	\$ 22,723.11	\$ 347,879.80		
NDNR				\$20,007.40
TBNRD			\$ 13,338.27	
NGPC				

Appendix D: CNPPID Groundwater Recharge Diversions Summary - 2021 Platte Basin

2019 (Cont.)				
Dates of Recharge Diversion	5-10-19 to 5-16-19			5-10-19 to 5-20-19
Elwood Reservoir Diversions				
AF, in	941.3	123.2	184.9	
\$/af	48.46	53.77	53.77	
\$/other				
Notes	For PRRIP. 11-26-18 SWA Amendment No. 2, took limit to 30,000 af for PRRIP. 1-3-19 WSA Amendment to 1024 extends cost cap to \$402,247 for TBNRD-NDNR. 50% split until TBNRD-NDNR full then all to PRRIP. These deliveries fulfilled both amendments.	For TBNRD. 11-26-18 SWA Amendment No. 2, took limit to 30,000 af for PRRIP. 1-3-19 WSA Amendment to 1024 extends cost cap to \$402,247 for TBNRD-NDNR. 50% split until TBNRD-NDNR full then all to PRRIP. These deliveries fulfilled both amendments. TBNRD 40%, NDNR 60% of their 50% of total diversions	For NDNR. 11-26-18 SWA Amendment No. 2, took limit to 30,000 af for PRRIP. 1-3-19 WSA Amendment to 1024 extends cost cap to \$402,247 for TBNRD-NDNR. 50% split until TBNRD-NDNR full then all to PRRIP. These deliveries fulfilled both amendments. TBNRD 40%, NDNR 60% of their 50% of total diversions	
Elwood Releases				
AF, in				
\$/af				
\$/other				
Notes				
E65 Canal				
AF, in				
\$/af				
\$/other				
Notes				
Phelps Canal				
AF, in				
\$/af				
\$/other				
Notes				
Funk Lagoon				
AF, in				
\$/af				
Notes				
Funds				
Total \$	\$ 45,615.40	\$ 6,624.46	\$ 9,942.07	\$ 6,557.12
PRRIP	\$ 45,615.40			
NDNR			\$ 9,942.07	
TBNRD		\$ 6,624.46		\$ 6,557.12
NGPC				

Appendix D: CNPPID Groundwater Recharge Diversions Summary - 2021 Platte Basin

2019 (Cont.) Dates of Recharge Diversion	7-9-19 to 7-29-19	9-12-19 to 9-28-19	12-16-19 to 12-31-19	12-16-19 to 12-31-19	12-20-19 to 12-31-19
Elwood Reservoir Diversions					
AF, in	4955.2	5463.9			
\$/af	48.46	48.46			
\$/other					
Notes	For PRRIP. 6-24-19 WSA (30,000 af limit annually)	For PRRIP. 6-24-19 WSA (30,000 af limit annually)			
Elwood Releases					
AF, in					
\$/af					
\$/other					
Notes					
E65 Canal					
AF, in			250.4	375.6	
\$/af			44.91	44.91	
\$/other					
Notes			E65 Canal recharge down to MP 23.7-0.3-TBNRD under contract #1150, 60/40 split TBNRD/DNR	E65 Canal recharge down to MP 23.7-0.3 -DNR under contract #1150, 60/40 split TBNRD/DNR	
Phelps Canal					
AF, in					
\$/af					
\$/other					
Notes					
Funk Lagoon					
AF, in					
\$/af					
Notes					
Funds					
Total \$	\$ 240,128.99	\$ 264,780.59	\$ 11,245.46	\$ 16,868.20	\$ 12,101.63
PRRIP	\$ 240,128.99	\$ 264,780.59			
NDNR				\$ 16,868.20	
TBNRD			\$ 11,245.46		\$ 12,101.63
NGPC					

Appendix D: CNPPID Groundwater Recharge Diversions Summary - 2021 Platte Basin

2020						
Dates of Recharge Diversion	1-1-20 to 2-14-20	1-1-20 to 2-14-20	1-1-20 to 2-23-20	3-19-20 to 4-14-20	3-26-20 to 4-14-20	
Elwood Reservoir Diversions						
AF, in						
\$/af						
\$/other						
Notes						
Elwood Releases						
AF, in						
\$/af						
\$/other						
Notes						
E65 Canal						
AF, in	465.5	698.3			253.9	380.8
\$/af	46.26	46.26			46.26	46.26
\$/other						
Notes	E65 Canal re-charge down to MP 23.7-0.3-TBNRD under contract #1150, 60/40 split TBNRD/DNR	E65 Canal re-charge down to MP 23.7-0.3 -DNR under contract #1150, 60/40 split TBNRD/DNR			E65 Canal re-charge down to MP 23.7-0.3-TBNRD under contract #1150, 60/40 split TBNRD/DNR	E65 Canal re-charge down to MP 23.7-0.3 - DNR under contract #1150, 60/40 split TBNRD/DNR
Phelps Canal						
AF, in				910.40		
\$/af				32.87		
\$/other						
Notes				9-25-19 WSA w/ PRRIP, Diversions down to MP 13.3		
Funk Lagoon						
AF, in						
\$/af						
Notes						
Funds						
Total \$	\$21,534.03	\$32,303.36	\$30,766.20	\$29,924.85	\$11,745.41	\$17,615.81
PRRIP				\$29,924.85		
NDNR		\$32,303.36				\$17,615.81
TBNRD	\$21,534.03		\$30,766.20		\$11,745.41	
NGPC						

Appendix D: CNPPID Groundwater Recharge Diversions Summary - 2021 Platte Basin

2020			
(Cont.)			
Dates of Recharge Diversion	7-20-20 to 9-22-20	9-21-20 to 9-22-20	11-17-20 to 12-3-20
Elwood Reservoir Diversions			
AF, in			
\$/af			
\$/other			
Notes			
Elwood Releases			
AF, in			
\$/af			
\$/other			
Notes			
E65 Canal			
AF, in			
\$/af			
\$/other			
Notes			
Phelps Canal			
AF, in		20.90	1054.40
\$/af		32.87	32.87
\$/other			
Notes		9-25-19 WSA w/PRRIP, Diversions down to MP 13.3	9-25-19 WSA w/ PRRIP, Diversions down to MP 13.3
Funk Lagoon			
AF, in			
\$/af			
Notes			
Funds			
Total \$	NA	\$686.98	\$34,658.13
PRRIP		\$686.98	\$34,658.13
NDNR			
TBNRD			
NGPC			

Appendix D: CNPPID Groundwater Recharge Diversions Summary - 2021 Platte Basin

2021 Dates of Recharge diversions	1-7-21 to 1-15-21	3-15-21 to 3-24-21	3-15-21 to 3-24-21	3-15-21 to 3-24-21	3-15-21 to 3-24-21
Elwood Reservoir Diversions					
AF, in		2114.3	845.7	1268.6	
\$/af		51.41	51.41	51.41	
\$/other					
Notes		For PRRIP. 6-24-19 WSA (30,000 af limit annually)	For TBNRD, Contract #1190	For NDNR, Contract #1190	
Elwood Releases					
AF, in					
\$/af					
\$/other					
Notes					
E65 Canal					
AF, in					332.7
\$/af					47.64
\$/other					
Notes					For TBNRD, Contract #1190, Down to MP 23.7-0.3
Phelps Canal					
AF, in	626.30				
\$/af	33.86				
\$/other					
Notes	9-25-19 WSA w/PRRIP, Diversions down to MP 13.3				
Cottonwood Ranch					
AF, in					
\$/af					
Notes					
Funk Lagoon					
AF, in					
\$/af					
Notes					
Funds					
Total \$	\$ 21,206.52	\$ 108,696.16	\$ 43,477.44	\$ 65,218.73	\$ 15,849.83
PRRIP	\$ 21,206.518	\$ 108,696.163			
NDNR				\$ 65,218.73	
TBNRD			\$ 43,477.44		\$ 15,849.83
NGPC					

Appendix D: CNPPID Groundwater Recharge Diversions Summary - 2021 Platte Basin

2021 (cont.) Dates of Recharge diversions	3-15-21 to 3-24-21	3-15-21 to 3-24-21	3-15-21 to 3-24-21	3-15-21 to 3-24-21
Elwood Reservoir Diversions				
AF, in				
\$/af				
\$/other				
Notes				
Elwood Releases				
AF, in				
\$/af				
\$/other				
Notes				
E65 Canal				
AF, in	499			
\$/af	47.64			
\$/other				
Notes	For NDNR, Contract #1190, Down to MP23.7-0.3			
Phelps Canal				
AF, in		1168.30	307.80	461.80
\$/af		33.86	33.86	33.86
\$/other				
Notes		9-25-19 WSA w/PRRIP, Diversions down to MP 13.3	For TBNRD, Contract #1190, From MP 13.3 to 34.2	For NDNR, Contract #1190, From MP 13.3 to 34.2
Cottonwood Ranch				
AF, in				
\$/af				
Notes				
Funk Lagoon				
AF, in				
\$/af				
Notes				
Funds				
Total \$	\$ 23,772.36	\$ 39,558.64	\$ 10,422.11	\$15,636.55
PRRIP		\$ 39,558.638		
NDNR	\$ 23,772.36			\$15,636.55
TBNRD			\$ 10,422.11	
NGPC				

Appendix D: CNPPID Groundwater Recharge Diversions Summary - 2021 Platte Basin

2021 (cont.) Dates of Recharge diversions	5/19/21- 5/30/21	5/19/21-5/30/21	5/19/21-5/30/21	5/19/21-5/30/21	5/19/21-5/30/21	Total
Elwood Reservoir Diversions						
AF, in	1649.4	659.7	989.6			7527.3
\$/af	51.41	51.41	51.41			
\$/other						
Notes	For PRRIP. 6-24-19 WSA (30,000 af limit annually)	For TBNRD, Contract #1190	For NDNR, Contract #1190			
Elwood Releases						
AF, in						0
\$/af						
\$/other						
Notes						
E65 Canal						
AF, in						831.7
\$/af						
\$/other						
Notes						
Phelps Canal						
AF, in						2564.20
\$/af						
\$/other						
Notes						
Cottonwood Ranch						
AF, in						0
\$/af						
Notes						
Funk Lagoon						
AF, in				176.9	265.4	0
\$/af				27.06	27.06	
Notes				For TBNRD, Contract #1190	For NDNR, Contract #1190	
Funds						
Total \$	\$ 84,795.654	\$ 33,915.177	\$ 50,875.336	\$ 4,786.914	\$ 7,181.724	\$ 557,027.14
PRRIP	\$ 84,795.654					\$ 254,256.97
NDNR			\$ 50,875.34		\$ 7,181.72	\$ 181,666.45
TBNRD		\$ 33,915.18		\$ 4,786.91		\$ 121,103.72
NGPC						\$ -

Appendix D: Phelps Canal Recharge Map - 2021 Platte Basin

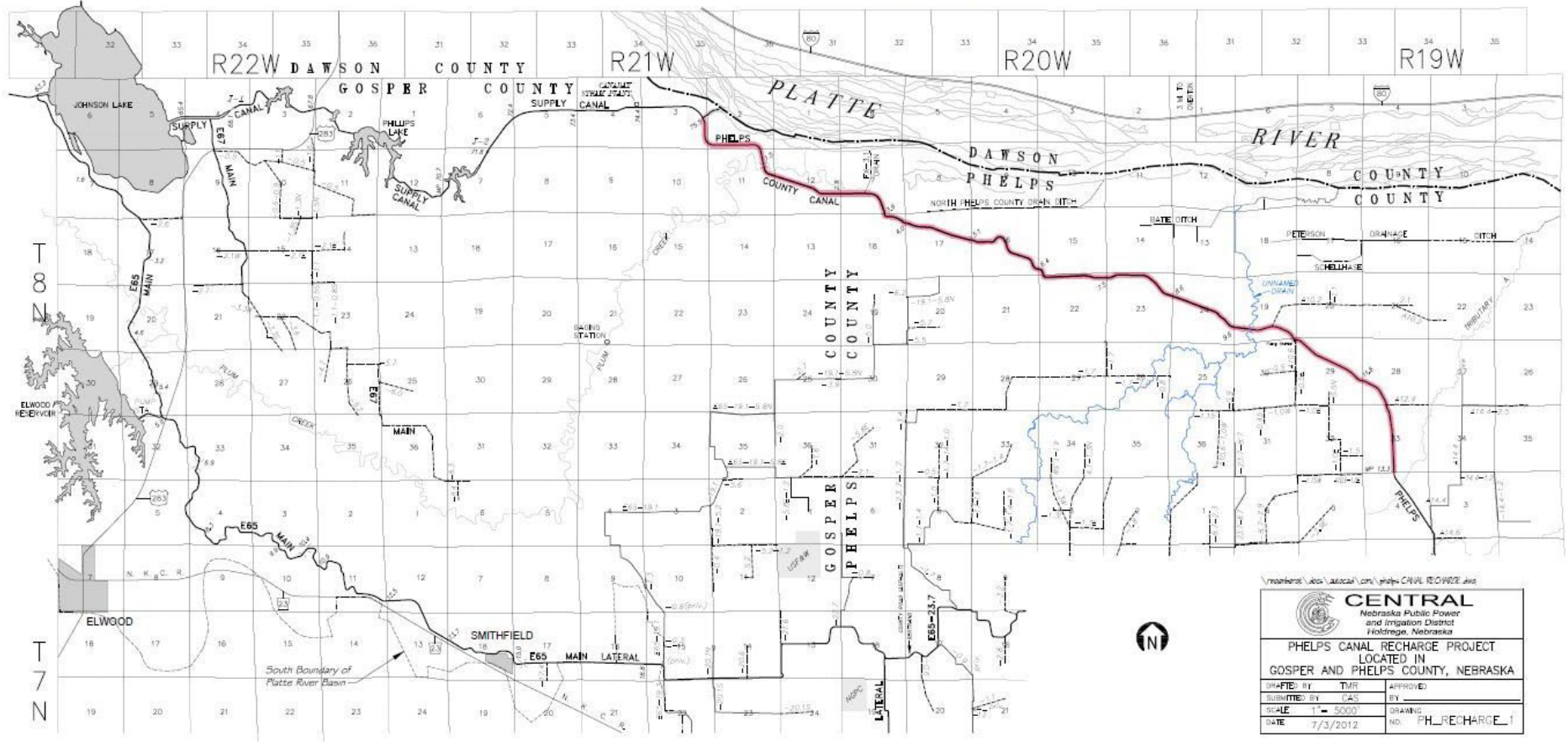

Appendix D: Elwood Reservoir & E65 Canal Recharge Map - 2021 Platte Basin

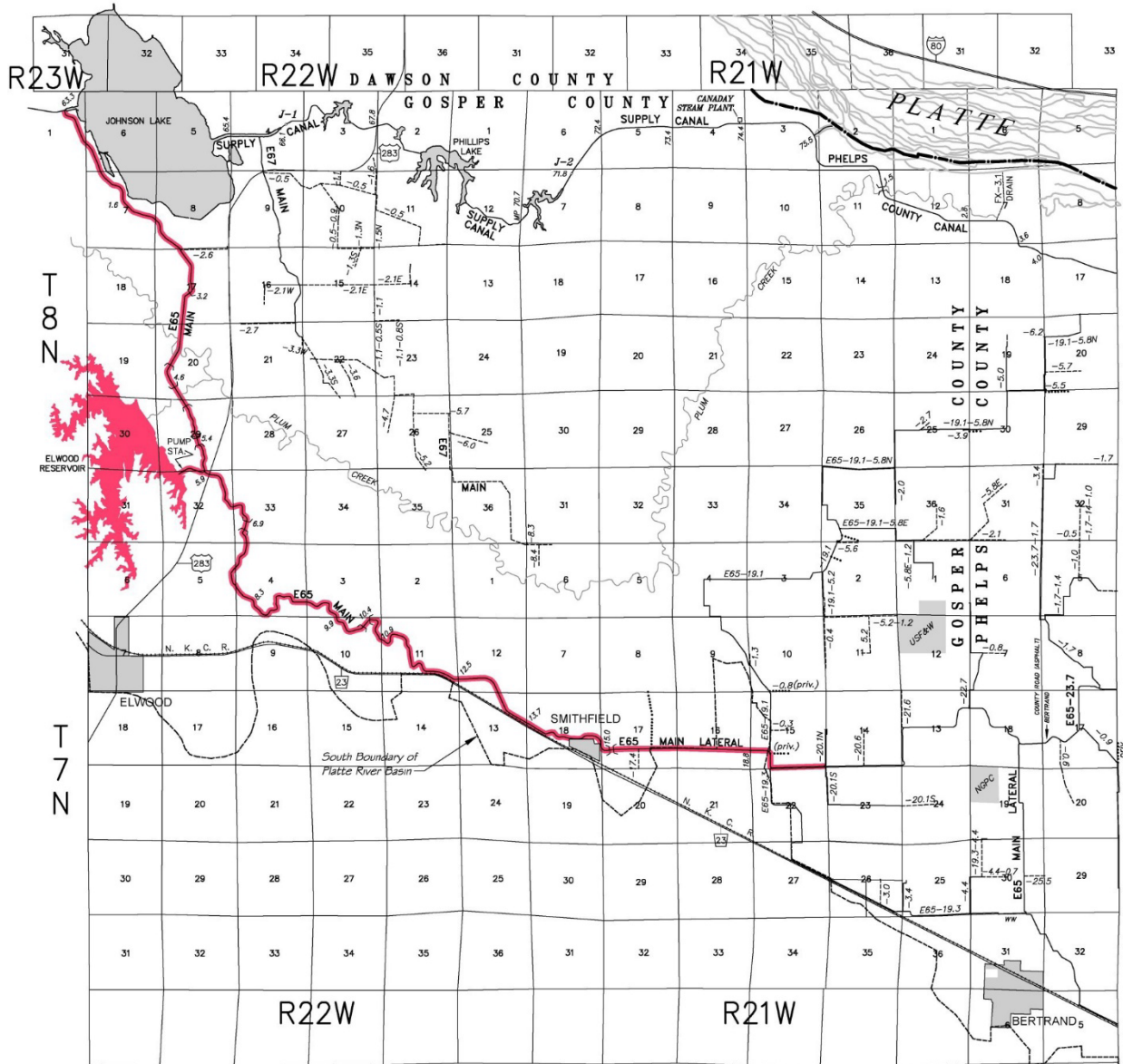

LEGEND

█ EXCESS FLOWS RECHARGE

\\nrgenbergt\docs\autocad\corv\elwoodRes-E65-201\dwg



CENTRAL
Nebraska Public Power
and Irrigation District
Holdrege, Nebraska

**PLATTE RIVER EXCESS FLOWS FOR RECHARGE
IN E65 CANAL & ELWOOD RESERVOIR,
GOSPER COUNTY, NEBRASKA**

DRAFTED BY	TMR	APPROVED	
SUBMITTED BY	DRF	BY	
SCALE	1" = 1.4 Mi.	DRAWING	
DATE	12/3/2014	NO.	RCHG_E65_DEC14

Appendix E: Wetland Recharge Project Map - 2021 Platte Basin

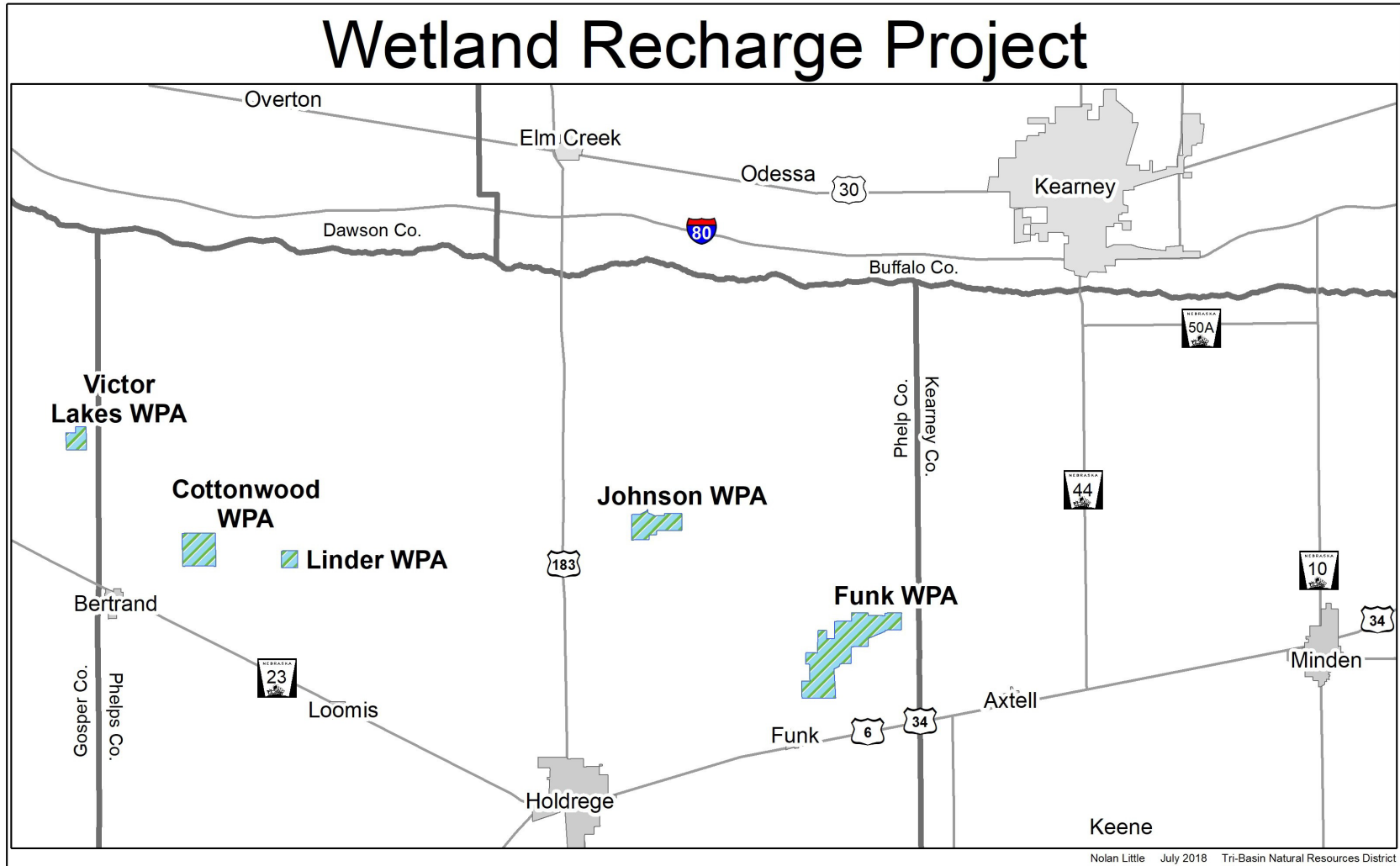

Appendix F: North Dry Creek Augmentation Pumping - 2021 Platte Basin

Augmentation Production Well #1			
G-159762		Well ID: 210850	
NWNE 27-8N-16W		NAD 83	
Lat: N40 38' 25.91700"		Long: W99 06' 59.91771"	
Surface Elev: 2156.92'		Stickup: 2.25'	
Well Depth=53'	Bore Hole: 30'	8" Column Pipe: 0'-40'	
16" Screen: 53'-23' / 0.085 Slot	River Gravel Pack: 53'-16'	8" Submersible 20 HP Pump: 40'-50'	
16" Plain: 23'-0'	Bentonite Chunks: 16'-0'	8" McCrometer Meter: Totalizer Acre/Inches	
Year	End Meter	Ac/In Annual Total	Annual Total Gallons
2012	4511.65	4493.26	122,009,982
2013	7762.48	3250.86	88,273,852
2014	8206.91	444.43	12,068,052
2015	8631.71	424.80	11,535,019
2016	9275.33	643.62	17,476,857
2017	5874.67	6599.34	179,198,478
2018	6486.80	612.13	16,621,778
2019	6645.88	159.88	4,319,658
2020	6712.21	66.33	1,801,125
2021	7580.00	867.79	23,563,970

Augmentation Production Well #2			
G-173880		Well ID: 234693	
SESE 5-7N-16W		NAD 83	
Lat: N40 35' 52.60"		Long: W99 08' 34.80"	
Surface Elev: 2182.95'		Stickup: .88'	
Well Depth=103'	Bore Hole:	8" Column Pipe: 0'-60'	
16" Screen: 103'-63' / 0.085 Slot	River Gravel Pack: 103'-15'	8" Submersible 25.63 HP Pump: 40'-50'	
16" Plain: 63'-0'	Bentonite Chunks: 15'-0'	8" McCrometer Meter: Totalizer Acre/Inches	
Start Date / Time	End Meter	Ac/In Annual Total	Annual Total Gallons
2014	0.00	0	0
2015	54.84	54.84	1,489,125
2016	247.49	192.65	5,231,218
2017	1465.30	1217.81	33,068,413
2018	2073.30	608.00	16,509,632
2019	2186.39	113.09	3,070,846
2020	3220.13	1033.74	28,070,176
2021	4303.90	1083.77	29,428,691

Appendix G: Tri-Basin NRD Water Conservation Incentive Program

3/12/19

Introduction: The Tri-Basin NRD Water Conservation Incentive Program (WCIP) is intended to address two natural resources management issues: ensuring sustainability of groundwater supplies and protecting streamflows from diminishment due to groundwater pumping. The goal of this voluntary program is to reduce groundwater pumping and increase irrigation water use efficiency in Tri-Basin NRD.

The Program: Tri-Basin will allow landowners to enroll up to 8000 NRD-certified irrigated acres in the program. The enrollment period will be from March 26 through April 19, or until the program acre enrollment limit is reached. Once the enrollment limit is reached, water savings to the district could reach 650 acre-feet per year. Incentives in this program will likely be most attractive to landowners in phase two and phase three groundwater quantity management areas, so the water-use reductions should be greatest where the need is greatest (there are approximately 30,000 certified irrigated acres in Tri-Basin's phase two and phase three townships).

In exchange for their participation, landowners will be paid for the equivalent of one acre-inch of water credit per acre per year, with the opportunity to sell additional credits to the NRD at a set price. In addition to NRD purchases, landowners will have the opportunity to sell water credits on the open market at any agreed-upon price (private transactions require NRD board approval). Tri-Basin will maintain an "electronic bulletin board" to facilitate connections between buyers and sellers. Landowners will also be granted flexibility to irrigate any acres within enrolled parcels and to share (pool) allocations between parcels. Pooling agreements will be required to enable sharing allocations between parcels under different ownership.

The Contract: The NRD and the landowner will sign a five-year agreement. The agreement commits the landowner to limiting water use (allocation) on parcels that they select. The allocation will be equal to the UNL average corn crop consumptive irrigation requirement, which is nine inches per acre per year in Kearney County, ten inches per acre per year in Phelps County and eleven inches per acre per year in Gosper County (allocation will be limited to current allocation of nine inches per acre per year in Union Township in Gosper County). Landowners will be required to have flowmeters installed on all wells serving participating parcels and to report water use annually to the NRD. Tri-Basin NRD will offer cost share on flowmeters for participants. Tri-Basin NRD will spot check flowmeter readings on 20% of participating parcels annually. As a condition of their participation, landowners will agree to subject enrolled parcels to (most of) the same rules that apply to all landowners in Phase three groundwater quantity management areas. An instrument will be filed with the county clerk recording these contracts, to provide notice to potential buyers of water use limitations associated with program participation.

In exchange for their participation, the NRD agrees to buy one acre-inch per acre per year from every acre enrolled in the contract. Landowners will have two payment options: an annual payment of \$5 per acre-inch credit for one acre-inch per year, or payment at the end of the contract period for up to five acre-inches of credits per acre (assuming the landowner has that much unused allocation) at a rate of \$4 per acre-inch. The NRD may also choose to purchase additional credits from participants. NRD purchases of additional acre-inches will be prioritized in Groundwater Quantity Management Phase 2 and Phase 3 areas and 50%+ stream depletion zones. The NRD will have the right of first refusal to purchase unused allocations from landowners, so landowners would need NRD board approval before they make private sales.

Landowners will also have the option to irrigate any and all acres within participating parcels. They can also pool acre-inches between parcels under the same ownership (pooling water credits associated with parcels under different ownership, but the same management will require a separate NRD-approved pooling agreement). Pools are only allowed for multiple parcels in the same basin and with the same groundwater quantity management phase status. Water use will be deducted from landowner water credit "accounts."

If a producer overuses their allocation, they will need to purchase credits from other landowners to eliminate their deficit. Otherwise, they will be prohibited from irrigating enrolled parcels until the deficit is eliminated. The only way a landowner can cancel a contract would be to pay the NRD for the full contracted amount (refund any payments that we've already made to them and pay the NRD the amount we would have paid them at the end of the contract period).

Appendix G: Tri-Basin NRD Water Conservation Incentive Program

Terminology

Accounts- An account will track the number of acre-inches of water available for pumping on a parcel. Each parcel will have a separate account unless landowners form pool accounts.

Allocations- Allocation amounts would be based on estimated safe yields from aquifers that would not result in long-term declines in groundwater levels. An initial allocation will be equal to the University of Nebraska's average annual irrigation water consumption requirement for corn (that amount is nine inches per acre in Kearney County, ten inches per acre in Phelps County and eleven inches per acre in Gosper County).

Credits (Water Use Credits)- Credits are accumulated on a per-NRD-certified irrigated acre per-parcel basis. Allocation credits are granted at the beginning of each allocation period.

Debits- Debits would be made against accounts based on actual pumping or water credits marketed and sold to the NRD or other water users.

Appendix H: Tri-Basin NRD Water Conservation Incentive Program Expansion

Introduction: Tri-Basin NRD launched the Water Conservation Incentive Program (WCIP) in March 2019. The program was initially aimed at groundwater irrigators. One of the main benefits that is anticipated is that it will encourage participants to be more efficient irrigators and help sustain groundwater supplies. We initially excluded CNPPID customers from the WCIP because the incentives set up for groundwater irrigators don't encourage conservation on commingled fields. We want to encourage irrigators who have parcels that have both surface water turnouts and groundwater wells (commingled parcels) to use canal water rather than groundwater on those fields to the greatest extent possible. This has the dual benefit of reducing groundwater pumping and increasing groundwater recharge.

A different approach is needed to incentivize surface water use. We need to incentivize commingled water users to use canal water rather than groundwater. CNPPID customers and landowners with individual surface water rights will be offered five-year contracts that pay the equivalent of the cost per acre of CNPPID water delivery, with the understanding that payments will be reduced by \$5 per acre inch of groundwater used during the contract period. If, however, CNPPID is unable to deliver the full amount of contracted water to a parcel for any reason, a landowner will be allowed to pump groundwater without penalty to make up the difference between what CNPPID is able to deliver and the full contract amount.

CNPPID charges \$34.61 to deliver nine inches of water to their irrigation customers (2019). Their prices are subject to annual increases. Tri-Basin will pay incentives to landowners based on the current delivery rate at the time of enrollment in WCIP. We won't adjust our payments if CNPPID raises prices.

Tri-Basin NRD irrigated acre certification data indicate that there are 114,016 acres in commingled irrigated fields in the Platte Basin portion of Tri-Basin NRD. This is an exaggeration of truly commingled acres because it includes all irrigated acres in fields that have both an irrigation well and a CNPPID delivery point or individual surface water right. According to CNPPID, they deliver water by contract to 103,068 acres within Tri-Basin NRD (109,000 acres total). Their estimate of truly commingled acres associated with CNPPID deliveries is 82,508 acres. WCIP incentives will be paid on all CNPPID contracted acres that are also NRD-certified for groundwater irrigation ("commingled acres"). Because NRD funds are limited, we will initially approve contracts for 8000 acres. If applications exceed the number of acres allowed for enrollment, applications will be selected for approval using a ranking system.

The WCIP requires annual reporting of groundwater use. As of 2018, only 15,597 commingled acres (TBNRD definition) have flowmeters in place and are reporting water use to Tri-Basin NRD. Applications from landowners with flowmeters currently in place will be favored in the ranking system.

Parcels in which CNPPID water service contracts are in the process of cancellation will not be eligible for enrollment. Landowners will be allowed to enroll additional acres on existing CNPPID water service contracts. Individual landowners will be limited to enrolling a total of no more than 320 acres in the WCIP. In the case of fields with fewer CNPPID contract acres than NRD-certified irrigated acres, landowners need to agree to have seals installed on valves or risers that would enable use of groundwater on CNPPID contract acres. If the seals are broken, recorded groundwater use will be divided among all NRD-certified irrigated acres.

Terminology:

Accounts- An account will track the number of acre-inches of water available for pumping on a parcel. Each parcel will have a separate account unless landowners form pool accounts.

Allocations- Allocation amounts would be based on estimated safe yields from aquifers that would not result in long-term declines in groundwater levels. An initial allocation will be equal to the University of Nebraska's average annual irrigation water consumption requirement for corn (that amount is nine inches per acre in Kearney County, ten inches per acre in Phelps County and eleven inches per acre in Gosper County).

Credits (Water Use Credits)- Credits are accumulated on a per-NRD-certified irrigated acre per-parcel basis. Allocation credits are granted at the beginning of each allocation period.

Debits- Debits would be made against accounts based on actual pumping or water credits marketed and sold to the NRD or other water users.

Appendix H: Tri-Basin NRD Water Conservation Incentive Program Expansion

Platte Basin WCIP Contracts			
Program Years	Program	Contract Acres	Legal Location
2020 - 2024	WCIP_Commingle	255	SE 1/4 Section 2-6- 16
2020 - 2024	WCIP_Commingle		Pt NW 1/4 Section 36-7- 16
2020 - 2024	WCIP_Commingle		Pt SW of NW 1/4 Section 36-7- 16
2020 - 2024	WCIP_Commingle	130.00	NW 1/4 Section 11-6- 16
2020 - 2024	WCIP_Commingle	149.00	Pt NW 1/4 Section 27-7- 15
2020 - 2024	WCIP_Commingle	150.00	SW1/4 & S 1/2 NW 1/4 Section 33-7- 15
2020 - 2024	WCIP_Commingle	142.00	NE 1/4 Section 16-7- 20
2020 - 2024	WCIP_Commingle	140.00	NE 1/4 Section 30-7- 20
2020 - 2024	WCIP_Commingle	147.00	SE 1/4 Section 16-6- 19
2020 - 2024	WCIP_Commingle	148.38	SW 1/4 Section 20-6- 19
2020 - 2024	WCIP_Commingle	287.10	NW 1/4 Section 34-7- 20
2020 - 2024	WCIP_Commingle		SE 1/4 Section 17-7- 19
2020 - 2024	WCIP_Commingle	149.00	Pt SE 1/4 Section 13-6- 20
2020 - 2024	WCIP_Commingle	123.86	SW 1/4 Section 14-7- 20
2020 - 2024	WCIP_Commingle	123.00	SE 1/4 Section 30-8- 19
2020 - 2024	WCIP_Commingle	135.00	SE 1/4 Section 13-6- 18
2020 - 2024	WCIP_Commingle	150.00	pt NE 1/4 Section 13-6- 18
2020 - 2024	WCIP_Commingle	300.86	NW 1/4 Section 13-6- 18
2020 - 2024	WCIP_Commingle		Pt SW 1/4 Section 13-6- 18
		2530.2	
2021 - 2025	WCIP_Groundwater	125.2	SW 1/4 Section 6-8- 23
2021 - 2025	WCIP_Groundwater	132.43	NE 1/4 Section 16-7- 17
		257.63	
2021 - 2025	WCIP_Commingle	142.00	E 1/2 SE 1/4 Section 25-7- 17
2021 - 2025	WCIP_Commingle		W 1/2 SE 1/4 Section 25-7- 17
2021 - 2025	WCIP_Commingle	144.00	NW 1/4 Section 30-7- 16
2021 - 2025	WCIP_Commingle	128.00	Lots 9, 10, 15, 16 Section 31-7- 17
2021 - 2025	WCIP_Commingle	127.00	Pt NW 1/4 Section 14-6- 18

541.00