

---

# 2018 Annual Report of Integrated Water Management Activities in the Platte Basin Within Tri-Basin NRD



1723 Burlington Street  
Holdrege, Nebraska 68949  
(308) 995-6688  
[www.tribasinnrd.org](http://www.tribasinnrd.org)  
email: [tribasin@tribasinnrd.org](mailto:tribasin@tribasinnrd.org)

**June 2019**

---

**ANNUAL REPORT OF WATER USE ACTIVITIES  
IN THE PLATTE BASIN WITHIN TRI-BASIN NRD  
TO MEET THE REQUIREMENTS OF THE JOINT INTEGRATED MANAGEMENT PLAN  
FOR THE 2019 BASIN-WIDE MEETING**

**I. SUMMARY**

The purpose of this report is to convey information that Tri-Basin Natural Resources District (TBNRD) agreed to supply to the State of Nebraska as part of a joint Integrated Management Plan for the fully and overappropriated portions of the Platte River Basin.

**Map #1: Basin Reference Map**

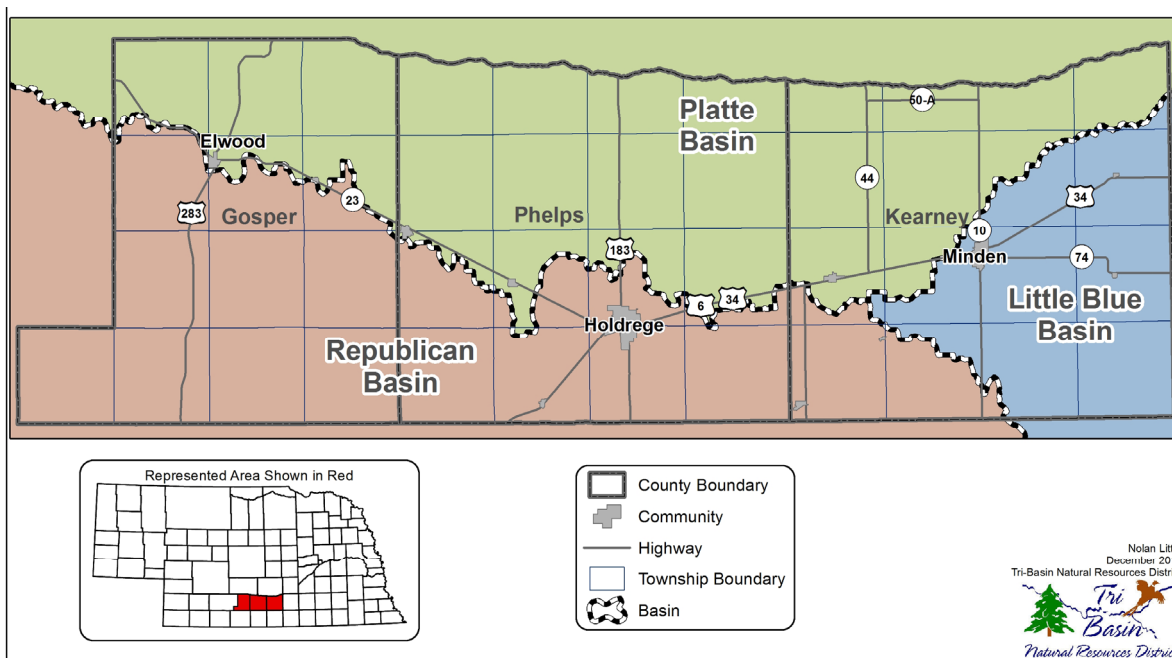

**II. INTRODUCTION**

TBNRD encompasses portions of the Republican, Platte and Little Blue River Basins (see map #1, above). The district also contains an area commonly referred to as the “Groundwater Mound” spanning portions of all three basins, that is characterized by groundwater levels that are higher than historic, “pre-development,” groundwater elevations.

More than 100,000 acres of cropland within the Platte Basin portion of TBNRD are irrigated with water diverted from the Platte River and distributed through the canals of the Central Nebraska Public Power and Irrigation District (CNPPID). Surface irrigation water and the canals that distribute it enhance recharge of groundwater supplies within the district. In addition to helping sustain groundwater supplies, this incidental recharge has increased streamflows in Platte and Republican tributaries. High groundwater levels have also saturated soil and sub-soil in parts of northern Phelps and Kearney counties, requiring TBNRD to construct drainage ditches (Improvement Project Areas or IPAs) in an attempt to stabilize groundwater levels below the crop root zone. For this reason, the TBNRD has designated portions of the Platte Basin as a “High Groundwater Management Area” pursuant to TBNRD rule 8.6 for purposes of groundwater quantity management.

**III. CERTIFIED IRRIGATED ACRES**

The district began certifying irrigated acres in the Platte Basin in 2004. The initial certification process in the Platte Basin ended on June 15, 2006. Since that time, corrections and revisions to the certi-

fied acre database have occurred with a net result as of December 31, 2018, of 298,511.05 certified acres in the Platte Basin within TBNRD. Data regarding certified irrigated acres can be found in **TABLE 1: Platte Basin Certified Irrigated Acres** (below). Commingled acres are acres that may be watered with either groundwater or surface water. Detailed information about locations and distribution of certified irrigated acres is available in the Tri-Basin NRD office.

<b>TABLE 1: Platte Basin Certified Irrigated Acres</b>			
	<b>Year</b>	<b>Acres Certified</b>	<b>Co-mingled Acres</b>
Gosper County	2010	35,755.63	
	2011	35,755.64	10,804.80
	2012	35,737.43	10,581.80
	2013	35,696.95	10,397.80
	2014	35,800.39	10,395.25
	2015	35,655.82	10,554.56
	2016	35,658.57	10,469.07
	2017	35,651.20	10,473.49
	2018	35,631.92	11,075.78
Phelps County	2010	166,992.60	
	2011	167,027.69	78,178.44
	2012	167,127.23	78,103.08
	2013	167,501.73	78,352.49
	2014	167,222.82	78,500.37
	2015	167,337.72	78,127.66
	2016	167,381.05	78,277.00
	2017	167,384.10	78,136.85
	2018	167,318.88	79,026.45
Kearney County	2010	94,984.64	
	2011	95,650.11	23,314.13
	2012	95,733.45	23,522.33
	2013	95,778.33	23,214.77
	2014	95,738.64	23,441.29
	2015	95,700.64	23,325.27
	2016	95,674.61	23,455.16
	2017	95,560.25	23,312.60
	2018	95,560.25	23,913.89
District Wide	2010	297,732.87	
	2011	298,433.44	112,297.37
	2012	298,598.11	112,207.21
	2013	298,977.01	111,965.06
	2014	298,761.85	112,336.91
	2015	298,694.18	112,007.49
	2016	298,714.23	112,201.23
	2017	298,595.55	111,922.94
	2018	298,511.05	114,016.12

**IV. APPROVED CERTIFIED ACRE AND GROUNDWATER TRANSFERS**

A. TBNRD allows certified irrigated acres to be transferred from one parcel to another within the Platte Basin portion of the district, with some limitations. These limitations include a prohibition on transfers from the fully appropriated portion of the district to the overappropriated area. Certified irrigated acres also cannot be transferred from parcels with surface water or commingled water resources to parcels that have groundwater wells as their only water source.

<b>NRD Permit Number</b>	<b>Legal Description</b>	<b>Acres Dried Up</b>
TBAT-0334	NW 1/4 Section 23-8-21	6
TBAT-0337	W 1/2 SE 1/4 Section 31-7-17	3
TBAT-0338	Lot 1; E 1/2 SE 1/4 Section 9-8-13	4
TBAT-0342	SW 1/4 Section 9-8-23	7

Furthermore, district rules require that the number of certified acres that can be transferred be limited or “discounted” to insure that there isn’t an increase in depletions to streamflows when acres are transferred from low to higher depletion zones. Between January 1, 2018 and December 31, 2018 the district approved 4 certified irrigated acre transfers in the Platte Basin. A total of 20 certified irrigated acres were involved in these transfers. Data regarding the location, amount and conditions associated with each transfer can be found in **TABLE 2A: Platte Basin Transfers-Acres at Original Locations** (above) and **TABLE 2B: Platte Basin Transfers-Acres at New Locations** (below).

<b>NRD Permit Number</b>	<b>Legal Description</b>	<b>New Irrigated</b>
TBAT-0334	NE 1/4 Section 8-7-20	6
TBAT-0337	E 1/2 SE 1/4 Section 31-7-17	3
TBAT-0338	Lot 2; W 1/2 SE 1/4 Section 9-8-13	4
TBAT-0342	N 1/2 Section 21-8-23	7

B. TBNRD regulates groundwater pumping off of overlying land by requiring landowners to secure groundwater transfer permits before they can pump groundwater to properties that are not contiguous or under the same ownership. Groundwater transfer permits can only be used to supply groundwater for irrigation of certified irrigated acres. Landowners are required to install flowmeters on wells that are permitted for transfers and to report pumping from these wells annually to the TBNRD. No permanent groundwater transfer permits were issued in the Platte Basin between January 1, 2018 and December 31, 2018. TBNRD allows CNPPID customers to pump groundwater into canals to supplement surface water diversions when necessary. Such permits are temporary and must be renewed annually. No temporary Groundwater Transfer Permits were issued by the NRD in 2018.

V. WELL CONSTRUCTION PERMITS

A. Since 1989, TBNRD has required landowners to secure well construction permits before they drill wells capable of pumping more than 50 gallons per minute. The district issues three categories of well permits: new well permits, conditional replacement well permits, and replacement well permits.

TBNRD requires landowners to agree to several conditions on the operation of new wells and conditional replacement wells before permits are issued. These conditions are listed in an agreement that is signed by landowners when they apply for these types of well permits. A copy of that agreement is attached to this report as Appendix A.

<b>Well Permit Type</b>	<b>Permits</b>
New (variance) irrigation	0
Replacement irrigation	9
Conditional replacement irrigation - supplemental to groundwater	2
Conditional replacement irrigation - supplemental to surface water	0
Dewatering (streamflow augmentation)	0
New commercial/industrial	0
Domestic (over 50 gpm)	0

B. **TABLE 3: TBNRD Well Permits** (page 4) is a breakdown of well permits that TBNRD issued in the Platte Basin between January 1, 2018 and December 31, 2018. A detailed listing of well permits issued by TBNRD in 2018 is found in **TABLE 4: Well Permit Summary** (below).

Permit Number	Well Permit Type	Legal Description	NDNR Reg. Number	Well ID Number
TBRP-G009923-R1	Replacement	Section 10-8- 21	G-009923	251462
TBRP-G045744-R1	Replacement	Section 12-6- 17	G-045744	252510
TBRP-G016588-R1	Replacement	Section 17-8- 13	G-016588	251642
TBRP-G056539-R1	Replacement	Section 27-8- 17	G-056539	254633
TBRP-G027543-R1	Replacement	Section 25-7- 20	G-027543	253079
TBRP-G069867-R1	Replacement	Section 36-8- 14	G-069867	253382
TBSG-1523	Supplemental to Ground	Section 14-8- 18	G-186486	254490
TBSG-1524	Supplemental to Ground	Section 17-8- 16	G-186194	254285
TBRP-G060270-R1	Replacement	Section 17-8- 13	NDY	
TBRP-G044409-R1	Replacement	Section 23-8- 17	NDY	
TBRP-G011187-R1	Replacement	Section 24-8- 15	NDY	
*NDY - Not drilled yet				

VI. VARIANCES

TBNRD issues new well permits to landowners of parcels that don't have a prior irrigation history only after they have transferred sufficient certified irrigated acres to the previously dryland parcel for the intended new use. The TBNRD Board must approve a variance to the rule prohibiting new well construction before new well permits can be issued. No new irrigation well construction permit variances were issued in the Platte Basin between January 1, 2018 and December 31, 2018.

Tri-Basin NRD corrected the district's certified acre database by certifying 27.26 acres in two parcels that had a history of irrigation between 1997 and 2005. These acres weren't previously included in the district's database, because they weren't classified as irrigated cropland by county assessors. Beginning in October 2013, producers also had to show proof that the corrected acres had been watered three out of the past five years. Tri-Basin NRD also adjusts the district's irrigated acre database as a result of revisions made by county assessors to taxable irrigated acres. Additions or reductions of taxable irrigated acres of four acres or less are automatically accepted by the district. Larger additions or reductions must be reviewed by the NRD board before they are approved. Tri-Basin NRD's Platte Basin Certified Irrigated Acre Corrections data is below in **TABLE 5: Platte Basin Certified Irrigated Acre Variances** (below). One approved well variance allowed an irrigation well to be modified to a livestock well. Tri-Basin NRD rule 10.2.2.3 allows landowners to offset depletive impacts of new or expanded livestock operations by converting consumption from certified irrigated acres to livestock use. In 2018 two landowners converted 69.62 certified irrigated acres to increase cattle feedlot capacity.

Date Approved	Type of Variance	Legal Description	Affected Acres
2/13/2018	Certified Acre Correction	Lots 11, 13; pts 10, 12; Pt S 1/2 SW 1/4 Section 2-8-21	22.3
4/5/2018	Certified Acre Correction	N 1/2 NW 1/4 Section 23-7- 18	4.96
6/28/2018	Conversion from irrigated crop to Livestock	SW 1/4 Section 9-8- 23	12.92
7/30/2018	Conversion from irrigated crop to Livestock	SE 1/4 Section 3-7 20	56.7

VII. MUNICIPAL AND INDUSTRIAL ACCOUNTING

TBNRD collects water use data annually from all municipalities and industries within the district. Municipal and industrial water use data for communities and industries located in the Platte Basin reported to TBNRD in 2018 is shown in the next two tables. A summary of Municipal Water Use may be found in **TABLE 6: Platte Basin Municipal Water Use Data** (pages 9 and 10). **TABLE 7** (page 11) shows Industrial and Commercial Water Use Data.

VIII. FLOWMETER DATA

TBNRD requires flowmeters to be installed and annual water use to be reported to TBNRD whenever landowners drill new wells, receive irrigation-related cost-share funds, or when groundwater is transferred from one property to another. In 2018, landowners reported data from 436 flowmeters in the Platte Basin. The metered wells reported irrigating 52,971 certified irrigated acres. Due to the installation of additional reporting flowmeters and depending on use of supplemental irrigation wells by CNPPID customers, flowmeter data and reported irrigated acres change from year to year. Ample rainfall in areas of the district in 2018 allowed many irrigators to use primarily surface water to irrigate crops; many supplemental wells were not used in 2018. All District flowmeter data is reported annually to the Department of Natural Resources (DNR) for purposes of Republican River Basin Compact Administration accounting. Platte Basin flowmeter data is included in Appendix B.

IX. WATER BANKING ACTIVITIES

TBNRD has initiated a new program called the Water Conservation Incentive Program (see program summary in Appendix F). Participants in this program sign contracts agreeing to limit irrigation to the UNL Average Corn Crop Irrigation requirement. In exchange, Tri-Basin NRD agrees to pay them if they use less water than their allocated amount. Participants will be provided with credit accounts that track available water use credits for participating fields. Sign-up for the 2019 irrigation season concluded on April 19. No fields in the Platte basin portion of the district have been signed up yet.

X. STREAMFLOW ACCRETION ACTIVITIES

Tri-Basin NRD started utilizing the facilities of Central Nebraska Public Power District (CNPPID) to provide groundwater recharge and to augment streamflows when the district and the NE Game and Parks Commission paid CNPPID to divert 9551 acre-feet of water from the Platte River into Elwood Reservoir in Gosper County in 2006. Additional diversions (see Appendix D and Graph #1, below) have been made regularly over the past twelve years, including 2018, when NDNR and TBNRD paid CNPPID

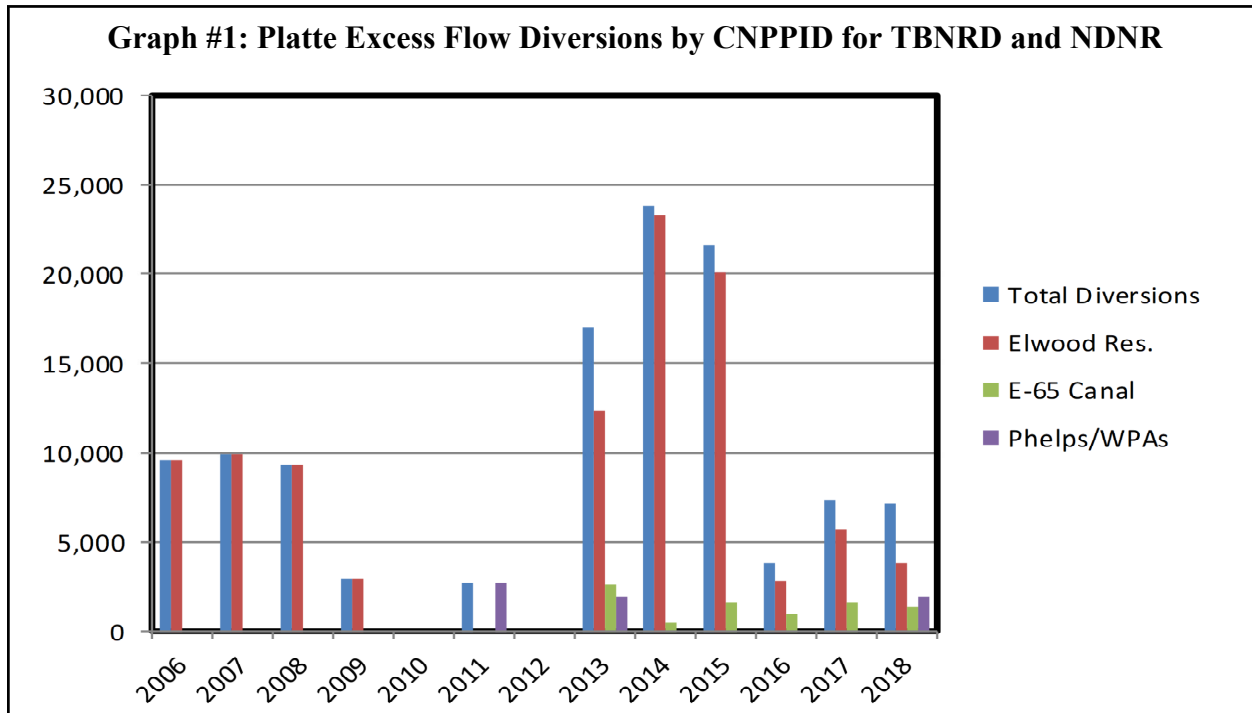

\$342,791.26 to divert 7200 acre-feet into Elwood Reservoir and E-65 Canal. Diversions in 2018, when added to past diversions, result in a grand total of 115,345.4 acre-feet of water diverted from 2006-2018. In all these instances, diversions were made when Platte streamflows exceeded target flows, or when irrigation deliveries were suspended due to heavy rainfall in the CNPPID irrigated area.

Tri-Basin NRD and NeDNR provided \$1,301,775 of local, state and Water Resources Cash Funds to the Rainwater Basin Joint Venture and CNPPID to construct pipelines from CNPPID canals to five federally-owned wetlands (Victor Lakes, Cottonwood, Linder, Johnson and Funk WPAs). This will enable CNPPID to deliver excess flows to these wetlands. Supplementing natural runoff with Platte excess flows will enhance wildlife habitat and increase groundwater recharge, which will offset groundwater pumping depletions, sustain groundwater supplies and augment baseflows in nearby Platte tributaries. The pipeline to FUNK WPA was completed in 2018 and over 1950 acre-feet were diverted into that wetland in November and December 2018.

The Platte River Recovery Implementation Program (PRRIP) paid CNPPID to divert 19,173 acre-feet of water into the Phelps County Canal in 2012. Since then, PRRIP has made additional diversions on several occasions when the Platte is flowing above target levels (see Appendix D). While recharge resulting from these diversions can't be used as a credit to offset depletions to Platte baseflows from post-1997 uses, they can be credited to Tri-Basin NRD toward reducing depletions to fully appropriated levels.

Tri-Basin NRD completed construction of a streamflow augmentation well along North Dry Creek in Kearney County in 2011. A second well was installed in 2015. The wells can each pump as much as 1250 gallons per minute. A study of the augmentation wells' impacts, conducted by HDR Engineering in 2014 and commissioned by TBNRD and DNR, indicates that the average depletion caused by pumping augmentation well #1 over a 25-year period is equivalent to 44% of total pumping (see Graph #2: Tri-Basin NRD North Dry Creek Augmentation Well Pumping, below). Augmentation well pumping and resulting estimated offset credit is described in Appendix E. Pumping by augmentation wells also has an ancillary benefit of providing forage fish habitat during extreme drought conditions.

Tri-Basin NRD also accrued credit for 357.64 acre-feet of water pumped into the Platte River near Kearney in 2018 through a wastewater pipeline from the KAAPA ethanol plant near Axtell. This pipeline was constructed in 2007.

Irrigated land was temporarily retired in TBNRD during 2018 through contracts totaling 35.4 irrigated acres that were signed up for USDA-EQIP Dry Land Corners.

Landowners reported to TBNRD on district Groundwater Quality Management Area crop reports that conservation tillage practices have been adopted or continue to be utilized on 82,614.68 certified irrigat-

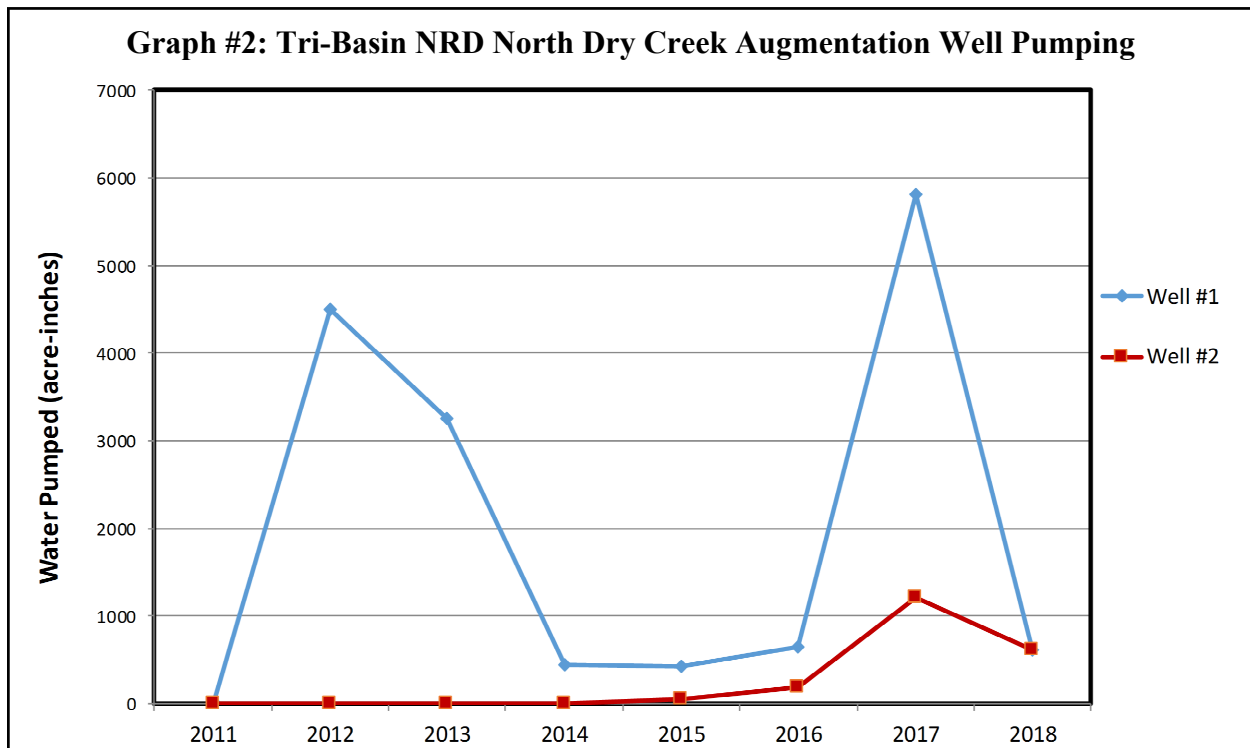

ed acres in the Platte Basin portion of the district during 2018 (see Appendix C). It is estimated that no-till or minimum tillage practices have been adopted on at least 110,000 irrigated acres in the Platte Basin portion of the district. Recent university research (Klocke, et al, 2009) indicates that evapotranspiration (ET) is reduced by as much as 3 inches per acre on irrigated cropland, as compared to conventional tillage systems. Therefore, as much as 27,500 acre-feet of water was conserved in the Platte Basin in TBNRD in 2018 through this conservation practice.

Tri-Basin NRD signed agreements with DNR, Central Platte NRD (CPNRD) and Twin Platte NRD to participate in funding the proposed “J-2 Re-regulation Reservoir” project southwest of Overton, Nebraska. It was anticipated that this reservoir would store up to 8000 acre-feet of water, and that it would fill as often as three times per year. Funding for the project was suspended by the PRRIP in 2016. Tri-Basin NRD and other project partners are evaluating possible feasible alternatives to this project. Tri-Basin NRD has accrued 2040 acre-feet per year of depletion offset credit from its participation in this project. This credit will remain in place through at least 2019.

Tri-Basin NRD and Central Platte NRD reached an agreement in 2013 that will enable TBNRD to compensate CPNRD in return for accruing credit from Platte baseflow enhancements that result from rehabilitation of three irrigation canal systems in Dawson County. In 2014, CPNRD provided 512 acre-feet of water to offset depletions caused by groundwater irrigation in TBNRD. No offset water credit has been provided under this agreement since that time, but the agreement remains in effect until 2033.

## XI. GROUNDWATER LEVELS

TBNRD has an extensive network of 122 dedicated groundwater observation wells (65 in the Platte Basin) and 90 irrigation wells (eight in the Platte Basin) that are used to measure groundwater levels (see Map #2, page 12). TBNRD also works cooperatively with CNPPID to gather groundwater level data. Data from 158 wells measured by CNPPID are included in TBNRD’s groundwater observation well database. District water level data is reported bi-annually to U.S. Geological Survey and UNL-Conservation and Survey Division. Groundwater level data for the district is available from the Tri-Basin NRD office.



**TABLE 6: Platte Basin Municipal Water Use Data**

	Year	Jan.	Feb.	March	April	May	June	July	August	Sept.	Oct.	Nov.	Dec.	Yearly Total
<b>Axtell</b>	<b>2010</b>	2,261,300	2,690,700	3,757,400	3,336,000	3,351,500	3,895,700	10,452,300	9,737,500	8,899,200	7,871,700	3,800,700	4,441,500	64,495,500
<b>Pop. 726</b>	<b>2011</b>	3,708,500	3,301,900	3,649,000	3,742,000	5,305,600	7,600,700	11,452,600	8,907,600	7,459,200	5,677,900	3,018,200	3,111,100	66,934,300
<b>(2010 census)</b>	<b>2012</b>	3,124,800	3,104,600	4,241,500	5,751,800	11,685,400	14,211,000	22,110,800	12,040,400	12,675,900	5,713,700	3,274,500	2,878,000	100,812,400
	<b>2013</b>	2,923,900	2,395,100	2,530,000	3,195,600	8,260,800	11,960,000	19,418,700	11,170,400	9,955,100	5,558,900	2,753,300	2,495,500	82,617,300
	<b>2014</b>	2,653,500	2,359,000	2,740,400	3,836,900	7,461,100	7,534,900	12,794,400	8,925,000	5,467,700	5,640,300	2,475,500	2,180,300	64,069,000
	<b>2015</b>	2,282,900	2,027,700	4,393,300	4,318,200	4,664,300	5,876,500	12,441,200	10,301,700	10,976,400	7,525,900	4,008,900	2,699,700	71,516,700
	<b>2016</b>	2,379,000	2,755,600	3,040,700	4,168,700	3,985,900	13,891,900	14,882,100	11,692,100	9,021,300	7,816,500	3,537,100	2,310,600	79,481,500
	<b>2017</b>	2,288,000	1,988,100	2,493,500	3,609,100	4,904,500	14,414,100	14,784,100	7,672,900	10,143,900	3,942,000	2,797,400	2,430,100	71,467,700
	<b>2018</b>	2,487,000	2,289,700	2,421,700	2,379,200	6,946,500	12,633,200	9,746,700	8,058,000	6,823,000	3,239,900	2,139,300	2,421,400	61,585,600
<b>Bertrand</b>	<b>2010</b>	4,380,000	3,998,000	3,383,000	3,837,000	5,147,000	6,153,000	11,853,000	12,170,000	11,097,000	9,986,000	4,532,000	3,748,000	80,284,000
<b>Pop. 750</b>	<b>2011</b>	4,234,000	3,655,000	3,876,000	4,307,000	7,316,900	9,301,200	15,651,200	12,540,800	9,397,600	7,050,000	3,945,000	4,152,000	85,426,700
<b>(2010 census)</b>	<b>2012</b>	3,575,000	3,348,000	3,846,000	6,122,000	13,410,700	17,711,000	27,282,900	14,707,500	15,511,100	8,976,000	5,261,000	3,970,000	123,721,200
	<b>2013</b>	4,002,000	3,571,000	3,533,000	3,858,000	10,671,200	15,688,200	23,473,500	17,540,600	14,850,200	6,406,000	3,852,000	4,288,000	111,733,700
	<b>2014</b>	4,422,000	3,817,000	4,069,000	4,949,000	11,419,500	8,539,000	16,089,200	11,456,000	7,427,000	8,972,000	4,710,000	4,114,000	89,983,700
	<b>2015</b>	4,294,000	3,807,000	6,038,000	8,605,000	8,294,500	9,873,100	21,287,600	15,234,800	15,246,600	9,881,500	4,519,000	3,981,000	111,062,100
	<b>2016</b>	4,467,000	4,003,000	4,548,000	8,925,400	6,381,000	14,827,300	14,993,000	15,371,700	11,076,700	11,481,000	7,061,000	5,398,000	108,533,100
	<b>2017</b>	5,477,000	4,266,000	4,763,000	8,036,000	6,728,100	19,708,400	17,701,100	10,483,000	13,751,700	6,601,200	4,552,000	5,166,000	107,233,500
	<b>2018</b>	5,215,000	4,682,000	4,490,000	4,829,700	9,412,811	14,385,000	12,214,100	11,105,700	10,056,700	5,838,400	4,190,000	4,154,000	90,573,411
<b>Elwood</b>	<b>2010</b>	2,654,000	4,454,000	4,132,000	5,162,000	6,407,000	7,509,000	12,253,300	12,469,000	12,818,000	10,493,000	5,631,000	4,269,600	88,251,900
<b>Pop. 707</b>	<b>2011</b>	4,490,000	3,277,000	4,745,000	4,930,200	7,990,000	10,787,000	9,682,800	17,946,300	7,851,600	8,301,000	5,195,900	3,483,000	88,679,800
<b>(2010 census)</b>	<b>2012</b>	4,278,000	3,324,500	5,774,700	4,184,000	16,881,600	22,944,600	30,825,300	20,347,800	15,277,100	9,352,300	4,511,400	4,061,900	141,763,200
	<b>2013</b>	5,223,600	4,535,500	5,299,500	6,824,000	4,795,500	14,776,000	28,116,000	17,587,000	13,151,900	5,936,800	4,311,200	3,800,900	114,357,900
	<b>2014</b>	3,729,600	4,188,000	4,915,000	4,968,000	12,601,700	10,104,800	20,316,600	15,146,100	9,033,400	6,043,600	3,827,000	4,682,500	99,556,300
	<b>2015</b>	3,067,700	3,531,000	6,951,100	5,160,200	6,668,600	10,586,900	19,270,800	11,772,800	10,001,500	6,784,900	3,373,000	3,468,000	90,636,500
	<b>2016</b>	3,467,900	3,235,000	3,817,300	5,768,000	5,770,000	14,979,700	13,372,200	15,078,400	9,390,000	11,215,400	3,825,000	4,302,000	94,220,900
	<b>2017</b>	4,283,600	4,994,000	4,074,900	6,153,800	12,262,600	12,577,800	17,753,700	10,229,900	12,605,600	4,944,800	3,536,900	3,677,000	97,094,600
	<b>2018</b>	4,439,000	3,754,000	3,928,200	4,162,000	9,938,200	15,358,800	12,971,100	9,499,900	8,555,000	6,843,000	4,364,000	6,179,000	89,992,200

(Continued on next page)

**TABLE 6: Platte Basin Municipal Water Use Data (continued)**

	Year	Jan.	Feb.	March	April	May	June	July	August	Sept.	Oct.	Nov.	Dec.	Yearly Total
<b>Funk</b>	2010	1,707,668	1,707,667	1,707,667	1,707,667	1,707,667	1,707,667	2,482,000	2,455,000	2,035,000	2,061,000	1,578,000	1,321,000	22,178,001
<b>Pop. 194</b>	2011	1,530,000	1,241,000	1,410,000	1,510,000	2,081,000	2,666,000	2,833,000	2,656,000	2,614,000	1,732,000	1,500,000	1,630,000	23,403,000
(2010 census)	2012	1,889,000	1,549,000	1,106,000	1,053,000	2,432,000	4,285,000	3,508,000	2,773,000	3,043,000	1,990,000	1,251,000	1,152,000	26,031,000
	2013	1,163,000	1,029,000	1,119,000	1,215,000	1,830,000	2,727,000	4,608,000	3,154,000	2,247,000	1,123,000	780,000	748,000	21,743,000
	2014	758,000	694,000	725,000	796,000	2,346,000	1,669,000	3,132,000	2,394,000	1,443,000	1,045,000	809,000	760,000	16,571,000
	2015	737,000	726,000	1,004,000	1,279,000	1,347,000	1,580,000	3,150,000	1,443,000	3,291,000	1,535,000	717,000	1,047,000	17,856,000
	2016	1,239,000	1,121,000	1,368,000	1,195,000	908,000	3,739,000	3,584,000	3,240,000	1,375,000	1,176,000	615,000	539,000	20,099,000
	2017	581,000	503,000	592,000	608,000	795,000	1,998,000	3,786,700	1,670,300	2,294,000	1,080,000	912,100	1,296,000	16,116,100
	2018	926,400	987,000	990,300	850,200	2,008,000	3,464,350	2,863,350	2,675,100	2,449,100	2,261,100	1,050,100	1,177,100	21,702,100
<b>Loomis</b>	2010	1,589,000	3,217,000	3,815,000	1,887,000	2,604,000	2,384,000	5,508,000	6,722,000	5,741,000	5,521,000	1,928,000	1,607,000	42,523,000
<b>Pop. 382</b>	2011	1,287,000	2,080,000	1,254,000	1,953,000	3,231,000	4,369,000	5,352,000	6,655,000	6,671,000	3,976,000	2,551,000	1,304,000	40,683,000
(2010 census)	2012	1,709,000	1,033,000	1,553,000	2,428,000	7,072,000	10,692,000	15,290,000	7,847,000	8,014,000	4,510,000	1,855,000	984,000	62,987,000
	2013	1,254,000	783,000	1,124,000	1,534,000	5,182,000	7,094,000	11,508,000	7,579,000	7,236,000	2,221,000	1,393,000	1,298,000	48,206,000
	2014	1,223,000	1,150,000	1,341,000	1,952,000	5,636,000	4,465,000	8,702,000	5,563,000	2,847,000	2,970,000	1,437,000	1,289,000	38,575,000
	2015	1,163,000	1,177,000	2,116,000	4,199,000	2,763,000	5,302,000	8,388,000	6,377,000	6,215,000	3,215,000	1,382,000	1,113,000	43,410,000
	2016	1,066,000	1,119,000	1,362,000	2,828,000	1,952,000	7,843,000	6,982,000	7,775,000	5,093,000	4,769,000	1,995,000	1,254,000	44,038,000
	2017	1,522,000	823,000	1,835,000	3,033,000	3,124,000	9,538,000	9,616,000	2,699,000	6,351,000	2,228,000	1,401,000	653,000	42,823,000
	2018	1,440,000	1,282,000	1,235,000	1,432,000	4,451,000	6,398,000	6,346,000	4,138,000	3,901,000	1,944,000	1,084,000	1,342,000	34,993,000
<b>Smithfield</b>	2010	69,700	192,000	231,200	107,500	135,900	335,000	407,700	734,700	465,900	237,200	184,300	238,700	3,339,800
<b>Pop. 54</b>	2011	232,300	332,000	553,600	555,200	420,600	270,100	440,600	801,200	602,000	321,000	234,300	202,800	4,965,700
(2010 census)	2012	311,700	169,600	212,300	145,100	611,300	959,500	959,700	650,100	620,700	332,900	290,900	112,800	5,376,600
	2013	167,700	158,400	106,400	269,100	373,800	690,600	555,300	601,500	350,200	211,600	181,400	195,000	3,861,000
	2014													3,808,100
	2015													3,447,200
	2016	178,100	79,200	93,100	182,300	210,600	189,900	1,028,800	1,173,700	386,200	290,500	164,400	180,700	4,157,500
	2017	121,600	151,200	127,700	128,900	236,000	489,300	725,400	267,900	375,100	168,400	162,000	99,600	3,053,100
	2018	160,800	82,400	113,300	199,800	254,200	393,900	436,600	271,700	248,000	207,100	131,600	202,300	2,701,700

\*2014 Smithfield monthly data unavailable. Papers fell into water; all they are able to provide is beginning and ending reading for the year.

\*2015 Smithfield monthly data unavailable. Water Manager passed away; village staff was unaware that they were to be keeping monthly readings. They will begin January 2016.

\*2015 IMP Report data for Bertrand contained an error; data from one well was not included in the report.

<b>TABLE 7: Platte Basin Industrial and Commercial Water Use Data</b>				
<b>NDNR Reg. Number</b>	<b>Well ID Number</b>	<b>Owner</b>	<b>Legal Description</b>	<b>Gallons Pumped</b>
G-177982	239716	Olsen Cattle Co LLC	Section 5-6-15	4,356,000
G-123753-R1	194279	KAAPA Ethanol, LLC	Section 13-6-16	126,838,200
G-123754-R2	210900	KAPPA Ethanol, LLC	Section 13-6-16	344,800
G-124061	152898	KAAPA Ethanol, LLC	Section 13-6-16	3,543,000
G-134413-R1	194280	KAAPA Ethanol, LLC	Section 13-6-16	45,673,900
G-181488	243777	KAAPA Ethanol LLC	Section 13-6-16	12,053,000
G-071961	80123	Mosaic	Section 15-6-16	9,000
G-071962	80124	Mosaic	Section 15-6-16	4,000
G-073875	82215	Village of Bertrand	Section 6-6-20	16,115,900
G-165728	219082	Fort Kearny Consolidated	Section 5-7-14	39,631,600
G-165729	219083	Fort Kearny Consolidated	Section 5-7-14	20,000,000
G-139944	171644	Fort Kearny Consolidated	Section 6-7-14	
G-116982	141058	KGLD, LLC	Section 11-7-16	52,845,026
G-177447	238330	Loomis Pork LLC	Section 19-7-19	3,660,500
G-147025	188561	Paul Johnson & Sons	Section 10-7-20	8,608,880
G-095842	112013	Aurora Co-Op	Section 19-7-20	950,000
G-093253	106683	Dan & Steve Wolfe	Section 28-8-16	5,000,000
G-093254	106684	Dan & Steve Wolfe	Section 28-8-16	5,000,000
G-087812	99723	Rusty's Fertilizer Inc	Section 21-8-18	1,036,800
G-073205	81395	Rockford G Plettner	Section 4-8-21	121,437,000
G-080853	89509	Nebraska Public Power District	Section 4-8-21	189,000
G-156977	199850	Central Nebraska Public Power & Irrigation District	Section 7-8-21	369,518,420
G-092923	102854	Central Nebraska Public Power & Irrigation District	Section 4-8-22	86,035,005
G-122576	151178	Bullhead Point Association	Section 5-8-22	5,807,500
G-076515	85080	Lakeside Country Club	Section 8-8-22	14,904,000
G-076780-R1	124121	Lakeside Country Club	Section 8-8-22	17,388,000

Map #2: Dedicated Groundwater Observation Wells

# Tri-Basin Natural Resources District Static Water Measurement Wells

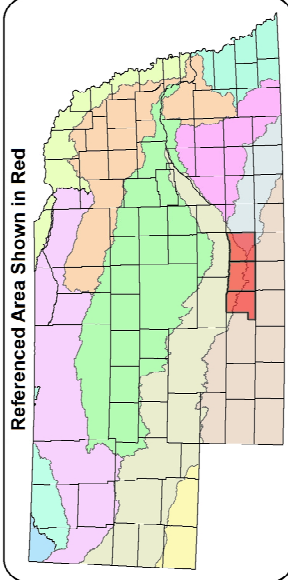
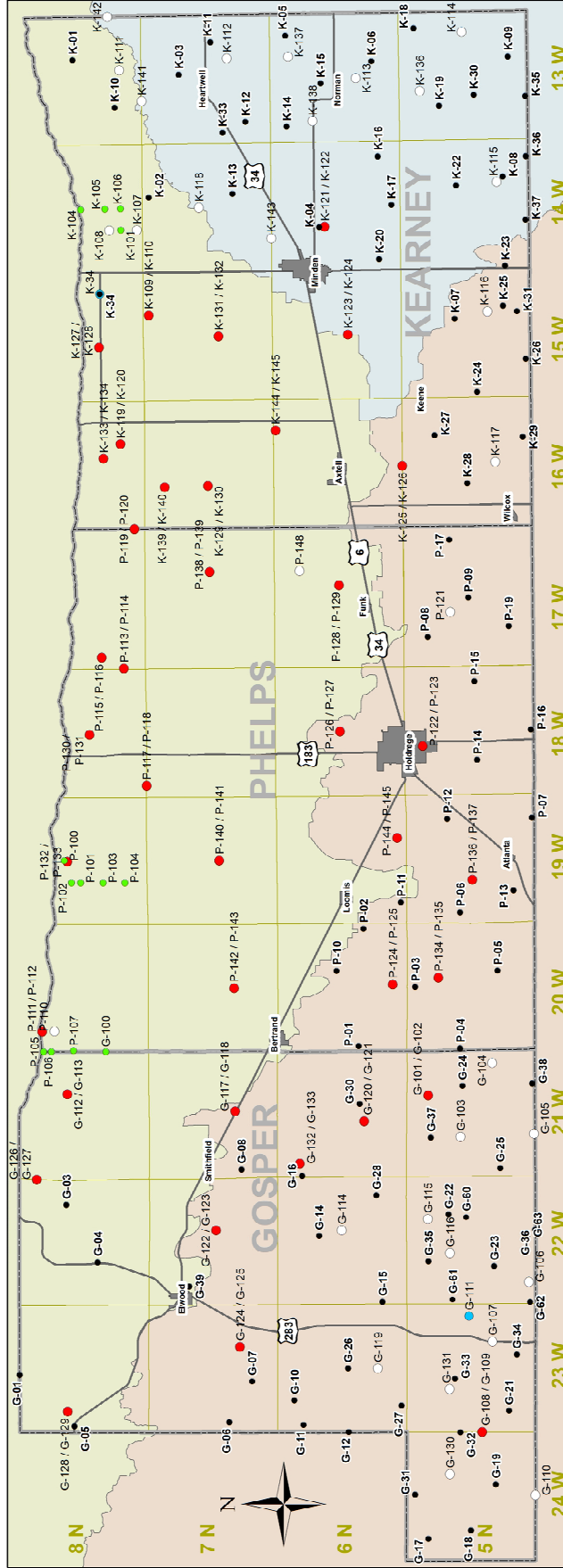

**Legend**

- Irrigation Well (Black dot)
- Transect Well (Green dot)
- Single Well (White circle)
- Nested Well (Red dot)
- Other Well (Blue dot)
- Highway (Line with number)
- Community (Black square)
- County Boundary (Grey outline)
- Township (Yellow outline)
- Little Blue Basin (Light blue oval)
- Republican Basin (Light orange oval)
- Platte Basin (Light green oval)

**Observation Well Stats:**

- 84 Sites
- 38 Nested Wells
- 122 Data Loggers
- 12 Hour Interval

**Irrigation Well Stats:**

- 8 Platte Basin
- 22 Little Blue Basin
- 60 Republican Basin
- 90 Measured Wells
- Spring & Fall

Nolan Little  
January 2019  
Tri-Basin Natural Resources District

**Tri-Basin NRD – Platte Basin Annual Report  
Appendix A**

**Tri-Basin Natural Resources District  
New Well and Conditional Replacement Well Permit  
Applicant Certification and Agreement**

Applicant Certification and Agreement to be bound by Conditions and Limitations on operation of a Well permitted as a New Well or as a Conditional Replacement Well pursuant to Rule 1.13, Tri-Basin Natural Resources District Rules and Regulations for Management of Land and Water Resources

NRD Permit # \_\_\_\_\_ Applicant \_\_\_\_\_

Applicant is the owner of the following- described real estate:

\_\_\_\_\_  $\frac{1}{4}$  Section \_\_\_\_\_ T \_\_\_\_\_ N - R \_\_\_\_\_ W \_\_\_\_\_

\*\*\*\*\*

Applicant accepts and agrees to be bound by the following conditions and limitations on the operation of a well that is constructed under the authority of a permit issued by the Tri-Basin Natural Resources District (“NRD”). The conditions and limitations are (check the box and initial those that apply):

1.  Applicant agrees to offset any “new depletions” to streamflows of the Platte River, Little Blue River, Republican River, or their tributaries that may be determined to be associated with use of this well. Applicant agrees to use methods to offset those depletions that are deemed acceptable by the NRD and the State of Nebraska. Applicant understands and agrees that Applicant’s failure to offset said new depletions may result in closure of this well or restrictions being imposed by the NRD on the number of acres of land that can be irrigated by this well.
  
2.  Applicant agrees to abide by well spacing and pumping capacity limitations that apply to the well that is the subject of this permit, whether such limitations arise pursuant to federal or state law or by rule or regulation of the NRD. Applicant understands and agrees that Applicant’s failure to comply with all rules and regulations of the NRD that pertain to this well may result in closure of this well and civil or criminal prosecution and other penalties.
  
3.  Applicant agrees to comply with all current and future rules and regulations of the NRD that pertain to this well. Applicant understands and agrees that Applicant’s failure to comply with all rules of regulations of the NRD that pertain to this well may result in closure of this well and civil or criminal prosecution and other penalties.
  
4.  Applicant agrees to maintain any and all surface water rights associated with the land to be irrigated by this well for the lifespan of the permitted well. Applicant understands and agrees that Applicant’s failure to comply with all rules and regulations of the NRD that pertain to this well may result in closure of this well and civil or criminal prosecution and other penalties.
  
5.  Applicant agrees to irrigate only land that has been certified for irrigation by the NRD (no new irrigated acres will be allowed). Applicant understands and agrees that Applicant’s failure to prevent irrigation of land not certified for irrigation by the NRD may result in closure of this well and prosecution by the State of Nebraska.

Applicant certifies that Applicant is familiar with the information contained in this instrument and that to the best of Applicant’s knowledge and belief, such information is true, complete and accurate. Applicant further acknowledges and agrees that the NRD and/or the State of Nebraska may impose additional conditions, limitations and restrictions on operation of the well that is the subject of this permit. Applicant further acknowledges and agrees that the conditions and limitations agreed to herein shall also be binding upon Applicant’s successors-in-interest to the well and/or the subject real estate.

**Tri-Basin NRD – Platte Basin Annual Report  
Appendix A**

I certify that I am familiar with the information contained in this application and that to the best of my knowledge and belief such information is true, complete and accurate. I further acknowledge that Tri-Basin Natural Resources District or the State of Nebraska may impose additional conditions, limitations and restrictions on operation of the well that is the subject of this permit.

\_\_\_\_\_  
Date

\_\_\_\_\_  
Signature of Applicant

\_\_\_\_\_  
Date

\_\_\_\_\_  
Signature of Applicant

\_\_\_\_\_  
Date

\_\_\_\_\_  
Signature of Witness

**Approval by Tri-Basin Natural Resources District**

\_\_\_\_\_  
Date

\_\_\_\_\_  
Signature of Tri-Basin NRD Representative

**Tri-Basin NRD Platte Basin Flowmeter Data for Irrigation Wells  
2018 Platte Basin Annual Report  
Appendix B**

<b>DNR Well Reg #</b>	<b>DNR Well ID #</b>	<b>Acres Reported</b>	<b>Gallons Used</b>	<b>Comments</b>
A-005254	805	152.0	24,520,000	
A-005527	1006	138.6	30,625,800	
A-005544-R1	113944	135.0	28,192,300	
A-005573-R1	203922	81.0	10,033,800	Supplemental well.
A-005616	1053	149.0	32,090,868	
A-005851-R2	234961	156.4	17,837,800	
A-005964B-R1	182843	116.0	20,371,473	
A-005987	1325	73.9	13,685,100	
A-006470	1647	130.0	30,600,385	
A-006862	1917	148.0	22,844,800	
A-007398-R1	219835	139.5	23,571,844	
A-008164-R1	174548	100.0	51,681,122	
G-000273-R1	98237	127.0	12,192,146	
G-000317-R2	219289	132.0	15,000,000	Supplemental Well.
G-000533	3831	126.0	5,798,194	
G-000559	3859	97.0	8,656,100	
G-000597-R1	207683	135.0	18,001,472	
G-000671-R1	3992	300.0	57,013,300	
G-001169	4563	151.0	26,058,300	
G-001228-R1	92085	73.0	30,176,200	
G-001374-R1	222615	135.0	26,968,900	
G-001498	4954	245.6	710,500	Meter One
G-001498	4954	245.6	28,472,800	Meter Two
G-001705	5190	140.0	20,215,066	
G-002216-R1	166014	128.0	24,865,000	
G-002383-R1	128836	132.0	14,227,500	
G-003468	7201	77.0	25,813,000	
G-004871	8801	80.0	8,595,327	
G-004955-R1	8893	148.0	28,001,700	
G-005097-R1	114236	151.3	22,399,500	
G-006383	10549	185.0	19,344,781	
G-007340-R1	162706	130.0	28,085,700	
G-007342-R1	162707	119.0	27,731,600	
G-008178	12651	130.0	16,418,666	
G-009596	14319	147.0	18,724,700	
G-010388-R1	213868	65.0	7,746,222	
G-011357-R1	16352	115.0	23,405,118	
G-011745-R1	16802	132.4	25,928,000	
G-012318	17473	137.0	12,864,000	
G-012651-R1	191520	67.0	16,720,075	
G-013097-R1	121819	132.0	18,731,500	
G-013149-R1	223630	75.0	16,862,090	
G-013423-R1	209336	260.0	18,664,030	

**Tri-Basin NRD Platte Basin Flowmeter Data for Irrigation Wells  
2018 Platte Basin Annual Report  
Appendix B**

<b>DNR Well Reg #</b>	<b>DNR Well ID #</b>	<b>Acres Reported</b>	<b>Gallons Used</b>	<b>Comments</b>
G-013974	19370	135.6	21,297,163	
G-014026	19432	146.0	7,922,500	Well Used Little in 2018. Hailed Out
G-014735-R1	20244	78.0	7,944,446	
G-016206	21928	142.0	11,403,500	
G-016446-R1	22203	130.0	11,200,481	
G-016633	22408	75.0	25,988,800	
G-017090-R1	172826	131.6	28,773,193	
G-020681	26927	133.6	13,436,613	
G-020831	27090	120.0	26,103,140	
G-021172	27458	98.0	13,634,900	
G-021193	27482	124.0	16,028,734	
G-021735-R1	28060	132.0	6,890,599	Well Used Little in 2018. Hailed Out - Did not harvest
G-022286	28646	30.0	1,936,623	
G-022950	29350	130.0	14,318,000	
G-022962-R1	227608	120.0	8,180,900	
G-023149	29563	26.0	7,185,763	
G-023266	29683	149.0	15,199,200	
G-023268-R1	241542	62.0	10,410,843	
G-023479	29912	125.0	18,790,500	
G-023572	30014	240.0	3,344,015	Supplemental Well.
G-023615	30058	155.0	24,857,900	
G-024078-R1	98512	129.6	14,719,000	
G-024327	30807	152.0	33,316,000	
G-024606-R1	228630	105.0	15,751,400	
G-024787-R1	97572	150.0	41,290,372	
G-024986	31500	120.0	4,890,978	
G-025069	31589	135.0	7,000,000	Estimate from producer.
G-025152	31677	125.0	23,172,000	
G-025207	31736	130.0	38,692,700	
G-025703-R1	242435	151.5	3,998,000	Supplemental Well.
G-025803	32369	140.0	22,735,500	
G-026446	33051	117.0	33,520,526	
G-027184	33850	140.0	20,478,000	
G-027484-R1	225652	135.0	3,509,111	Supplemental Well.
G-028077	34788	146.0	13,679,000	
G-028109-R1	34822	109.0	18,130,182	
G-028636	35400	132.0	7,344,000	Producer estimated. Field was hailed.
G-028660-R2	160179	135.0	3,665,790	Estimate. Supplemental Well. Hailed out
G-028765-R1	35540	142.0	23,977,000	
G-028884	35667	140.0	32,522,700	
G-029347	36156	104.7	25,464,000	
G-029951-R1	217569	38.0	11,276,241	



**Tri-Basin NRD Platte Basin Flowmeter Data for Irrigation Wells  
2018 Platte Basin Annual Report  
Appendix B**

<b>DNR Well Reg #</b>	<b>DNR Well ID #</b>	<b>Acres Reported</b>	<b>Gallons Used</b>	<b>Comments</b>
G-030265	37128	50.0	9,503,900	Producer estimated
G-030496	37375	130.0	13,801,292	
G-030668-R1	164677	135.0	9,730,200	Supplemental Well.
G-030676	37576	130.0	20,386,951	
G-030936-R1	176011	120.0	17,170,800	
G-031102	38030	147.0	23,893,000	
G-031354	38311	139.0	9,114,000	
G-031657	38620	62.0	16,074,700	
G-031862-R1	170685	147.5	16,328,100	
G-031885-R1	168468	149.9	25,855,600	
G-032220	39203	145.0	28,477,485	
G-032462-R1	166009	124.0	18,824,500	
G-032999-R2	189200	65.0	10,379,073	
G-033196-R1	158873	132.0	9,212,538	
G-033788	40819	147.2	5,063,600	Supplemental Well.
G-033845	40877	132.0	26,246,800	corners of this field are irrigated with Tri-county
G-034024	41062	85.0	17,583,000	
G-034034-R1	93086	77.0	6,967,800	
G-034439	41489	130.0	42,033,305	
G-034601	41656	70.0	11,248,200	
G-034607-R1	95424	191.0	39,068,903	
G-034763	41826	142.1	1,737,856	Senninger running total
G-034808	41871	134.0	10,006,249	Estimate. Meter exemption. Estimated 2.8 inches
G-035001-R1	246956	151.0	35,351,249	
G-035027	42096	116.7	17,460,900	
G-035028	42097	154.8	36,521,900	
G-035046-R1	149129	94.1	5,533,800	
G-035210-R1	42287	132.0	15,673,831	
G-035230-R1	209844	100.5	25,971,443	
G-036219-R1	213455	75.0	16,641,871	
G-036447-R1	203726	135.0	10,092,400	
G-036500	43633	132.0	14,826,355	
G-036585	43719	44.9	8,452,497	
G-036677	43812	130.0	31,075,580	
G-037041	44181	50.0	287,500	Supplemental Well. Used surface water
G-037482	44633	145.0	31,227,643	
G-037931-R1	227572	140.0	8,212,200	
G-038167-R2	209014	134.0	30,371,400	
G-038172	45343	130.0	30,380,166	
G-039054	46251	119.0	18,144,031	

**Tri-Basin NRD Platte Basin Flowmeter Data for Irrigation Wells  
2018 Platte Basin Annual Report  
Appendix B**

<b>DNR Well Reg #</b>	<b>DNR Well ID #</b>	<b>Acres Reported</b>	<b>Gallons Used</b>	<b>Comments</b>
G-039106	46304	128.0	29,889,000	
G-039190	46392	156.0	26,900,381	
G-039572	46786	77.9	28,048,724	
G-039663-R1	199851	95.0	11,614,400	
G-040337	47575	145.0	15,864,900	
G-040839	48087	118.0	14,692,757	
G-041057	48311	79.0	32,724,100	
G-041183	48439	142.0	33,212,500	
G-041329-R1	219361	125.0	4,169,225	
G-041350	48611	127.0	12,205,723	
G-041369-R1	188563	66.0	4,959,100	
G-041826	49107	157.8	11,605,100	
G-041978-R1	222393	240.0	8,255,902	Supplemental Well.
G-041996-R1	228128	17.0	3,248,705	
G-042019	49302	145.0	28,240,974	
G-042824	50125	159.9	22,436,300	
G-042992-R1	198737	135.0	5,363,700	
G-043275-R1	50593	137.0	10,130,071	
G-043276-R1	169041	147.0	13,790,000	Estimate.
G-043366-R1	127238	83.0	11,811,000	
G-043639	50973	151.0	29,516,398	
G-043947	51286	137.0	11,794,300	
G-044047	51391	145.0	12,641,001	
G-044222	51568	165.0	38,408,300	
G-044570	51919	30.0	4,580,000	Estimate
G-044608	51959	132.0	26,191,400	
G-044680	52031	141.0	27,770,938	
G-044918	52271	156.4	13,204,447	
G-045284	52644	135.1	18,429,700	
G-045549-R1	118572	135.9	20,417,900	
G-046380	53760	135.0	19,312,739	
G-046434	53847	150.0	17,187,300	
G-048424	55885	111.0	15,461,200	
G-049528	57016	133.0	27,801,400	
G-049567-R1	221186	146.0	22,077,016	
G-050030	57531	139.0	17,758,000	
G-050941	58466	17.0	6,236,839	
G-053420	60983	160.0	23,866,736	
G-053870	61445	150.0	21,430,000	
G-054523	62111	150.0	23,720,300	
G-055251	62856	135.5	18,929,100	
G-055382-R1	172201	156.7	11,263,000	
G-055521	63130	136.8	69,732,015	

**Tri-Basin NRD Platte Basin Flowmeter Data for Irrigation Wells  
2018 Platte Basin Annual Report  
Appendix B**

<b>DNR Well Reg #</b>	<b>DNR Well ID #</b>	<b>Acres Reported</b>	<b>Gallons Used</b>	<b>Comments</b>
G-056004	63618	102.5	23,386,700	
G-056606-R1	64243	133.0	19,382,600	
G-057082	64744	130.0	18,587,000	Supplemental Well
G-057427-R1	222051	187.0	22,632,000	
G-058508	66218	136.0	19,096,865	
G-059592	67347	149.3	21,890,400	
G-059676	67433	57.3	23,629,410	
G-060797-R1	212228	130.0	25,487,287	
G-061063-R1	213557	240.0	47,581,411	
G-061501-R1	221352	152.0	11,711,200	
G-061654	69490	150.5	35,497,700	
G-061946	69783	128.0	25,826,900	
G-063158	71057	156.0	10,820,900	
G-063177	71076	138.7	24,693,032	
G-063232	71133	150.0	18,891,800	
G-063877	71796	91.0	19,952,100	
G-063968	71890	130.0	32,617,656	
G-064069	71993	65.3	10,200,100	
G-064756	72722	77.2	20,031,500	
G-064840	72808	145.0	19,554,700	
G-065598	73589	130.0	28,858,185	
G-066150	74154	135.0	18,421,000	
G-066270	74279	134.0	24,301,000	
G-066404	74421	130.0	27,702,782	
G-066511	74530	149.2	26,764,800	
G-067478	75541	65.0	6,861,816	
G-067820	75893	135.0	11,748,500	
G-067926	76002	103.0	15,589,300	
G-067960	76038	132.0	33,692,300	
G-068235	76316	127.0	22,337,151	
G-068903	77028	134.8	8,343,400	
G-068938	77063	135.0	20,528,152	
G-069457	77609	256.0	28,289,080	
G-069536	77689	130.0	37,149,700	
G-069613	77769	275.0	45,736,568	
G-070731	78892	158.2	33,080,000	
G-070802	78963	145.0	18,925,000	
G-071177-R1	225427	133.0	15,794,124	
G-071178-R1	162859	144.8	12,784,200	
G-071179	79340	120.0	23,491,000	
G-071541	79703	128.0	21,784,024	
G-072455-R1	206053	132.0	24,486,934	
G-072667	80855	140.0	15,272,495	

**Tri-Basin NRD Platte Basin Flowmeter Data for Irrigation Wells  
2018 Platte Basin Annual Report  
Appendix B**

<b>DNR Well Reg #</b>	<b>DNR Well ID #</b>	<b>Acres Reported</b>	<b>Gallons Used</b>	<b>Comments</b>
G-073172	81360	72.0	11,351,458	
G-073798	82134	124.0	19,693,166	
G-073863	82203	150.0	35,613,900	
G-074144	82484	134.0	20,810,010	
G-074176	82517	130.0	18,269,211	
G-074256	82601	73.0	16,901,100	
G-074282	82627	140.0	27,412,000	
G-074365	82710	127.0	6,897,116	Estimate
G-074392	82739	76.1	7,938,300	
G-074662	83011	105.0	28,842,800	
G-087416	99269	140.0	27,831,492	
G-087842	99647	143.0	16,989,900	
G-091120	102868	142.0	24,419,100	
G-091407	102859	120.0	38,279,200	
G-094083	107849	130.0	19,864,000	
G-096150	109726	130.0	15,019,420	
G-096555	109842	130.0	31,284,200	
G-096676	112194	130.0	12,939,695	
G-097707-R1	236661	143.3	25,744,978	
G-100388	114419	145.0	26,187,200	
G-109999	128947	225.0	11,286,560	
G-110172	129232	150.0	33,321,700	
G-116457	140343	130.0	12,473,189	
G-116906	141679	75.0	20,880,000	Estimate provided by producer from hours.
G-118169	142719	160.8	27,784,787	
G-119660	146805	88.0	8,928,235	
G-121077	147633	152.8	22,907,300	
G-121219	146009	120.0	18,629,400	
G-121766	146008	150.0	27,143,681	
G-121894	148344	182.0	26,891,179	
G-122529	147634	78.2	4,968,200	Hailed.
G-123303	149183	64.0	3,870,000	
G-124617	152724	128.0	21,598,182	
G-125286	152448	40.0	18,333,900	
G-125287	152447	130.0	28,396,400	
G-127496	153919	127.0	10,866,500	
G-127559	155815	135.0	14,885,800	
G-128172	154500	37.5	3,438,000	
G-129150	154896	147.0	8,410,100	Supplemental well.
G-129241	158555	90.0	9,245,500	
G-129257	160440	137.0	7,786,700	Well Used Little in 2018. Hailed Out
G-129577	158376	120.0	17,844,200	

**Tri-Basin NRD Platte Basin Flowmeter Data for Irrigation Wells  
2018 Platte Basin Annual Report  
Appendix B**

<b>DNR Well Reg #</b>	<b>DNR Well ID #</b>	<b>Acres Reported</b>	<b>Gallons Used</b>	<b>Comments</b>
G-129685	156989	136.2	1,739,214	Supplemental well
G-129692	160438	140.0	30,110,700	
G-130058	154894	100.0	32,200,570	
G-130108	159812	75.0	8,683,578	
G-130225	160878	156.0	35,026,400	
G-130559	156326	152.5	27,971,800	
G-130635	159808	19.0	5,106,100	
G-130699	161380	135.1	1,668,400	Supplemental Well.
G-130801	154254	130.0	21,062,600	
G-130918	161076	152.2	18,641,200	
G-130954	162385	10.0	25,000	Well Not Used in 2018 for crop
G-130969	161430	145.0	5,216,283	Supplemental Well.
G-131043	161371	143.0	17,859,000	
G-131271	156876	130.0	3,530,020	Estimate. Supplemental Well
G-131440	156871	124.0	4,092,900	Supplemental Well.
G-131490	154924	79.8	11,328,920	
G-131622	155819	100.0	7,540,000	Well Used Little in 2018. Hailed Out
G-131623	155812	135.0	16,932,000	Slight hail
G-131726	162133	150.9	18,433,900	
G-131774	163016	144.0	1,118,489	
G-131925	162127	133.0	2,825,000	Supplemental Well.
G-131927	161757	130.0	15,151,600	
G-131930	162388	122.6	18,603,800	
G-132158	163442	130.0	20,781,900	
G-132168	160566	135.0	22,965,700	
G-132241	165009	128.0	7,390,000	
G-132339	156879	129.4	4,847,300	Supplemental Well.
G-132340	156877	135.0	3,741,800	Supplemental well.
G-132344	156789	12.0	2,828,500	
G-132359	160881	132.0	8,021,563	Supplemental Well.
G-132512	161373	135.0	15,433,200	
G-132529	161379	141.5	1,435,300	Supplemental Well.
G-132531	161571	140.0	29,982,360	
G-132532	161572	151.1	50,199,000	
G-132544	159256	136.5	14,741,635	
G-132547	159597	153.5	11,054,400	Supplemental Well.
G-132644	160439	157.6	77,080,800	
G-132663	164229	154.3	22,274,154	
G-132700	165015	132.0	67,482,500	

**Tri-Basin NRD Platte Basin Flowmeter Data for Irrigation Wells  
2018 Platte Basin Annual Report  
Appendix B**

<b>DNR Well Reg #</b>	<b>DNR Well ID #</b>	<b>Acres Reported</b>	<b>Gallons Used</b>	<b>Comments</b>
G-132701	165016	132.0	76,812,800	
G-132733	159884	160.0	19,855,200	
G-132734	164687	115.0	36,549,012	
G-132768	165657	140.1	15,350,300	
G-132769	160567	144.0	28,184,100	
G-132798	159254	130.0	29,309,484	Meter measures both groundwater and surface water. All well-2018
G-132840	160488	151.0	24,590,000	Estimate
G-133038	165739	130.0	19,730,200	
G-133088	157915	130.0	12,272,000	
G-133180	161381	144.7	3,973,800	Supplemental Well.
G-133181	161382	141.9	5,320,100	Supplemental Well.
G-133233	162390	117.0	22,946,400	
G-133234	161749	118.0	23,097,300	
G-133235	158379	117.0	2,268,400	Supplemental Well.
G-133352	162136	135.0	10,654,414	
G-133405	165547	120.0	11,494,100	
G-133416	165335	52.0	18,540,700	
G-133421	161383	101.0	27,358,198	
G-133426	165471	65.0	13,517,700	
G-133471	163782	130.0	16,118,200	
G-133725	162123	130.0	11,975,800	
G-133759	160323	87.0	13,796,404	
G-133929	164406	75.0	8,282,600	
G-133952	166448		3,880,000	Well Used to fill Mosaic Pond
G-134113	166449	111.0	15,939,800	
G-134130	162140	130.0	20,885,227	
G-134132	162139	67.0	8,290,800	
G-134199	162134	130.0	11,559,729	
G-134206	166528	123.5	2,165,200	Supplemental Well.
G-134230	166010	130.5	25,972,300	
G-134566	160564	123.0	17,638,200	
G-134879	162601	65.0	3,815,000	Supplemental Well.
G-135119	169328	156.3	22,363,600	
G-135169	166605	120.0	21,972,100	
G-135192	167715	5.0	1,804,900	
G-135213	166040	86.0	21,490,100	
G-135516	169018	120.0	30,637,500	
G-135532	160565	140.0	12,627,900	Supplemental Well.
G-135822	169468	99.6	12,295,100	
G-136259	169013	86.0	11,000,300	
G-136650	169774	135.0	35,453,300	
G-136691	165017	135.0	17,761,200	Supplemental Well
G-137318	169448	110.0	4,506,000	
G-137329	169841	134.3	24,612,300	

**Tri-Basin NRD Platte Basin Flowmeter Data for Irrigation Wells  
2018 Platte Basin Annual Report  
Appendix B**

<b>DNR Well Reg #</b>	<b>DNR Well ID #</b>	<b>Acres Reported</b>	<b>Gallons Used</b>	<b>Comments</b>
G-137381	170158	145.0	9,775,440	
G-137402	170172	135.0	24,124,699	
G-137403	170742	72.0	6,129,700	
G-137447	165018	135.0	30,814,600	Supplemental Well
G-137937	172642	134.0	58,978,400	
G-137967	166808	292.0	5,375,400	Supplemental Well.
G-138203	172442	155.0	36,498,777	
G-138280	162142	66.0	10,413,600	
G-138416	162122	145.0	14,021,200	
G-138534	172370	80.0	26,301,907	
G-138594	172862	74.6	5,220,300	
G-139059	172599	106.0	26,876,200	
G-139271	170679	120.0	10,603,500	
G-139360	165336	40.0	21,087,500	
G-139572	169042	100.0	21,508,300	
G-140625	172547	128.0	5,575,300	Supplemental Well. Used well for water for cows during winter.
G-141518	173834	65.0	5,074,100	Hailed Out
G-141860	177863	93.3	5,929,511	
G-142430	178761	130.0	15,026,100	Supplemental Well.
G-142530	173630	139.0	27,645,700	
G-142967	178585	215.0	40,303,800	
G-144298	182757	65.0	13,396,200	
G-144716	182053	145.0	22,293,100	Supplemental Well.
G-144783	183104	135.0	21,847,600	Supplemental Well.
G-144823	182952	165.0	2,089,700	Supplemental Well.
G-144980	182209	135.0	31,857,600	Supplemental Well.
G-145042	183105	100.0	16,226,000	Supplemental Well.
G-145565-R1	190217	130.0	18,740,876	Supplemental Well.
G-145863	185009	132.0	27,602,400	Supplemental Well.
G-145885	178762	40.0	1,878,900	Supplemental Well.
G-146977	180054	50.0	14,293,100	
G-147124	182953	150.0	3,706,100	Supplemental Well.
G-147456	188634	65.0	10,546,070	
G-147457	188635	136.0	29,015,406	
G-148411	189364	135.3	27,729,100	Supplemental Well.
G-148565	187309	131.7	3,576,182	Estimate. Supplemental Well.
G-148621	191026	75.0	17,439,113	Supplemental Well.
G-148622	190543	130.0	2,174,700	Supplemental Well.
G-148685	188800	125.0	32,395,536	Supplemental Well.
G-148702	189813	94.0	34,241,194	
G-148743	187694	100.0	2,552,476	Supplemental Well.
G-149188	191318	134.0	22,255,400	Supplemental Well.
G-149618	192106	132.0	22,701,830	Supplemental Well.

**Tri-Basin NRD Platte Basin Flowmeter Data for Irrigation Wells  
2018 Platte Basin Annual Report  
Appendix B**

<b>DNR Well Reg #</b>	<b>DNR Well ID #</b>	<b>Acres Reported</b>	<b>Gallons Used</b>	<b>Comments</b>
G-149663	191521	74.0	17,153,453	
G-149890	191025	87.0	6,168,031	
G-150891	187697	129.0	18,679,400	Surface Water Used.
G-151663	191248	62.0	10,412,744	Supplemental Well.
G-152676	191017	125.0	23,932,449	
G-152707	197427	135.0	9,214,600	Supplemental Well.
G-153081	197627	68.0	7,116,520	
G-153624	199985	95.0	13,777,124	
G-157641	202660	120.0	369,294	Supplemental Well.
G-158114	208108	72.0	6,462,652	Supplemental Well.
G-159284	208463	162.8	28,902,717	
G-161020	213049	128.0	33,549,500	
G-161031	214156	30.0	11,268,910	
G-161519	208462	67.0	7,626,500	
G-162926	216452	74.5	10,322,321	Supplemental Well.
G-164032	219279	155.0	25,741,992	
G-164644	218534	160.0	19,279,340	
G-165055	220042	138.0	13,534,911	Supplemental Well.
G-165537	215283	48.0	17,025,558	
G-165597	218166	75.0	17,211,019	Supplemental Well.
G-166011	221015	130.0	35,695,833	
G-166108	222272	67.0	12,370,547	Supplemental Well.
G-166557	217687	124.0	34,069,037	
G-166720	222354	148.0	21,642,824	Supplemental well.
G-167012	221958	31.8	6,385,263	
G-167286	223104	144.0	14,363,922	Supplemental well.
G-167416	222557	77.1	18,605,649	
G-167483	224220	105.0	4,219,189	Supplemental well.
G-167695	221189	127.0	6,015,969	Supplemental Well.
G-167696	221856	130.0	6,939,205	Supplemental Well.
G-167697	222232	4.0	104,543	Supplemental Well.
G-167889	222616	76.0	15,071,284	Supplemental well.
G-168610	217989	143.0	19,190,817	Supplemental Well. Some hail
G-169763	225845	25.0	5,957,700	Supplemental Well.
G-169866	224583	88.0	7,468,979	
G-170249	228482	122.0	19,768,112	Supplemental Well.
G-170384	228390	208.0	35,722,716	
G-170397	222559	79.4	1,112,499	Supplemental well.
G-170400	226797	67.0	10,049,423	
G-171454	229850	81.4	8,905,697	Supplemental Well. Field had some hail damage.
G-171471	229476	65.0	6,810,200	Supplemental Well.



**Tri-Basin NRD Platte Basin Flowmeter Data for Irrigation Wells  
2018 Platte Basin Annual Report  
Appendix B**

<b>DNR Well Reg #</b>	<b>DNR Well ID #</b>	<b>Acres Reported</b>	<b>Gallons Used</b>	<b>Comments</b>
G-171948	228629	133.0	23,708,700	Supplemental Well.
G-172337	230621	130.5	2,966,031	Supplemental Well.
G-172642	226828	137.0	11,185,275	Supplemental Well.
G-172798	230409	143.2	12,427,842	Supplemental Well.
G-173699	230989	171.0	37,878,472	
G-174251	230397	100.0	2,872,893	Supplemental well.
G-174591	234579	82.0	5,032,994	Supplemental well.
G-174932	232741	123.0	6,385,806	Supplemental well.
G-175697	235514	75.0	30,412,480	Supplemental Well.
G-175830	235770	35.0	3,284,548	
G-175946	231156	140.0	16,862,634	
G-175949	236660	108.0	5,631,740	Supplemental Well.
G-176126	235952	116.0	1,265,105	Supplemental Well.
G-176401	236745	15.0	10,873,819	
G-177578	239253	21.4	11,042,174	
G-178903	240974	132.0	12,721,920	
		52,971.0	7,954,251,679	<b>Gallons Used</b>
2/8/2019			24,411	<b>Acre Feet Used</b>

**Tri-Basin NRD Platte Basin No Till Acres - 2018 Platte Basin Annual Report**  
**Appendix C**

Well Reg	Legal	T Ship	Range	Sect	Irrigated acres	Tillage Practice
G-024713	NE 1/4	5	16	4	142	No Till
G-069112	SW 1/4	5	16	4	25	No Till
G-003681	SW 1/4	5	16	4	147	No Till
G-039345	NW 1/4	5	16	4	78	No Till
G-025035	SW 1/4	5	16	5	75.1	No Till
G-030567	NE 1/4	5	16	7	75	No Till
G-023406	SW 1/4	5	16	7	127	No Till
G-051674	NW 1/4	5	16	8	70	No Till
G-069714	NE 1/4	5	16	8	135	No Till
G-025915	SW 1/4	5	16	8	78	No Till
G-027444	NW 1/4	5	16	8	70	No Till
G-008291	NE 1/4	5	16	9	75.9	No Till
G-016226	NW 1/4	5	16	17	70	No Till
G-073554	NE 1/4	5	16	17	78	No Till
G-130632	SW of NW 1/4	5	16	18	125	No Till
G-039194	SE 1/4	5	16	18	71.53	No Till
G-039193	SE 1/4	5	16	18	78.75	No Till
G-115336	SW 1/4	5	16	19	63	No Till
G-127045	SE of SE 1/4	5	16	19	130	No Till
G-086748	NW 1/4	5	16	19	120	No Till
G-071117	SW 1/4	5	16	20	128	No Till
G-073037	NE 1/4	5	16	20	133	No Till
G-039492	SW 1/4	5	16	21	151	No Till
G-064303	NW 1/4	5	16	21	144	No Till
G-030857	NW 1/4	5	16	21	22	No Till
G-008191	SE 1/4	5	16	22	66.7	No Till
G-042526	NW 1/4	5	16	22	150	No Till
G-023920	NE 1/4	5	16	22	110	No Till
G-068947	NE 1/4	5	16	23	155	No Till
G-013965	SW 1/4	5	16	23	155	No Till
G-030229	NE 1/4	5	16	24	145.45	No Till
G-061041	SE 1/4	5	16	24	135	No Till
G-007196	NW 1/4	5	16	24	145	No Till
G-013352	SW 1/4	5	16	24	133	No Till
G-011958	NW 1/4	5	16	26	158.61	No Till
G-023474	NE 1/4	5	16	26	158.62	No Till
G-064292	NW 1/4	5	16	26	158.61	No Till
G-001416	NW 1/4	5	16	27	80	No Till
G-013964	SW 1/4	5	16	28	13	No Till
G-028128	SW 1/4	5	16	28	150	No Till
G-037547	NE 1/4	5	16	29	45	No Till
G-065030	SE 1/4	5	16	29	141	No Till
G-013963	NE 1/4	5	16	29	123	No Till
G-067052	SW 1/4	5	16	29	120	No Till
G-025010	NW 1/4	5	16	29	65	No Till
G-020298	NW 1/4	5	16	30	64	No Till
G-023721	SW 1/4	5	16	31	125.7	No Till
G-028336	SW 1/4	5	16	31	30.8	No Till
G-013511	NW 1/4	5	16	31	31.52	No Till
G-026087	SW 1/4	5	16	32	161	No Till
G-114756	NW 1/4	5	16	32	37	No Till
G-128679	NW 1/4	5	16	32	67	No Till
G-002716	NE 1/4	5	16	33	18	No Till

**Tri-Basin NRD Platte Basin No Till Acres - 2018 Platte Basin Annual Report**  
**Appendix C**

Well Reg	Legal	T Ship	Range	Sect	Irrigated acres	Tillage Practice
G-050075	SW 1/4	5	16	33	130	No Till
G-082492	NW 1/4	5	16	33	151	No Till
G-039968	NE 1/4	5	16	34	80	No Till
G-035158	NW 1/4	5	16	34	66	No Till
G-002671	NW 1/4	5	16	35	145	No Till
G-050365	SW 1/4	5	16	35	65	No Till
G-074588	SE 1/4	5	16	36	155	No Till
G-027064	SE 1/4	5	17	2	80	No Till
G-032478	SE 1/4	5	17	3	125	No Till
G-044612	NE 1/4	5	17	4	100	No Till
G-047172	SW 1/4	5	17	5	132	No Till
G-010454	lots 11, 12, 17, & 18	5	17	6	143	No Till
G-045681	NE 1/4	5	17	6	128	No Till
G-044893	lots 3, 4, 9, & 10	5	17	6	130	No Till
G-018114	lots 13, 14, pts of 15, 16	5	17	6	143	No Till
G-076517	lots pt 7, 9, 10, 11, 14, 15, & pt 16	5	17	7	265	No Till
G-076516	lots 8, pt 1	5	17	7	38	No Till
G-062245	pts of S2 of NE 1/4 & N2 of SE 1/4	5	17	7	7	No Till
G-063852	NE 1/4	5	17	7	95	No Till
G-032082	NE 1/4	5	17	9	73	No Till
G-052284	NW 1/4	5	17	9	78	No Till
G-001336	NE 1/4	5	17	10	128	No Till
A-007010	SE 1/4	5	17	11	64	No Till
G-031733	SW 1/4	5	17	13	11.3	No Till
G-000125	SE 1/4	5	17	14	75	No Till
G-087522	NW 1/4	5	17	14	131	No Till
G-083647	SW 1/4	5	17	14	136	No Till
G-072383	NE 1/4	5	17	14	118.5	No Till
G-023301	NW 1/4	5	17	15	130	No Till
G-053691	SW 1/4	5	17	15	46.03	No Till
G-055469	SE 1/4	5	17	16	120	No Till
A-008150	NW 1/4	5	17	16	125	No Till
G-146199	NE1/4	5	17	16	125	No Till
G-060341	SE 1/4	5	17	17	65	No Till
G-071535	lots 13 & pt S2 lot 12	5	17	18	61	No Till
G-029189	lots 3, 4, 5, & 6	5	17	18	153	No Till
G-041544	lots 3-6	5	17	19	79.5	No Till
G-061141	NW 1/4	5	17	20	132	No Till
G-091242	NE 1/4	5	17	21	46.3	No Till
G-165675	NW 1/4	5	17	21	55.3	No Till
G-042382	NW 1/4	5	17	21	35.1	No Till
G-046943	SW 1/4	5	17	23	77	No Till
G-056707	NE 1/4	5	17	23	136	No Till
G-076846	SW 1/4	5	17	23	77	No Till
G-036947	SE 1/4	5	17	23	65	No Till
G-067974	SW 1/4	5	17	24	130	No Till
G-028013	NE 1/4	5	17	25	130	No Till
G-048083	NW 1/4	5	17	25	130	No Till
G-069535	SE 1/4	5	17	25	53	No Till
G-128351	SW of SE 1/4	5	17	26	100	No Till
G-128350	NE of NE 1/4	5	17	26	65	No Till
G-054773	SE 1/4	5	17	30	160	No Till

**Tri-Basin NRD Platte Basin No Till Acres - 2018 Platte Basin Annual Report**  
**Appendix C**

Well Reg	Legal	T Ship	Range	Sect	Irrigated acres	Tillage Practice
G-054772	lots 11, 12, 13, & 14	5	17	30	160	No Till
G-023905	NE 1/4	5	17	32	135	No Till
G-051199	SW 1/4	5	17	33	136	No Till
G-053486	SE 1/4	5	17	33	64	No Till
G-025739	SW 1/4	5	17	33	136	No Till
G-024353	NE 1/4	5	17	34	72	No Till
G-046944	NE 1/4	5	17	34	72	No Till
G-001694	SW 1/4	5	17	34	97	No Till
G-134304	NW of SE 1/4	5	17	34	72	No Till
G-028120	NW 1/4	5	17	34	66	No Till
G-030282	NE 1/4	5	17	35	125	No Till
G-115347	SW 1/4	5	17	35	115	No Till
G-029273	NW 1/4	5	17	36	72	No Till
G-054318	NE 1/4	5	17	36	43	No Till
G-047270	SE 1/4	5	18	1	54	No Till
A-006382	NE 1/4	5	18	1	160	No Till
G-023886	NE 1/4	5	18	2	100	No Till
G-006858	SW 1/4	5	18	3	135	No Till
G-028043	SW 1/4	5	18	3	14	No Till
G-047630	SW 1/4	5	18	6	120	No Till
G-027284	NW 1/4	5	18	6	70	No Till
G-033786	SW 1/4	5	18	7	40	No Till
G-015350	NW 1/4	5	18	8	145	No Till
G-074706	NE 1/4	5	18	8	154	No Till
G-171394	SE 1/4	5	18	9	70	No Till
G-031750	SE 1/4	5	18	9	70	No Till
G-090257	SE 1/4	5	18	10	67	No Till
G-028804	NW 1/4	5	18	11	65	No Till
G-022762	NE 1/4	5	18	11	65	No Till
G-024376	SW 1/4	5	18	12	64	No Till
G-165018	NE 1/4	5	18	12	85	No Till
G-126616	NW 1/4	5	18	12	200	No Till
G-062292B	SE 1/4	5	18	13	157	No Till
G-025632	NE 1/4	5	18	14	65	No Till
G-027510	SW 1/4	5	18	15	155	No Till
G-049435	NW 1/4	5	18	15	70	No Till
G-027808	SE 1/4	5	18	16	97	No Till
G-048441	NE 1/4	5	18	16	111	No Till
G-066990	NW 1/4	5	18	17	150.8	No Till
G-037902	NE 1/4	5	18	17	130	No Till
G-095680	NE 1/4	5	18	18	130	No Till
G-021705	NW 1/4	5	18	18	76	No Till
G-015354	SW 1/4	5	18	19	139	No Till
G-065869	NW 1/4	5	18	19	138	No Till
G-072701	NW 1/4	5	18	20	130	No Till
G-005936	SW 1/4	5	18	20	130	No Till
G-047719	NW 1/4	5	18	21	138	No Till
G-062981	NE 1/4	5	18	21	147	No Till
G-050005	SW 1/4	5	18	21	150.9	No Till
G-044991	SE 1/4	5	18	22	148.5	No Till
G-022590	NW 1/4	5	18	22	150.27	No Till
G-074640	NE 1/4	5	18	22	132	No Till
G-070513	SW 1/4	5	18	23	155	No Till

**Tri-Basin NRD Platte Basin No Till Acres - 2018 Platte Basin Annual Report**  
**Appendix C**

<b>Well Reg</b>	<b>Legal</b>	<b>T Ship</b>	<b>Range</b>	<b>Sect</b>	<b>Irrigated acres</b>	<b>Tillage Practice</b>
G-031620	NW 1/4	5	18	23	132	No Till
G-060613	SE 1/4	5	18	24	132	No Till
G-081419	SW 1/4	5	18	24	52	No Till
G-022098	NW 1/4	5	18	24	100	No Till
G-129695	NW of SW 1/4	5	18	25	68.1	No Till
G-050678	NE 1/4	5	18	27	154	No Till
G-011811	SW 1/4	5	18	27	72	No Till
G-031086	SE 1/4	5	18	27	140	No Till
G-025488	SE 1/4	5	18	28	120	No Till
G-038067	SW of NE 1/4	5	18	28	130	No Till
G-070514	NW 1/4	5	18	28	129	No Till
G-069042	SW 1/4	5	18	31	133	No Till
G-040134	NW 1/4	5	18	31	136	No Till
G-022971	SE 1/4	5	18	32	130	No Till
G-129056	NE of NE 1/4	5	18	32	133	No Till
G-042013	NW 1/4	5	18	32	150	No Till
G-045830	NW 1/4	5	18	33	92	No Till
G-042294	SE 1/4	5	18	34	130	No Till
G-002145	NE 1/4	5	18	34	130	No Till
G-030725	SE 1/4	5	18	35	72	No Till
G-050229	NE 1/4	5	18	35	128	No Till
G-037900	NW 1/4	5	18	35	131	No Till
G-129768	NE of SW 1/4	5	18	36	100	No Till
G-119626	SE of SE 1/4	5	18	36	66	No Till
G-082140	SE 1/4	5	19	1	127	No Till
G-129611	NE of NE 1/4	5	19	2	65	No Till
G-055772	NE 1/4	5	19	2	86	No Till
G-022430	NE 1/4	5	19	3	141	No Till
G-023062	SW 1/4	5	19	4	132	No Till
G-178984	SW of NW	5	19	4	40.4	No Till
G-044680	NE 1/4	5	19	5	142	No Till
G-120087	Cent of SW 1/4	5	19	6	128.2	No Till
G-039462	SE 1/4	5	19	6	132	No Till
G-029428	NW 1/4	5	19	6	112	No Till
G-060748	NE 1/4	5	19	6	130	No Till
A-007514	SW 1/4	5	19	7	140	No Till
G-039385	NW 1/4	5	19	7	151	No Till
G-005935	NE 1/4	5	19	7	140	No Till
G-115304	SE	5	19	7	122	No Till
G-039461	NW 1/4	5	19	8	130	No Till
G-001256	SE 1/4	5	19	9	156	No Till
G-025126	SW 1/4	5	19	9	149	No Till
G-024222	SW 1/4	5	19	11	130	No Till
G-000540	SE 1/4	5	19	11	87	No Till
G-041441	NW 1/4	5	19	11	135	No Till
G-041783	SE 1/4	5	19	11	144	No Till
G-012366	NE 1/4	5	19	11	142	No Till
G-056969	NW 1/4	5	19	12	155	No Till
G-040491	SE 1/4	5	19	13	152	No Till
G-045600	NW 1/4	5	19	14	128	No Till
G-020404	SW 1/4	5	19	14	130	No Till
G-042864	SE 1/4	5	19	15	135	No Till
G-006176	NE 1/4	5	19	15	142	No Till
G-129594	NE of NE 1/4	5	19	16	45	No Till

**Tri-Basin NRD Platte Basin No Till Acres - 2018 Platte Basin Annual Report**  
**Appendix C**

<b>Well Reg</b>	<b>Legal</b>	<b>T Ship</b>	<b>Range</b>	<b>Sect</b>	<b>Irrigated acres</b>	<b>Tillage Practice</b>
G-169903	N 1/2 of NW 1/4	5	19	16	65	No Till
G-037905	NE 1/4	5	19	17	133	No Till
G-032103	NW NE 1/4	5	19	18	75	No Till
G-109792	NW 1/4	5	19	19	158	No Till
G-028049	SE 1/4	5	19	19	64	No Till
G-015987	SW 1/4	5	19	19	148	No Till
G-090649	NE 1/4	5	19	19	130	No Till
G-001341	SE 1/4	5	19	20	100	No Till
G-073389	NW 1/4	5	19	20	155	No Till
G-032374	SW 1/4	5	19	22	130.6	No Till
G-049914	NE 1/4	5	19	22	134	No Till
G-003517	SE 1/4	5	19	22	48.5	No Till
G-003516	NE 1/4	5	19	22	25	No Till
G-026301	NE 1/4	5	19	23	125	No Till
A-007273	SE 1/4	5	19	23	135	No Till
G-116848	SW 1/4	5	19	23	131	No Till
G-072466	SE 1/4	5	19	25	126	No Till
G-034186	SW 1/4	5	19	25	117	No Till
G-028487	SW 1/4	5	19	26	150	No Till
G-022556	NE 1/4	5	19	27	120	No Till
G-036688	NW 1/4	5	19	27	145	No Till
G-094006	SW 1/4	5	19	29	158	No Till
G-037484	NW 1/4	5	19	29	145	No Till
G-096952	NW 1/4	5	19	31	125	No Till
G-094233	NE 1/4	5	19	31	81	No Till
G-053938	NE 1/4	5	19	32	174	No Till
G-025704	SW 1/4	5	19	33	186	No Till
G-042011	NE 1/4	5	19	33	80	No Till
G-047595	NE 1/4	5	19	34	185	No Till
G-044270	SE 1/4	5	19	34	155	No Till
G-030784	SW 1/4	5	19	36	130	No Till
G-040116	NE 1/4	5	19	36	145	No Till
G-086858	NW 1/4	5	19	36	132	No Till
G-086432	NW 1/4	6	16	4	143	No Till
G-123407	NE 1/4	6	16	5	135	No Till
G-074451	SE 1/4	6	16	6	130	No Till
G-104101	S 1/2 of SW 1/4	6	16	6	130	No Till
G-012318	NW 1/4	6	16	17	57.73	No Till
G-133929	NW of NE 1/4	6	16	17	120.3	No Till
G-024234	NE 1/4	6	16	19	104	No Till
G-016296	SW 1/4	6	16	21	37	No Till
G-009596	NE of SE 1/4	6	16	29	72.6	No Till
G-081367	SW 1/4	6	16	32	172	No Till
A-005509	NE 1/4	6	16	32	65	No Till
G-057571	NW 1/4	6	16	32	112	No Till
G-130559	SW of SW 1/4	6	17	3	155	No Till
G-011361	NE 1/4	6	17	4	152	No Till
G-041432	SW 1/4	6	17	4	50	No Till
G-129246	Cent of NE 1/4	6	17	5	135	No Till
G-132996	SW of NW 1/4	6	17	5	77	No Till
G-100986	lots pts 5, 6, 7, & 8	6	17	6	90	No Till
G-036707	lots 3, 6	6	17	7	23	No Till
G-039539	lots 9, 10, 15 & 16	6	17	7	140	No Till
G-068245	lots 11 & 14	6	17	7	65	No Till

**Tri-Basin NRD Platte Basin No Till Acres - 2018 Platte Basin Annual Report**  
**Appendix C**

<b>Well Reg</b>	<b>Legal</b>	<b>T Ship</b>	<b>Range</b>	<b>Sect</b>	<b>Irrigated acres</b>	<b>Tillage Practice</b>
G-132544	SE of SE 1/4	6	17	7	66	No Till
G-053867	lots 1, 2, 7 & 8	6	17	7	140	No Till
G-069166	NE 1/4	6	17	8	75	No Till
G-133416	NW of NW 1/4	6	17	8	72	No Till
G-027040	NE 1/4	6	17	11	110	No Till
G-028826	NW 1/4	6	17	13	130	No Till
G-030193	NW 1/4	6	17	14	49	No Till
G-039977	NE 1/4	6	17	15	130	No Till
G-132798	NE of NE 1/4	6	17	17	66	No Till
G-113080	NE 1/4	6	17	18	150	No Till
G-031717	lots 2 & 7	6	17	19	120	No Till
G-130755	SE of NW 1/4	6	17	21	130	No Till
G-006476	SW 1/4	6	17	21	130	No Till
G-135163	SW of SE 1/4	6	17	22	40	No Till
G-069603	SE 1/4	6	17	22	85	No Till
G-068317	NW 1/4	6	17	23	40	No Till
G-036220	NE 1/4	6	17	23	185	No Till
G-126657	NW of NW 1/4	6	17	25	73.7	No Till
G-060677	SW 1/4	6	17	25	67	No Till
G-068903	NE 1/4	6	17	26	134.8	No Till
G-042676	SW 1/4	6	17	26	76	No Till
G-026335	SE 1/4	6	17	28	74	No Till
A-005637	lots 9, 10, 15 & 16	6	17	30	37.74	No Till
G-015980	lots S pt of 13 & 14	6	17	30	80	No Till
A-006272	lots 1, 2, 7 & 8	6	17	30	36.75	No Till
G-074132	SE 1/4	6	17	31	160	No Till
G-026426	SE 1/4	6	17	32	140	No Till
G-026159	SE 1/4	6	17	33	155	No Till
G-074644	NE 1/4	6	17	35	77.6	No Till
G-015957	SW 1/4	6	18	1	140	No Till
G-026634	SE 1/4	6	18	2	100	No Till
G-069282	SW 1/4	6	18	3	120	No Till
G-113765	NW 1/4	6	18	3	136	No Till
G-134566	NW of NW 1/4	6	18	6	113.16	No Till
G-133180	NE of SW 1/4	6	18	7	145	No Till
G-133181	NW of SE 1/4	6	18	7	142	No Till
G-131624	SW of NW 1/4	6	18	7	45	No Till
G-135942	SE of SE 1/4	6	18	8	125	No Till
G-023699	NW 1/4	6	18	9	125	No Till
G-133038	NE 1/4	6	18	9	65	No Till
G-129150	NW of NE 1/4	6	18	10	135	No Till
G-130100	NW of SE 1/4	6	18	10	138	No Till
G-008028	NW 1/4	6	18	10	103.2	No Till
G-063234	SW 1/4	6	18	12	135	No Till
G-015956	NW 1/4	6	18	12	120	No Till
G-015125	NE 1/4	6	18	12	133	No Till
G-074662	SE 1/4	6	18	14	105	No Till
G-040036	SW 1/4	6	18	15	145	No Till
G-013612	NW 1/4	6	18	15	150	No Till
G-129356	NE 1/4	6	18	16	78	No Till
G-031315	SE 1/4	6	18	16	131	No Till
G-071933	SW 1/4	6	18	17	145	No Till
G-130635	SE of NE 1/4	6	18	17	67.25	No Till
G-130452	NE of NW 1/4	6	18	17	125	No Till

**Tri-Basin NRD Platte Basin No Till Acres - 2018 Platte Basin Annual Report**  
**Appendix C**

Well Reg	Legal	T Ship	Range	Sect	Irrigated acres	Tillage Practice
G-050203	SE 1/4	6	18	17	12	No Till
G-024607	SE 1/4	6	18	18	130.91	No Till
G-084575	NE 1/4	6	18	18	155	No Till
G-044283	SE 1/4	6	18	20	158	No Till
G-044258	SW 1/4	6	18	20	159	No Till
G-041561	NE 1/4	6	18	20	152	No Till
G-030693	NW 1/4	6	18	20	154	No Till
G-044968	NE 1/4	6	18	21	150	No Till
G-069776	SE 1/4	6	18	21	162	No Till
G-008006	SW 1/4	6	18	21	132	No Till
G-074759	NW 1/4	6	18	21	155	No Till
G-059302	SE of NW	6	18	22	131	No Till
G-045284	SE 1/4	6	18	22	40.9	No Till
G-004679	SW 1/4	6	18	22	70.4	No Till
G-041717	E 1/2 SE 1/4	6	18	23	102	No Till
G-041970	SE 1/4	6	18	24	148	No Till
G-125287	NW	6	18	24	60	No Till
G-025803	SW 1/4	6	18	24	155	No Till
G-028924	SW 1/4	6	18	25	146	No Till
G-028923	SE 1/4	6	18	25	156	No Till
G-024356	NW of SW 1/4	6	18	26	47	No Till
G-029057	NW 1/4	6	18	26	151	No Till
G-008029	SW 1/4	6	18	27	71.5	No Till
G-026280	NW 1/4	6	18	27	136	No Till
G-006859	NE 1/4	6	18	28	144.5	No Till
G-038822	NW 1/4	6	18	29	44	No Till
G-044681	NE 1/4	6	18	30	150	No Till
G-003580	SE 1/4	6	18	30	51	No Till
G-032987	SW 1/4	6	18	30	145	No Till
G-056619	SW 1/4	6	18	31	100	No Till
G-016211	SW 1/4	6	18	31	83	No Till
G-023074	SE 1/4	6	18	31	30	No Till
G-035251	NE 1/4	6	18	31	151.1	No Till
G-028370	SW 1/4	6	18	32	100	No Till
G-030104	SW 1/4	6	18	32	100	No Till
G-026164	NW 1/4	6	18	32	141	No Till
G-001060	NE 1/4	6	18	34	115	No Till
G-050480	NW 1/4	6	18	34	78	No Till
G-121464	SW 1/4	6	18	34	115	No Till
G-026036	NW 1/4	6	18	34	23	No Till
G-039278	NE 1/4	6	18	36	24	No Till
G-075211	NE 1/4	6	19	2	92.2	No Till
G-014651	SW 1/4	6	19	2	150	No Till
G-045549	SE 1/4	6	19	2	140	No Till
G-025849	NW 1/4	6	19	3	150	No Till
G-020857	SW of NW 1/4	6	19	4	180	No Till
G-052272	NE 1/4	6	19	4	290	No Till
G-001169	NE 1/4	6	19	5	149	No Till
G-088498	SW 1/4	6	19	5	130	No Till
G-036171	SE 1/4	6	19	6	148	No Till
G-172798	NE 1/4	6	19	6	65	No Till
G-132512	NE of NE 1/4	6	19	7	130	No Till
G-040343	SW 1/4	6	19	8	132	No Till
G-015120	SE 1/4	6	19	8	133	No Till



**Tri-Basin NRD Platte Basin No Till Acres - 2018 Platte Basin Annual Report**  
**Appendix C**

Well Reg	Legal	T Ship	Range	Sect	Irrigated acres	Tillage Practice
A-005648	NW 1/4	6	19	8	85	No Till
G-044779	NW 1/4	6	19	9	120	No Till
G-025733	NE 1/4	6	19	9	100	No Till
G-087523	SE 1/4	6	19	9	73	No Till
G-060618	SE 1/4	6	19	9	73	No Till
G-036476	SW 1/4	6	19	9	144	No Till
A-005633	SE 1/4	6	19	10	156	No Till
G-042443	SW 1/4	6	19	11	137	No Till
G-126845	NW of SE 1/4	6	19	11	80	No Till
G-025757	NW SW 1/4	6	19	13	52	No Till
G-114016	NE 1/4	6	19	13	150	No Till
G-072918	NW 1/4	6	19	13	146	No Till
G-032835	SE 1/4	6	19	13	268	No Till
G-169498	NE 1/4	6	19	13	38	No Till
G-025244	SE 1/4	6	19	14	141	No Till
G-025815	SW 1/4	6	19	14	155	No Till
G-110559	NE 1/4	6	19	14	143	No Till
G-060288	NW 1/4	6	19	15	135	No Till
G-000854	SW 1/4	6	19	15	144	No Till
G-058068	SE 1/4	6	19	15	155	No Till
G-063149	NE 1/4	6	19	16	135	No Till
G-035917	SE 1/4	6	19	17	135	No Till
G-032462	SW 1/4	6	19	17	13.55	No Till
G-027416	NE 1/4	6	19	17	152	No Till
G-133563	NW of NW 1/4	6	19	18	145	No Till
G-045710	NE 1/4	6	19	18	148	No Till
G-074330	SW 1/4	6	19	19	61	No Till
G-132608	SW of SW 1/4	6	19	21	88	No Till
G-129257	NW of NW 1/4	6	19	21	137	No Till
G-068598	SE 1/4	6	19	22	150	No Till
G-030892	NE 1/4	6	19	22	158	No Till
G-040622	SW 1/4	6	19	22	75	No Till
G-002588	NW 1/4	6	19	22	135	No Till
G-013985	NE 1/4	6	19	23	110	No Till
A-005462	SE 1/4	6	19	23	154	No Till
G-007211	NW 1/4	6	19	23	156	No Till
G-026550	SW 1/4	6	19	23	78.5	No Till
A-006735	W 1/2 SW 1/4	6	19	23	73	No Till
G-031740	NW 1/4	6	19	24	140	No Till
G-025168	SW 1/4	6	19	24	135	No Till
G-071119	NE 1/4	6	19	24	134	No Till
G-009669	NE 1/4	6	19	24	137	No Till
G-053544	NW 1/4	6	19	24	11	No Till
G-073050	SE 1/4	6	19	25	70	No Till
G-039540	SW 1/4	6	19	25	135	No Till
G-049083	NW 1/4	6	19	25	152	No Till
G-048259	NE 1/4	6	19	25	131	No Till
G-030912	SE 1/4	6	19	26	117	No Till
G-073120	SW 1/4	6	19	26	91	No Till
G-094725	NW 1/4	6	19	26	218	No Till
G-026085	SE 1/4	6	19	27	131	No Till
G-074863	SW 1/4	6	19	27	157	No Till
G-127368	SE of NW 1/4	6	19	27	135	No Till
G-129577	SW 1/4	6	19	28	55	No Till

**Tri-Basin NRD Platte Basin No Till Acres - 2018 Platte Basin Annual Report**  
**Appendix C**

Well Reg	Legal	T Ship	Range	Sect	Irrigated acres	Tillage Practice
G-052078	SE 1/4	6	19	28	115	No Till
G-042381	NW 1/4	6	19	28	145	No Till
G-020391	SW 1/4	6	19	29	79	No Till
G-038040	NE 1/4	6	19	29	148	No Till
G-029642	NE 1/4	6	19	30	145	No Till
G-041182	SW 1/4	6	19	30	135	No Till
G-007767	NE of SE	6	19	30	151	No Till
G-052273	SE 1/4	6	19	31	68	No Till
G-035734	SW 1/4	6	19	31	87	No Till
G-073711	NE 1/4	6	19	31	145	No Till
G-025703	SE 1/4	6	19	32	151	No Till
G-066511	SW 1/4	6	19	32	149	No Till
G-034808	NW 1/4	6	19	32	139	No Till
G-025069	NW 1/4	6	19	33	151	No Till
G-013618	SW 1/4	6	19	34	156	No Till
G-032740	SE 1/4	6	19	34	125	No Till
G-027136	NE 1/4	6	19	34	140	No Till
G-030448	NW 1/4	6	19	34	132	No Till
G-062535	NW 1/4	6	19	35	168	No Till
G-110137	SE 1/4	6	19	35	131	No Till
G-026244	NW 1/4	6	19	36	102	No Till
G-051086	SE 1/4	6	19	36	140	No Till
G-024296	NW 1/4	6	19	36	100	No Till
G-101001	NE 1/4	6	19	36	74	No Till
G-045402	NE 1/4	6	20	1	148	No Till
G-060528	SE 1/4	6	20	1	135	No Till
G-045273	SW 1/4	6	20	1	135	No Till
G-001127	NW 1/4	6	20	1	65	No Till
G-167695	SE 1/4	6	20	3	124	No Till
G-072667	SW 1/4	6	20	5	140	No Till
G-133504	NE 1/4	6	20	5	147.9	No Till
G-152707	SE 1/4	6	20	5	76	No Till
G-021172	SE 1/4	6	20	6	97	No Till
G-034558	SE 1/4	6	20	6	85	No Till
G-023738	NW 1/4	6	20	6	75	No Till
G-003127	NE 1/4	6	20	8	79	No Till
A-005229	NE 1/4	6	20	8	39	No Till
G-007505	SE 1/4	6	20	9	130	No Till
G-042269	NE 1/4	6	20	9	144	No Till
G-043366	NW 1/4	6	20	10	83	No Till
G-089768	NE 1/4	6	20	10	128	No Till
G-041487	SE 1/4	6	20	10	136	No Till
G-020401	SW 1/4	6	20	12	156	No Till
G-002626	NW 1/4	6	20	12	151	No Till
G-122126	SW of SE 1/4	6	20	12	142	No Till
G-132340	SE 1/4	6	20	13	135	No Till
G-001680	NW 1/4	6	20	14	59	No Till
G-073772	SE 1/4	6	20	14	108.8	No Till
G-034091	SW 1/4	6	20	14	150	No Till
G-005487	NE 1/4	6	20	21	145	No Till
G-000652	SW 1/4	6	20	22	156	No Till
G-002985	NW 1/4	6	20	22	145	No Till
G-091279	SE 1/4	6	20	22	102	No Till
G-028007	NE 1/4	6	20	22	150	No Till

**Tri-Basin NRD Platte Basin No Till Acres - 2018 Platte Basin Annual Report**  
**Appendix C**

Well Reg	Legal	T Ship	Range	Sect	Irrigated acres	Tillage Practice
G-129049	SW 1/4	6	20	23	78	No Till
G-025593	NW 1/4	6	20	23	63	No Till
G-024728	SE 1/4	6	20	24	130	No Till
G-024524	SW 1/4	6	20	24	68	No Till
G-025986	NE 1/4	6	20	25	150	No Till
G-026281	SW 1/4	6	20	25	62	No Till
G-032795	SE 1/4	6	20	25	112	No Till
G-091179	NW 1/4	6	20	25	135	No Till
G-023483	SW 1/4	6	20	26	93	No Till
G-033793	SW 1/4	6	20	27	38	No Till
G-074785	NW 1/4	6	20	27	157	No Till
G-001239	SW 1/4	6	20	27	178	No Till
G-048537	NE 1/4	6	20	28	146.3	No Till
G-062683	SW 1/4	6	20	29	64	No Till
G-055771	NW 1/4	6	20	35	158	No Till
G-061360	NE 1/4	6	20	36	144	No Till
G-053780	NW 1/4	6	21	1	164	No Till
G-031354	NE 1/4	6	21	1	120	No Till
G-049326	NW 1/4	6	21	2	160	No Till
G-005593	NE 1/4	6	21	2	130	No Till
G-027616	SW 1/4	6	21	3	155.8	No Till
G-033028	SE 1/4	6	21	3	76	No Till
G-004802	NE 1/4	6	21	3	110	No Till
G-056273	NW 1/4	6	21	3	163	No Till
G-061500	SW 1/4	6	21	10	145	No Till
G-052566	NW 1/4	6	21	10	148	No Till
G-013986	SE 1/4	6	21	11	74	No Till
G-050066	NE 1/4	6	21	11	127	No Till
G-027126	NW 1/4	6	21	11	128	No Till
G-063216	NW 1/4	7	17	16	126	No Till
G-034034	NW 1/4	7	17	17	65	No Till
G-060103	NW 1/4	7	17	17	133	No Till
G-034036	NE 1/4	7	17	19	70	No Till
G-037117	SE 1/4	7	17	19	70	No Till
G-147456	NW 1/4 Lots 1 & 2	7	17	19	78	No Till
G-139059	NE 1/4	7	17	19	70	No Till
G-024040	lots 1 & 2	7	17	19	12	No Till
G-028884	SW 1/4	7	17	29	71	No Till
G-046723	lots 1 & 8	7	17	30	63.11	No Till
A-005616	lot 2	7	17	30	7	No Till
G-039976	SE 1/4	7	17	30	132	No Till
G-068764	lots 1, 2, 7 & 8	7	17	31	12	No Till
G-131918	Lot 3	7	17	31	125	No Till
G-147457	NW 1/4	7	17	31	142	No Till
G-061971	SE 1/4	7	17	31	126	No Till
G-021595	NE 1/4	7	17	31	66	No Till
G-030174	SE 1/4	7	17	32	65	No Till
G-071289	NE 1/4	7	18	13	158	No Till
G-046945	SW 1/4	7	18	13	134	No Till
G-077708	NW 1/4	7	18	13	120	No Till
G-059557	NE 1/4	7	18	15	135	No Till
G-057112	SE 1/4	7	18	15	135	No Till
G-068806	NW 1/4	7	18	15	130	No Till
G-137702	NE1/4	7	18	16	110	No Till

**Tri-Basin NRD Platte Basin No Till Acres - 2018 Platte Basin Annual Report**  
**Appendix C**

Well Reg	Legal	T Ship	Range	Sect	Irrigated acres	Tillage Practice
G-129448	NE of NW 1/4	7	18	17	60	No Till
G-129872	NW of NE 1/4	7	18	17	30	No Till
G-041826	SE 1/4	7	18	19	161	No Till
G-149618	SW 1/4	7	18	19	123	No Till
A-005527	SE 1/4	7	18	20	9	No Till
G-130665	SW of SW 1/4	7	18	20	125	No Till
G-037334	NW 1/4	7	18	21	68.5	No Till
G-131463	SE	7	18	21	138	No Till
G-021229	SW 1/4	7	18	22	147.83	No Till
G-056497	NW 1/4	7	18	22	140	No Till
G-022438	NE 1/4	7	18	22	125	No Till
G-038802	SW 1/4	7	18	22	12	No Till
G-061654	SE 1/4	7	18	22	139.1	No Till
G-076064	NE 1/4	7	18	24	143.2	No Till
G-037113	NE 1/4	7	18	24	14.4	No Till
G-037114	SE 1/4	7	18	24	161	No Till
G-012216	NE 1/4	7	18	25	62	No Till
G-074452	SW 1/4	7	18	25	14	No Till
G-010388	NE NE 1/4	7	18	25	65	No Till
G-131774	NE of SW 1/4	7	18	25	106	No Till
G-020927	NW 1/4	7	18	25	109	No Till
G-074282	NW 1/4	7	18	25	160	No Till
G-022950	SW 1/4	7	18	26	73	No Till
G-040651	NE 1/4	7	18	26	103.83	No Till
G-028701	SE 1/4	7	18	26	75	No Till
G-040650	SE 1/4	7	18	27	125	No Till
G-014652	NW 1/4	7	18	27	150	No Till
A-005544	NW 1/4	7	18	28	135	No Till
G-020280	SW 1/4	7	18	28	140	No Till
G-002216	NE 1/4	7	18	28	128	No Till
G-127904	NE of NW 1/4	7	18	29	140	No Till
G-063177	SW 1/4	7	18	29	76	No Till
G-063158	SE 1/4	7	18	30	156	No Till
G-063233	SE 1/4	7	18	31	4	No Till
G-075182	NE 1/4	7	18	31	140	No Till
G-132769	NW of SW 1/4	7	18	32	65	No Till
G-063159	NW 1/4	7	18	32	67.5	No Till
G-063178	NE 1/4	7	18	32	67	No Till
G-093751	SE 1/4	7	18	34	135	No Till
G-039497	NE 1/4	7	18	34	150	No Till
G-003050	SE 1/4	7	18	34	12	No Till
G-139527	NW1/4	7	18	35	80	No Till
G-018622	NE 1/4	7	18	35	7	No Till
G-028077	NW 1/4	7	18	36	155	No Till
G-071511	NE 1/4	7	18	36	67	No Till
G-135170	S1/2 NE 1/4	7	19	13	51	No Till
G-138416	NW 1/4	7	19	13	120	No Till
G-129696	NW 1/4	7	19	14	125	No Till
G-005202	NW 1/4	7	19	15	60	No Till
G-034763	SE 1/4	7	19	16	143.5	No Till
G-007043	NW 1/4	7	19	16	150	No Till
G-014735	NW 1/4	7	19	17	73	No Till
G-009427	NW 1/4	7	19	18	148	No Till
G-126121	SE1/4	7	19	18	130	No Till

**Tri-Basin NRD Platte Basin No Till Acres - 2018 Platte Basin Annual Report**  
**Appendix C**

Well Reg	Legal	T Ship	Range	Sect	Irrigated acres	Tillage Practice
G-074549	NE 1/4	7	19	20	134	No Till
G-032611	SE 1/4	7	19	20	152	No Till
G-013807	NE 1/4	7	19	21	96	No Till
G-038793	NW 1/4	7	19	21	74	No Till
G-025307	SE 1/4	7	19	21	113	No Till
G-121515	NW of SE 1/4	7	19	21	67	No Till
G-020681	SW 1/4	7	19	21	155	No Till
G-033171	SW 1/4	7	19	22	120	No Till
G-045570	NE NE 1/4	7	19	22	130	No Till
G-130799	NE of SE 1/4	7	19	23	130	No Till
G-171471	NW 1/4	7	19	23	65	No Till
G-132613	SE 1/4	7	19	24	125	No Till
G-071266	NW 1/4	7	19	24	75	No Till
G-132645	SW 1/4	7	19	25	75	No Till
G-019600	NE 1/4	7	19	26	78	No Till
G-025252	SE 1/4	7	19	26	7	No Till
G-038816	SE 1/4	7	19	26	75	No Till
G-000317	NE 1/4	7	19	27	67	No Till
G-023819	SW 1/4	7	19	27	130	No Till
G-074261	NW 1/4	7	19	27	133	No Till
A-007095	SE 1/4	7	19	28	132	No Till
G-135944	NE of SW 1/4	7	19	29	151	No Till
G-000746	NE 1/4	7	19	29	154	No Till
G-031736	SE 1/4	7	19	30	142	No Till
G-172337	NE 1/4	7	19	30		No Till
G-012652	SE 1/4	7	19	31	156	No Till
G-168005	NE 1/4	7	19	31	83	No Till
G-014117	NE 1/4	7	19	31	57	No Till
G-022245	NW 1/4	7	19	32	150	No Till
G-023124	SW 1/4	7	19	32	139	No Till
G-001460	SE 1/4	7	19	33	120	No Till
G-064984	NE 1/4	7	19	34	135	No Till
G-066270	NW 1/4	7	19	34	130	No Till
G-032770	SW SW 1/4	7	19	35	122	No Till
G-127891	NW of SE 1/4	7	19	36	12	No Till
G-119660	NE 1/4	7	19	36	88	No Till
G-151663	SW 1/4	7	19	36	62	No Till
G-065049	NW 1/4	7	19	36	135	No Till
G-006383	NW 1/4	7	20	14	140	No Till
G-023572	NE 1/4	7	20	15	6.36	No Till
G-119178	NW 1/4	7	20	16	142	No Till
G-028109	SW 1/4	7	20	17	118	No Till
G-132790	NW of SE 1/4	7	20	17	99	No Till
G-023844	NW 1/4	7	20	18	80	No Till
G-012647	SW 1/4	7	20	18	25	No Till
G-133370	SW of SW 1/4	7	20	19	136	No Till
G-175946	SW 1/4	7	20	23	113.65	No Till
G-027543	NE 1/4	7	20	25	145	No Till
G-130108	SE of SW 1/4	7	20	25	7	No Till
G-044047	NW 1/4	7	20	26	149	No Till
G-042184	NW SE 1/4	7	20	26	152	No Till
G-033288	NE 1/4	7	20	26	75	No Till
G-037042	SE 1/4	7	20	27	113	No Till
G-135517	SE of NE 1/4	7	20	31	153	No Till

**Tri-Basin NRD Platte Basin No Till Acres - 2018 Platte Basin Annual Report**  
**Appendix C**

Well Reg	Legal	T Ship	Range	Sect	Irrigated acres	Tillage Practice
A-005605	SW 1/4	7	20	31	41	No Till
G-069253	SE 1/4	7	20	31	210	No Till
G-135518	NW of SW 1/4	7	20	32	107	No Till
G-087415	NE 1/4	7	20	33	156	No Till
G-037542	SW 1/4	7	20	34	164	No Till
G-039565	SE 1/4	7	20	36	140	No Till
G-129992	NE of NE 1/4	7	20	36	134	No Till
G-088406	SW 1/4	7	21	14	121	No Till
G-131440	NE 1/4	7	21	15	3	No Till
G-167700	SE	7	21	15	130	No Till
G-134206	NW of SW 1/4	7	21	24	3	No Till
G-132819	SE of NW 1/4	7	21	24	132	No Till
G-128994	SE 1/4	7	21	26	24	No Till
G-036387	NW 1/4	7	21	27	81	No Till
G-039594	SE 1/4	7	21	27	158	No Till
G-089871	NW 1/4	7	21	27	30	No Till
G-045821	NE 1/4	7	21	34	76	No Till
G-021159	SE 1/4	7	21	34	142	No Till
G-027227	NW 1/4	7	21	34	55	No Till
G-009227	SW 1/4	7	21	34	62	No Till
G-019861	NE 1/4	8	13	10	20	No Till
G-008209	SE 1/4	8	13	10	24	No Till
G-008211	SE 1/4	8	13	10	28	No Till
G-080421	SE 1/4	8	13	10	147	No Till
G-039518	NE 1/4	8	13	11	138	No Till
G-015972	SE 1/4	8	13	13	72	No Till
G-006536	NW 1/4	8	13	14	90	No Till
G-034783	NE 1/4	8	13	15	14	No Till
G-015330	NE 1/4	8	13	15	125	No Till
G-052873	SE 1/4	8	13	16	134	No Till
A-005964B	NE 1/4	8	13	16	116	No Till
G-010285	NW 1/4	8	13	17	131	No Till
G-060270	SE 1/4	8	13	17	70	No Till
G-040084	SE 1/4	8	13	21	132	No Till
G-042426	NE 1/4	8	13	21	149.37	No Till
G-012428	NW 1/4	8	13	22	127	No Till
G-053462	SW 1/4	8	13	22	132	No Till
G-063600	SE 1/4	8	13	23	133	No Till
G-067372	NE 1/4	8	13	23	133	No Till
G-064757	SW 1/4	8	13	23	131	No Till
G-067373	NW of NW 1/4	8	13	23	130	No Till
G-043853	NE 1/4	8	13	24	127	No Till
G-007079	NE 1/4	8	14	23	18	No Till
G-018674	NW 1/4	8	14	24	90	No Till
G-018673	NW 1/4	8	14	24	11	No Till
G-038170	NW 1/4	8	14	25	133.6	No Till
G-044832	SE 1/4	8	14	27	133	No Till
G-059826	SE 1/4	8	15	32	132	No Till
G-053686	NW 1/4	8	15	34	150	No Till
G-048684	NE 1/4	8	15	34	150	No Till
G-044831	NW 1/4	8	15	35	128	No Till
G-167416	NW of SW 1/4	8	16	22	77.1	No Till
G-034320	SE 1/4	8	16	30	130	No Till
G-034321	SW 1/4	8	16	30	126	No Till

**Tri-Basin NRD Platte Basin No Till Acres - 2018 Platte Basin Annual Report  
Appendix C**

<b>Well Reg</b>	<b>Legal</b>	<b>T Ship</b>	<b>Range</b>	<b>Sect</b>	<b>Irrigated acres</b>	<b>Tillage Practice</b>
G-067833	SE 1/4	8	16	35	132	No Till
G-067832	SW 1/4	8	16	35	132	No Till
G-140497	SW 1/4	8	17	17	44	No Till
G-015907	SE 1/4	8	17	17	45	No Till
G-024429	SW 1/4	8	17	17	52	No Till
G-041383	SE 1/4	8	17	17	40	No Till
G-027841	lot 9	8	17	18	101	No Till
G-065342	lot 10	8	17	18	53	No Till
G-104054	pt of lots 2, 3, 4, 5, 6 & 7	8	17	18	110	No Till
G-104055	lot pts2, 7 & all 8	8	17	18	70	No Till
G-027593	N2 SE 1/4	8	17	19	74	No Till
G-034898	lots 9, 10, 15 & 16	8	17	19	149	No Till
G-090860	S2 of SE 1/4	8	17	19	58	No Till
G-090861	lots 11, 12, 13 & 14	8	17	19	133	No Till
G-041384	NE 1/4	8	17	20	77	No Till
G-048556	SW 1/4	8	17	20	150	No Till
G-034095	NE 1/4	8	17	23	77	No Till
G-034096	NE 1/4	8	17	23	77	No Till
G-121369	Cent of SE 1/4	8	17	23	152	No Till
G-072631	NW 1/4	8	17	23	77	No Till
G-049239	NW 1/4	8	17	25	153	No Till
G-049240	SW 1/4	8	17	25	133	No Till
G-063556	NW 1/4	8	17	26	136	No Till
G-108717	SE 1/4	8	17	26	136	No Till
G-090906	SW 1/4	8	17	26	136	No Till
G-061318	NE 1/4	8	17	26	136	No Till
G-042999	NE 1/4	8	17	29	130	No Till
G-060896	SE 1/4	8	17	29	130	No Till
G-060937	NW 1/4	8	17	29	130	No Till
G-064839	SW 1/4	8	17	29	130	No Till
G-088499	NE 1/4	8	17	33	130	No Till
G-088500	SE 1/4	8	17	33	130	No Till
G-047120	SW 1/4	8	17	34	135	No Till
G-055521	NW 1/4	8	17	34	136.9	No Till
G-063815	NE 1/4	8	17	35	133	No Till
G-062791	SE 1/4	8	17	35	133	No Till
G-069018	SW 1/4	8	17	35	133	No Till
G-069017	NW 1/4	8	17	35	133	No Till
G-048991	NW 1/4	8	17	36	130	No Till
G-063395	NE 1/4	8	17	36	130	No Till
G-137937	SW 1/4	8	17	36	130	No Till
G-060781	SW 1/4	8	18	13	120	No Till
G-001168A	NE 1/4	8	18	14	35	No Till
G-015772	SW 1/4	8	18	16	100	No Till
G-028377	SW 1/4	8	18	16	16	No Till
G-008007	NW 1/4	8	18	21	130	No Till
G-052500	NW 1/4	8	18	23	130	No Till
G-002623	NW 1/4	8	18	24	76	No Till
G-068036	Cent of NE 1/4	8	18	25	130	No Till
G-058321	SW 1/4	8	18	26	70	No Till
G-067875	NW 1/4	8	18	27	130	No Till

**CNPPID Groundwater Recharge Diversions Summary - 2018 Platte Basin Annual Report  
Appendix D**

2006			
Dates of Recharge Diversion	1/24/06 to 2/13/06	8/8/06 to 2 /13/06	12/22/06 to 12/31/06
<b>Elwood Reservoir Diversions</b>			
AF, in			
\$/af			
\$/other			
Notes	gravity, Appears to be no charges	gravity, Appears to be no charges	gravity, JO costs, NGPC was billed for 50% of the JO costs
<b>Elwood Releases</b>			
AF, in			
\$/af			
\$/other			
Notes			
<b>E65 Canal</b>			
AF, in			
\$/af			
\$/other			
Notes			
<b>Phelps Canal</b>			
AF, in			
\$/af			
\$/other			
Notes			
<b>Funk Lagoon</b>			
AF, in			
\$/af			
Notes			
<b>Funds</b>			
Total \$	N/A	N/A	\$16,752.44
PRRIP			
NDNR			
TBNRD			
NGPC			\$16,752.44



**CNPPID Groundwater Recharge Diversions Summary - 2018 Platte Basin Annual Report  
Appendix D**

2007			
Dates of Recharge Diversion	5/30/07 to 6/25/07	7/9/07 to 7/11/07	7/31/07 to 8/8/07
<b>Elwood Reservoir Diversions</b>			
AF, in			
\$/af			
\$/other			
Notes	gravity, JO costs	gravity, Not billed	gravity, JO Costs
<b>Elwood Releases</b>			
AF, in			
\$/af			
\$/other			
Notes			
<b>E65 Canal</b>			
AF, in			
\$/af			
\$/other			
Notes			
<b>Phelps Canal</b>			
AF, in			
\$/af			
\$/other			
Notes			
<b>Funk Lagoon</b>			
AF, in			
\$/af			
Notes			
<b>Funds</b>			
Total \$	\$57,819.51	N/A	\$17,686.39
PRRIP			
NDNR			
TBNRD			
NGPC	\$57,819.51		\$17,686.39

**CNPPID Groundwater Recharge Diversions Summary - 2018 Platte Basin Annual Report  
Appendix D**

<b>2008-2009</b>				
<b>Dates of Recharge Diversion</b>	5/23/08 to 6/11/08	7/18/08 to 7/21/08	8/10/08 to 8/19/08	6/21/09 to 8/21/09
<b>Elwood Reservoir Diversions</b>				
AF, in				
\$/af				
\$/other				
Notes	4240 af gravity, 2543 pumped, \$ pump & hydro	pumped, \$pump & hydro	gravity, \$ for hydro offset	diversions stopped once irrigation decision was made
<b>Elwood Releases</b>				
AF, in				
\$/af				
\$/other				
Notes				
<b>E65 Canal</b>				
AF, in				
\$/af				
\$/other				
Notes				
<b>Phelps Canal</b>				
AF, in				
\$/af				
\$/other				
Notes				
<b>Funk Lagoon</b>				
AF, in				
\$/af				
Notes				
<b>Funds</b>				
Total \$	\$66,568.32	\$12,878.02	\$10,498.40	\$25,572.80
PRRIP				
NDNR				
TBNRD	\$33,284.16	\$6,439.01	\$5,249.20	\$12,786.40
NGPC	\$33,284.16	\$6,439.01	\$5,249.20	\$12,786.40

**CNPPID Groundwater Recharge Diversions Summary - 2018 Platte Basin Annual Report  
Appendix D**

<b>2012-2013</b>								
<b>Dates of Recharge Diversion</b>	9/28/11 to 1/5/12	12/4/12 to 3/11/13	9/19/13 to 10/31/13					
<b>Elwood Reservoir Diversions</b>								
AF, in			12385					
\$/af			35					
\$/other								
Notes			Pumped					
<b>Elwood Releases</b>								
AF, in								
\$/af								
\$/other								
Notes								
<b>E65 Canal</b>								
AF, in				2615				
\$/af				35				
\$/other								
Notes				Canal to NP 23.7-3.2, Cottonwood WPA, and 36.2S				
<b>Phelps Canal</b>								
AF, in						3890	2000	3897
\$/af						25	25	NA
\$/other								
Notes						down to MP 13.3	Funk Lagoon	Phelps below 13.3 to 51.1 plus 19.1, 38.6. No payment for these diversions.
<b>Funk Lagoon</b>								
AF, in								
\$/af								
Notes								
<b>Funds</b>								
Total \$	\$138,954.00	\$102,200.00	\$433,475.00	\$91,525.00	\$97,250.00	\$50,000.00	NA	
PRRIP	\$69,477.00	\$102,200.00			\$48,625.00	\$50,000.00		
NDNR	\$41,686.20		\$260,085.00	\$54,915.00	\$29,175.00			
TBNRD	\$27,790.80		\$173,390.00	\$36,610.00	\$19,450.00			
NGPC								

**CNPPID Groundwater Recharge Diversions Summary - 2018 Platte Basin Annual Report  
Appendix D**

2014 Dates of Recharge Diversion	6/10/14 to 7/7/14	11/26/14 to 11/30/14			12/9/14 to 12/27/14		11/26/14 to 12/31/14
<b>Elwood Reservoir Diversions</b>							
AF, in	13237	1763	37		8309.2		
\$/af	39	39	NA		41		
\$/other							
Notes	Pumped, 15,000 af contract with amendment	Pumped, finished con- tract 11-26 to 11-30	Not billed but pumped into Elwood		Pumped, 5000 af contract + 5000 af am- endment		
<b>Elwood Releases</b>							
AF, in							
\$/af							
\$/other							
Notes							
<b>E65 Canal</b>							
AF, in				70		567.1	
\$/af				NA		38	
\$/other							
Notes				Not billed, part of Elwood filling, down to MP 5.9		down to MP 20.1	
<b>Phelps Canal</b>							
AF, in							2346
\$/af							27
\$/other							
Notes							down to MP 13.3
<b>Funk Lagoon</b>							
AF, in							
\$/af							
Notes							
<b>Funds</b>							
Total \$	\$516,243.00	\$68,757.00	NA	NA	\$340,677.20	\$21,549.80	\$63,339.30
PRRIP							\$31,669.65
NDNR	\$258,121.50	\$34,378.50			\$170,338.60	\$10,774.90	\$31,669.65
TBNRD	\$258,121.50	\$34,378.50			\$170,338.60	\$10,774.90	
NGPC							

**CNPPID Groundwater Recharge Diversions Summary - 2018 Platte Basin Annual Report  
Appendix D**

2015 (cont. on 46) Dates of Recharge Diversion	1/1/15 to 2/14/15		1/14/15 to 1/21/15		5/11/15 to 8/24/15		
<b>Elwood Reservoir Diversions</b>							
AF, in			1028.8		6800		9007
\$/af			42.6		42.6		42.6
\$/other							
Notes			Finished out 10,000 af contract, pumped		For NDNR/TBNRD, finished out Amendments No 1 thru No 4 (Total 17,000 AF)		For PRRIP
<b>Elwood Releases</b>							
AF, in							
\$/af							
\$/other							
Notes							
<b>E65 Canal</b>							
AF, in				94.9	200		
\$/af				39.5	39.5		
\$/other							
Notes				in Canal to MP 5.9	Into Cottonwood WPA, part of Amendment No 1		
<b>Phelps Canal</b>							
AF, in	1654	543.7					
\$/af	28.1	28.1					
\$/other							
Notes	down to MP 13.3, up to 4000 af, then PRRIP to get 100%	down to MP 13.3, PRRIP only					
<b>Funk Lagoon</b>							
AF, in							
\$/af							
Notes							
Total \$	\$46,447.13	\$15,267.10	\$43,868.03	\$3,750	\$289,952.00	\$7,904.00	\$384,058.48
PRRIP	\$23,223.56	\$15,267.10					\$384,058.48
NDNR	\$23,223.56		\$21,934.02	\$1,875.22	\$144,976.00	\$3,950.00	
TBNRD			\$21,934.02	\$1,875.22	\$144,976.00	\$3,950.00	
NGPC							

**CNPPID Groundwater Recharge Diversions Summary - 2018 Platte Basin Annual Report  
Appendix D**

<b>2015 (cont.) Dates of Recharge Diversion</b>	11/23/15 to 12/18/15			11/16/15 to 12/31/15		12/19/15 to 2/1/16
<b>Elwood Reservoir Diversions</b>						
AF, in	3227			5776		
\$/af	42.6			42.6		
\$/other						
Notes	For NDNR/ TBNRD, 11-16- 15 Agreement for 4500 af total Canal and Elwood			For PRRIP, May 2015 Agree- ment and Amendment No 1		
<b>Elwood Releases</b>						
AF, in						1119
\$/af						
\$/other						
Notes						Released from Elwood to E65 Canal. Sub- tracted from NDNR/State Elwood Acct for recharge in E65 Canal, No charge in the contract
<b>E65 Canal</b>						
AF, in					1273	
\$/af					39.5	
\$/other						
Notes					For NDNR/ TBNRD, 11-16 -15 Agree- ment for 4500 af total Canal and Elwood, down to MP 20.1	
<b>Phelps Canal</b>						
AF, in				747.5	2243	
\$/af				28.1	28.1	
\$/other						
Notes				down to MP 13.3, 25% of diversions for NDNR, 11-18- 15 Agreement	down to MP 13.3, 75% of diversions for PRRIP, 11-26- 14 Agreement	
<b>Funk Lagoon</b>						
AF, in						
\$/af						
Notes						
<b>Funds</b>						
Total \$	\$137,599.28	\$50,308.96	\$246,288.64	\$20,989.80	\$62,969.40	NA
PRRIP			\$246,288.64		\$62,969.40	
NDNR	\$68,799.64	\$25,154.48		\$20,989.80		
TBNRD	\$68,799.64	\$25,154.48				
NGPC						

**CNPPID Groundwater Recharge Diversions Summary - 2018 Platte Basin Annual Report  
Appendix D**

<b>2016 (Cont. on pg. 48) Dates of Recharge Diversion</b>	<b>1/1/16 to 2/14/16</b>		<b>3/16/16 to 4/13/16</b>		<b>3/16/16 to 3/20/16</b>		<b>9/15/16 to 12/31/16</b>	
<b>Elwood Reservoir Diversions</b>								
AF, in								
\$/af								
\$/other								
Notes								
<b>Elwood Releases</b>								
AF, in								
\$/af								
\$/other								
Notes								
<b>E65 Canal</b>								
AF, in			500	28				
\$/af			41.1					
\$/other								
Notes			Fullfills 3-17-16 agreement (ammendment NO.1), down to MP 20.1	Not Billed, excess diversion as part of 500 af agreement				
<b>Phelps Canal</b>								
AF, in	489.25	1467.75	157.5	472.5			1080.5	3241.4
\$/af	29.2	29.2	29.2	29.2			29.2	29.2
\$/other								
Notes	down to MP 13.3, 25% of diversions for NDNR, 11-18-15 Agreement	down to MP 13.3, 75% of diversions for PRRIP, 12-11-15 Agreement	down to MP 13.3, 25% of diversions for NDNR, 11-18-15 Agreement	down to MP 13.3, 75% of diversions for PRRIP, 12-11-15 Agreement			down to MP 13.3, 25% of diversions for NDNR, 9-20-2016 Agreement	down to MP 13.3, 75% of diversions for PRRIP, 9-26-2016 Agreement
<b>Funk Lagoon</b>								
AF, in								
\$/af								
Notes								
<b>Funds</b>								
Total \$	\$14,286.10	\$42,858.30	\$4,599.00	\$13,797.00	\$20,550.00	NA	\$31,550.60	\$94,648.88
PRRIP		\$42,858.30		\$13,797.00				\$94,648.88
NDNR	\$14,286.10		\$4,599.00		\$10,275.00		\$31,550.60	
TBNRD					\$10,275.00			
NGPC								

**CNPPID Groundwater Recharge Diversions Summary - 2018 Platte Basin Annual Report  
Appendix D**

2016 (Cont.) Dates of Recharge Diversion	12/10/16 to 12/31/16			12/9/16 to 12/31/16	
<b>Elwood Reservoir Diversions</b>					
AF, in	1152	2880	1728		
\$/af	44.4	44.4	44.4		
\$/other					
Notes	For TBNRD, 12-7-2016 Agreement with \$127,036 limit for TBNRD and 60% NDNR/40% TBNRD split	For TBNRD, 12-7-2016 Agreement with \$127,036 limit for TBNRD and 60% NDNR/40% TBNRD split	For NDNR, 12-7-2016 Agreement with \$190,554 limit for NDNR and 60% NDNR/40% TBNRD split		
<b>Elwood Releases</b>					
AF, in					
\$/af					
\$/other					
Notes					
<b>E65 Canal</b>					
AF, in				335.9	503.8
\$/af				41.1	41.1
\$/other					
Notes				For TBNRD, 12-7-2016 Agreement with \$127,036 limit for TBNRD and 60% NDNR/40% TBNRD split, Water down to MP 19.3	For NDNR, 12-7-2016 Agreement with \$190,554 limit for NDNR and 60% NDNR/40% TBNRD split, Water down to MP 19.3
<b>Phelps Canal</b>					
AF, in					
\$/af					
\$/other					
Notes					
<b>Funk Lagoon</b>					
AF, in					
\$/af					
Notes					
<b>Funds</b>					
Total \$	\$51,091.20	\$127,728.00	\$76,636.80	\$13,805.49	\$20,706.18
PRRIP		\$127,728.00			
NDNR			\$76,636.80		\$20,706.18
TBNRD	\$51,091.20			\$13,805.49	
NGPC					



**CNPPID Groundwater Recharge Diversions Summary - 2018 Platte Basin Annual Report  
Appendix D**

2017 (Cont. on pg. 50) Dates of Recharge Diversion	1/1/17 to 1/30/17		1/1/17 to 1/31/17	1/1/17 to 2/14/17		1/1/17 to 2/14/17	1/1/17 to 2/14/17	9/15/17 to 10/12/17	
<b>Elwood Reservoir Diversions</b>									
AF, in	1631.6	2447.4							
\$/af	45.7	45.7							
\$/other									
Notes	For TBNRD, 1-23-17 Amendment for \$164,800	For NDNR, 1-23-17 Amendment for \$247,200 limit.							
<b>Elwood Releases</b>									
AF, in									
\$/af									
\$/other									
Notes									
<b>E65 Canal</b>									
AF, in				599.4	899.1				
\$/af				42.3	42.3				
\$/other									
Notes				For TBNRD, 1-23-17 Amendment for \$164,800 limit. Water to MP 19.3	For NDNR, 1-23-17 Amendment for \$247,200 limit. Water to MP 19.3				
<b>Phelps Canal</b>									
AF, in						338.50	1015.40	1353.50	451.20
\$/af						30.1	30.1	30.1	30.1
\$/other									
Notes						down to MP 13.3, 25% of diversions for NDNR, 9-20-2016 Agreement, 2,666 af limit	down to MP 13.3, 75% of diversions for PRRIP, 9-26-2016 Agreement, 8,000 af limit	down to MP 13.3, 75% of diversions for PRRIP, 10-20-17 Agreement	down to MP 13.3, 25% of diversions for NDNR, 9-20-2016 Agreement, 2,666 af limit
<b>Funk Lagoon</b>									
AF, in									
\$/af									
Notes									
<b>Funds</b>									
Total \$	\$74,531.49	\$111,797.23	\$208,789.58	\$25,372.60	\$38,058.90	\$10,182.08	\$30,543.23	\$40,713.28	\$13,572.10
PRRIP			\$208,789.58				\$30,543.23	\$40,713.28	
NDNR		\$111,797.23			\$38,058.90	\$10,182.08			\$13,572.10
TBNRD	\$74,531.49			\$25,372.60					
NGPC									

**CNPPID Groundwater Recharge Diversions Summary - 2018 Platte Basin Annual Report  
Appendix D**

2017 (Cont.) Dates of Recharge Diversion	11/28/17 to 12/22/17	12/15/17 to 12/22/17				12/1/17 to 12/31/17	
<b>Elwood Reservoir Diversions</b>							
AF, in	6953.6	657.5	986.3				
\$/af	45.7	50.7	50.7				
\$/other							
Notes	For PRRIP, 10-20-17 Agreement, 8,000 af limit, All diversion to PRRIP until 12-15-17 when NDNR/TBNRD signed agreement, then 50%/50% split with them	For TBNRD, 12-15-17 Agreement, 50/50 split with PRRIP and then 40% of that split to TBNRD, 13,500 af limit for State and TBNRD combined	For NDNR, 12-15-17 Agreement, 50/50 split with PRRIP and then 60% of that split to State, 13,500 af limit for State and TBNRD combined				
<b>Elwood Releases</b>							
AF, in							
\$/af							
\$/other							
Notes							
<b>E65 Canal</b>							
AF, in				66.6	100		
\$/af				42.3	42.3		
\$/other							
Notes				For TBNRD, 12-15-17 Agreement, Contract No. 1024, 40% split to TBNRD, 60% to NDNR, 13,500 af limit for State and TBNRD combined	For NDNR, 12-15-17 Agreement, Contract No. 1024, 60% of that split to NDNR, 40% split to TBNRD, 13,500 af limit for State and TBNRD combined		
<b>Phelps Canal</b>							
AF, in						1317.70	439.20
\$/af						30.1	30.1
\$/other							
Notes						down to MP 13.3, 75% of diversions for PRRIP, 10-20-17 Agreement	down to MP 13.3, 25% of diversions for NDNR, 9-20-2016 Agreement, 2,666 af limit
<b>Funk Lagoon</b>							
AF, in							
\$/af							
Notes							
<b>Funds</b>							
Total \$	\$317,640.45	\$33,322.10	\$49,985.68	\$2,819.18	\$4,233.00	\$39,636.42	\$13,211.14
PRRIP	\$317,640.45					\$39,636.42	
NDNR			\$49,985.68		\$4,233.00		\$13,211.14
TBNRD		\$33,322.10		\$2,819.18			
NGPC							

**CNPPID Groundwater Recharge Diversions Summary - 2018 Platte Basin Annual Report  
Appendix D**

2018 (Cont. on pg. 52) Dates of Recharge Diversion	1/3/18 to 3/22/18		1/5/18 to 2/8/18			1/1/18 to 2/12/18
<b>Elwood Reservoir Diversions</b>						
AF, in			3854.9	1542	2313	
\$/af			47.1	52.2	52.2	
\$/other						
Notes			For PRRIP, 10-20-17 Agreement, 8,000 af limit, 1-8-18 Amendment took limit to 12,000 af, 50%/50% split with NDNR/TBNRD	For TBNRD, 12-15-17 Agreement, 50/50 split with PRRIP and then 40% of that split to TBNRD, 13,500 af limit and/or \$362,948 limit for State and TBNRD combined	For NDNR, 12-15-17 Agreement, 50/50 split with PRRIP and then 60% of that split to State, 13,500 af limit and/or \$362,948 limit for State and TBNRD combined	
<b>Elwood Releases</b>						
AF, in						
\$/af						
\$/other						
Notes						
<b>E65 Canal</b>						
AF, in	360.5	540.8				
\$/af	43.6	43.6				
\$/other						
Notes	For TBNRD, 12-15-17 Agreement, Contract No. 1024, 40% split to TBNRD, 60% to NDNR, 13,500 af limit for State and TBNRD combined. Diversions down to MP 19.3	For NDNR, 12-15-17 Agreement, Contract No. 1024, 60% of that split to NDNR, 40% split to TBNRD, 13,500 af limit for State and TBNRD combined. Diversions down to MP 19.3				
<b>Phelps Canal</b>						
AF, in						1066.00
\$/af						31
\$/other						
Notes						10-20-17 Agreement. No agreement with NDNR. PRRIP got all diversions. Diversions down to MP 13.3. <b>NOTE: Total diversions were reduced by 200 af for water left in the Phelps Canal at the start of irrigation season.</b>
<b>Funk Lagoon</b>						
AF, in						
\$/af						
Notes						
<b>Funds</b>						
Total \$	\$15,717.80	\$23,578.88	\$181,373.05	\$80,492.40	\$120,738.60	\$33,024.68
PRRIP			\$181,373.05			\$33,024.68
NDNR		\$23,578.88			\$120,738.60	
TBNRD	\$15,717.80			\$80,492.40		
NGPC						

**CNPPID Groundwater Recharge Diversions Summary - 2018 Platte Basin Annual Report  
Appendix D**

<b>2018 (Cont.) Dates of Recharge Diversion</b>	<b>11/19/18 to 12/31/18</b>	<b>11/21/18 to 12/20/18</b>	<b>11/22/18 to 12/20/18</b>	<b>12/3/18 to 12/31/18</b>		
<b>Elwood Reservoir Di- versions</b>						
AF, in				11061		
\$/af				47.1		
\$/other						
Notes				11-26-18 SWA Ammendment No. 2, took limit to 30,000 af. All for PRRIP. NDNR and TBNRD wanted the remainder of their contract in E65 Canal		
<b>Elwood Releases</b>						
AF, in						
\$/af						
\$/other						
Notes						
<b>E65 Canal</b>						
AF, in					196.8	295.1
\$/af					43.6	43.6
\$/other						
Notes					Contract 1024, for TBNRD, down to MP 19.3	Contract 1024, for NDNR, down to MP 19.3
<b>Phelps Canal</b>						
AF, in	2191.80	1001.00				
\$/af	31	31				
\$/other						
Notes	10-27-19 WSA w/ PRRIP, Diversions down to MP 13.3	11-15-17 WPA WSA with TBNRD, from MP 13.3 to MP 34.2.				
<b>Funk Lagoon</b>						
AF, in			1952.4			
\$/af			25.5			
Notes			11-15-17 WPA WSA with TBNRD, Delivery to Funk Lagoon			
<b>Funds</b>						
Total \$	\$67,901.96	\$31,010.98	\$49,786.20	\$520,401.23	\$8,580.48	\$12,866.36
PRRIP	\$67,901.96			\$520,401.23		
NDNR						\$12,866.36
TBNRD		\$31,010.98	\$49,786.20		\$8,580.48	
NGPC						

**CNPPID Groundwater Recharge Diversions Summary - 2018 Platte Basin Annual Report  
Appendix D**

Dates of Recharge Diversion	1/1/19 to 1/24/19	1/1/19 to 1/28/19	1/1/19 to 1/31/19	
<b>Elwood Reservoir Diversions</b>				
AF, in				
\$/af				
\$/other				
Notes				
<b>Elwood Releases</b>				
AF, in				
\$/af				
\$/other				
Notes				
<b>E65 Canal</b>				
AF, in			297	445.5
\$/af			44.9	44.9
\$/other				
Notes			Contract 1024 w/ 1-7-19 Amendment, for TBNRD, down to MP 19.3	Contract 1024 w/ 1-7-19 Amendment, for NDNR, down to MP 19.3
<b>Phelps Canal</b>				
AF, in	712.1			
\$/af	31.9			
\$/other				
Notes	10-27-19 WSA w/ PRRIP, Diversions down to MP 13.3			
<b>Funk Lagoon</b>				
AF, in				
\$/af				
Notes				
<b>Funds</b>				
Total \$	\$22,723.11	\$347,879.80	\$13,338.27	\$20,007.41
PRRIP	\$22,723.11	\$347,879.80		
NDNR				\$20,007.41
TBNRD			\$13,338.27	
NGPC				

# Phelps Canal Recharge Map - 2018 Platte Basin Annual Report Appendix D

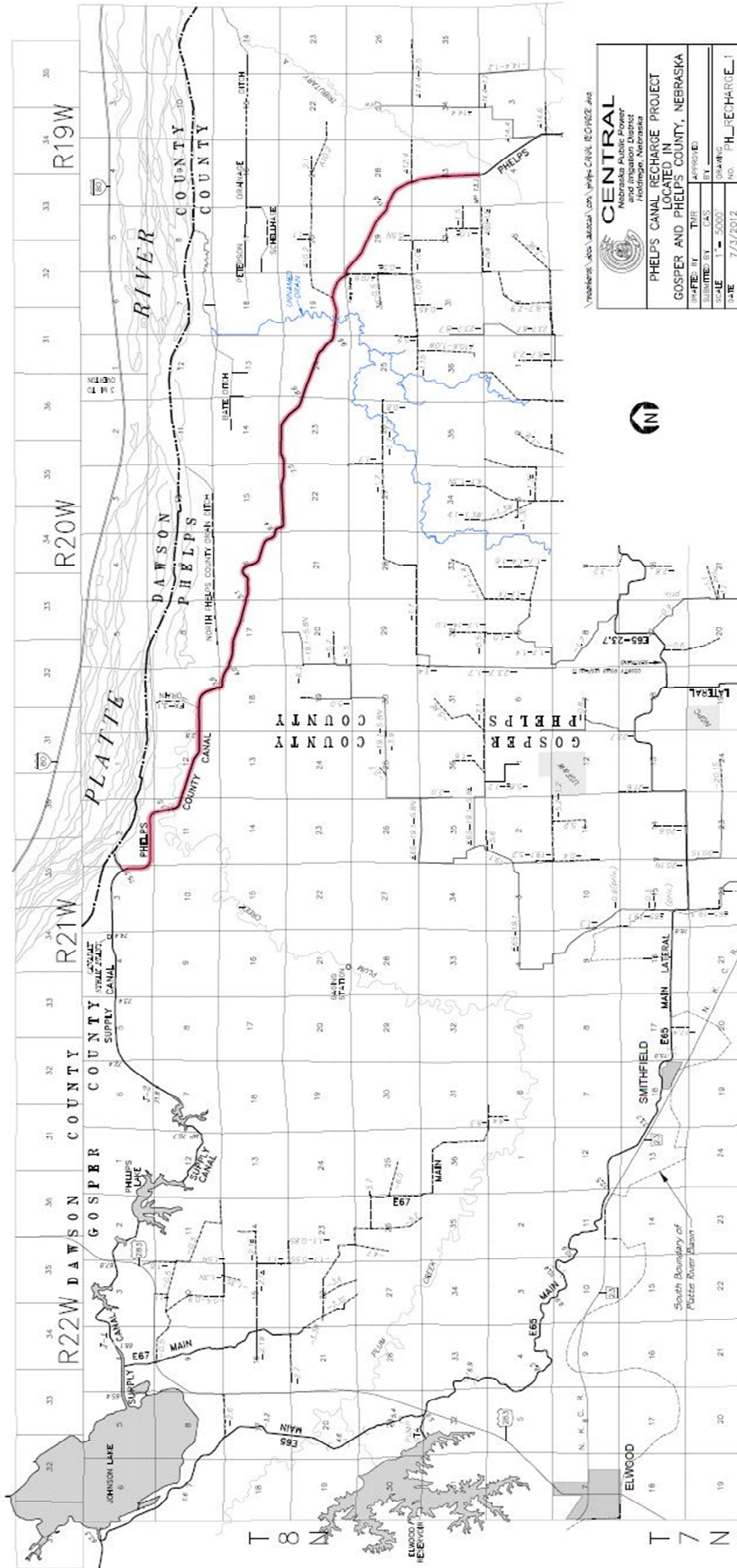

# Elwood Reservoir & E65 Canal Recharge Map - 2018 Platte Basin Annual Report Appendix D

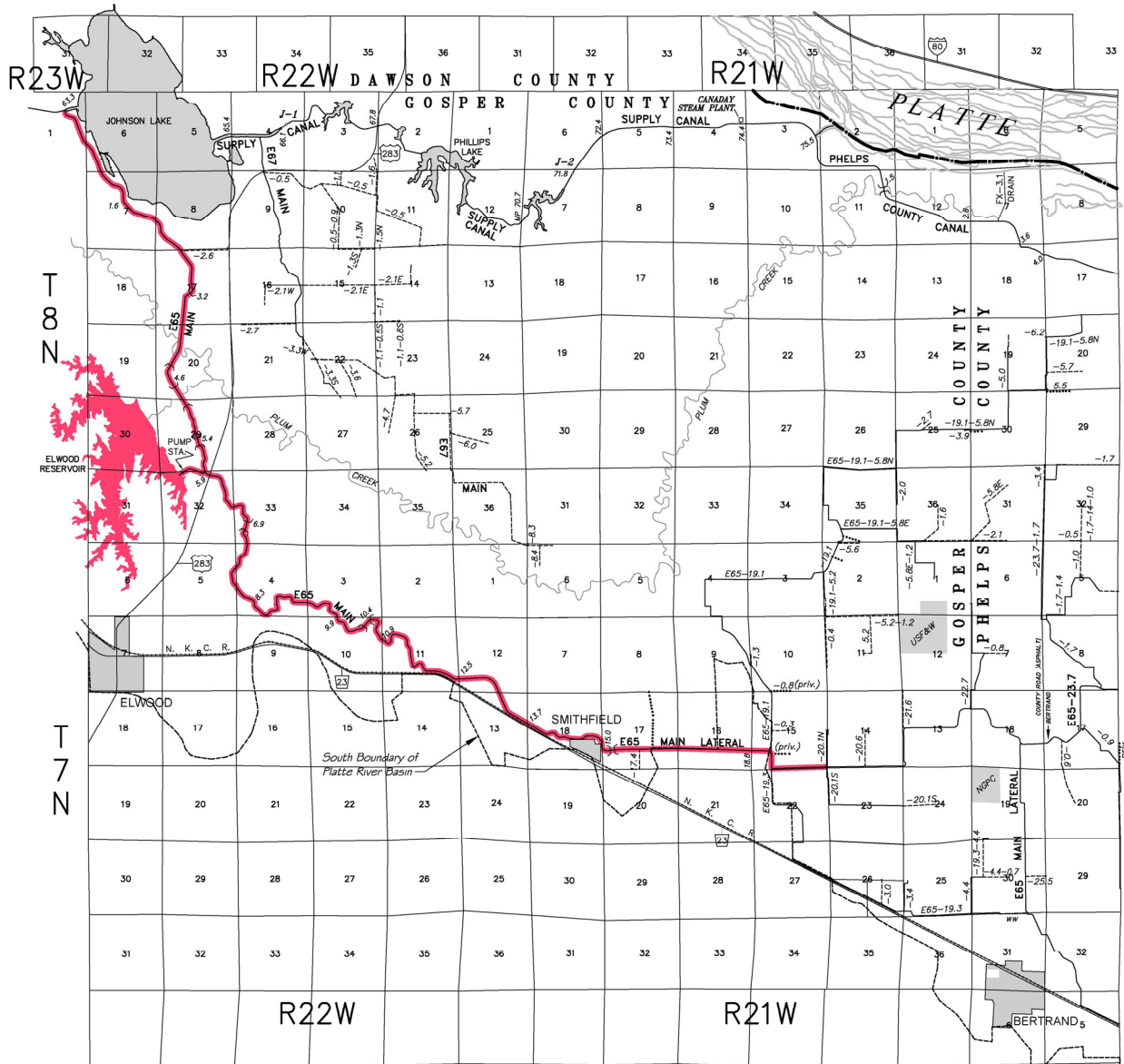

**LEGEND**

█ EXCESS FLOWS RECHARGE

\\ringenberg\docs\autocad\cor\elwoodRes-E65-201~.dwg



**CENTRAL**  
Nebraska Public Power  
and Irrigation District  
Holdrege, Nebraska

**PLATTE RIVER EXCESS FLOWS FOR RECHARGE  
IN E65 CANAL & ELWOOD RESERVOIR,  
GOPHER COUNTY, NEBRASKA**

DRAFTED BY TMR	APPROVED BY _____
SUBMITTED BY DRF	DRAWING NO. RCHG_E65_DEC14
SCALE 1" = 1.4 Mi.	DATE 12/3/2014

**North Dry Creek Augmentation Pumping - 2018 Platte Basin Annual Report  
Appendix E**

<b>Augmentation Production Well #1</b>			
G-159762		Well ID: 210850	
NWNE 27-8N-16W		NAD 83	
Lat: N40 38' 25.91700"		Long: W99 06' 59.91771"	
Surface Elev: 2156.92'		Stickup: 2.25'	
Well Depth=53'	Bore Hole: 30'	8" Column Pipe: 0'-40'	
16" Screen: 53'-23' / 0.085 Slot	River Gravel Pack: 53'-16'	8" Submersible 20 HP Pump: 40'-50'	
16" Plain: 23'-0'	Bentonite Chunks: 16'-0'	8" McCrometer Meter: Totalizer Acre/Inches	
Year	End Meter	Ac/In Annual Total	Annual Total Gallons
2011	18.39	<b>18.39</b>	<b>499,362</b>
2012	4511.65	<b>4493.26</b>	<b>122,009,982</b>
2013	7762.48	<b>3250.86</b>	<b>88,273,852</b>
2014	8206.91	<b>444.43</b>	<b>12,068,052</b>
2015	8631.71	<b>424.80</b>	<b>11,535,019</b>
2016	9275.33	<b>643.62</b>	<b>17,476,857</b>
2017	5874.67	<b>6599.34</b>	<b>179,198,478</b>
2018	6486.80	<b>612.13</b>	<b>16,621,778</b>

<b>Augmentation Production Well #2</b>			
G-173880		Well ID: 234693	
SESE 5-7N-16W		NAD 83	
Lat: N40 35' 52.60"		Long: W99 08' 34.80"	
Surface Elev: 2182.95'		Stickup: .88'	
Well Depth=103'	Bore Hole:	8" Column Pipe: 0'-60'	
16" Screen: 103'-63' / 0.085 Slot	River Gravel Pack: 103'-15'	8" Submersible 25.63 HP Pump: 40'-50'	
16" Plain: 63'-0'	Bentonite Chunks: 15'-0'	8" McCrometer Meter: Totalizer Acre/Inches	
Start Date / Time	End Meter	Ac/In Annual Total	Annual Total Gallons
2014	0.00	<b>0</b>	<b>0</b>
2015	54.84	<b>54.84</b>	<b>1,489,125</b>
2016	247.49	<b>192.65</b>	<b>5,231,218</b>
2017	1465.30	<b>1217.81</b>	<b>33,068,413</b>
2018	2073.30	<b>608.00</b>	<b>16,509,632</b>



## **Tri-Basin NRD Water Conservation Incentive Program**

### **Appendix F**

3/12/19

**Introduction:** The Tri-Basin NRD Water Conservation Incentive Program (WCIP) is intended to address two natural resources management issues: ensuring sustainability of groundwater supplies and protecting streamflows from diminishment due to groundwater pumping. The goal of this voluntary program is to reduce groundwater pumping and increase irrigation water use efficiency in Tri-Basin NRD.

**The Program:** Tri-Basin will allow landowners to enroll up to 8000 NRD-certified irrigated acres in the program. The enrollment period will be from March 26 through April 19, or until the program acre enrollment limit is reached. Once the enrollment limit is reached, water savings to the district could reach 650 acre-feet per year. Incentives in this program will likely be most attractive to landowners in phase two and phase three groundwater quantity management areas, so the water-use reductions should be greatest where the need is greatest (there are approximately 30,000 certified irrigated acres in Tri-Basin's phase two and phase three townships).

In exchange for their participation, landowners will be paid for the equivalent of one acre-inch of water credit per acre per year, with the opportunity to sell additional credits to the NRD at a set price. In addition to NRD purchases, landowners will have the opportunity to sell water credits on the open market at any agreed-upon price (private transactions require NRD board approval). Tri-Basin will maintain an "electronic bulletin board" to facilitate connections between buyers and sellers. Landowners will also be granted flexibility to irrigate any acres within enrolled parcels and to share (pool) allocations between parcels. Pooling agreements will be required to enable sharing allocations between parcels under different ownership.

**The Contract:** The NRD and the landowner will sign a five-year agreement. The agreement commits the landowner to limiting water use (allocation) on parcels that they select. The allocation will be equal to the UNL average corn crop consumptive irrigation requirement, which is nine inches per acre per year in Kearney County, ten inches per acre per year in Phelps County and eleven inches per acre per year in Gosper County (allocation will be limited to current allocation of nine inches per acre per year in Union Township in Gosper County). Landowners will be required to have flowmeters installed on all wells serving participating parcels and to report water use annually to the NRD. Tri-Basin NRD will offer cost share on flowmeters for participants. Tri-Basin NRD will spot check flowmeter readings on 20% of participating parcels annually. As a condition of their participation, landowners will agree to subject enrolled parcels to (most of) the same rules that apply to all landowners in Phase three groundwater quantity management areas. An instrument will be filed with the county clerk recording these contracts, to provide notice to potential buyers of water use limitations associated with program participation.

In exchange for their participation, the NRD agrees to buy one acre-inch per acre per year from every acre enrolled in the contract. Landowners will have two payment options: an annual payment of \$5 per acre-inch credit for one acre-inch per year, or payment at the end of the contract period for up to five acre-inches of credits per acre (assuming the landowner has that much unused allocation) at a rate of \$4 per acre-inch. The NRD may also choose to purchase additional credits from participants. NRD purchases of additional acre-inches will be prioritized in Groundwater Quantity Management Phase 2 and Phase 3 areas and 50%+ stream depletion zones. The NRD will have the right of first refusal to purchase unused allocations from landowners, so landowners would need NRD board approval before they make private sales.

Landowners will also have the option to irrigate any and all acres within participating parcels. They can also pool acre-inches between parcels under the same ownership (pooling water credits associated with parcels under different ownership, but the same management will require a separate NRD-approved pooling agreement). Pools are only allowed for multiple parcels in the same basin and with the same groundwater quantity management phase status. Water use will be deducted from landowner water credit "accounts."

If a producer overuses their allocation, they will need to purchase credits from other landowners to eliminate their deficit. Otherwise they will be prohibited from irrigating enrolled parcels until the deficit is eliminated. The only way a landowner can cancel a contract would be to pay the NRD for the full contracted amount (refund any payments that we've already made to them and pay the NRD the amount we would have paid them at the end of the contract period).

## Tri-Basin NRD Water Conservation Incentive Program Appendix F

### **Terminology**

**Accounts-** An account will track the number of acre-inches of water available for pumping on a parcel. Each parcel will have a separate account, unless landowners form pool accounts.

**Allocations-** Allocation amounts would be based on estimated safe yields from aquifers that would not result in long-term declines in groundwater levels. An initial allocation will be equal to the University of Nebraska's average annual irrigation water consumption requirement for corn (that amount is nine inches per acre in Kearney County, ten inches per acre in Phelps County and eleven inches per acre in Gosper County).

**Credits (Water Use Credits)-** Credits are accumulated on a per-NRD-certified irrigated acre per-parcel basis. Allocation credits are granted at the beginning of each allocation period.

**Debits-** Debits would be made against accounts based on actual pumping or water credits marketed and sold to the NRD or other water users.